

RECEIVED N MEXICO OIL CONSERVATION COMMISSION WELL LOCATION AND ACREEAGE DEDICATION PLAT

Form C-10L
Supersedes C-128
Effective 1-1-65

MAY 10 1976

All distances must be from the outer boundaries of the Section

Operator INEXCO OIL COMPANY		Lease FEDERAL AVALON / Federal		Well No. 1
Unit Letter P X	Section 1	Township 21 SOUTH	Range 26 EAST	County EDDY
Actual Portage Location of Well: 350 feet from the EAST line and 803 feet from the SOUTH line				
Ground Level Elev. 3211.8	Producing Formation MORROW	Pool BURTON FLAT M. 11.13	Dedicated Acreage 320 Acres	

- Outline the acreage dedicated to the subject well by colored pencil or hachure marks, on the plat below.
- If more than one lease is dedicated to the well, outline each and identify the ownership thereof (both as to working interest and royalty).
- If more than one lease of different ownership is dedicated to the well, have the interests of all owners been consolidated by communitization, unitization, force-pooling, etc?

☐ Yes ☐ No If answer is "yes," type of consolidation _____

If answer is "no," list the owners and tract descriptions which have actually been consolidated. (Use reverse side of this form if necessary.) _____

No allowable will be assigned to the well until all interests have been consolidated (by communitization, unitization, forced-pooling, or otherwise) or until a non-standard unit, eliminating such interests, has been approved by the Commission.

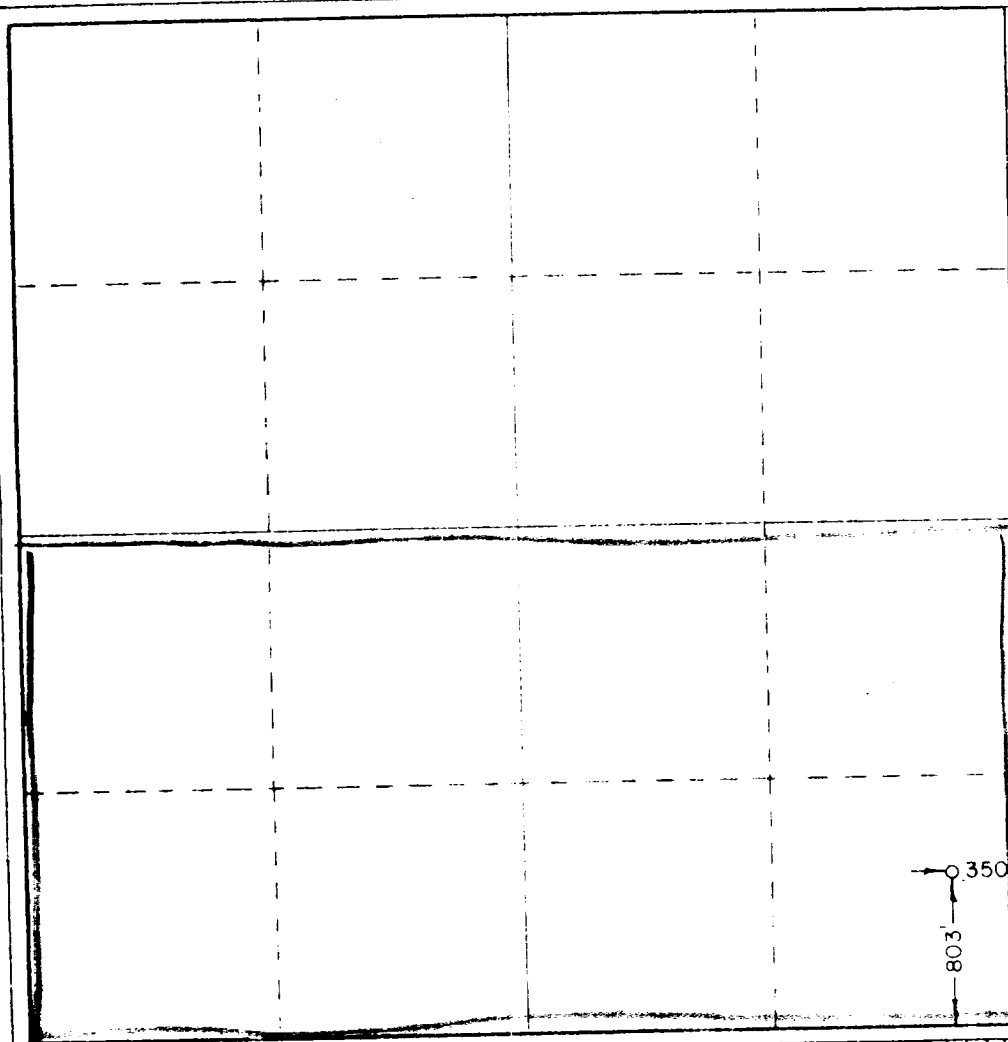

CERTIFICATION

I hereby certify that the information contained herein is true and complete to the best of my knowledge and belief.

R. T. Foster

Name
R. T. Foster

Position
Drlg. Administrator

Company
Inexco Oil Company

Date
May 10, 1976

I hereby certify that the well location shown on this plat was plotted from field notes of actual surveys made by me or under my supervision, and that the same is true and correct to the best of my knowledge and belief.

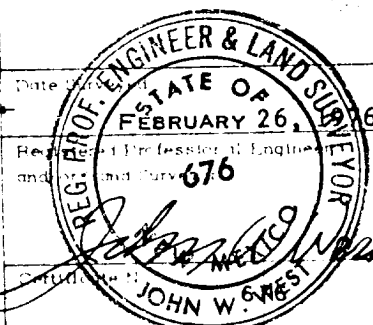

Date
FEBRUARY 26, 1976

Registered Professional Engineer and Land Surveyor
676

JOHN W. REST