

NEW MEXICO OIL CONSERVATION COMMISSION
WELL LOCATION AND ACREAGE DEDICATION PLAT

Form O-102
Supersedes O-101
Effective 1-1-65

All distances must be from the outer boundaries of the Section

Operator TEXAS OIL & GAS CORP.			Lease Federal "4"		Well No. 1
Section F	Section 4	Township 22 South	Range 26 East	County Eddy	
Approximate Location of Well					
2310	feet from the	North	line and	1980	feet from the West line
Ground Level Elev.	Producing Formation Morrow		Pool Undesignated (Morrow)	Dedicated Acreage 320 Acres	

- Outline the acreage dedicated to the subject well by colored pencil or hachure marks on the plat below.
- If more than one lease is dedicated to the well, outline each and identify the ownership thereof (both as to working interest and royalty).
- If more than one lease of different ownership is dedicated to the well, have the interests of all owners been consolidated by communitization, unitization, force-pooling, etc?

☐ Yes ☒ No If answer is "yes," type of consolidation _____

If answer is "no," list the owners and tract descriptions which have actually been consolidated. (Use reverse side of this form if necessary.) None

No allowable will be assigned to the well until all interests have been consolidated (by communitization, unitization, forced-pooling, or otherwise) or until a non-standard unit, eliminating such interests, has been approved by the Commission.

RECEIVED
OCT 29 1976
U. S. GEOLOGICAL SURVEY
ARTESIA, NEW MEXICO

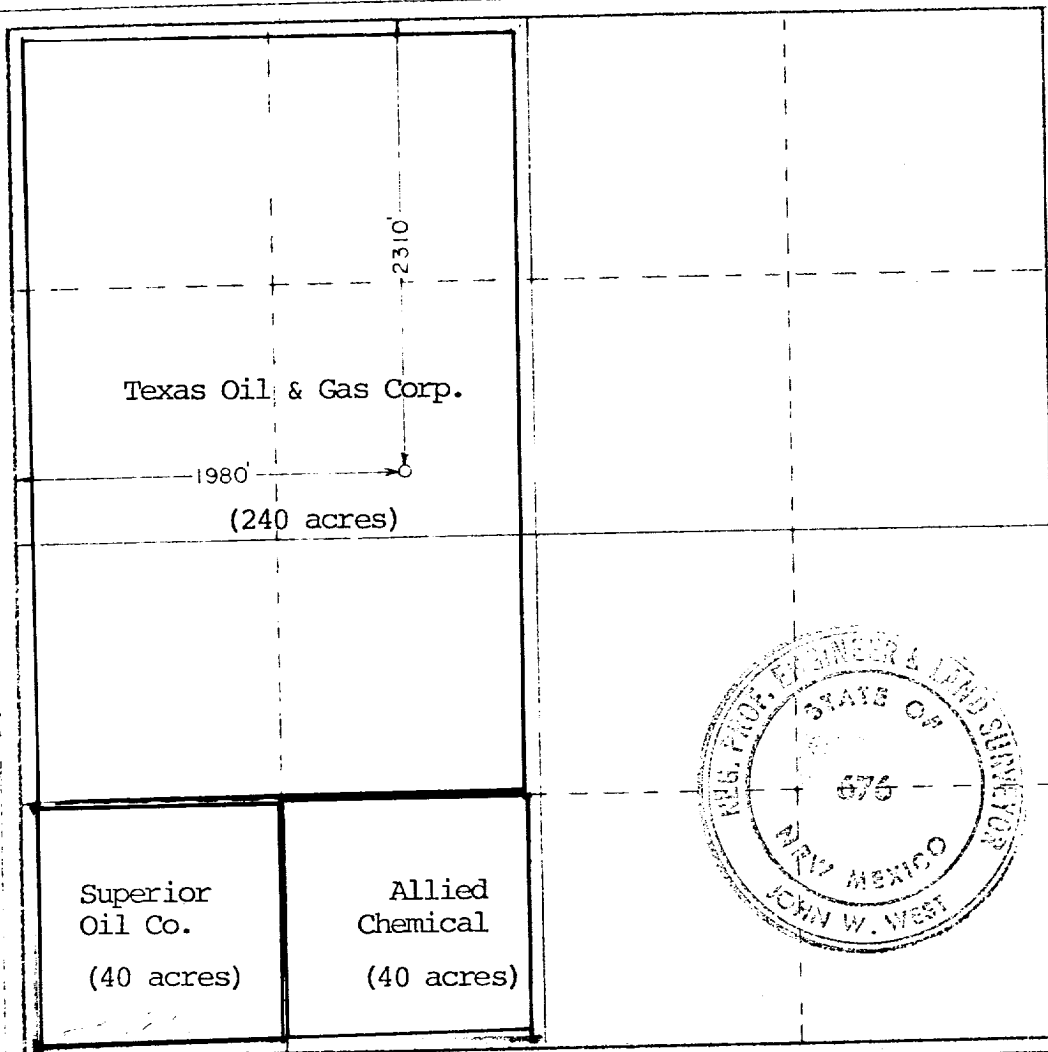

CERTIFICATION

I hereby certify that the information contained herein is true and complete to the best of my knowledge and belief.

J. R. Colter
J. R. Colter

Position
Staff Engineer

Employer
Texas Oil & Gas Corp.

Date
October 29, 1976

I hereby certify that the well location shown on this plat was plotted from field notes of actual surveys made by me or under my supervision, and that the same is true and correct to the best of my knowledge and belief.

Date Surveyed

October 19, 1976

Registered Professional Engineer and Land Surveyor

John W. West
Certificate No. 676