

REGISTRATION		
SANTA FE	/	
TRIP	/	/
U.S.G.S.		
LAND OFFICE		
TRANSPORTER	OIL /	
	GAS /	
OPERATOR	/	
PRODUCTION OFFICE		

NEW MEXICO OIL & GAS CONSERVATION COMMISSION  
REQUEST FOR ALLOWABLE  
AND  
AUTHORIZATION TO TRANSPORT OIL AND NATURAL GAS

Form C-104  
Superseding Old C-104 and C-11  
Effective 1-1-65

RECEIVED

OCT 17 1977

Operator	Belco Petroleum Corporation	O. C. C. ARTESIA, OFFICE
Address	10,000 Old Katy Rd., Suite 100, Houston, Texas	77055
Reason(s) for filing (Check proper box)		Other (Please explain)
New Well	<input checked="" type="checkbox"/>	Change in Transporter of:
Recompletion	<input type="checkbox"/>	Oil <input type="checkbox"/> Dry Gas <input type="checkbox"/>
Change in Ownership	<input type="checkbox"/>	Casinghead Gas <input type="checkbox"/> Condensate <input type="checkbox"/>

If change of ownership give name and address of previous owner

II. DESCRIPTION OF WELL AND LEASE

Lease Name	Well No.	Pool Name, including Formation	Kind of Lease	Lease No.
Pennzoil State	1	Revelation - Strawn	State, Federal or Fee State	L-4894
Location				
Unit Letter	B	913 Feet From The North Line and 2193 Feet From The East		
Line of Section	16	Township 22-S	Range 25-E	NMPM, Eddy County

III. DESIGNATION OF TRANSPORTER OF OIL AND NATURAL GAS

Name of Authorized Transporter of Oil (has changed its name to) or Condensate	Address (Give address to which approved copy of this form is to be sent)
<del>Summit Gas Company</del> SUMMIT TRANSPORTATION COMPANY	405 Entex Bldg. Houston, Texas 77002
Name of Authorized Transporter of Casinghead Gas or Dry Gas	Address (Give address to which approved copy of this form is to be sent)
Llano, Inc.	P.O. Box 1320, Hobbs, New Mexico 88240
If well produces oil or liquids, give location of tanks.	Unit Sec. Twp. Rge. Is gas actually connected? When
	B 16 22S 25E Yes 10-10-77

If this production is commingled with that from any other lease or pool, give commingling order number:

IV. COMPLETION DATA

Designate Type of Completion - (X)	Oil Well	Gas Well	New Well	Workover	Deepen	Plug Back	Same Prod.	Diff. Prod.
		X						
Date Spudded	Date Compl. Ready to Prod.	Total Depth	P.B.T.D.					
1-21-77	6-1-77	10850'	10186'					
Elevations (DF, RKB, RT, GR, etc.)	Name of Producing Formation	Top Oil/Gas Pay	Tubing Depth					
3708.4'	Strawn	9619'	9517'					
Perforations	Depth Casing Shoe							
9619'-625'	10850'							
TUBING, CASING, AND CEMENTING RECORD								
HOLE SIZE	CASING & TUBING SIZE	DEPTH SET	SACKS CEMENT					
17 1/2"	13-3/8"	360'	300 sx "C" + 8 yds mix					
12 1/4"	9-5/8"	2395'	1200 sx class "C"					
8-3/4"	5 1/2"	10850'	1337 sx class "H"					
	2-7/8"	9517'						

V. TEST DATA AND REQUEST FOR ALLOWABLE OIL WELL

(Test must be after recovery of total volume of load oil and must be equal to or exceed top allowable for this depth or be for full 24 hours)

Date First New Oil Run To Tanks	Date of Test	Producing Method (Flow, pump, gas lift, etc.)	
Length of Test	Tubing Pressure	Casing Pressure	Choke Size
Actual Prod. During Test	Oil - Bbls.	Water - Bbls.	Gas - MCF

GAS WELL

Actual Prod. Test - MCF/D	Length of Test	Bbls. Condensate/MMCF	Gravity of Condensate
1100	24 hrs.	5.45	56.0
Testing Method (pilot, back pr.)	Tubing Pressure (shut-in)	Casing Pressure (Shut-in)	Choke Size
Orifice Meter	3000#	Packer	14/64"

VI. CERTIFICATE OF COMPLIANCE

I hereby certify that the rules and regulations of the Oil Conservation Commission have been complied with and that the information given above is true and complete to the best of my knowledge and belief.

E. W. Bayard  
(Signature)  
Production Accountant  
(Title)  
October 13, 1977  
(Date)

OIL CONSERVATION COMMISSION

APPROVED NOV 4 1977  
BY W. A. Gressett  
TITLE SUPERVISOR, DISTRICT II

This form is to be filed in compliance with RULE 1104.  
If this is a request for allowable for a newly drilled or deepened well, this form must be accompanied by a tabulation of the deviation tests taken on the well in accordance with RULE 111.  
All sections of this form must be filled out completely for allowable on new and recompleted wells.  
Fill out only Sections I, II, III, and VI for change of owner, well name or number, or transporter or other such change of condition.

OIL CONSERVATION COMMISSION

RECEIVED

OCT 11 1977

O.C.C.  
ARTESIA, OFFICE

P.O. DRAWER DD

ARTESIA, NEW MEXICO

88210

NOTICE OF GAS CONNECTION

DATE OCTOBER 10, 1977

THIS IS TO NOTIFY THE OIL CONSERVATION COMMISSION THAT CONNECTION FOR THE  
PURCHASE OF GAS FROM THE BELCO PETROLEUM CORPORATION,

PENNZOIL STATE, 1 B, 16-22S-25E, REVELATION Straw  
LEASE WELL-UNIT S-T-R POOL

LLANO, INC., WAS MADE ON OCTOBER 10, 1977.  
NAME OF TRANSPORTER

LLANO, INC.  
TRANSPORTER

Al Klaar  
REPRESENTATIVE  
AL KLAAR

MANAGER OF PETROLEUM AND  
NATURAL GAS ENGINEERING  
TITLE

cc: Oil Conservation Commission Box 2088 Santa Fe, New Mexico 87501  
cc: To Operator

NEW MEXICO OIL CONSERVATION COMMISSION  
WELL LOCATION AND ACREAGE DEDICATION A1

Form C-107  
Supersedes C-128  
Effective 1-1-65

All distances must be from the outer boundaries of the Section

Operator <b>BELCO PETROLEUM CORP.</b>		Lease <b>Pennzoil-State</b>		Section <b>1</b>
Unit Letter <b>B</b>	Section <b>16</b>	Township <b>22 South</b>	Range <b>25 East</b>	County <b>Eddy</b>
Actual Well Location of Well:				
913 feet from the north line and		2193 feet from the east line		Spot
Ground Level Elev. <b>3708.4</b>	Producing Formation <b>Strawn</b>	Pool <b>Revelation Strawn</b>	<b>320</b>	

1. Outline the acreage dedicated to the subject well by colored pencil or hatchure marks on the plat below
2. If more than one lease is dedicated to the well, outline each and identify the ownership thereof (both as to working interest and royalty).
3. If more than one lease of different ownership is dedicated to the well, have the interests of all owners been consolidated by communitization, unitization, force-pooling, etc?

☒ Yes ☐ No If answer is "yes," type of consolidation Communitization

If answer is "no," list the owners and tract descriptions which have actually been consolidated (Use reverse side of this form if necessary.)

No allowable will be assigned to the well until all interests have been consolidated (by communitization, unitization, forced-pooling, or otherwise) or until a non-standard unit, eliminating such interests, has been approved by the Commission.

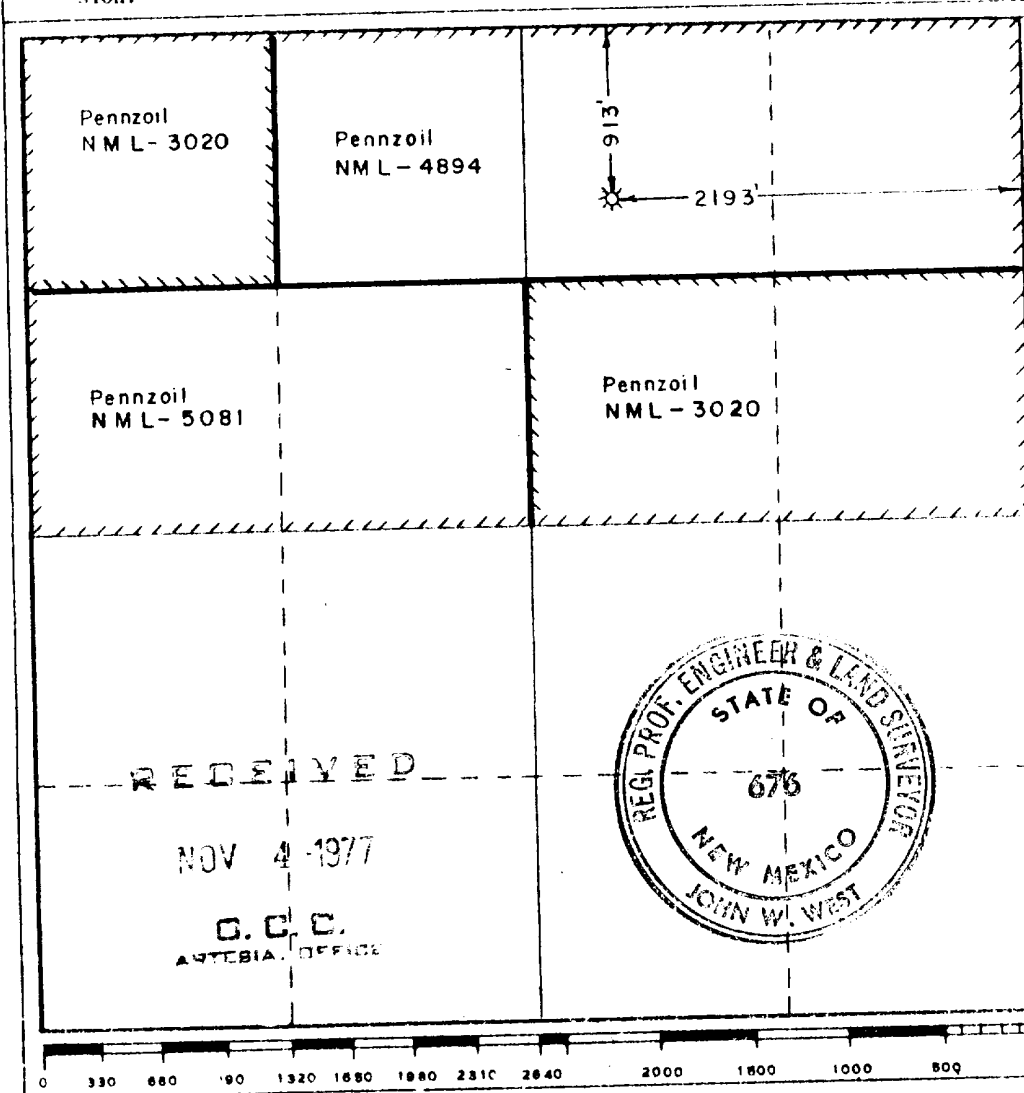

CERTIFICATION

I hereby certify that the information contained herein is true and complete to the best of my knowledge and belief.

Name  
Lee G. Nering  
Position  
Administrative Geologist  
Company  
Belco Petroleum Corp.  
Date  
Oct. 31, 1977

I hereby certify that the well location shown on this plat was plotted from field notes of actual surveys made by me or under my supervision, and that the same is true and correct to the best of my knowledge and belief.

Date Surveyed  
Dec. 29, 1976  
Registered Professional Engineer and/or Land Surveyor  
John W. West  
Certificate No. 676