

NO. OF COPIES RECEIVED	6
DISTRIBUTION	
SANTA FE	1
FILE	1
U.S.G.S.	2
LAND OFFICE	1
OPERATOR	1

RECEIVED  
NEW MEXICO OIL CONSERVATION COMMISSION

MAR 4 1977

O. C. C.  
ARTESIA, OFFICE

30-015-22071

Form C-101  
Revised 1-1-65

5A. Indicate Type of Lease	STATE <input checked="" type="checkbox"/>	FEE <input type="checkbox"/>
5. State Oil & Gas Lease No.	L-4894	

APPLICATION FOR PERMIT TO DRILL, DEEPEN, OR PLUG BACK

1a. Type of Work		7. Unit Agreement Name	
b. Type of Well DRILL <input checked="" type="checkbox"/> DEEPEN <input type="checkbox"/> PLUG BACK <input type="checkbox"/> OIL WELL <input type="checkbox"/> GAS WELL <input checked="" type="checkbox"/> OTHER <input type="checkbox"/> SINGLE ZONE <input checked="" type="checkbox"/> MULTIPLE ZONE <input type="checkbox"/>		8. Farm or Lease Name Pennzoil State	
2. Name of Operator BELCO PETROLEUM CORPORATION		9. Well No. 2	
3. Address of Operator 10,000 Old Katy Road, Suite 100, Houston, Texas 77055		10. Field and Pool, or Wildcat Undesignated Morrow	
4. Location of Well UNIT LETTER <u>BK</u> LOCATED <u>1780'</u> FEET FROM THE <u>South</u> LINE AND <u>2180'</u> FEET FROM THE <u>West</u> LINE OF SEC. <u>16</u> TWP. <u>22-S</u> RGE. <u>25-E</u> NMPM		12. County Eddy Co.	
19. Proposed Depth 11,000'		19A. Formation Morrow	
20. Rotary or C.T. Rotary		21. Elevations (Show whether DF, RT, etc.) 3628	
21A. Kind & Status Plug. Bond Permanent		21B. Drilling Contractor McVay	
22. Approx. Date Work will start 3-10-77			

PROPOSED CASING AND CEMENT PROGRAM

SIZE OF HOLE	SIZE OF CASING	WEIGHT PER FOOT	SETTING DEPTH	SACKS OF CEMENT	EST. TOP
17 1/2"	13 3/8"	48	300'	315	Surface
12 1/2"	9 3/8"	36	2300'	750	Surface
8 1/2"	5 1/2"	17 & 20	11,000'	720	8500

BOP PROGRAM

13-3/8" Csg: 12" Hydril will be installed and tested to 1500 psi. Two inch diverter line w/1500 psi working pressure valve will be installed below Hydril. 9-5/8" Csg: 10" Rams and Blinds w/Hydril. Hydraulic choke and manifold. BOP stack and choke manifold will be tested to 3000 psi. At 5000' a flow-show and gas separator will be installed. A set of PVT's will be used on steel mud pits.

GAS IS NOT DEDICATED

APPROVAL VALID  
FOR 90 DAYS UNLESS  
DRILLING COMMENCED,  
EXPIRES 6-11-77

IN ABOVE SPACE DESCRIBE PROPOSED PROGRAM: IF PROPOSAL IS TO DEEPEN OR PLUG BACK, GIVE DATA ON PRESENT PRODUCTIVE ZONE AND PROPOSED NEW PRODUCTIVE ZONE. GIVE BLOWOUT PREVENTER PROGRAM, IF ANY.

I hereby certify that the information above is true and complete to the best of my knowledge and belief.

Signed [Signature] Title District Engineer Date 3-3-77

(This space for State Use)

APPROVED BY [Signature] TITLE SUPERVISOR, DISTRICT H DATE MAR 11 1977

CONDITIONS OF APPROVAL, IF ANY:

Cement must be circulated to  
surface behind 13 3/8" & 9 3/8" casing

Notify N.M.C.C. in 10 days  
time to witness cementing  
the 9 3/8" casing

NEW MEXICO OIL CONSERVATION COMMISSION  
WELL LOCATION AND ACREAGE DEDICATION PLAT

All distances must be from the outer boundaries of the Section

Lessor <b>BELCO PETROLEUM CORP.</b>			Lessee <b>PENNZOIL STATE</b>		
Section <b>K</b>	Range <b>16</b>	Meridian <b>22 South</b>	Range <b>25 East</b>	County <b>Eddy</b>	
Section <b>1780</b>	Section <b>South</b>	Section <b>2180</b>	Section <b>West</b>		
Section <b>3628</b>	Section <b>Morrow</b>	Section <b>Undesignated Morrow</b>	Section <b>320</b>		

2

1. Outline the acreage dedicated to the subject well by colored pencil or hatchmark marks on the plat below.
2. If more than one lease is dedicated to the well, outline each and identify the ownership thereof (both ownership interest and royalty).
3. If more than one lease of different ownership is dedicated to the well, have the interests of all owners been consolidated by communitization, unitization, force-pooling etc?

☐ Yes ☒ No If answer is "yes," type of consolidation to be communitized if productive

If answer is "no," list the owners and tract descriptions which have actually been consolidated (so communitized, unitized, forced-pooling, or otherwise) or until a non-standard unit, eliminating such interests, has been approved by the Commission.

No allowable will be assigned to the well until all interests have been consolidated (by communitization, unitization, forced-pooling, or otherwise) or until a non-standard unit, eliminating such interests, has been approved by the Commission.

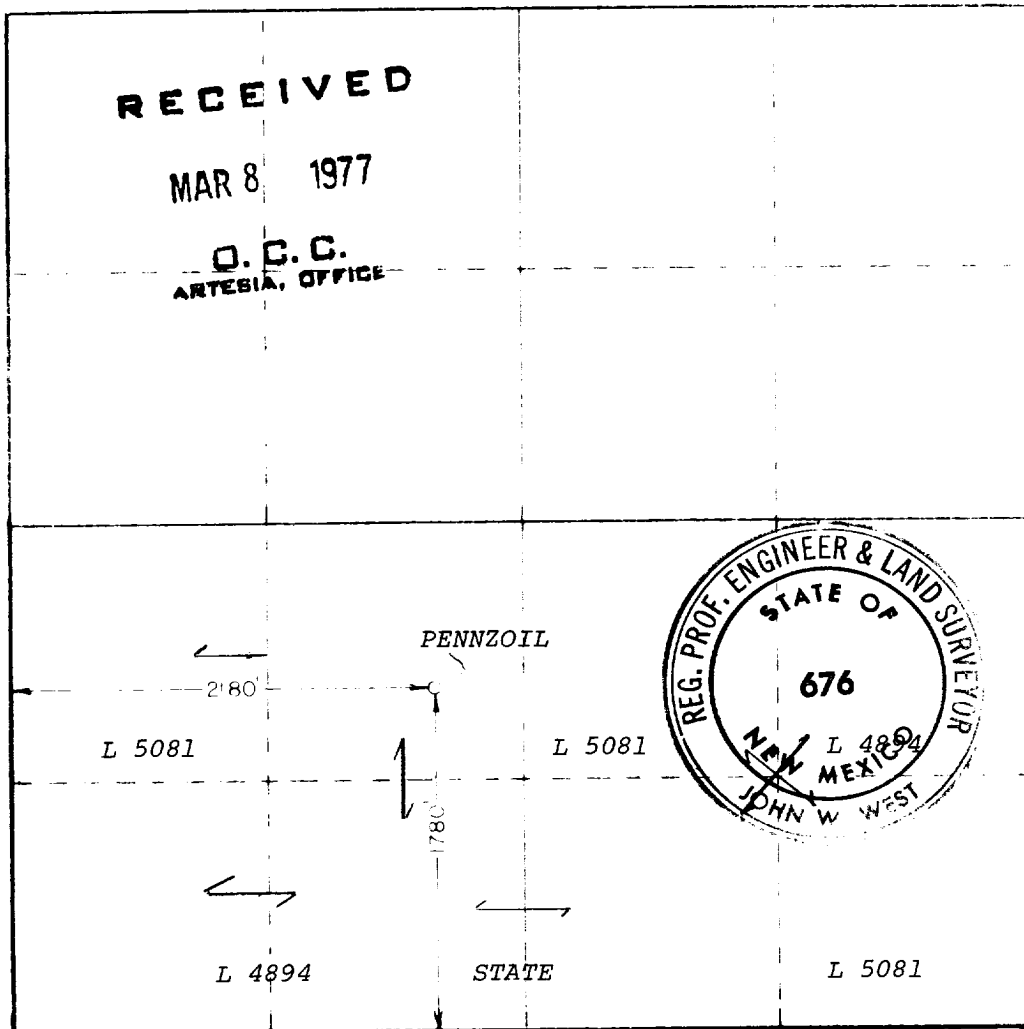

CERTIFICATION

I hereby certify that the information furnished hereon is true and correct to the best of my knowledge and belief.

*[Signature]*

District Engineer

Belco Petroleum Corporation

March 9, 1977

I hereby certify that the well shown on this plat was located in accordance with the rules and regulations of the State of New Mexico and that the well is being drilled and operated in accordance with the rules and regulations of the State of New Mexico and that the well is being drilled and operated in accordance with the rules and regulations of the State of New Mexico.

February 25, 1977

Registered Professional Engineer and Land Surveyor

*[Signature]*

676