

UNITED STATES
DEPARTMENT OF THE INTERIOR
GEOLOGICAL SURVEY

30-015-22214

5. LEASE DESIGNATION AND SERIAL NO.

4298 LC-065609

6. IF INDIAN, ALLOTTEE OR TRIBE NAME

7. UNIT AGREEMENT NAME

Big Eddy Unit

8. FIRM OR LEASE NAME

Big Eddy Unit

9. WELL NO.

55

10. FIELD AND POOL, OR WILDCAT

Wildcat

11. SEC., T., R., M., OR BLK.
AND SURVEY OR AREA

Sec 19-T21S-R29E

12. COUNTY OR PARISH

Eddy County

13. STATE

New Mexico

APPLICATION FOR PERMIT TO DRILL, DEEPEN, OR PLUG BACK

1a. TYPE OF WORK

DRILL ☒DEEPEN ☐PLUG BACK ☐

b. TYPE OF WELL

OIL
WELL ☒GAS
WELL ☐

OTHER

SINGLE
ZONE ☒MULTIPLE
ZONE ☐

2. NAME OF OPERATOR

PERRY R. BASS

3. ADDRESS OF OPERATOR

P.O. Box 2760, Midland, Texas 79702

4. LOCATION OF WELL (Report location clearly and in accordance with any State requirements*)

At surface 660' FSL & 660' FEL Sec 19, T21S-R29E

Eddy County, New Mexico

At proposed prod. zone
same as above

14. DISTANCE IN MILES AND DIRECTION FROM NEAREST TOWN OR POST OFFICE*

12 miles east of Carlsbad, New Mexico

15. DISTANCE FROM PROPOSED*

LOCATION TO NEAREST
PROPERTY OR LEASE LINE, FT.
(Also to nearest drilg. unit line, if any)18. DISTANCE FROM PROPOSED LOCATION*
TO NEAREST WELL, DRILLING, COMPLETED,
OR APPLIED FOR, ON THIS LEASE, FT.

21. ELEVATIONS (Show whether DF, RT, GR, etc.)

GL 3267.8

16. NO. OF FEET IN LEASE

19. PROPOSED DEPTH

6700'

17. NO. OF ACRES ASSIGNED
TO THIS WELL

40

20. ROTARY OR CABLE TOOLS

rotary

22. APPROX. DATE WORK WILL START*

30 days after approval

23. PROPOSED CASING AND CEMENTING PROGRAM

SIZE OF HOLE	SIZE OF CASING	WEIGHT PER FOOT	SETTING DEPTH	QUANTITY OF CEMENT
12-1/4	8-5/8	24#	500'	333 sx
7-7/8	5-1/2	14 & 15.5	6700'	824 sx

Drilling procedure, BOPE diagram, anticipated formation tops, & surface
use plans are attached.

RECEIVED
JUL 05 1977
U.S. GEOLOGICAL SURVEY
ARTESIA, NEW MEXICO

IN ABOVE SPACE DESCRIBE PROPOSED PROGRAM: If proposal is to deepen or plug back, give data on present productive zone and proposed new productive zone. If proposal is to drill or deepen directionally, give pertinent data on subsurface locations and measured and true vertical depths. Give blowout preventer program, if any.

24.

SIGNED

(This space for Federal or State office use)

TITLE

Division Manager

DATE

7-1-1977

PERMIT NO.

APPROVAL DATE

JUL 15 1977

APPROVED BY

CONDITIONS OF APPROVAL, IF ANY:

TITLE

ACTING DISTRICT ENGINEER

DATE

JUL 15 1977

Subject to attached stipulations!

*See Instructions On Reverse Side

THIS APPROVAL IS RESCINDED IF OPERATIONS
ARE NOT COMMENCED WITHIN 3 MONTHS,
EXPIRES OCT 15 1977

**NEW MEXICO OIL CONSERVATION COMMISSION
WELL LOCATION AND ACREAGE DEDICATION PLAT**

Form O-200
Supersedes O-128
Effective 6-65

All distances must be from the outer boundaries of the Section

Operator Perry R. Bass			Lease Big Eddy Unit		Well No. 55
Section Letter P	Section 19	Township 21 South	Range 29 East	County Eddy	
Actual Well Location (Well):					
660	feet from the	East	line and	660	feet from the
				South	
Acres of land covered by plat 3267.8	Producing Formation <i>Bone Springs</i>		Pool <i>Wildcat</i>	Estimated Acreage 40	

1. Outline the acreage dedicated to the subject well by colored pencil or hatchure marks on the plat below.
2. If more than one lease is dedicated to the well, outline each and identify the ownership thereof (both as to working interest and royalty).
3. If more than one lease of different ownership is dedicated to the well, have the interests of all owners been consolidated by communitization, unitization, force-pooling, etc?

Yes ☐ No ☐ If answer is "yes," type of consolidation _____

If answer is "no," list the owners and tract descriptions which have actually been consolidated (Use reverse side of this form if necessary.) _____

No allowable will be assigned to the well until all interests have been consolidated (by communitization, unitization, force-pooling, or otherwise) or until a non-standard unit, eliminating such interests, has been approved by the Commission.

RECEIVED
JUL 05 1977
U.S. GEOLOGICAL SURVEY
ARTESIA, NEW MEXICO

CERTIFICATION

I hereby certify that the information contained herein is true and complete to the best of my knowledge and belief.

J. E. Pullig

J. E. Pullig

Division Manager

Perry R. Bass

July 1, 1977

I hereby certify that the well location shown on this plat was plotted from field notes of actual surveys made by me or under my supervision and that the same is true and correct to the best of my knowledge and belief.

Date Surveyed:

June 21, 1977

Registered in the name of _____
and the following:

John W. West

Certificate No. **676**

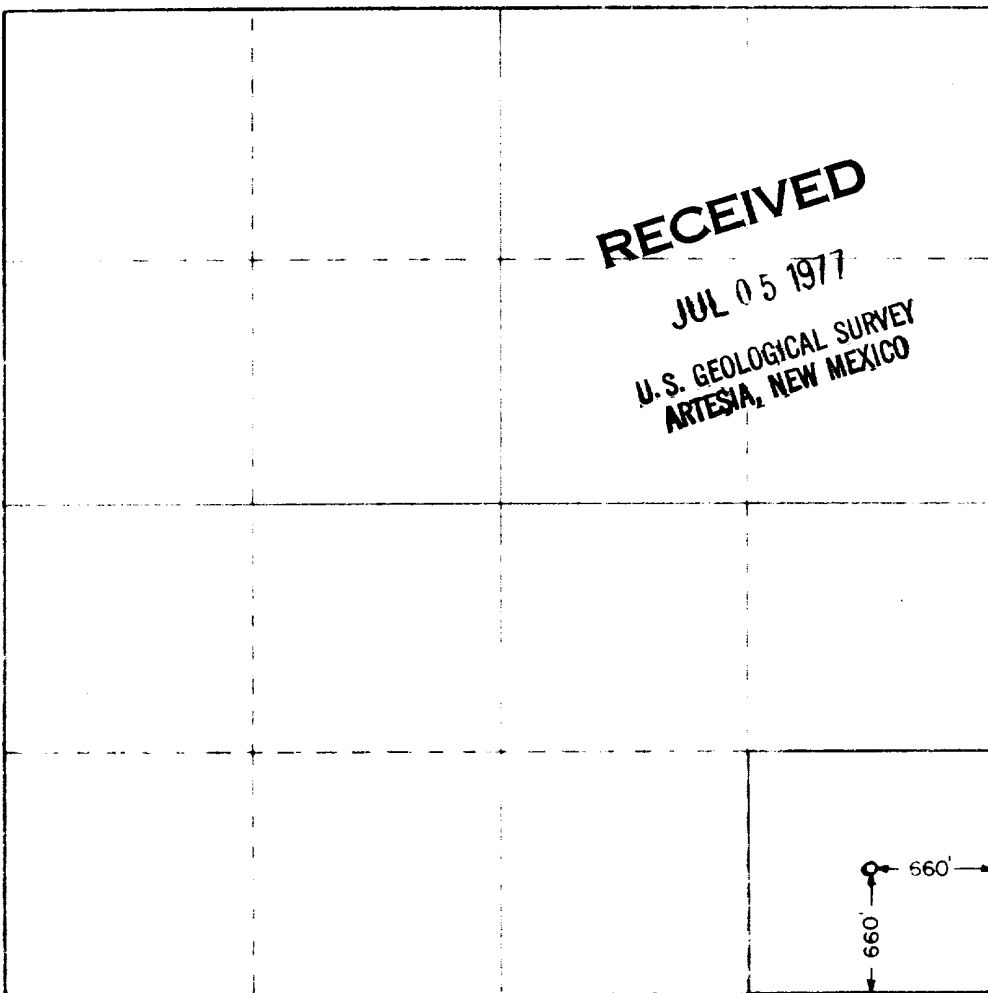

330 660 90 1320 1680 1980 2310 2640 2970 3300 3630 3960 4290 4620 4950 5280 5610 5940 6270 6600

BUREAU OF LAND MANAGEMENT
ROSWELL, NEW MEXICO

January 29, 1976

Lease # LC-065609
Operator Perry R. Bass
Well Name 55- Big Eddy Unit
Location Sec 19, T21S, R29E

"STANDARD STIPULATIONS FOR ALL DRILLING
IN RELATION TO OIL AND GAS ACTIVITIES
IN THE ROSWELL DISTRICT"

(The following list of 14 stipulations are some of the more commonly used stipulations for oil and gas drilling operations in southeastern New Mexico. The blocks checkmarked in red designate the stipulations applicable to the particular drilling permit listed above. Special or additional stipulations (if any) are written in under #15.)

- ☒ 1. If, during operations, the operator or any person working in his behalf, discover any historic or prehistoric ruin, monument or site, or any object of antiquity subject to the Antiquities Act of June 8, 1906, (34 Stat. 225, 16 U.S.C. Secs. 431-433), and 43 CFR Part 3, then work will be suspended and the discovery promptly reported to the District Manager. The Bureau will then take such action as required under the Act and regulations thereunder. When directed by the District Manager, the operator will obtain, at his expense, a qualified archaeologist to examine and, if necessary, excavate or gather such ruins or objects.
- ☒ 2. All access roads constructed in conjunction with the drilling permit should be limited to 12 feet in width, along with turnouts. If well is a producer, all roads will be adequately drained to control runoff and soil erosion. Drainage facilities may include ditches, water bars, culverts and/or any other measure deemed necessary by the responsible BLM representative.
- ☒ 3. Each existing fence to be crossed by the permittee will be braced and tied off before cutting so as to prevent slacking of the wire. The opening will be protected as necessary during construction to prevent the escape of livestock and upon completion of construction, the fence will be repaired to BLM specifications. A cattleguard with an adjacent 12 foot gate will be installed in any fence where a road is to be regularly traveled.

- ☐ 4. When a road or construction in connection with the drilling operation breaks or destroys a natural barrier used for livestock controls, gap thus opened shall be fenced to prevent drift of livestock. Said fences shall be constructed according to BLM specifications.
- ☒ 5. Materials removed during construction must be disposed of in such a manner that it does not detract from the aesthetics and does not accelerate erosion. When clearing the area of operations of vegetation other than grass, the vegetation removed will be placed in drainages, washes, gullies, etc., and "walked down" by crawler type tractor. If no drainages are in the immediate area, the vegetation will be "walked down" in place. After construction has been completed, the affected area will be left in as aesthetically pleasing condition as possible. All trash resultant from construction activities will be disposed of. Any large rocks left as a result of construction activities will not be piled or left in rolls but will be left so they do not detract from the scenic attributes of the area and will not hinder the movement of livestock or big game animals.
- ☒ 6. Any "available topsoil" encountered during the construction of the drill site area will be stockpiled and made available for re-surfacing of the reserve pit area (after pits are covered) after completion of the drilling operation.
- ☒ 7. "Caliche" for use in the construction of the drill pad and access road shall be obtained from existing authorized pits whenever possible, as determined by the responsible BLM representative. No new pits shall be opened without prior approval from the responsible BLM representative.
- ☒ 8. The "mud pits" shall be well constructed and under no circumstances will they be allowed to leak or be cut to drain. They shall not be located on natural drainages. Waste or discharge of any kind will not be allowed to enter any drainage. Any plastic material used to line pits and/or sumps shall be cut-off below ground level, as far down as possible, and disposed of before the pits are covered. All unattended pits, containing liquids, will be fenced and the liquid portion allowed to evaporate before the pits are broken.
- ☒ 9. All pits found to contain toxic liquids will be fenced and covered with a fine-mesh netting for the protection of wildlife as directed by the responsible BLM representative.

- ☒ 10. All waste associated with the drilling operation will be buried in place (in a separate trash pit) or removed and deposited in an approved sanitary landfill. All garbage (metal containers will be crushed) and debris left on site will be buried at least three feet deep. All trash and debris will be buried or removed from the site within one month after removal of the drill rig. The permittee will comply with all state laws and regulations pertaining to the disposal of human waste.
- ☐ 11. If the well is a producer, during cleanup: all cut and fill banks will be made to be no steeper than _____ slope wherever possible.
- ☒ 12. The well "site", if a producer, will be maintained and kept clean of all trash and litter or other foreign material which detracts from the surrounding environment. Maintenance shall also include measures necessary to stabilize soil conditions (other than reseeding) on the road and pad area, and maintenance of facilities associated with said well, to the satisfaction of the District Manager for the lifetime of the well.
- ☒ 13. In the event the oil or gas test results in a dry hole, the drill pad and access road will be ripped in accordance with "BLM Roswell Districts' Ripping Recommendations for Caliche or Compacted Drill Pads and Access Roads" (3109). (Reseeding of the affected areas may be required at the discretion of the District Manager).
- ☒ 14. All structures above ground not subject to applicable conservation and safety requirements should be painted a non-glare, non-reflective, non-chalking color that simulates the natural colors of the site.
- ☒ 15. Special Stipulations: *Federal standard 595, Color 30318*

"Proposed road" to follow existing road to a point closest to pad site.

ALTERNATE POSITION FOR CHOKE MANIFOLD
MASTER VALVES TO BE FLANGED OR CLAMPED.

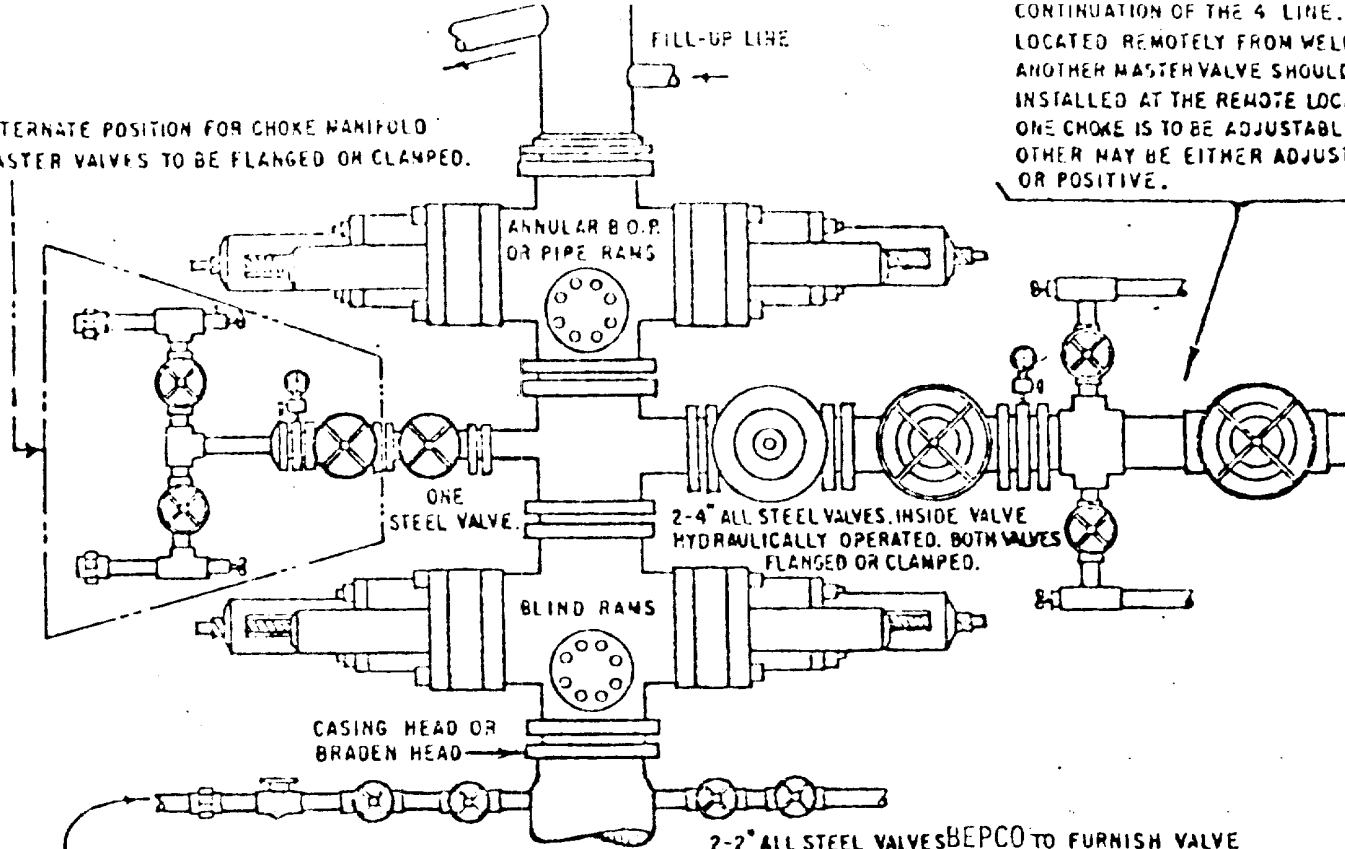

CONTINUATION OF THE 4 LINE.
LOCATED REMOTELY FROM WELL
ANOTHER MASTER VALVE SHOULD
BE INSTALLED AT THE REMOTE LOC
ONE CHOKE IS TO BE ADJUSTABLE
OTHER MAY BE EITHER ADJUST
OR POSITIVE.

THE MUD KILL LINE SHOULD HAVE TWO
STEEL VALVES AND ONE BALL CHECK VALVE. BEPCO
TO FURNISH VALVE NEXT TO HEAD, CONTRACTOR
TO FURNISH ONE VALVE AND CHECK VALVE.

2-2\" ALL STEEL VALVES BEPCO TO FURNISH VALVE
NEXT TO HEAD. CONTRACTOR TO FURNISH ONE VALVE.

THE FOLLOWING CONSTITUTE MINIMUM BLOWOUT PREVENTER REQUIREMENTS

- A. CONDITIONS MAY BE MET BY EITHER
 - (1) AN ANNULAR BLOWOUT PREVENTER ON TOP AND BLIND RAMS BELOW WITH A CHOKE SPOOL BETWEEN THEM.
 - (2) PIPE RAMS ON TOP AND BLIND RAMS BELOW WITH A CHOKE SPOOL BETWEEN THEM.
 - (3) A DUAL BLOWOUT PREVENTER WITH PIPE RAMS ON TOP AND BLIND RAMS BELOW WITH A SIDE OUTLET BETWEEN THE RAMS LEAST FOUR INCHES DIAMETER.
- B. OPENINGS BETWEEN RAMS TO BE FLANGED, STUDDED OR CLAMPED.
- C. ALL CONNECTIONS FROM OPERATING MANIFOLD TO PREVENTERS TO BE ALL STEEL HOSE OR TUBE A MINIMUM OF ONE INCH IN DIA
- D. THE AVAILABLE CLOSING PRESSURE SHALL BE AT LEAST 15% IN EXCESS OF THAT REQUIRED WITH SUFFICIENT VOLUME TO OPE THE B.O.P's.
- E. ALL CONNECTIONS TO AND FROM PREVENTERS TO HAVE A PRESSURE RATING EQUIVALENT TO THAT OF THE B.O.P's.
- F. MANUAL CONTROLS TO BE INSTALLED BEFORE DRILLING CEMENT PLUG.
- G. KELLY COCK TO BE INSTALLED ON KELLY.
- H. INSIDE BLOWOUT PREVENTER TO BE AVAILABLE ON RIG FLOOR.

DEPCO III
TWO CLOSURE HYDRAULIC BLOWOUT PREVENTERS

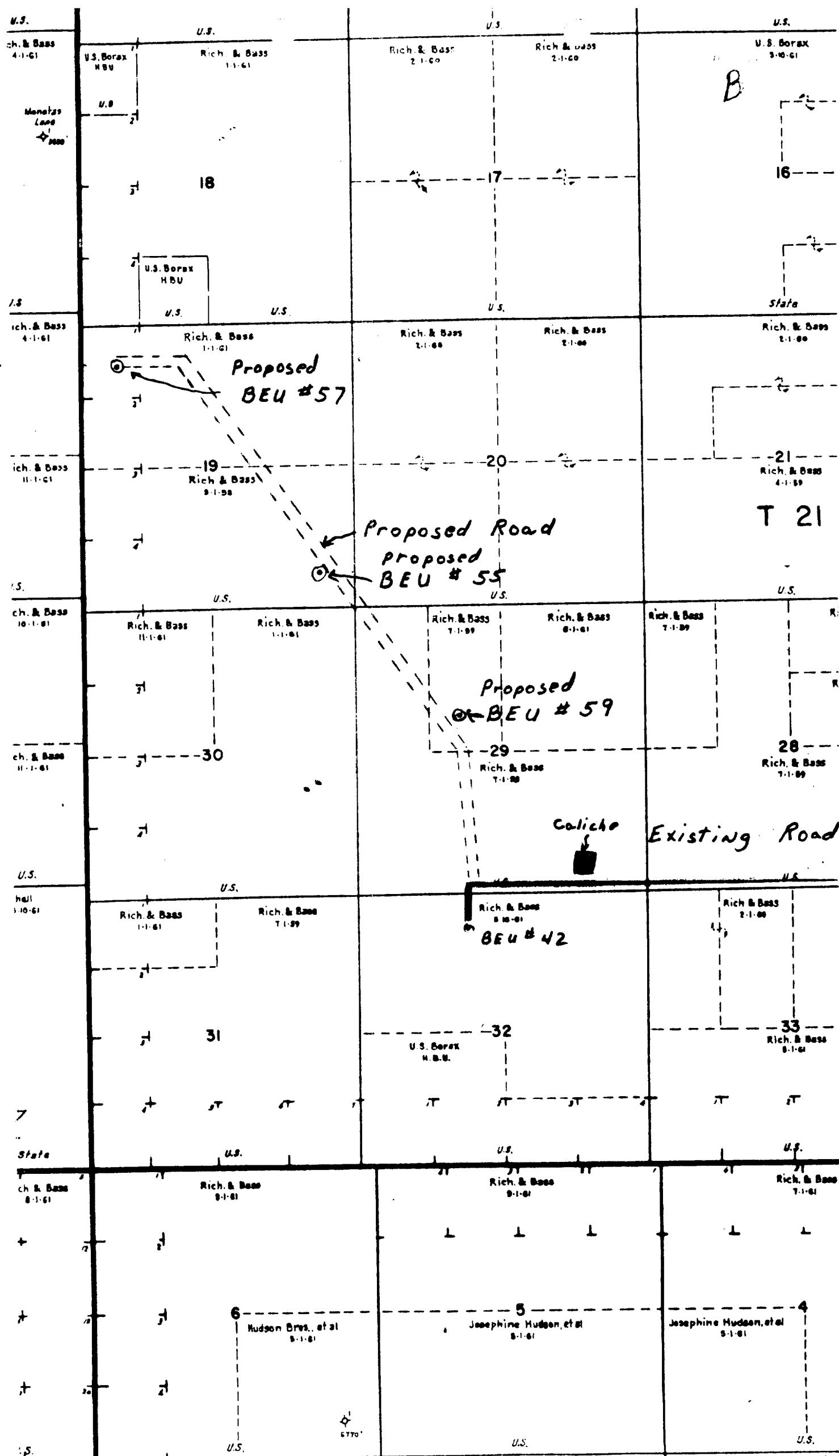

"C"

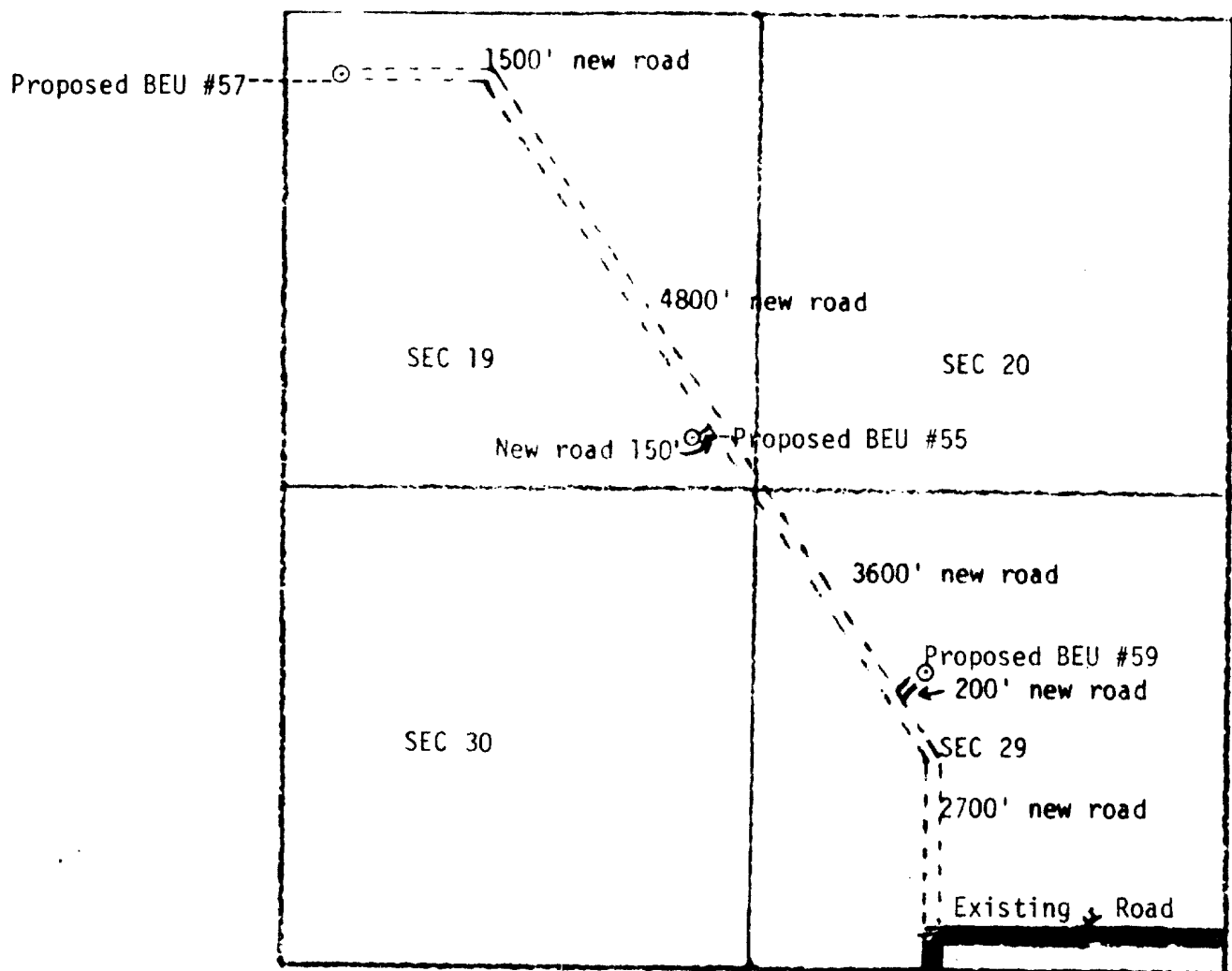

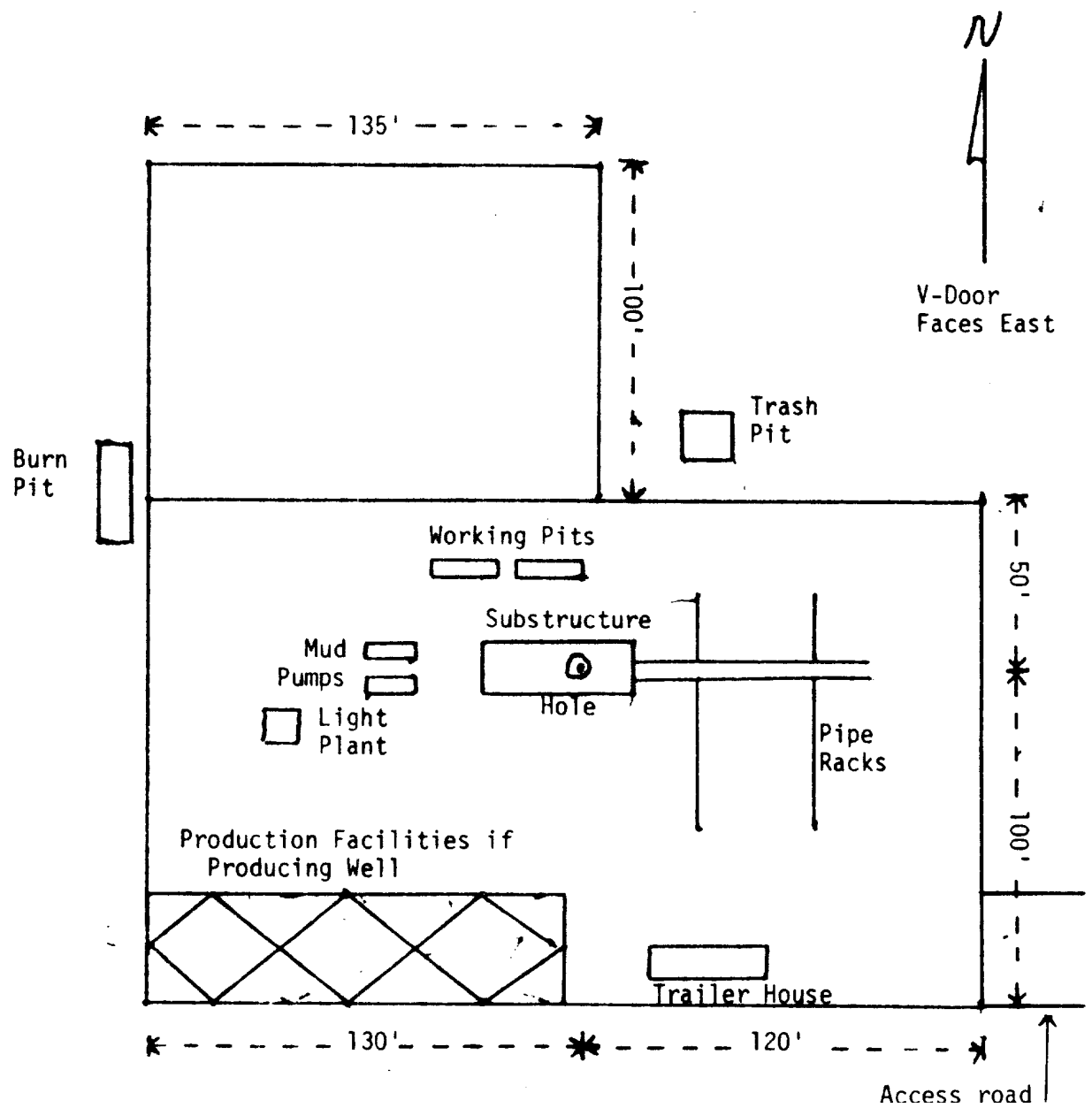

BIG EDDY UNIT #55
ANTICIPATED FORMATION MARKERS

Delaware Mtn Gp	(+270)	3000'
Indian Draw Sand	(-570)	3840'
Cherry Canyon	(-1150)	4420'
Brushy Canyon	(-2330)	5600'
Bone Springs	(-3300)	6570'