

NEW MEXICO OIL CONSERVATION COMMISSION
REQUEST FOR ALLOWABLE
AND
AUTHORIZATION TO TRANSPORT OIL AND NATURAL GAS

Form C-104
Supersedes Old C-104 and C-11
Effective 1-1-65

RECEIVED

OCT 13 1978

O. C. C.
ARTESIA, OFFICE

NO. OF COPIES RECEIVED	5
DISTRIBUTION	
SALE & EC	/
FILE	/
U.S.G.S.	
LAND OFFICE	
TRANSPORTER	OIL / GAS /
OPERATOR	/
PROBATION OFFICE	

Operator
Yates Petroleum Corporation ✓

Address
207 South 4th Street - Artesia, NM 88210

Reason(s) for filing (Check proper box)
New Well ☒ Change in Transporter of:
Recompletion ☐ Oil ☐ Dry Gas ☐
Change in Ownership ☐ Casinghead Gas ☐ Condensate ☐

Other (Please explain)
Corrected Pool Designation to Undes. Strawn.

If change of ownership give name and address of previous owner

I. DESCRIPTION OF WELL AND LEASE

Lease Name **Huber "IA" Federal** Well No. **2** Pool Name, Including Formation **Box Canyon Strawn Gas** Kind of Lease **NM 13968** Lease No.
State, Federal or Fee **Fed.**

Location
Unit Letter **P**; **660** Feet From The **South** Line and **1270** Feet From The **East**
Line of Section **15** Township **21S** Range **21E**, NMPM, **Eddy** County

I. DESIGNATION OF TRANSPORTER OF OIL AND NATURAL GAS

Name of Authorized Transporter of Oil ☐ or Condensate ☒
Navajo Crude Oil Purchasing Company Address (Give address to which approved copy of this form is to be sent)
North Freeman Ave. - Artesia, NM 88210

Name of Authorized Transporter of Casinghead Gas ☐ or Dry Gas ☒
El Paso Natural Gas Pipeline Company Address (Give address to which approved copy of this form is to be sent)
P.O. Box 1384, Jal, NM 88252

If well produces oil or liquids, give location of tanks. Unit **P** Sec. **15** Twp. **21S** Rge. **21E** Is gas actually connected? **Yes** When **8-9-78**

If this production is commingled with that from any other lease or pool, give commingling order number:

II. COMPLETION DATA

Designate Type of Completion - (X) Oil Well Gas Well New Well Workover Deepen Plug Back Same Res'tv. Diff. Res'tv.
X

Date Spudded **7-18-77** Date Compl. Ready to Prod. **4-6-78** Total Depth **8050'** P.B.T.D. **6900'**

Elevations (DF, RKB, RT, GR, etc.) **4549' GR** Name of Producing Formation **Strawn** Top Oil/Gas Pay **6790'** Tubing Depth **6749'**

Perforations **6790-96'** Depth Casing Shoe **7717'**

TUBING, CASING, AND CEMENTING RECORD

HOLE SIZE	CASING & TUBING SIZE	DEPTH SET	SACKS CEMENT
17 1/2"	13 3/8"	260'	12 Yds Ready-Mix
12 1/4"	8 5/8"	1303'	400
7 7/8"	5 1/2"	7717'	630
	2 3/8"	6749'	

TEST DATA AND REQUEST FOR ALLOWABLE OIL WELL (Test must be after recovery of total volume of load oil and must be equal to or exceed top allowable for this depth or be for full 24 hours)

Date First New Oil Run To Tanks	Date of Test	Producing Method (Flow, pump, gas lift, etc.)	
Length of Test	Tubing Pressure	Casing Pressure	Choke Size
Actual Prod. During Test	Oil - Bbls.	Water - Bbls.	Gas - MCF

GAS WELL

Actual Prod. Test - MCF/D	Length of Test	Bbls. Condensate/MMCF	Gravity of Condensate
840	24		
Testing Method (prior, back pr.)	Tubing Pressure (Shut-in)	Casing Pressure (Shut-in)	Choke Size
Back Pressure	1925	pkc.	3/4"

CERTIFICATE OF COMPLIANCE

I hereby certify that the rules and regulations of the Oil Conservation Commission have been complied with and that the information given above is true and complete to the best of my knowledge and belief.

(Signature)

Eddie Mahfood, Engineer

(Title)

October 13, 1978

(Date)

OIL CONSERVATION COMMISSION

APPROVED **OCT 17 1978**, 19

BY **W. A. Gressett**

TITLE **SUPERVISOR, DISTRICT II**

This form is to be filed in compliance with RULE 1104.

If this is a request for allowable for a newly drilled or deepened well, this form must be accompanied by a tabulation of the deviation tests taken on the well in accordance with RULE 111.

All sections of this form must be filled out completely for allowable on new and recompleted wells.

Fill out only Sections I, II, III, and VI for changes of owner, well name or number, or transporter, or other such change of condition.

NE EXICO OIL CONSERVATION COMMISSION
WELL LOCATION AND ACREAGE DEDICATION PLAT

Form C-102
Supersedes C-128
Effective 1-1-65

All distances must be from the outer boundaries of the Section.

Operator YATES PETROLEUM CORP			Lease Huber 1A FEDERAL		Well No. 2
Dist Letter P	Section 15	Township 21S	Range 21E	County EDDY	
Actual Point-to-Point Distance of Well: 660 feet from the South line and 1270 feet from the East line					
Ground Level Elev. 4549	Producing Formation Strawn		Pool und. Strawn	Dedicated Acreage: 320 Acres	

1. Outline the acreage dedicated to the subject well by colored pencil or hatchure marks on the plat below.
2. If more than one lease is dedicated to the well, outline each and identify the ownership thereof (both as to working interest and royalty).
3. If more than one lease of different ownership is dedicated to the well, have the interests of all owners been consolidated by communitization, unitization, force-pooling, etc?

☐ Yes ☐ No If answer is "yes," type of consolidation _____

RECEIVED

If answer is "no," list the owners and tract descriptions which have actually been consolidated. (Use reverse side of this form if necessary.) _____

No allowable will be assigned to the well until all interests have been consolidated (by communitization, unitization, forced-pooling, or otherwise) or until a non-standard unit, eliminating such interests, has been approved by the Commission.

CERTIFICATION

I hereby certify that the information contained herein is true and complete to the best of my knowledge and belief.

Name
EDDIE M. MAHFODD
Position
ENGINEER
Company
YATES PETROLEUM CORP
Date
10-13-78

I hereby certify that the well location shown on this plat was plotted from field notes of actual surveys made by me or under my supervision, and that the same is true and correct to the best of my knowledge and belief.

Date Surveyed
Refer to Original Plat
Registered Professional Engineer and/or Land Surveyor

Plat Title No.

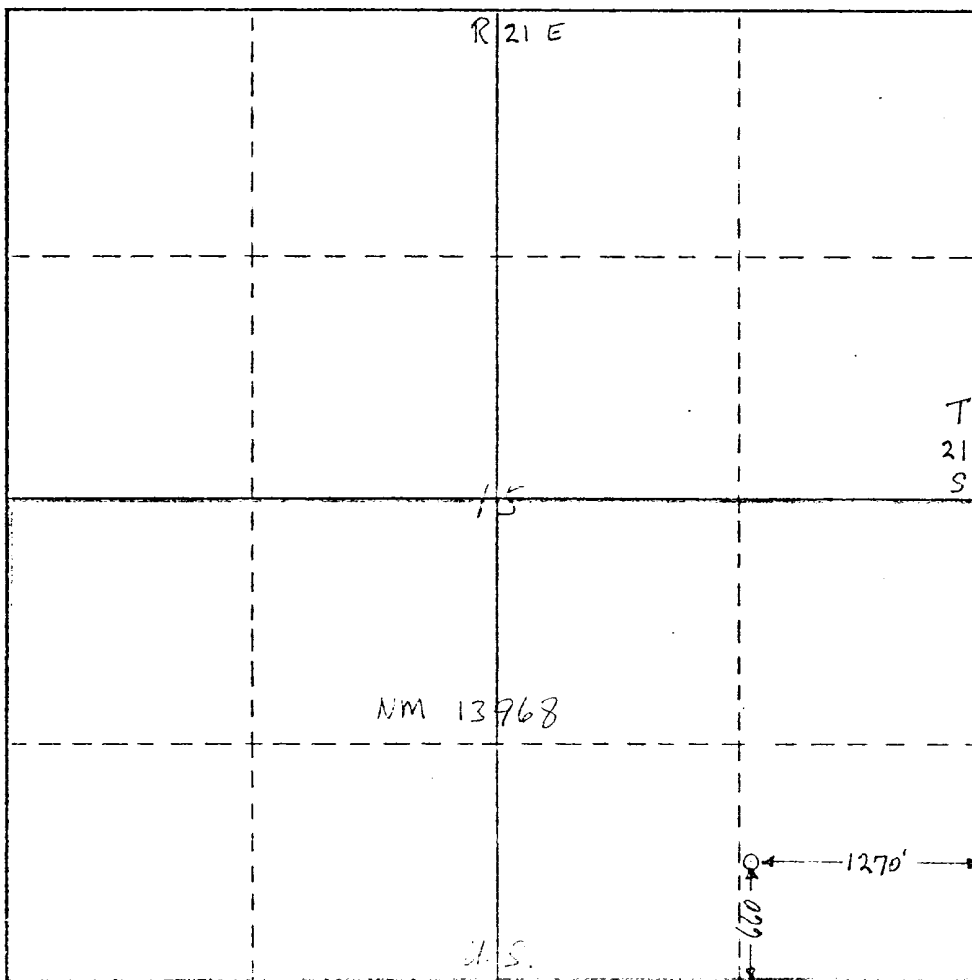

0 330 660 990 1320 1650 1980 2310 2640 2000 1500 1000 500 0