

NEW MEXICO OIL CONSERVATION COMMISSION
WELL LOCATION AND ACREAGE DEDICATION PLAT

Form C-100
Supersedes C-128
Effective 1-1-65

All distances must be from the outer boundaries of the Section.

Owner MONSANTO COMPANY			Locality Catclaw Federal		Well No. 1
Section G	Distance 10	Township 22-S	Range 25-E	County Eddy	

Actual Footprint Location of Well: 1980 feet from the North line and 1980 feet from the East line	
Actual Footprint Location: FURNISH LATER	Dedicated Acreage: 288

- Outline the acreage dedicated to the subject well by colored pencil or hatchure marks on the plat below.
- If more than one lease is dedicated to the well, outline each and identify the ownership thereof (both as to working interest and royalty).
- If more than one lease of different ownership is dedicated to the well, have the interests of all owners been consolidated by communitization, unitization, force-pooling, etc?

RECEIVED

JUL 26 1977

☐ Yes ☐ No If answer is "yes," type of consolidation _____
If answer is "no," list the owners and tract descriptions which have actual interest in the well (Use reverse side of this form if necessary.) _____

**U.S. GEOLOGICAL SURVEY
ARTESIA, NEW MEXICO**

No allowable will be assigned to the well until all interests have been consolidated (by communitization, unitization, forced-pooling, or otherwise) or until a non-standard unit, eliminating such interests, has been approved by the Commission.

288 ACRES

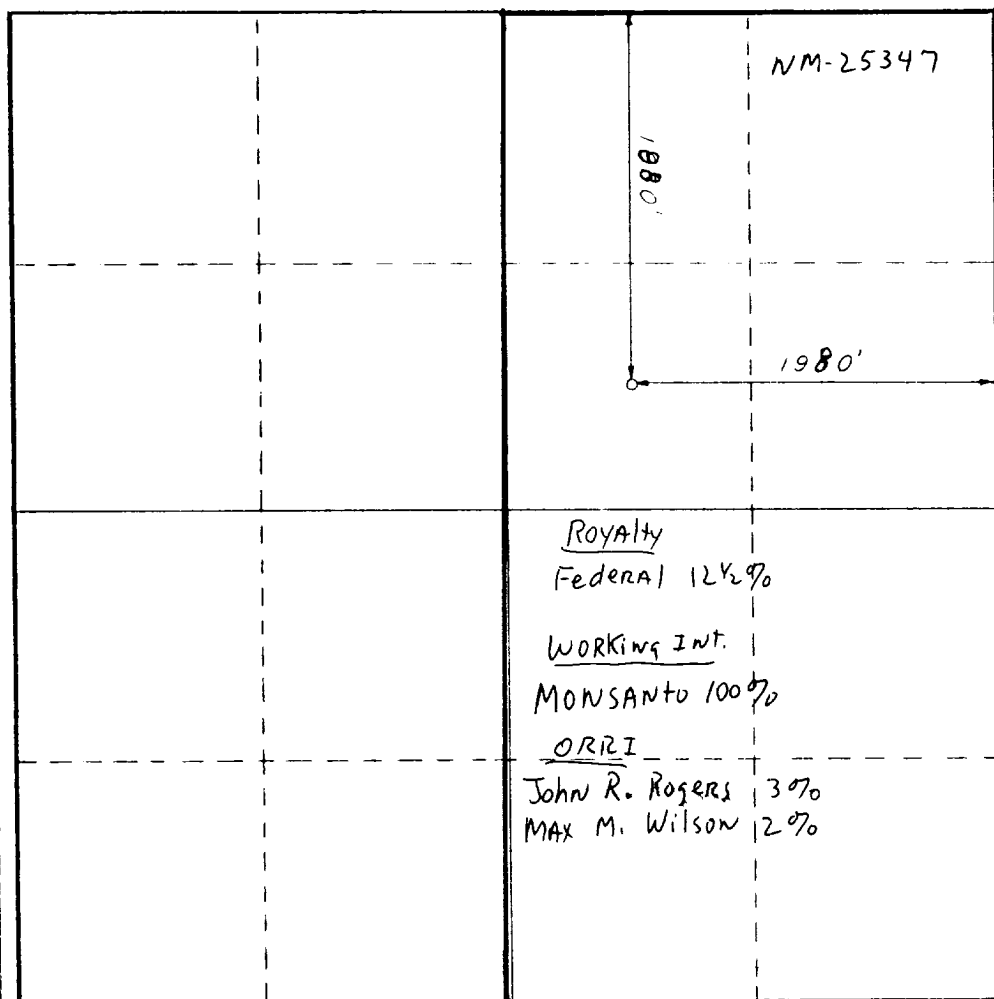

CERTIFICATION

I hereby certify that the information contained herein is true and complete to the best of my knowledge and belief.

W. B. Schall

Regional Prod. MNGR.

MONSANTO CO.

July 15, 1977

Date

I hereby certify that the well location shown on this plat was plotted from field notes of actual surveys made by me or under my supervision, and that the same is true and correct to the best of my knowledge and belief.

July 15, 1977

Date Surveyed

Richard B. Duniven

Registered Professional Engineer and/or Land Surveyor

Richard B. Duniven

Certificate No. 4882

330 660 990 1320 1650 1980 2310 2640 2000 1500 1000 500 0