

NO. OF COPIES RECEIVED	6
DISTRIBUTION	
ANTA FE	1
FILE	1
U.S.G.S.	2
LAND OFFICE	1
OPERATOR	1

NEW MEXICO ENGINEERING COMMISSION

SEP 10 1977

O. C. C.
ARTESIA, OFFICE

30-015-22299
Form C-101
Revised 1-1-65

5A. Indicate Type of Lease
STATE <input checked="" type="checkbox"/> FEE <input type="checkbox"/>
5. State Oil & Gas Lease No.
L-487

APPLICATION FOR PERMIT TO DRILL, DEEPEN, OR PLUG BACK

1a. Type of Work		7. Unit Agreement Name	
b. Type of Well DRILL <input checked="" type="checkbox"/> DEEPEN <input type="checkbox"/> PLUG BACK <input type="checkbox"/> OIL WELL <input type="checkbox"/> GAS WELL <input checked="" type="checkbox"/> OTHER <input type="checkbox"/> SINGLE ZONE <input type="checkbox"/> MULTIPLE ZONE <input type="checkbox"/>		8. Farm or Lease Name State "EP" COM	
2. Name of Operator Amoco Production Company		9. Well No. 1	
3. Address of Operator P. O. Drawer A, Levelland, Texas 79336		10. Field and Pool, or Wildcat Burton Flat	
4. Location of Well UNIT LETTER J LOCATED 1980 FEET FROM THE South LINE AND 1980 FEET FROM THE East LINE OF SEC. 21 TWP. 20 RGE. 28 NMPM		12. County Eddy	
21. Elevations (Show whether DF, RT, etc.) 3235.9		19. Proposed Depth 11,500'	19A. Formation Morrow
21A. Kind & Status Plug. Bond Blanket - On File	21B. Drilling Contractor NA	20. Rotary or C.T. Rotary	
22. Approx. Date Work will start October 1, 1977			

PROPOSED CASING AND CEMENT PROGRAM

SIZE OF HOLE	SIZE OF CASING	WEIGHT PER FOOT	SETTING DEPTH	SACKS OF CEMENT	EST. TOP
17 1/2"	13 3/8	48#	400'	Circ to Surf	Surf
12 1/4"	9 5/8	36#	3000'	Circ to Surf	Surf
8 3/4"	5 1/2"	15.5 & 17#	11500'	Sufficient to tie back to 9 5/8" csg.	Btm of 9 5/8" csg.

Propose to drill and equip Morrow well at 11,500. Attempt completion by perforating and stimulating as necessary.

Mud Program: 0 - 400' - Native Mud and Water
400' - 3000' - Native Mud and brine water
3000' - 11,500' - Brine water and commercial mud with additives to maintain 34-40 viscosity

BOP Program attached.
Gas is not committed

APPROVAL VALID
FOR 90 DAYS UNLESS
DRILLING COMMENCED,

EXPIRES 12-20-77

IN ABOVE SPACE DESCRIBE PROPOSED PROGRAM: IF PROPOSAL IS TO DEEPEN OR PLUG BACK, GIVE DATA ON PRESENT PRODUCTIVE ZONE AND PROPOSED NEW PRODUCTIVE ZONE. GIVE BLOWOUT PREVENTER PROGRAM, IF ANY.

I hereby certify that the information above is true and complete to the best of my knowledge and belief.

Signed Ray W. Cox Title Administrative Assistant Date 9-16-77

(This space for State Use)

APPROVED BY W.A. Gressett TITLE SUPERVISOR, DISTRICT II DATE SEP 20 1977

CONDITIONS OF APPROVAL, IF ANY:

Cement must be circulated to

Notify N.M.O.C.C. in sufficient time to witness cementing the 9 5/8" casing

0 + 4 - NMOCC, Art. 1 - RC surface behind 13 3/8" + 9 5/8" casing
1 - Div. 1 - Petroleum Reserve Corp.
1 - Casing

NEW MEXICO OIL CONSERVATION COMMISSION
WELL LOCATION AND ACREAGE DEDICATION PLAT

Form 1-77
Supersedes 1-72
Effective 1-78

All distances must be from the outer boundaries of the Section

Operator AMOCO PRODUCTION CO.			Lease STATE E.P. COM.			Well No. 1		
Section J	Section 21	Range 20 South	Range 28 East	County Eddy				
Actual Section Location of Well								
1980 feet from the South			1980 feet from the East					
Ground Level Elev 3235.9		Elevation of Morrow MORROW		Elevation of Burton Flat Morrow BURTON FLAT MORROW			Elevation of Morrow 320	

1. Outline the acreage dedicated to the subject well by colored pencil or hachure marks on the plat below.
2. If more than one lease is dedicated to the well, outline each and identify the ownership thereof (both as to working interest and royalty).
3. If more than one lease of different ownership is dedicated to the well, have the interests of all owners been consolidated by communitization, unitization, force-pooling, etc?

☒ Yes ☐ No If answer is "yes," type of consolidation **Communitization**

If answer is "no," list the owners and tract descriptions which have actually been consolidated (Use reverse side of this form if necessary.)

No allowable will be assigned to the well until all interests have been consolidated (by communitization, unitization, forced-pooling, or otherwise) or until a non-standard unit, eliminating such interests, has been approved by the Commission.

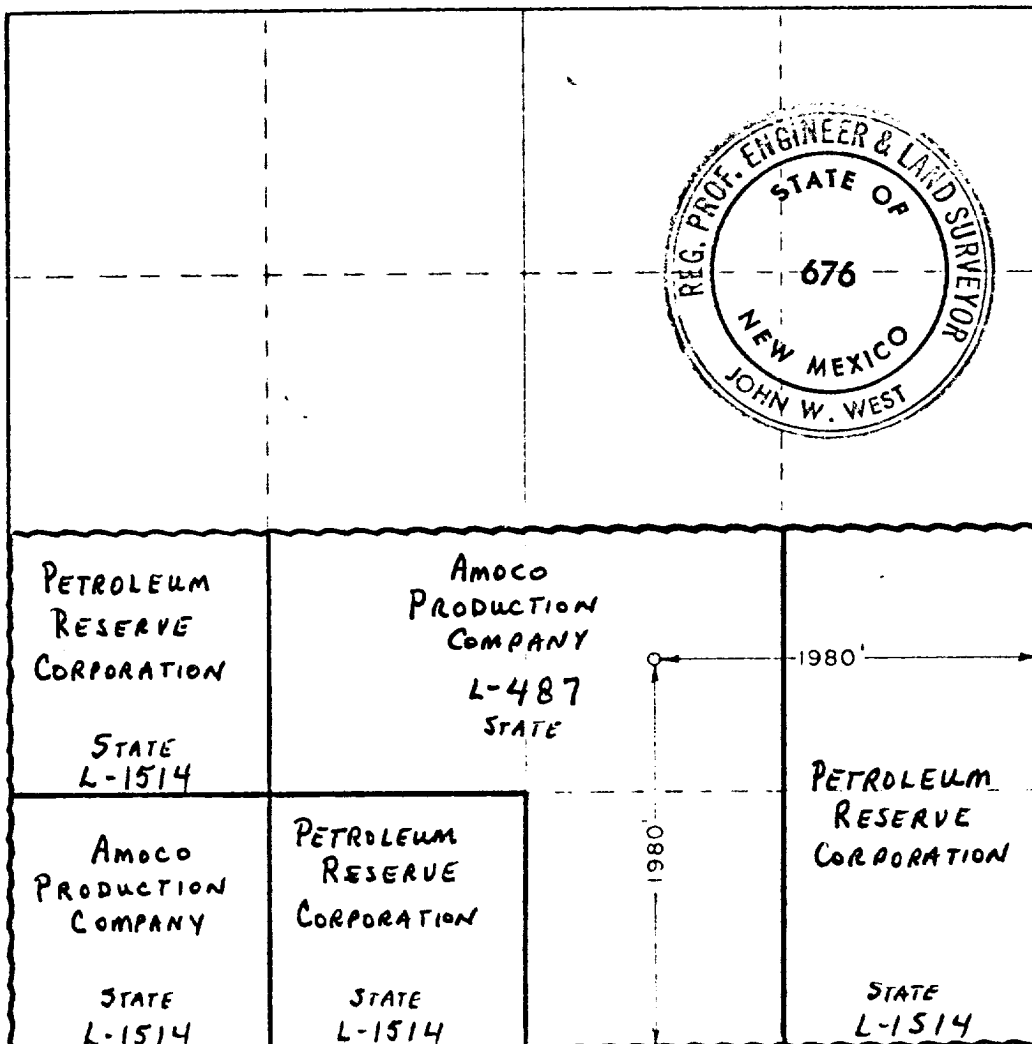

CERTIFICATION

I hereby certify that the information contained herein is true and complete to the best of my knowledge and belief

Name **Ray W. Cox**
Position **Administrative Assistant**
Company **AMOCO PRODUCTION COMPANY**
Date **9-16-77**

I hereby certify that the well location shown on this plat was plotted from field notes of actual surveys made by me or under my supervision, and that the same is true and correct to the best of my knowledge and belief

Date of Survey **September 1, 1977**
Registered Professional Engineer
and Land Surveyor
John W. West
676

ATTACHMENT "B"
NOTES

1. Blow-out preventers and master valve to be fluid operated and all fittings must be in good condition, 3,000# W.P. (6,000 p.s.i. test), minimum.
2. Equipment through which bit must pass shall be as large as the inside diameter of the casing that is being drilled through.
3. Nipple above blow-out preventer shall be same size as casing being drilled through.
4. Kelly cock required, 3,000# W.P. (6,000 p.s.i. test), minimum.
5. OMSCO or comparable safety valve must be available on rig floor at all times with proper connection or sub, 3,000# W.P. (6,000 p.s.i. test), minimum.
6. Blow-out preventers and master valve while drilling intermediate hole to 6,000' may be 2,000# W.P. (4,000 p.s.i. test), minimum.
7. Choke assembly, beyond second valve from cross, may be positioned (Optional) outside of derrick foundation.
8. Spool or cross may be eliminated if connections are available in the lower part of the blow-out preventer body.
9. Plug valves - gate valves are optional. Valves shown as 2" are minimum size.
10. Casing head and casing head spool, including attached valves, to be furnished by Pan American.
11. Rams in preventers will be installed as follows:

When drilling, use:	When running casing, use:
Top Preventer - Drill pipe rams	Top Preventer - Casing rams
Bottom Preventer - Blind rams or master valve	Bottom Preventer - Blind rams or master valve.

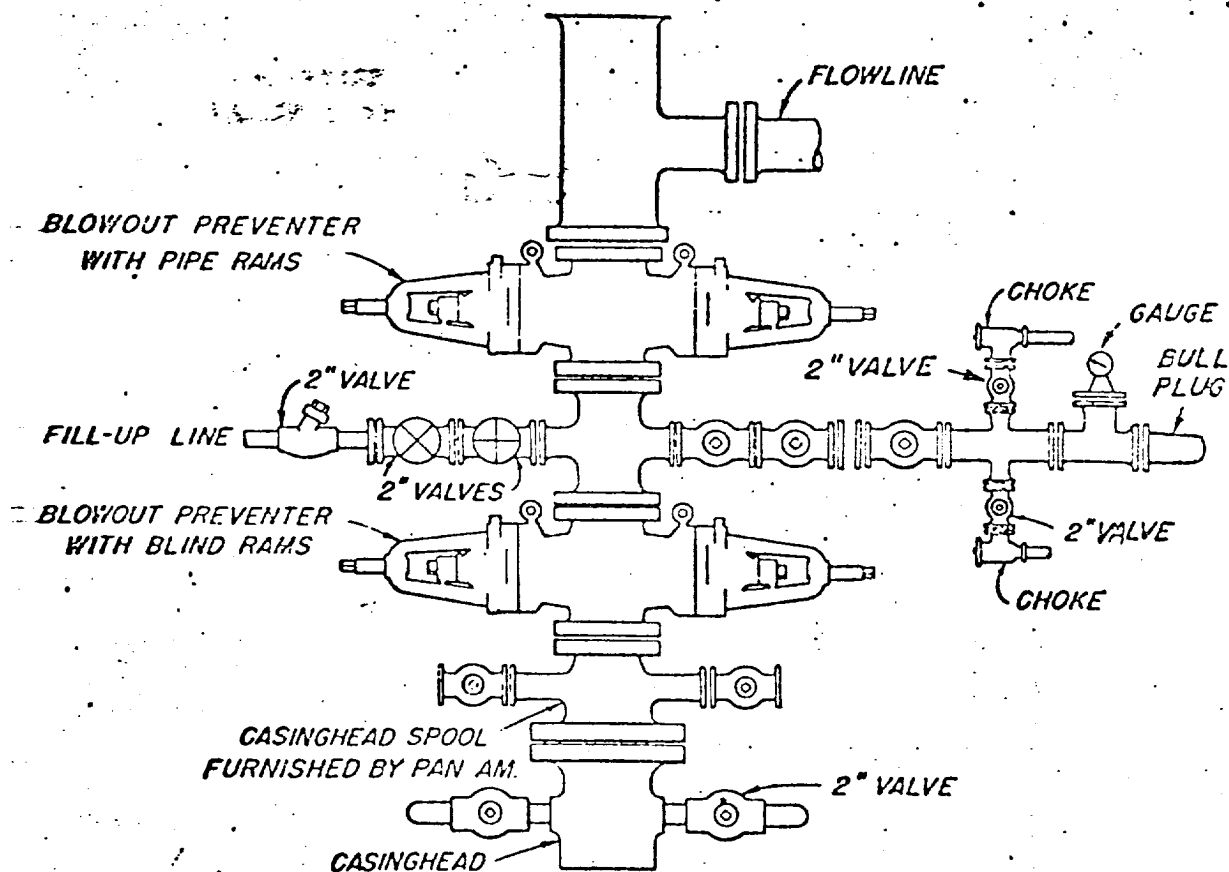

BLOWOUT PREVENTER HOOK-UP
PAN AMERICAN PETROLEUM CORP.

EXHIBIT D-I MODIFIED

JUNE 1, 1962