

NO. OF COPIES RECEIVED	
DISTRIBUTION	
SANTA FE	1
FILE	1
U.S.G.S.	
LAND OFFICE	1
OPERATOR	1

## NEW MEXICO OIL CONSERVATION COMMISSION

RECEIVED

DEC 18 1981

O. C. D.

Form C-101  
Revised 1-1-65

5A. Indicate Type of Lease

STATE ☒ FEE ☐

5. State Oil &amp; Gas Lease No.

L-487

## APPLICATION FOR PERMIT TO DRILL, DEEPEN, OR PLUG BACK

1a. Type of Work		7. Unit Agreement Name	
b. Type of Well DRILL <input type="checkbox"/> DEEPEN <input type="checkbox"/> PLUG BACK <input checked="" type="checkbox"/> OIL WELL <input checked="" type="checkbox"/> GAS WELL <input type="checkbox"/> SINGLE ZONE <input type="checkbox"/> MULTIPLE ZONE <input type="checkbox"/>		8. Farm or Lease Name State EP Com.	
2. Name of Operator Amoco Production Company /		9. Well No. 1	
3. Address of Operator P. O. Box 68, Hobbs, NM 88240		10. Field and Pool, or Wildcat Wolfcamp	
4. Location of Well UNIT LETTER J LOCATED 1980 FEET FROM THE South LINE AND 1980 FEET FROM THE East LINE OF SEC. 21 TWP. 20-S RGE 28-E NMPM		12. County Eddy	
19. Proposed Depth		19A. Formation Wolfcamp	
21. Elevations (Show whether OF, RT, etc.) 3235.9 GR		22. Approx. Date Work will start	
21A. Kind & Status Plug. Bond Blanket-on-file			

23.

## PROPOSED CASING AND CEMENT PROGRAM

SIZE OF HOLE	SIZE OF CASING	WEIGHT PER FOOT	SETTING DEPTH	SACKS OF CEMENT	EST. TOP
17-1/2	13-3/8	48#	397'	400	Surf.
12-1/4	9-5/8	36#	2980'	2100	450
8-3/4	5-1/2	17#	11458'	2400	4650

Propose to abandon Strawn and recomplete to Wolfcamp. Move in service unit, kill well with 10# brine. Pull 2-3/8 tubing and packer. Go in hole with CIBP set at 10100' cap with 35' cement. Pressure test plug. Perforate Wolfcamp intervals 9254'-64', 9426'-34', 9512'-20', with 4 JSPF. Go in hole with tubing (tested to 6500 PSI) and packer, set packer at 9140'. Flow test. If well won't flow acidize with 1000 gallons 20% NEFE flush to perfs with 50 barrels 2% KCL. Flow test.

0+4-NMOCD, A 1-Hou 1-Susp 1-W. Stafford, Hou 1-DMF

IN ABOVE SPACE DESCRIBE PROPOSED PROGRAM; IF PROPOSAL IS TO DEEPEN OR PLUG BACK, GIVE DATA ON PRESENT PRODUCTIVE ZONE AND PROPOSED NEW PRODUCTIVE ZONE. GIVE BLOWOUT PREVENTER PROGRAM, IF ANY.

I hereby certify that the information above is true and complete to the best of my knowledge and belief.

Signed Mark L. Lerner Title Assist. Admin. Analyst Date 12-17-81

(This space for State Use)

APPROVED BY W. A. Gressett TITLE SUPERVISOR, DISTRICT II DATE JAN 11 1982

CONDITIONS OF APPROVAL, IF ANY:

**NEW MEXICO OIL CONSERVATION COMMISSION**  
**WELL LOCATION AND ACREAGE DEDICATION**

Form C-102  
 Supersedes C-128  
 Effective 1-1-65

All distances must be from the outer boundaries of the Section.

Operator <b>Amoco Production Company</b>			Lease <b>State EP Com</b>		Well No. <b>1</b>
Unit Letter <b>J</b>	Section <b>21</b>	Township <b>20-S</b>	Range <b>28E</b>	County <b>Eddy</b>	
Actual Footage Location of Well: <b>1980</b> feet from the <b>South</b> line and <b>1980</b> feet from the <b>East</b> line					
Ground Level Elev. <b>3235.9</b>	Producing Formation <b>Wolfcamp</b>		Pool <b>N. Burtor Flats Wildcat Wolfcamp</b>		Dedicated Acreage: <b>320</b>

1. Outline the acreage dedicated to the subject well by colored pencil or hatchure marks on the plat below.
2. If more than one lease is dedicated to the well, outline each and identify the ownership thereof (both as to working interest and royalty).
3. If more than one lease of different ownership is dedicated to the well, have the interests of all owners been consolidated by communitization, unitization, force-pooling, etc?

☐ Yes    ☐ No    If answer is "yes," type of consolidation \_\_\_\_\_

If answer is "no," list the owners and tract descriptions which have actually been consolidated. (Use reverse side of this form if necessary.) \_\_\_\_\_

No allowable will be assigned to the well until all interests have been consolidated (by communitization, unitization, forced-pooling, or otherwise) or until a non-standard unit, eliminating such interests, has been approved by the Commission.

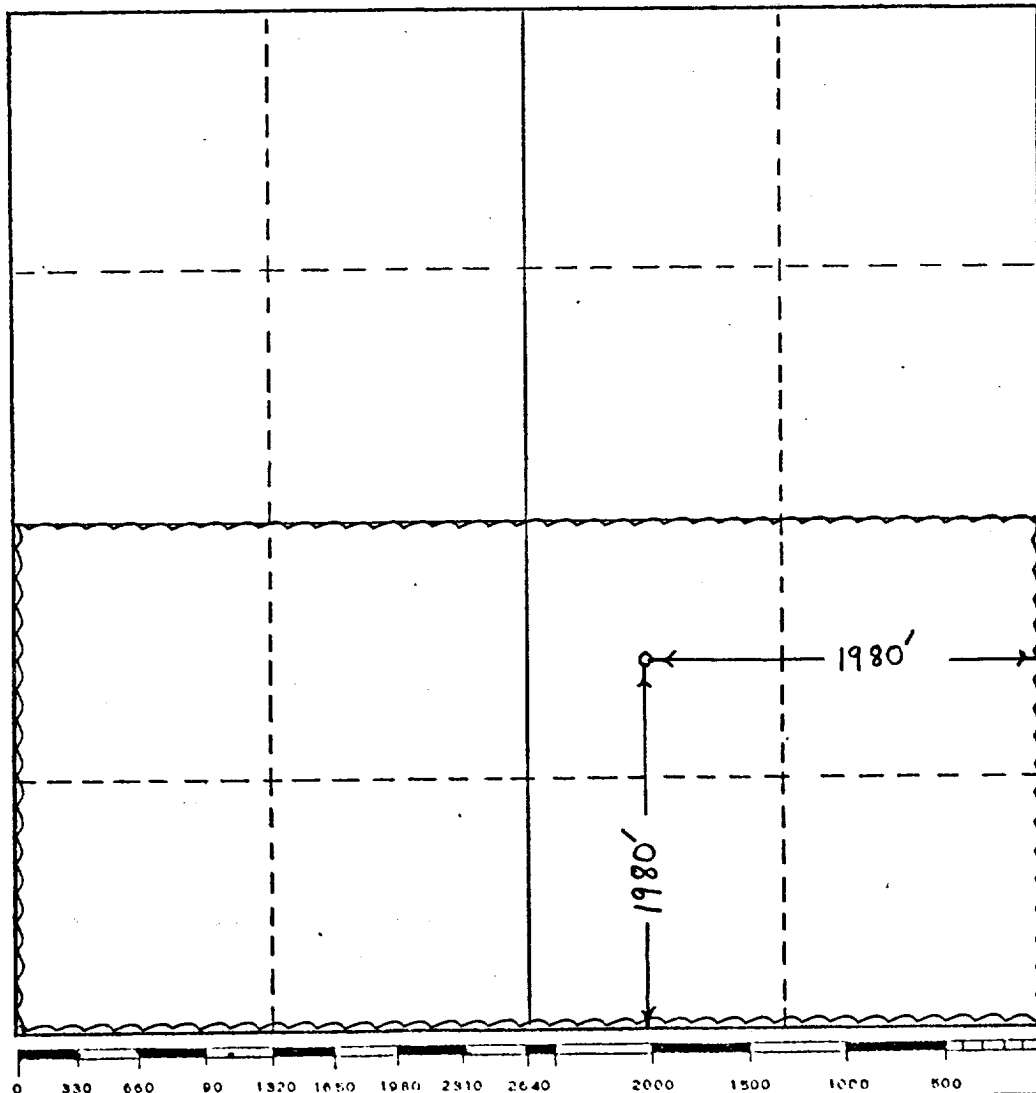

**CERTIFICATION**

I hereby certify that the information contained herein is true and complete to the best of my knowledge and belief.

Name **Mark Freeman**  
 Position **Assist. Admin. Analyst**  
 Company **Amoco Production Company**  
 Date **January 5, 1982**

I hereby certify that the well location shown on this plat was plotted from field notes of actual surveys made by me or under my supervision, and that the same is true and correct to the best of my knowledge and belief.

Date Surveyed \_\_\_\_\_  
 Registered Professional Engineer and/or Land Surveyor \_\_\_\_\_  
 Certificate No. \_\_\_\_\_