

NO. OF COPIES RECEIVED	
DISTRIBUTION	
SANTA FE	<input checked="" type="checkbox"/>
FILE	<input checked="" type="checkbox"/>
U.S.G.S.	
LAND OFFICE	<input checked="" type="checkbox"/>
OPERATOR	<input checked="" type="checkbox"/>

NEW MEXICO OIL CONSERVATION COMMISSION **RECEIVED**

Form C-101
Revised 1-1-65

DEC 09 '88

O.C.D.

5A. Indicate Type of Lease	
STATE <input checked="" type="checkbox"/>	FEE <input type="checkbox"/>
5. State Oil & Gas Lease No.	
L-4995	

APPLICATION FOR PERMIT TO DRILL, DEEPEN, OR PLUG BACK

1a. Type of Work				7. Unit Agreement Name	
b. Type of Well DRILL <input type="checkbox"/> DEEPEN <input type="checkbox"/> PLUG BACK <input type="checkbox"/> OIL WELL <input type="checkbox"/> GAS WELL <input checked="" type="checkbox"/> OTHER RECOMPLETE <input type="checkbox"/> SINGLE ZONE <input type="checkbox"/> MULTIPLE ZONE <input type="checkbox"/>				8. Firm or Lease Name Cities JH State	
2. Name of Operator Yates Petroleum Corporation ✓				9. Well No. 1	
3. Address of Operator 105 South 4th St., Artesia, NM 88210				10. Field and Pool, or Wildcat Undesignated Strawn Box Canyon Strawn	
4. Location of Well UNIT LETTER <u>E</u> LOCATED <u>2205</u> FEET FROM THE <u>North</u> LINE AND <u>660</u> FEET FROM THE <u>West</u> LINE OF SEC. <u>36</u> TWP. <u>21S</u> RGE. <u>21E</u> NMPM				12. County Eddy	
				19. Proposed Depth LTD 8895'	
				19A. Formation Strawn	
				20. Rotary or C.T. Reverse Unit	
21. Elevations (Show whether DF, RT, etc.) 4612' GR		21A. Kind & Status Plug. Bond Blanket		22. Approx. Date Work will start When approved	

PROPOSED CASING AND CEMENT PROGRAM

SIZE OF HOLE	SIZE OF CASING	WEIGHT PER FOOT	SETTING DEPTH	SACKS OF CEMENT	EST. TOP
17 1/2"	13-3/8"	61#	111'	100 sx (in place)	
12 1/2"	8-5/8"	24#	1557'	1190 sx (in place)	
7-7/8"	5 1/2"	17 & 15.5#	8748'	560 sx (in place)	

Propose to temporarily abandon present completion in Cisco perms 5953-58', 6035-40', 6171-73' and Wolfcamp perms 5851-53' (blanked off in annulus) and recomplete in Strawn sand at 7519-29' and lime stringer at 7413-16'. Will stimulate as needed for production. Will consider perforating and stimulating Canyon lime at 6420-56'. Will return to Permo Penn zone at a later date.

APPROVAL VALID FOR 180 DAYS
PERMIT EXPIRES 6/12/89
UNLESS DRILLING UNDERWAY

IN ABOVE SPACE DESCRIBE PROPOSED PROGRAM: IF PROPOSAL IS TO DEEPEN OR PLUG BACK, GIVE DATA ON PRESENT PRODUCTIVE ZONE AND PROPOSED NEW PRODUCTIVE ZONE. GIVE BLOWOUT PREVENTER PROGRAM, IF ANY.

I hereby certify that the information above is true and complete to the best of my knowledge and belief.

Signed Guillermo S. Salas Title Production Supervisor Date 12-7-88

(This space for State Use)

Original Signed By
Mike Williams

APPROVED BY _____ TITLE _____ DATE DEC 19 1988

CONDITIONS OF APPROVAL, IF ANY:

OIL CONSERVATION DIVISION

STATE OF NEW MEXICO
ENERGY AND MINERALS DEPARTMENTP. O. BOX 2088
SANTA FE, NEW MEXICO 87501Form C-102
Revised 10-1-78

All distances must be from the outer boundaries of the Section.

Operator Yates Petroleum Corporation			Lease Cities JH State		Well No. 1
Unit Letter E	Section 36	Township 21-S	Range 21-E	County Eddy	
Actual Footage Location of Well: 2205 feet from the North line and 660 feet from the West line					
Ground Level Elev. 4612' GR	Producing Formation Strawn - Canyon		Pool Wildcat Under Box Canyon Strawn		Dedicated Acreage: 320 Acres

1. Outline the acreage dedicated to the subject well by colored pencil or hatchure marks on the plat below.
2. If more than one lease is dedicated to the well, outline each and identify the ownership thereof (both as to working interest and royalty).
3. If more than one lease of different ownership is dedicated to the well, have the interests of all owners been consolidated by communitization, unitization, force-pooling, etc?

☐ Yes ☐ No If answer is "yes," type of consolidation _____

If answer is "no," list the owners and tract descriptions which have actually been consolidated. (Use reverse side of this form if necessary.) _____

No allowable will be assigned to the well until all interests have been consolidated (by communitization, unitization, forced-pooling, or otherwise) or until a non-standard unit, eliminating such interests, has been approved by the Division.

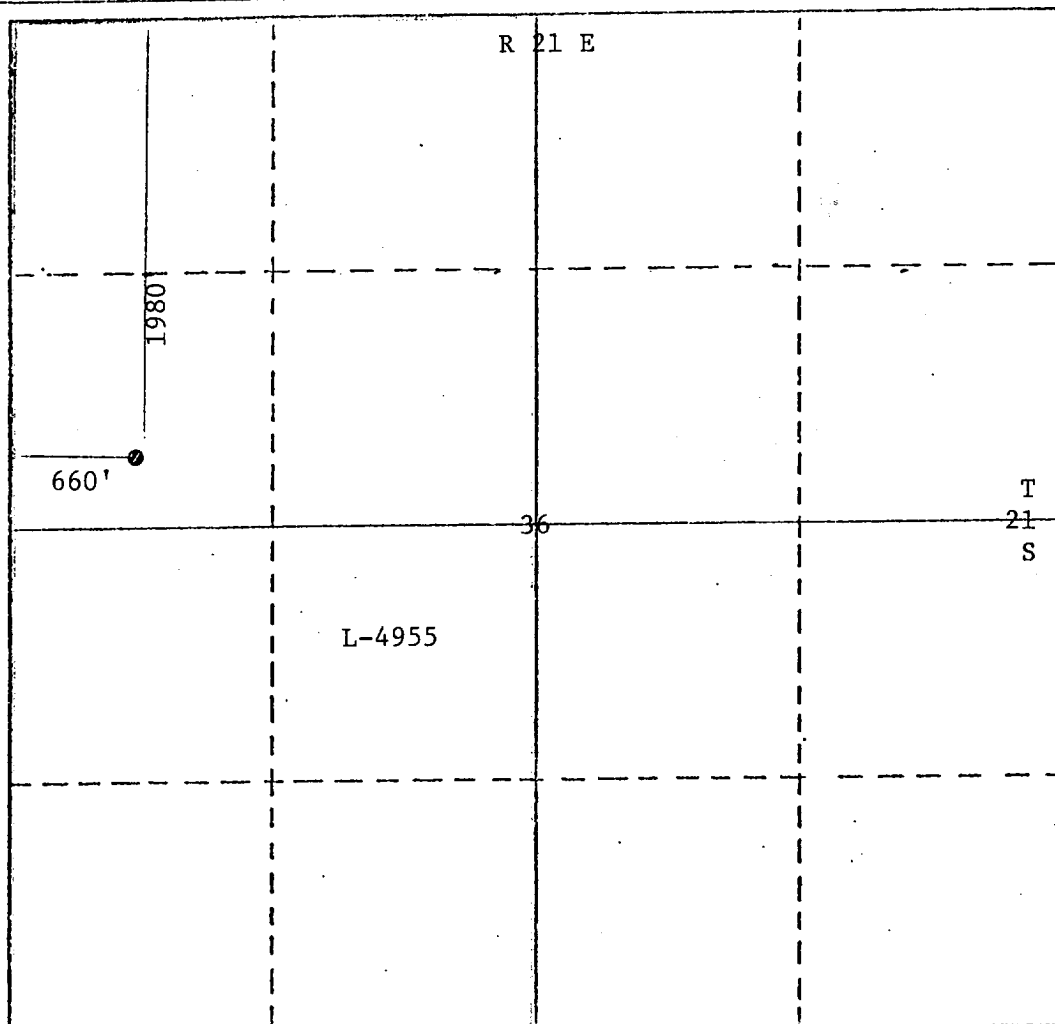

CERTIFICATION

I hereby certify that the information contained herein is true and complete to the best of my knowledge and belief.

Name

Juanita Goodlett

Position

Production Supervisor

Company

Yates Petroleum Corporation

Date

12-7-88

I hereby certify that the well location shown on this plat was plotted from field notes of actual surveys made by me or under my supervision, and that the same is true and correct to the best of my knowledge and belief.

Refer to original plat

Date Surveyed

Registered Professional Engineer
and/or Land Surveyor

Certificate No.

0 330 660 990 1320 1650 1980 2310 2640 2970 3300 3630 3960 4290 4620 4950 5280 5610 5940 6270 6600