

NEW MEXICO OIL CONSERVATION COMMISSION
WELL LOCATION AND ACREAGE DEDICATION PLAT

Form O-128
Supersedes C-128
Effective 1-1-65

All distances must be from the outer boundaries of the Section

Operator Continental Oil Co.			Lease Federal 34		Well No. 1
Section N	Section 34	Township 20 South	Range 26 East	County Eddy	
Actual Well Location of Well:					
960		feet from the South	line and	1980	feet from the West line
Ground Level Elev. 3257.5	Producing Formation MORROW		Pool SPRINGFIELD	Dedicated Acreage 32.0	

- Outline the acreage dedicated to the subject well by colored pencil or hatchure marks on the plat below.
- If more than one lease is dedicated to the well, outline each and identify the ownership thereof (both as to working interest and royalty).
- If more than one lease of different ownership is dedicated to the well, have the interests of all owners been consolidated by communitization, unitization, force-pooling, etc?

☐ Yes ☐ No If answer is "yes," type of consolidation _____

If answer is "no," list the owners and tract descriptions which have actually been consolidated (Use reverse side of this form if necessary.) _____

No allowable will be assigned to the well until all interests have been consolidated (by communitization, unitization, forced-pooling, or otherwise) or until a non-standard unit, eliminating such interests, has been approved by the Commission.

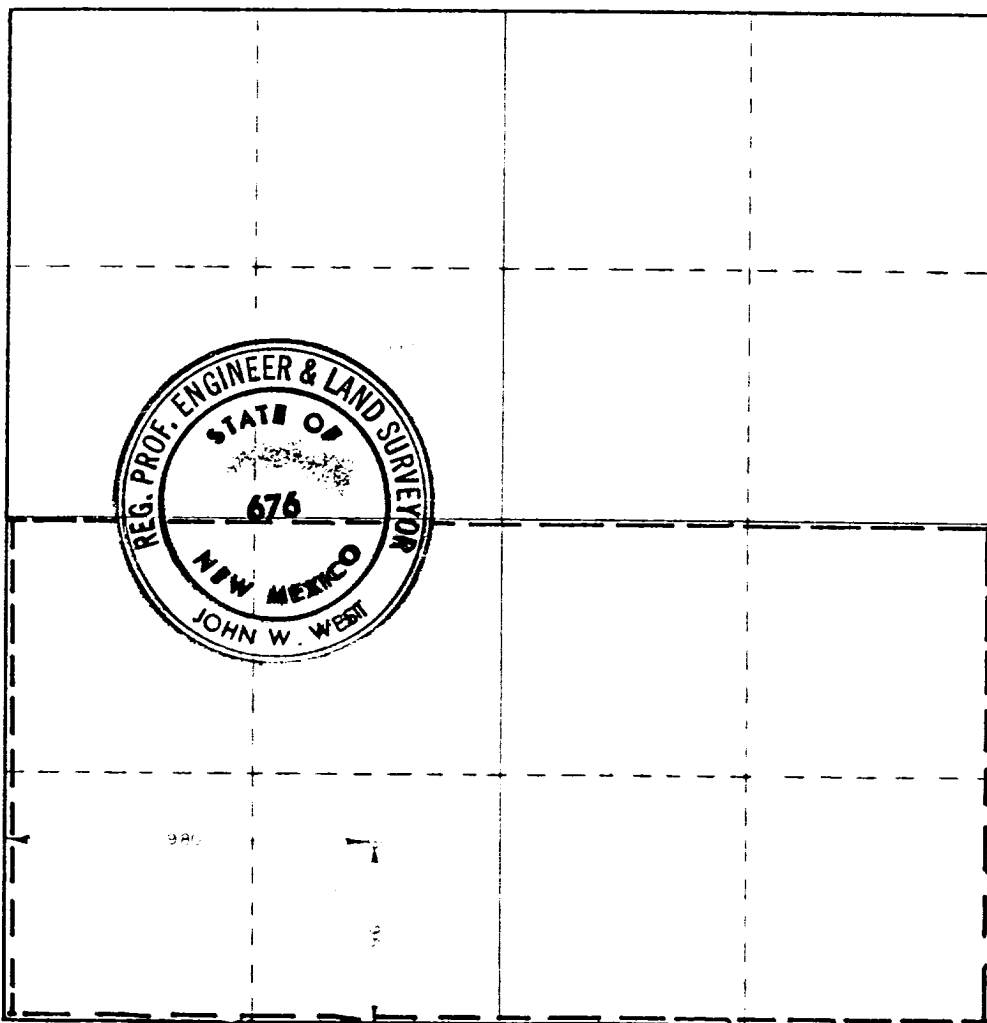

CERTIFICATION

I hereby certify that the information contained herein is true and complete to the best of my knowledge and belief.

Name
John A. Butler
Position
Administrative Supervisor
Company
Continental Oil Co.
Date
October 16, 1978

I hereby certify that the well location shown on this plat was plotted from field notes of actual surveys made by me or under my supervision, and that the same is true and correct to the best of my knowledge and belief.

Date Surveyed
October 7, 1978

Registered Professional Engineer and/or Land Surveyor

John W. West
Certificate No. **John W. West** 676