

Operator Morris R. Antweil Lease M-H Federal Com Well No. 1  
Unit Letter N Section 1 Township 22 South Range 24 East County Eddy  
Actual Postage Location of Well:  
1650 feet from the West line and 660 feet from the South line  
Ground Level Elev. 3853.5 Existing Foundation Upper Penn Pool McKittrick Hills Up. Penn Dedicated Acreage 320 Acres

1. Outline the acreage dedicated to the subject well by colored pencil or hatchure marks on this plat.
2. If more than one lease is dedicated to the well, outline each and identify the ownership thereof (both as to working interest and royalty).
3. If more than one lease of different ownership is dedicated to the well, have the interests consolidated by communitization, unitization, force-pooling, etc?

☒ Yes ☐ No If answer is "yes," type of consolidation Communitization

If answer is "no," list the owners and tract descriptions which have actually been consolidated. (Use reverse side of this form if necessary.)

No allowable will be assigned to the well until all interests have been consolidated (by communitization, unitization, forced-pooling, or otherwise) or until a non-standard unit, eliminating such interests, has been approved by the Commission.

**RECEIVED**  
**DEC 15 1978**  
U.S. GEOLOGICAL SURVEY  
ARTESIA, NEW MEXICO

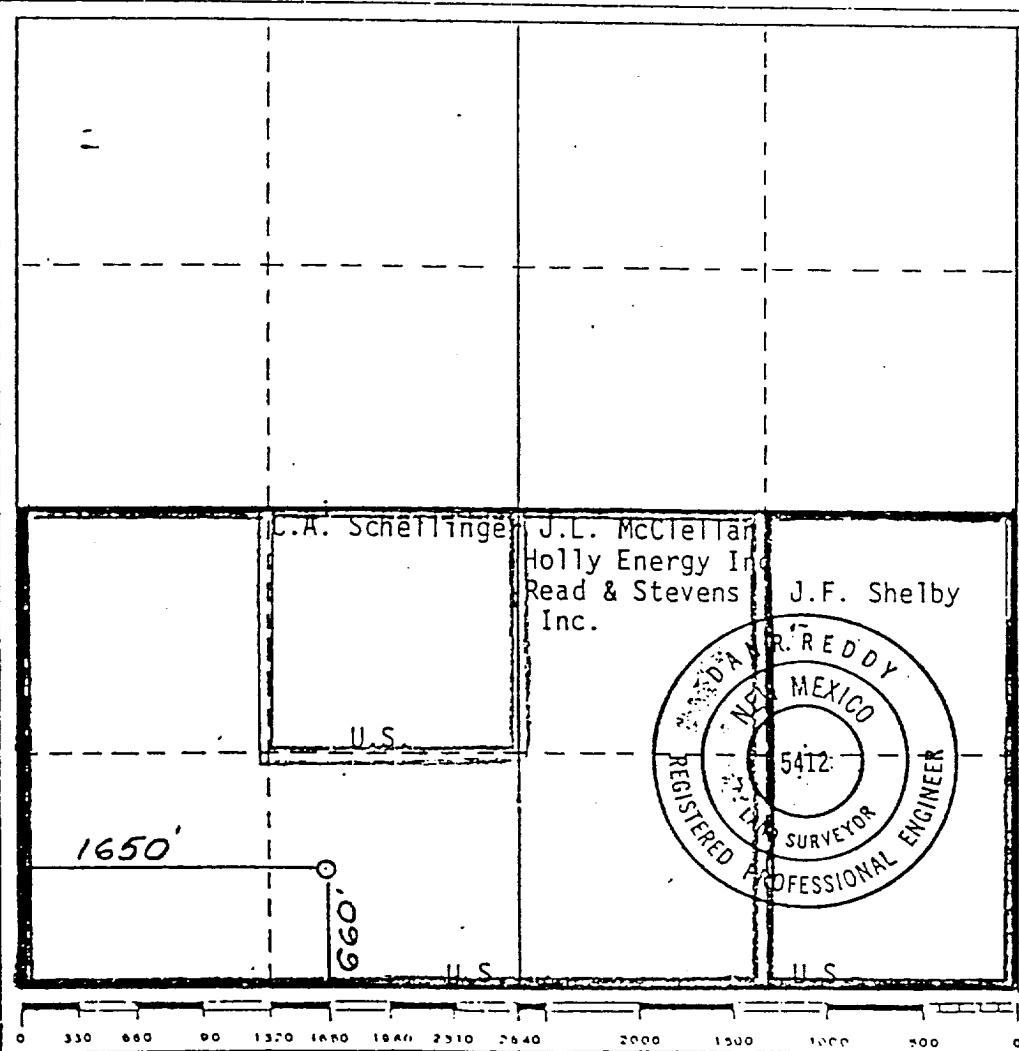

**CERTIFICATION**

I hereby certify that the information contained herein is true and complete to the best of my knowledge and belief.

Name Carl A. Schellinger  
Position Agent

Company Morris R. Antweil  
Date December 8, 1978

Date Surveyed 12/2/78

I hereby certify that the well location shown on this plat was plotted from field notes of actual surveys made by me or under my supervision, and that the same is true and correct to the best of my knowledge and belief.

Registered Professional Engineer and/or Land Surveyor  
Dan R. Reddy  
Certificate No. NM PE&LS #5412