

MEXICO OIL CONSERVATION COMMISSION
WELL LOCATION AND ACREAGE DEDICATION PLAT

Form C-102
Supersedes C-128
Effective 1-1-55

All distances must be from the outer boundaries of the Section

Operator J.C. WILLIAMSON			Lease TOG FED.			Well No. 1		
Unit Letter F	Section 16	Township 20 SOUTH	Range 29 EAST	County EDDY				
Actual Footage Location of Well: <div style="display: flex; justify-content: space-between;"> 1980 feet from the NORTH line and 2310 feet from the WEST line </div>								
Ground Level Elev. 3272.5	Producing Formation Delaware			Pool EAST BURTON DELAWARE			Dedicated Acreage: 40 Acres	

1. Outline the acreage dedicated to the subject well by colored pencil or hatchure marks on the plat below.
2. If more than one lease is dedicated to the well, outline each and identify the ownership thereof (both as to working interest and royalty)
3. If more than one lease of different ownership is dedicated to the well, have the interests of all owners been consolidated by communitization, unitization, force-pooling etc?

RECEIVED

JUL 11 1979

**U.S. GEOLOGICAL SURVEY
ARTESIA, NEW MEXICO**

☐ Yes ☒ No If answer is "yes," type of consolidation

If answer is "no," list the owners and tract descriptions which have actually been consolidated. (Use reverse side of this form if necessary.) None

No allowable will be assigned to the well until all interests have been consolidated (by communitization, unitization, forced-pooling, or otherwise) or until a non-standard unit, eliminating such interests, has been approved by the Commission.

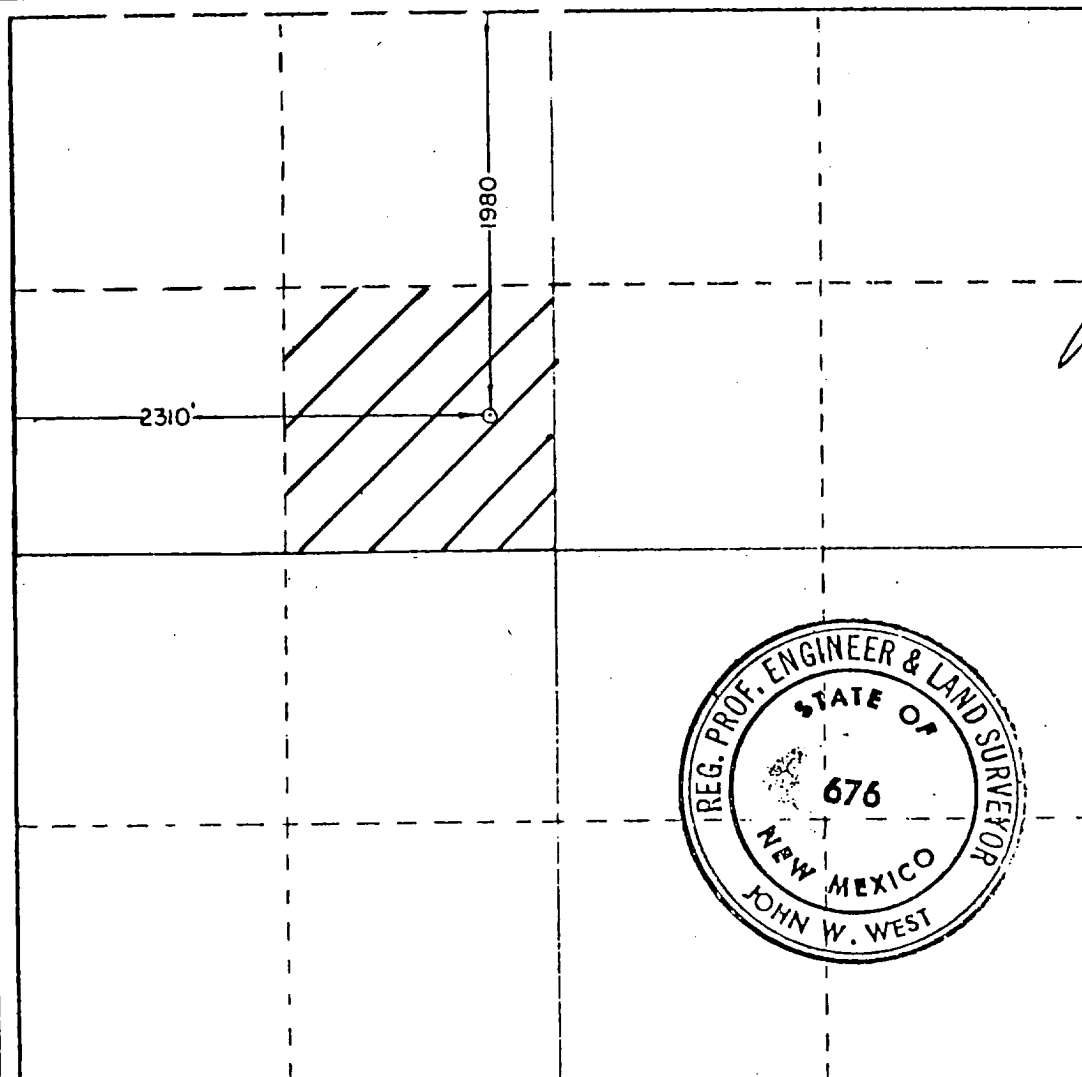

CERTIFICATION

I hereby certify that the information contained herein is true and complete to the best of my knowledge and belief.

Name **JAN LIVINGSTON
J. C. Williamson**

Position **Operator PRODUCTION**

Company **Independent J.C. Williamson**

Date **July 9, 1979 July 20, 1989**

I hereby certify that the well location shown on this plat was plotted from field notes of actual surveys made by me or under my supervision, and that the same is true and correct to the best of my knowledge and belief.

Date Surveyed **JULY 6TH, 1979**

Registered Professional Engineer and Land Surveyor

John W. West

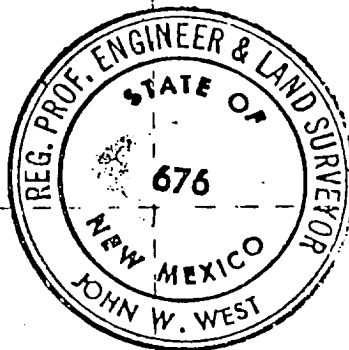

SUPPLEMENTAL DRILLING DATA

J. C. WILLIAMSON
TOG Federal # 1

1. SURFACE FORMATION: Quaternary Alluvium

2. ESTIMATED TOPS OF GEOLOGIC MARKERS:

Rustler Anhydrite	110'
Salt Debris	400'
Solid Salt	550'
Tansil	1060'
Yates Sand	1185'
Goat Seep Reef	1435'
Delaware Sands	3170'±
in Mid-Clearfork Formation	
First Bone Springs Lime	5881'

3. ANTICIPATED POSSIBLE WATER AND HYDROCARBON BEARING ZONES:

Fresh Water	above 200'
Delaware (oil)	3350' - 5950'
Bone Springs	5950' - 6500'

4. PROPOSED CASING AND CEMENTING PROGRAM:

Casing program is shown on Form 9-331 C.

Surface, interm. & 4-1/2" casing on this well have already been set and cement circulated. The production portion of the hole will be drilled to approximately 4700' and 4-1/2" casing will be cemented at a total depth if significant shows are encountered in the Delaware sand series.

5. PRESSURE CONTROL EQUIPMENT:

Pressure control equipment will consist of a 3000# double ram manually controlled blow out preventer and a 3000# choke manifold.

6. CIRCULATING MEDIUM:

The circulating medium will be brine water below 3200' and will be used to drill out existing cement plugs.

7. AUXILARY EQUIPMENT:

Not Applicable.

8. TESTING, LOGGING AND CORING PROGRAM:

Formation testing will be made by conventional drill stem test; however none are anticipated.

It is planned that a Gamma Ray correlation log will be run.

No coring is planned.

9. ABNORMAL PRESSURES, TEMPERATURES OR HYDROGEN SULFIDE GAS:

None anticipated.

10. ANTICIPATED STARTING DATE:

It is planned that operations will commence on August 20, 1989, or as soon as the application is approved.

SURFACE USE AND OPERATIONS PLAN

FOR

J. C. WILLIAMSON

TOG FEDERAL # 1

1980' FNL & 2310' FWL Sec. 16-20S-29E
EDDY COUNTY, NEW MEXICO

LOCATED: 13 air miles Northeast of Carlsbad, New Mexico

FEDERAL LEASE NUMBER: NM 0554771

LEASE ISSUED: September 1, 1964

RECORD LESSEE: TXO, et al

ACRES IN LEASE: 640

SURFACE OWNERSHIP: Federal

POOL: East Burton Delaware

ATTACHMENTS:

- A. General Road Map
- B. Plat Showing existing well and existing roads
- C. Lease Plat
- D. Drilling Rig Layout
- E. BOP Diagram

1. EXISTING ROADS:

- A. Exhibit "A" is a portion of a road map showing the location of the proposed well. Access to the location will be gained by using an existing road.
- B. Exhibit "B" is a plat showing existing roads in the vicinity of a well site. Existing roads are shown by a double black line.

2. PLANNED ACCESS ROAD:

- A. SURFACING MATERIAL: Some surfacing material may be needed for the prepared location. If necessary, 4" caliche, watered and compacted will be used in those areas of the road where water might stand during a rain storm.
- B. MAXIMUM GRADE: One-half Percent.
- C. TURNOUTS: None required.
- D. DRAINAGE DESIGN: Road will have a drop of six inches from the center on each side.
- E. CULVERTS: None required.
- F. CUTS AND FILLS None necessary. Only clearing and minor leveling will be required.
- G. GATES AND CATTLE GUARD: No fence will need to be cut in conjunction with drilling operations so no cattleguard will be needed.

3. LOCATION OF EXISTING WELLS:

- A. Existing wells in the area are shown on Exhibit "B".

4. LOCATION OF EXISTING AND/OR PROPOSED FACILITIES:

- A. There are no existing facilities on this lease that may be used for production facilities for this well.
- B. If production is encountered, the needed production facilities will be located on the J.C. Williamson TOG Federal #3.

5. LOCATION AND TYPE OF WATER SUPPLY:

- A. Fresh water necessary for drilling will be purchased and hauled to the well site over existing and proposed roads.

6. SOURCE OF CONSTRUCTION MATERIALS:

Material needed for road and location improvement will be obtained from an approved caliche pit located one mile east of the location along the main east/west road in the area.

7. METHODS OF HANDLING WASTE DISPOSAL:

- A. Drill cuttings will be disposed of the drilling pit.
- B. Drilling fluid will be allowed to evaporate in the drilling pit until the pit is dry.
- C. Water produced during testing of this well will be disposed of in the drilling pit. Oil produced during test will be stored in test tanks until sold.
- D. Current laws and regulations pertaining to the disposal of human waste will be complied with.
- E. Trash, waste paper, garbage and junk will be buried in a separate trash pit and covered with a minimum of 24 inches of dirt. All waste material will be contained to prevent scattering by the wind. Location of the trash pit is shown on Exhibit "D"
- F. All trash and debris will be buried or removed from the well site within 30 days after finishing drilling and/or completion operations.

8. ANCILLARY FACILITIES:

- A. None Required.

9. WELL SITE LAYOUT:

- A. Exhibit "D" shows the relative location and dimensions of the well pad, mud pit, trash pit, and the location of major rig components.
- B. Only minor leveling of the well site will be required, No significant cut and fill will be necessary.

10. PLANS FOR RESTORATION OF THE SURFACE:

- A. After completion of drilling and/or completion operations, all equipment and other material not needed for operations will be removed. Pits will be filled and the location cleaned of all trash, junk and all material buried so as to leave the well site in as an aesthetically pleasing condition as possible.

- B. Any unguarded pits containing fluids will be fenced until they are filled.
- C. After abandonment, all equipment, trash and junk will be removed or buried and the location cleaned. Any special abandonment rehabilitation and/or special revegetation requirements of the surface management agency will be complied with and accomplished as expeditiously as possible. No location will be reclaimed and reseeded prior to well abandonment.

11. OTHER INFORMATION:

- A. TOPOGRAPHY: The land surface is relatively level. Regional slope is to the southwest.
- B. SOIL: The top soil at the well site is a gravelly, loamy sand.
- C. FLORA AND FAUNA: The vegetative cover is sparse and consists of mesquite, grease wood, yucca, weeds and range grasses, wildlife in the area is that typical of semi-arid desert land and includes coyotes, rabbits, rodents, reptiles, dove and quail.
- D. PONDS AND STREAMS: The Pecos River is approximately five and one-half miles West of the proposed well site.
- E. RESIDENCE AND OTHER STRUCTURES: There is an operating windmill approximately 3/4 of a mile SW of the proposed well site.
- F. ARCHAEOLOGICAL, HISTORICAL, AND OTHER CULTURAL SITES: None observed in the area.
- G. LAND USE: Grazing and hunting in season.
- H. SURFACE OWNERSHIP: Federal.

12. OPERATOR'S REPRESENTATIVE:

Representative responsible for assuring compliance with the approved Surface Use Plan is:

J. C. Williamson
890 One Midland National Center
Midland, Texas 79701
Attention: J.C. Williamson
Office Phone: 915-682-1797
Home Phone: 915-682-8357

13. CERTIFICATION:

I hereby certify that I, or persons under my direct supervision, have inspected the proposed drill site and access route; that I am familiar with the conditions which presently exist; that the statements made in the plan are, to the best of my knowledge, true and correct; and, that the work associated with the operations proposed herein will be performed by J. C. Williamson and its contractors and subcontractors in conformity with this plan and the term and conditions under which it is approved.

July 20, 1989

DATE

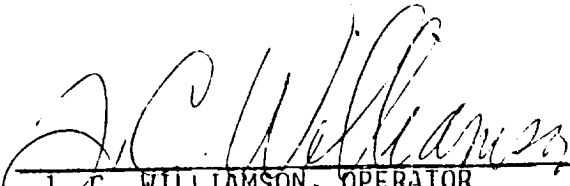
J. C. WILLIAMSON, OPERATOR

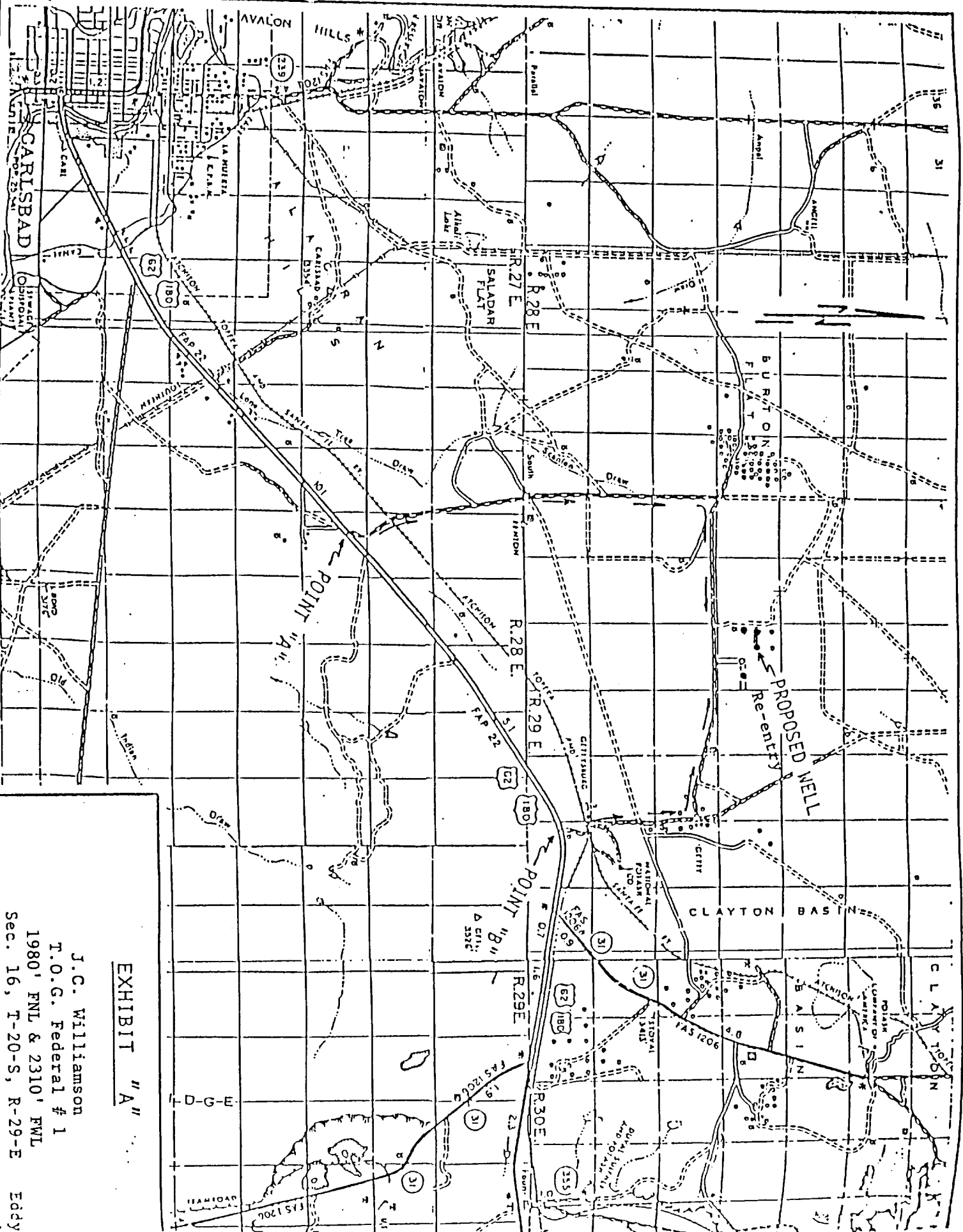
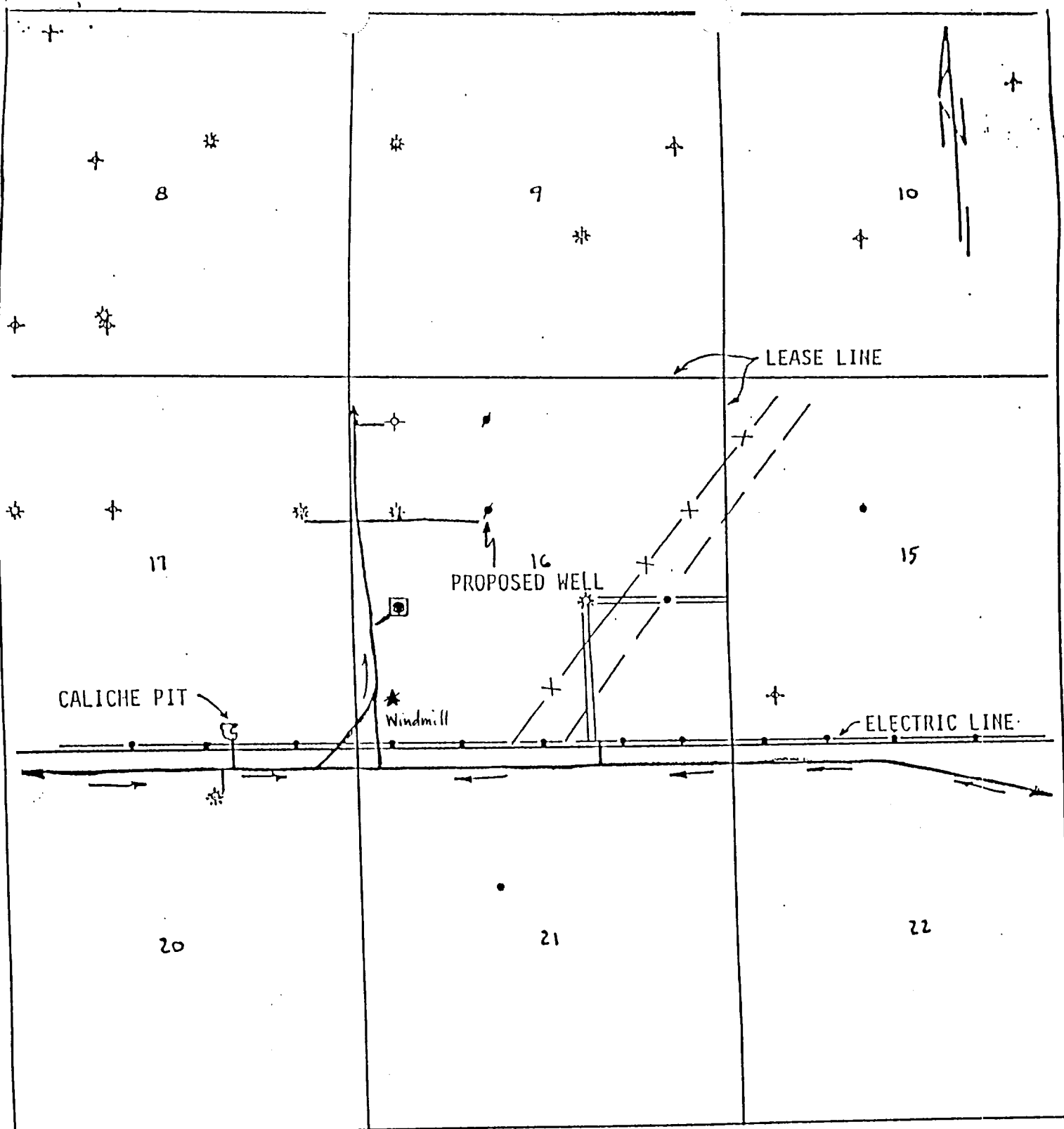

EXHIBIT "A"

J.C. Williamson
 T.O.G. Federal # 1
 1980' FNL & 2310' FWL
 Sec. 16, T-20-S, R-29-E Eddy C



LEGEND:

- Oil Well
- ☆ Gas Well
- ⊕ Plugged Well
- ==== Existing Caliche Road
- Proposed New Road
- High pressure gas pipeline
- x-x- Barbed wire fence

EXHIBIT "B"

J.C. Williamson
T.O.G. Federal # 1
1980' FNL & 2310' FWL
Eddy County, New Mexico

SCALE 4" = 1 MILE

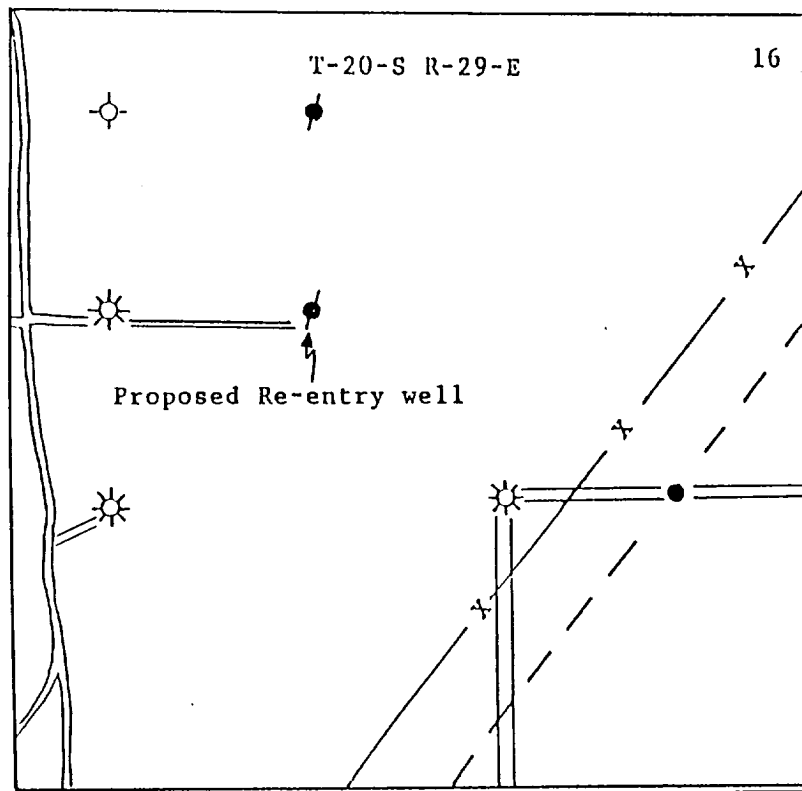



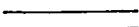



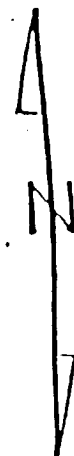

EXHIBIT "C"

J.C. WILLIAMSON
T.O.G. Federal # 1
Sec. 16 T-20-S, R-29-E
Eddy County, New Mexico

-  Oil well
-  Gas well
-  Abandoned dry hole
-  Abandoned well
-  Existing caliche road
-  Proposed new road
-  High pressure gas pipeline
-  Barbed wire fence



-- 200' --

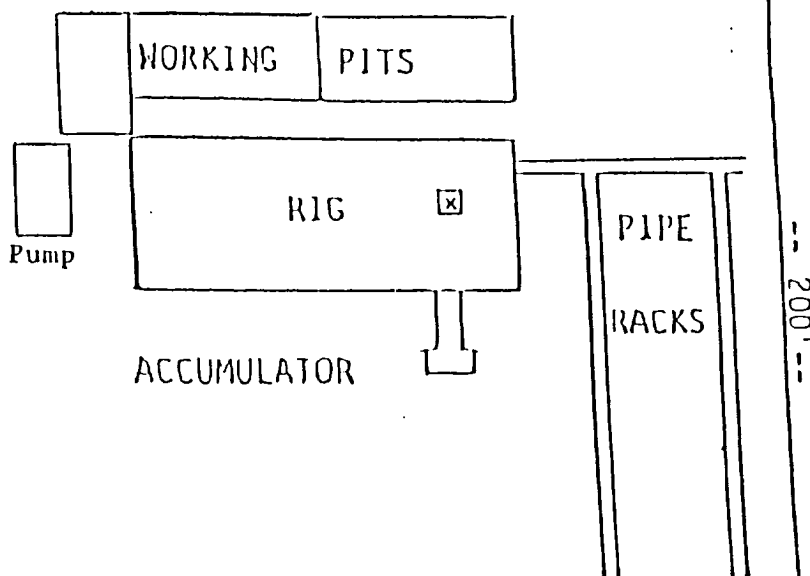

EXHIBIT "D"

J.C. Williamson
T.O.G. Federal # 1
Eddy County, New Mexico

EXHIBIT "E"

BOP Diagram

A flanger type Bell lead will be used on this well. After the 13-3/8" casing has been set and cemented, an 11" double ram BOP will be put on and kept in service for the life of this well.

After 8-5/8" intermediate casing has been set and cement placed around the bottom of this pipe, the 13-3/8" casing will be orange peeled into the 8-5/8" casing and then an 11" double ram BOP, as shown below will be put on the hole. This blowout preventer will be connected to a manually controlled closing unit. The pressure rating on this BOP is 3000#, and will have blank and 5-1/2" pipe.

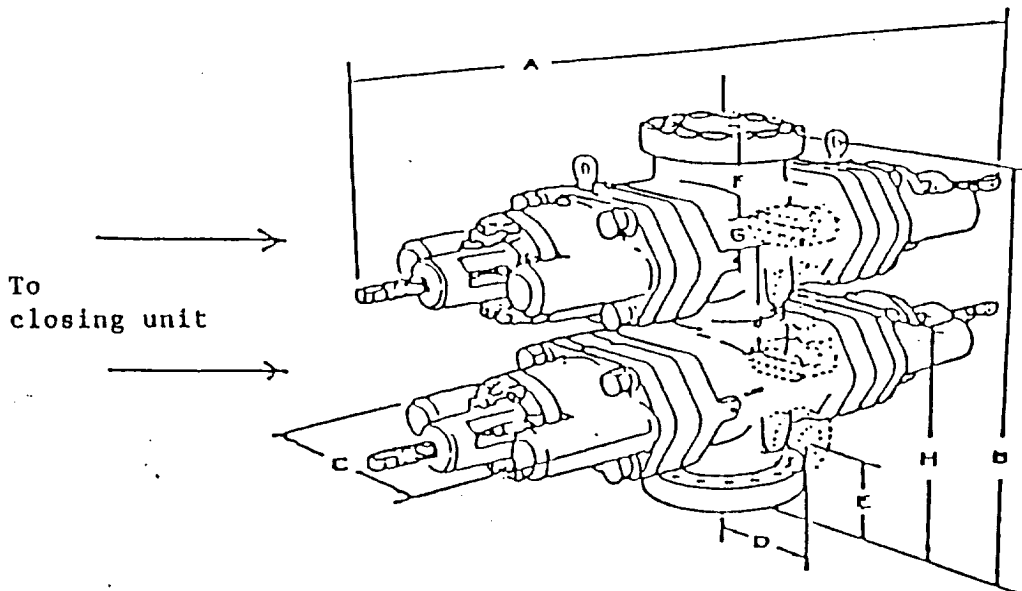

J.C. Williamson
T.O.G. Federal # 1
1980' FNL & 2310' FWL
Sec. 16, T-20-S, R-29-E
Eddy County, New Mexico