

STATE OF NEW MEXICO
ENERGY AND MINERALS DEPARTMENT

OIL CONSERVATION DIVISION

30-015-23100
Form C-101
Revised 10-1-78

NO. OF COPIES RECEIVED	
DISTRIBUTION	
SANTA FE	
FILE	
U.S.G.S.	
LAND OFFICE	
OPERATOR	

P. O. BOX 2088
SANTA FE, NEW MEXICO 87501

CONFIDENTIAL
TIGHT HOLE

5A. Indicate Type of Lease
STATE ☒ FEE ☐

5. State Oil & Gas Lease No.
VB-0183

APPLICATION FOR PERMIT TO DRILL, DEEPEN, OR PLUG BACK

1a. Type of Work DRILL <input type="checkbox"/> DEEPEN <input type="checkbox"/> PLUG BACK <input type="checkbox"/>		7. Unit Agreement Name
b. Type of Well OIL WELL <input checked="" type="checkbox"/> GAS WELL <input type="checkbox"/> OTHER <input type="checkbox"/> Re-enter <input type="checkbox"/> SINGLE ZONE <input type="checkbox"/> MULTIPLE ZONE <input type="checkbox"/>		8. Farm or Lease Name State
2. Name of Operator Energex Company		9. Well No. 1
3. Address of Operator 100 North Pennsylvania, Roswell, NM 88201-4620		10. Field and Pool, or Wildcat Undes. Bone Spring
4. Location of Well UNIT LETTER <u>X</u> LOCATED <u>3300</u> FEET FROM THE <u>South</u> LINE AND <u>660</u> FEET FROM THE <u>West</u> LINE OF SEC. <u>2</u> TWP. <u>21-S</u> RGE. <u>28-F</u> NMPM		12. County Eddy
19. Proposed Depth 7600'		19A. Formation Bone Spring
20. Rotary or C.T. Reverse Unit		
21. Elevations (Show whether DF, RT, etc.) 3318.8 GR	21A. Kind & Status Plug. Bond One Well (CD)	22. Approx. Date Work will start 11-20-92

PROPOSED CASING AND CEMENT PROGRAM

SIZE OF HOLE	SIZE OF CASING	WEIGHT PER FOOT	SETTING DEPTH	SACKS OF CEMENT	EST. TOP
17-1/2"	13-3/8"	54.5#	513'	525	
11"	8-5/8"	24# & 32#	3250'	2900	
7-7/8"	5-1/2" see below		3710' SUR		

Energex will re-enter the well which was plugged and abandoned by Pogo Producing. We propose to clean out the hole to 7400' and attempt to complete the well in the Bone Spring formation. We will use a 6" 900 Series Shaffer BOP during operations.

The 5-1/2" casing was cut at 3710' & pulled out of hole. The 5-1/2" casing left in hole is shown on the attached Exhibit "A". Energex proposes to:
Drill plugs at surface and 3153'. Clean out to top of 5-1/2" casing at 3710'. Set approx. 460' of 5-1/2" casing with welded overshot over csg stub @ 3710' & tie in to 8-5/8" casing. (design casing patch to facilitate cement squeeze behind 5-1/2" csg. covering 5700'-8200' - hole conditions may necessitate running casing patch with 5-1/2" to surface.) Drill out plugs @ 4900', clean out casing cut @ 5130', drill plug @ 6900', clean out to 8300' preparatory to running radial CBL. Set CIBP @ approx. 8300'. Perforate to suicide squeeze covering the interval from 5,300-7,600', if possible.

Former: Pogo Prod Co - State #1

OTD: 13,339 PYB: 9-21-87

APPROVAL VALID FOR 180 DAYS
PERMIT EXPIRES 3-8-89
UNLESS DRILLING UNDERWAY

IN ABOVE SPACE DESCRIBE PROPOSED PROGRAM: IF PROPOSAL IS TO DEEPEN OR PLUG BACK, INDICATE PRESENT PRODUCTIVE ZONE AND PROPOSED NEW PRODUCTIVE ZONE. GIVE BLOWOUT PREVENTER PROGRAM, IF ANY.

I hereby certify that the information above is true and complete to the best of my knowledge and belief.

Signed George L. Scott, III Title George L. Scott, III, President Date 8/20/92

(This space for State Use)

ORIGINAL SIGNED BY

MIKE WILLIAMS

SUPERVISOR, DISTRICT II

APPROVED BY

TITLE

DATE

CONDITIONS OF APPROVAL

622-~~6713~~ 6713
OCT 23 1992

EXHIBIT "A"

TO C-101 - Energex Company State #1 Re-entry

Pogo Producing # 1 (Sand Point) State
 Sec. 2-T21S-R28E, 3306 FSL & 660' FWL
 KB 3335'; GL 3319
 Spud 1-20-1980; Cmp (Morrow) 5-29-1980

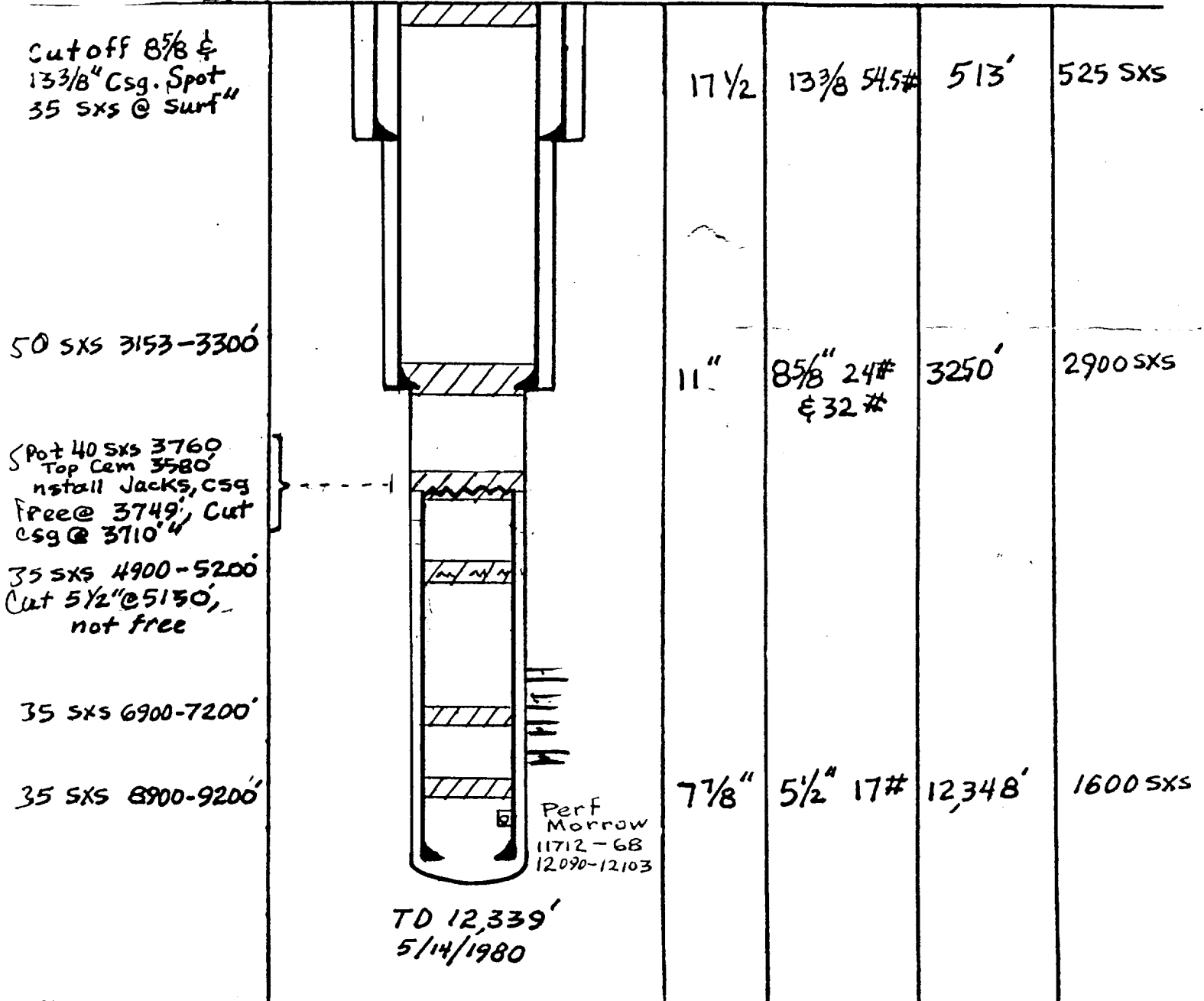

On 1-1-82 Abandon Morrow & att. cml in Atoka. Temp. abandon Atoka 1-19-82, Would "test Bone Springs after Reservoir study complete". (From OCD Data)

OIL CONSERVATION DIVISION

STATE OF NEW MEXICO
ENERGY AND MINERALS DEPARTMENTP. O. BOX 2088
SANTA FE, NEW MEXICO 87501Form C-102
Revised 10-1-78

All distances must be from the outer boundaries of the Section.

Operator Energex Company		Lease State		Well No. 1	
Unit Letter M	Section 2	Township 21-S	Range 28-E	County Eddy	
Actual Footage Location of Well:					
3300'		feet from the South line and		660 feet from the West line	
Ground Level Elev. 3318.8 GR	Producing Formation Bone Spring	Pool Undesignated Bone Spring		Dedicated Acreage: 40 Acres	

1. Outline the acreage dedicated to the subject well by colored pencil or hachure marks on the plat below.
2. If more than one lease is dedicated to the well, outline each and identify the ownership thereof (both as to working interest and royalty).
3. If more than one lease of different ownership is dedicated to the well, have the interests of all owners been consolidated by communitization, unitization, force-pooling, etc?

☐ Yes ☐ No If answer is "yes," type of consolidation _____

If answer is "no," list the owners and tract descriptions which have actually been consolidated. (Use reverse side of this form if necessary.) _____

No allowable will be assigned to the well until all interests have been consolidated (by communitization, unitization, forced-pooling, or otherwise) or until a non-standard unit, eliminating such interests, has been approved by the Division.

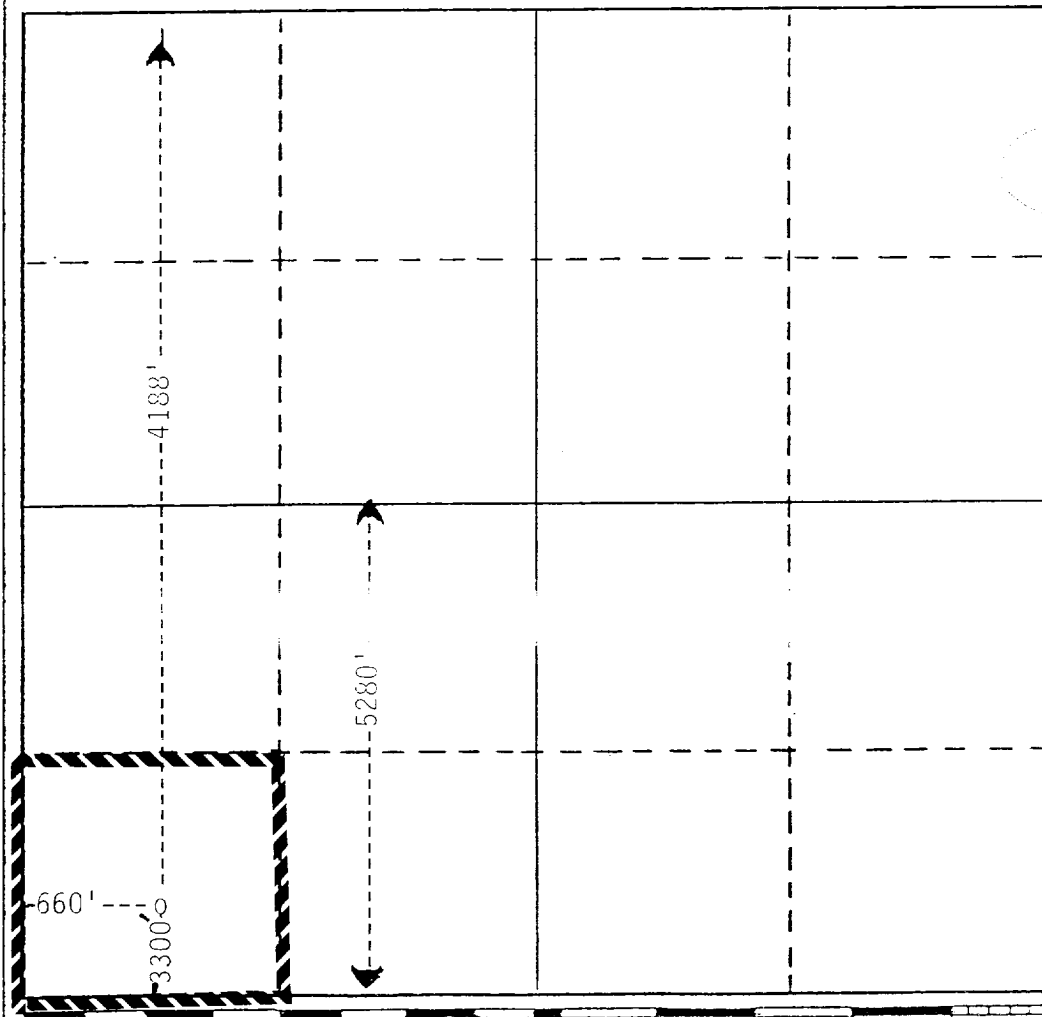

CERTIFICATION

I hereby certify that the information contained herein is true and complete to the best of my knowledge and belief.

Name
Jackie Midkiff
Position
Administrative Assistant
Company
Energex Company

Date
7/28/92

I hereby certify that the well location shown on this plat was plotted from field notes of a registered professional engineer or under my supervision, and that the same is true and correct to the best of my knowledge and belief.

December 10, 1979

Date Surveyed
PLEASE SEE ORIGINAL C-102
Registered Professional Engineer
and/or Land Surveyor

ON POGO PRODUCING STATE #1

Certificate No.