

NEW MEXICO OIL CONSERVATION COMMISSION  
WELL LOCATION AND ACREAGE DEDICATION PLAT

Form C-102  
Supersedes C-128  
Effective 1-1-65

All distances must be from the outer boundaries of the Section

Operator David Fasken			Lease Marala Fed.		Well No. 1
Unit Letter J	Section 35	Township 20 South	Range 27 East	County Eddy	
Actual Portage Location of Well: 1980 feet from the South line and 1980 feet from the East line					
Ground Level Elev. 3226.95	Producing Formation Morrow	Pool Avalon Morrow	Dedicated Acreage: 320 Acres		

1. Outline the acreage dedicated to the subject well by enclosing oil or hatchure marks on the plat below.
2. If more than one lease is dedicated to the well, outline each and identify the ownership thereof (both as to working interest and royalty).
3. If more than one lease of different ownership is dedicated to the well, have the interests of all owners been consolidated by communitization, unitization, force-pooling, etc.

☐ Yes ☐ No If answer is "yes," type of consolidation Working Interest Unit w/David Fasken as Operator. All Federal Acreage & Lease.

If answer is "no," list the owners and tract descriptions which have actually been consolidated. (Use reverse side of this form if necessary.)

No allowable will be assigned to the well until all interests have been consolidated (by communitization, unitization, forced-pooling, or otherwise) or until a non-standard unit, eliminating such interests, has been approved by the Commission.

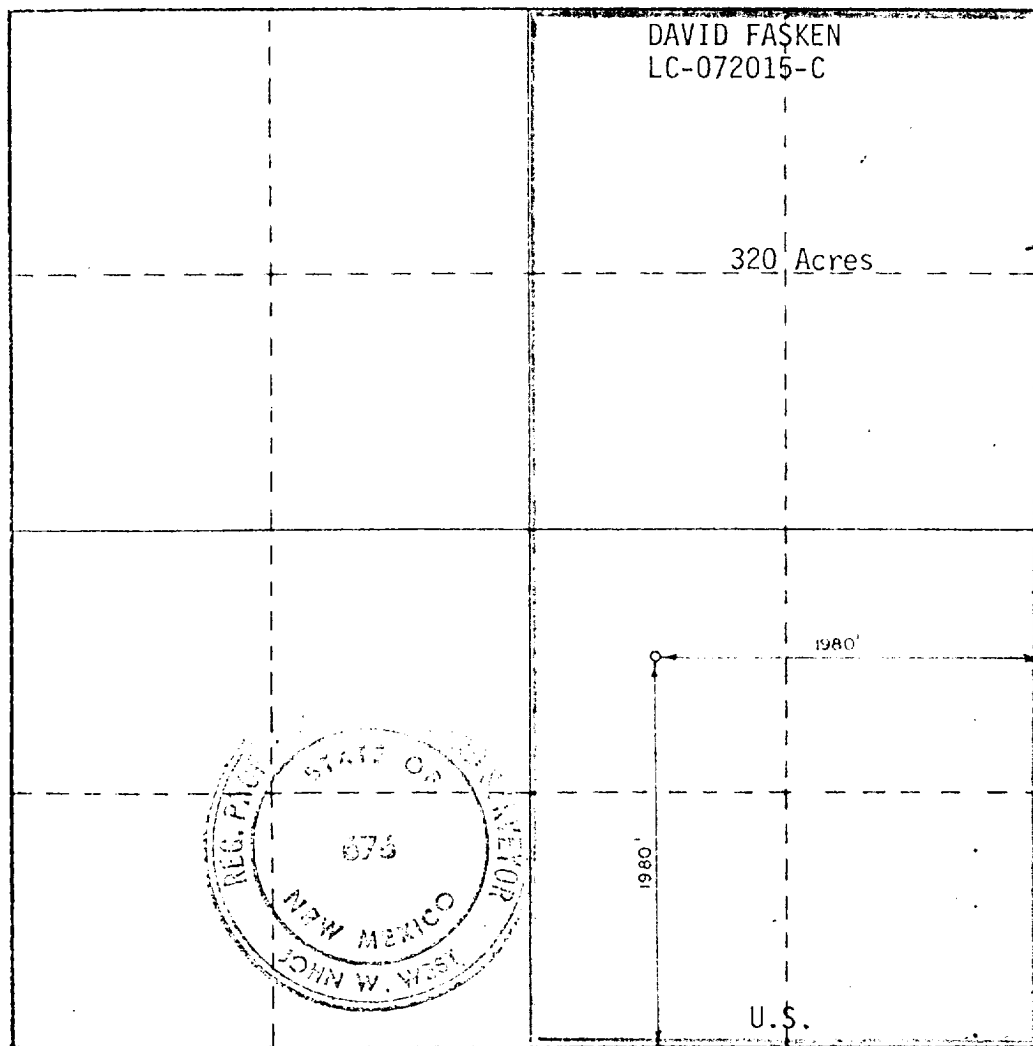

CERTIFICATION

I hereby certify that the information contained herein is true and complete to the best of my knowledge and belief.

*Robert H. Angevine*  
Name

Robert H. Angevine, Agent

Position

DAVID FASKEN

Company

February 18, 1980

Date

I hereby certify that the well location shown on this plat was plotted from field notes of actual surveys made by me or under my supervision, and that the same is true and correct to the best of my knowledge and belief.

Date Surveyed

2-1-1980

Registered Professional Engineer and/or Land Surveyor

*John W. West*

Certificate No. JOHN W. WEST 676  
PATRICK A. ROMERO 8583  
Ronald J. Eidson 3239