

**MEXICO OIL CONSERVATION COMMISSION
WELL LOCATION AND ACREAGE DEDICATION PLAT**

File ✓
USGS
S-11-1-81
Form C-102
Supersedes C-128
Effective 1-1-65

All distances must be from the outer boundaries of the Section

AMENDED

Operator Tenneco Oil Co.			Lease State F.P. 13			Well No. 2		
Unit Letter E	Section 13	Township 21 South	Range 25 East	County Eddy				
Actual Footage Location of Well: 990 feet from the west line and 2310 feet from the north line								
Ground Level Elev. 3301.1	Producing Formation Morrow		Pool Catclaw Draw Morrow			Dedicated Acreage 640 Acres		

OCT 15 1981

O. C. D.

ARTESIA, OFFICE

1. Outline the acreage dedicated to the subject well by colored pencil or hachure marks on the plat below.
2. If more than one lease is dedicated to the well, outline each and identify the ownership thereof (both as to working interest and royalty).
3. If more than one lease of different ownership is dedicated to the well, have the interests of all owners been consolidated by communitization, unitization, force-pooling, etc?

☒ Yes ☐ No If answer is "yes," type of consolidation Communitization

If answer is "no," list the owners and tract descriptions which have actually been consolidated. (Use reverse side of this form if necessary.) _____

No allowable will be assigned to the well until all interests have been consolidated (by communitization, unitization, forced-pooling, or otherwise) or until a non-standard unit, eliminating such interests, has been approved by the Commission.

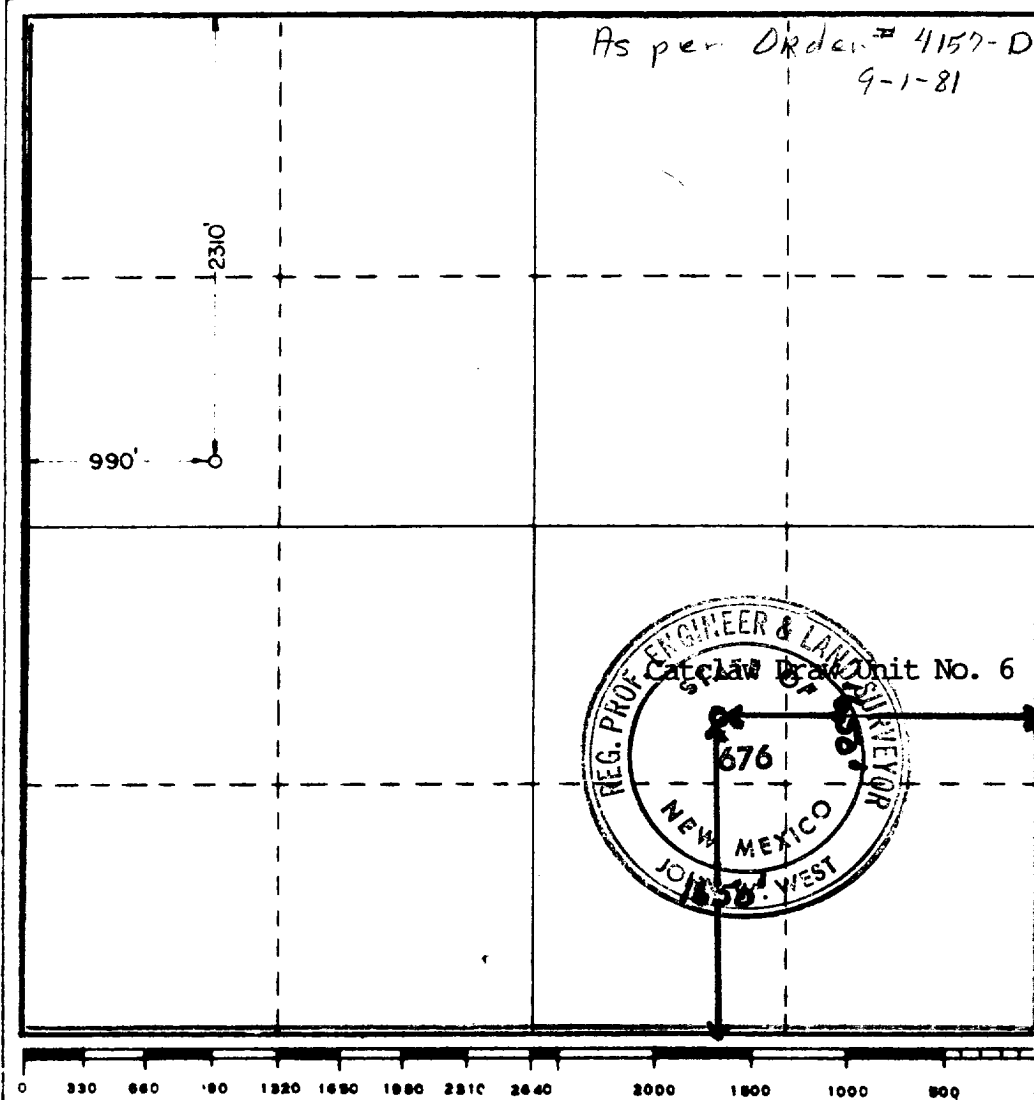

CERTIFICATION

I hereby certify that the information contained herein is true and complete to the best of my knowledge and belief.

Name

Anita Gray

Position

Production Analyst

Company

Tenneco Oil Company

Date

October 12, 1981

I hereby certify that the well location shown on this plat was plotted from field notes of actual surveys made by me or under my supervision, and that the same is true and correct to the best of my knowledge and belief.

Date Surveyed

4-8-81

Registered Professional Engineer and/or Land Surveyor

Certificate No

**JOHN W. WEST 676
PATRICK A. ROMERO 6663
Ronald J. Eidson 3239**