

**N MEXICO OIL CONSERVATION COMMISS**  
**WELL LOCATION AND ACREAGE DEDICATION PLAT**

Form C-102  
 Supersedes C-128  
 Effective 1-1-65

All distances must be from the outer boundaries of the Section.

Operator <b>Bliss Petroleum, Inc.,</b>			Lease <b>D B Federal</b>		Well No. <b>1</b>
Tract Letter <b>L</b>	Section <b>22</b>	Township <b>20 South</b>	Range <b>29 East</b>	County <b>Eddy</b>	
Actual Footage Location of Well: <b>2310</b> feet from the <b>south</b> line and <b>330</b> feet from the <b>west</b> line					
Ground Level Elev. <b>3273.5</b>	Producing Formation <b>Seven Rivers</b>		Pool <b>wildcat SR</b> <b>Undesignated</b>	Dedicated Acreage <b>40</b>	

1. Outline the acreage dedicated to the subject well by colored pencil or hatchure marks on the plat below.
2. If more than one lease is dedicated to the well, outline each and identify the ownership thereof (both as to working interest and royalty).
3. If more than one lease of different ownership is dedicated to the well, have the interests of all owners been consolidated by communitization, unitization, force-pooling, etc?

☐ Yes ☐ No If answer is "yes," type of consolidation \_\_\_\_\_

If answer is "no," list the owners and tract descriptions which have actually been consolidated. (Use reverse side of this form if necessary.) \_\_\_\_\_

No allowable will be assigned to the well until all interests have been consolidated (by communitization, unitization, forced-pooling, or otherwise) or until a non-standard unit, eliminating such interests, has been approved by the Commission.

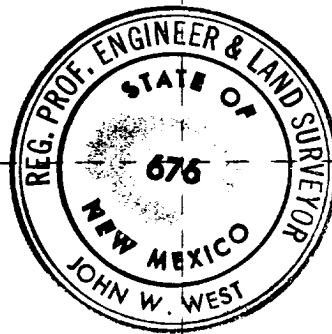

**CERTIFICATION**

I hereby certify that the information contained herein is true and complete to the best of my knowledge and belief.

*Paul Bliss*

Name  
**Paul Bliss**

Position  
**President**

Company  
**Bliss Petroleum, Inc.**

Date  
**June 18, 1981**

I hereby certify that the well location shown on this plat was plotted from field notes of actual surveys made by me or under my supervision, and that the same is true and correct to the best of my knowledge and belief.

Date Surveyed  
**June 11, 1981**

Registered Professional Engineer and/or Land Surveyor

*John W. West*

Certificate No. **JOHN W. WEST 676**  
**PATRICK A. ROMERO 6863**  
**Ronald J. Eidson 3239**

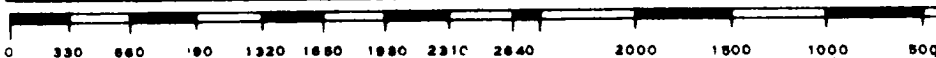
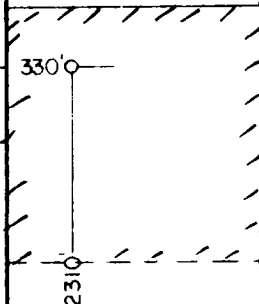

N.M.O.G.D. COPY

SUBMIT IN TRIPLICATE\*  
(Other instructions on  
reverse side)Form approved.  
Budget Bureau No. 42-R1425.UNITED STATES  
DEPARTMENT OF THE INTERIOR  
GEOLOGICAL SURVEY

30-015-23885

## APPLICATION FOR PERMIT TO DRILL, DEEPEN, OR PLUG BACK

1a. TYPE OF WORK

DRILL ☒RECEIVED  
DEEPEN ☐PLUG BACK ☐

b. TYPE OF WELL

OIL  
WELL ☒GAS  
WELL ☐

OTHER

JUL 29 1981

SINGLE  
ZONEMULTIPLE  
ZONES

2. NAME OF OPERATOR

Bliss Petroleum, Inc.

O. C. D.

3. ADDRESS OF OPERATOR

ARTESIA, OFFICE

P. O. Box 1817 Hobbs, N.M. 88240

4. LOCATION OF WELL (Report location clearly and in accordance with any State requirements.)

At surface

Unit L, 2310' FSL &amp; 330' FSL, Sec. 22, T20S, R29E

At proposed prod. zone

Same

14. DISTANCE IN MILES AND DIRECTION FROM NEAREST TOWN OR POST OFFICE\*

14 Miles Northeast of Carlsbad, N.M.

15. DISTANCE FROM PROPOSED\*

LOCATION TO NEAREST  
PROPERTY OR LEASE LINE, FT.

(Also to nearest drlg. unit line, if any)

1650'

18. DISTANCE FROM PROPOSED LOCATION\*

TO NEAREST WELL, DRILLING, COMPLETED,  
OR APPLIED FOR, ON THIS LEASE, FT.

None

16. NO. OF ACRES IN LEASE

560

19. PROPOSED DEPTH

2000'

17. NO. OF ACRES ASSIGNED

TO THIS WELL

40

20. ROTARY OR CABLE TOOLS

Cable Tools &amp; Rotary

21. ELEVATIONS (Show whether DF, RT, GR, etc.)

3274' GL

22. APPROX. DATE WORK WILL START\*

7-27-81

23.

## PROPOSED CASING AND CEMENTING PROGRAM

SIZE OF HOLE	SIZE OF CASING	WEIGHT PER FOOT	SETTING DEPTH	QUANTITY OF CEMENT
11"	8 5/8"	24#	280'	125 sx. - Circulate
6 3/4"	4 1/2"	9.5#	2000'	350 sx. - Circulate

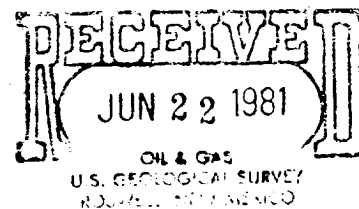
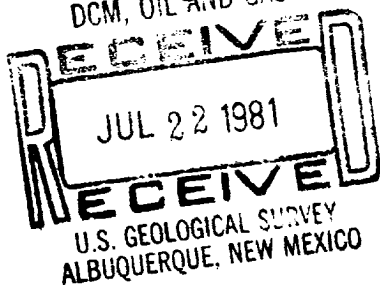
See Attachments for complete details of Operations,  
Mud Program, Blowout Preventers, Etc.  
DCM, OIL AND GAS

IN ABOVE SPACE DESCRIBE PROPOSED PROGRAM: If proposal is to deepen or plug back, give data on present productive zone and proposed new productive zone. If proposal is to drill or deepen directionally, give pertinent data on subsurface locations and measured and true vertical depths. Give blowout preventer program, if any.

24.

SIGNED

*Paul Bliss*

TITLE

President

DATE

6-18-1981

(This space for Federal or State office use)

PERMIT NO.

APPROVAL DATE

7-23-81

APPROVED BY

TITLE

DATE

CONDITIONS OF APPROVAL, IF ANY:

\*See Instructions On Reverse Side

## Instructions

**General:** This form is designed for submitting proposals to perform certain well operations, as indicated, on all types of lands and leases for appropriate action by either a Federal or a State agency, or both, pursuant to applicable Federal and/or State laws and regulations. Any necessary special instructions concerning the use of this form and the number of copies to be submitted, particularly with regard to local, area, or regional procedures and practices, either are shown below or will be issued by, or may be obtained from, the local Federal and/or State office.

**Item 1:** If the proposal is to redrill to the same reservoir at a different subsurface location or to a new reservoir, use this form with appropriate notations. Consult applicable State or Federal regulations concerning subsequent work proposals or reports on the well.

**Item 4:** If there are no applicable State requirements, locations on Federal or Indian land should be described in accordance with Federal requirements. Consult local State or Federal office for specific instructions.

**Item 14:** Needed only when location of well cannot readily be found by road from the land or lease description. A plat, or plats, separate or on this reverse side, showing the roads to, and the surveyed location of, the well, and any other required information, should be furnished when required by Federal or State agency offices.

**Items 15 and 18:** If well is to be, or has been directionally drilled, give distances for subsurface location of hole in any present or objective production zone.

**Item 22:** Consult applicable Federal or State regulations, or appropriate officials, concerning approval of the proposal before operations are started.



UNITED STATES  
DEPARTMENT OF THE INTERIOR  
GEOLOGICAL SURVEY  
South Central Region  
P.O. Box 26124  
Albuquerque, New Mexico 87125

IN REPLY REFER TO:

RECEIVED

JUL 29 1981

O. C. D.  
ARTESIA, OFFICE

JUL 23 1981

Bliss Petroleum, Inc.  
P.O. Box 1817  
Hobbs, New Mexico 88240

Gentlemen:

Your application for Permit to Drill well No. 1 - "DB" Federal in the SW $\frac{1}{4}$  sec. 22, T. 20 S., R. 29 E., Eddy County, New Mexico, lease NM-13995, to a depth of 2,000 feet to test the Seven Rivers formation in the oil-potash area, is hereby approved as amended by stipulations attached to the application.

One copy of the application is returned herewith. Please notify the District Supervisor, Geological Survey, Roswell, New Mexico, in sufficient time for a representative to witness all cementing operations.

Sincerely yours,

(ORIG. SGD.) GENE F. DANIEL

Gene F. Daniel  
Deputy Conservation Manager  
Oil and Gas

Enclosure

cc:  
NMOCD (2)

Bliss Petroleum, Inc.

DB Federal No. 1

Unit L, 2310' FSL & 330' FWL Section 22, T20S, R29E

Eddy County, New Mexico - Federal Lease NM 13995

1. Surface Formation: Quaternary Alluvium

2. Estimated tops of geologic markers:   Base Salt               950'  
  Yates               1140'  
  Seven Rivers       1360'

3. Estimated depth of mineral-bearing formations:

Fresh Water - None  
Yates           + 2135' oil & gas  
Seven Rivers+ 1915' oil & gas

4. Casing Program

<u>Hole Size</u>	<u>Size of Casing</u>	<u>Weight Per ft.</u>	<u>Cond.</u>	<u>Grade</u>	<u>Depth</u>	<u>Sacks Cement</u>	<u>Est. Top of Cement</u>
11"	8 5/8"	24#	New	H-40	280'	125	Circ.
6 3/4"	4 1/2"	9.5#	New	K-55	2000'	350	Circ.

5. Blowout Preventer: Blind Ram Cable Tool Control while drilling with cable tools. Shaffer Type Manual with Blind Rams & Pipe Rams while drilling and completing well.

6. Mud Program: 0-1000' native spud mud, 34 viscosity, weight 8.9#; 1000-2000 salt base mud viscosity 35-38, weight 10.1#, water loss 20.

7. Auxiliary Equipment: Kelly valve, safety sub with full opening valve, drill pipe float valve.

8. Logging and Testing: No drillstem tests or coring anticipated. Log to consist of Density and Dual Induction Laterolog.

9. Anticipated pressure and potential hazards: The L. C. Ellis, Federal No. 1 well 3/4 mile to the North in Sec. 15 indicates that the maximum pressure will be less than 1000 psig and that hydrogen sulfide will not be encountered.

10. Starting date and duration: Starting date will be before July 27, 1981. Abbott Bros. Drilling Contractors from Hobbs, N.M. will drill to 280' with their cable tool rig and set surface pipe. A DA&S Well Servicing Unit will be used with Star Tool Co. rotary equipment to drill from 280' to 2000'. They will be used in an attempt to test and complete as a producer. Operations are expected to be complete in 17 days.

SURFACE USE AND OPERATIONS PLAN

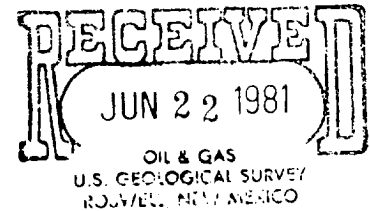

Bliss Petroleum, Inc.  
DB Federal No. 1

Federal Lease NM 13995; 2310' FSL & 330' FWL of Section 22, T20S, R29E, Eddy Co.  
New Mexico

1. Existing Roads:

Exhibit "A" is a portion of a topographic map showing the existing lease roads that will be utilized and their junction with Highway 180 about 13 miles East of Carlsbad, N.M.

2. Planned Access Road:

Length and Width: The proposed road will be built 12 feet wide and 2850 feet long. As shown on Exhibit "B", the proposed road will tie into the unimproved existing road that crosses the north line of Section 22.

Surfacing Material: We plan to scrape off topsoil and use existing caliche to smooth out the road.

Maximum Grade: One Percent.

Turnouts: None required.

Drainage Design: None required.

Culverts: None required.

Gates and Cattleguards: None required.

3. Location of Existing Wells:

Exhibit "C" is a portion of a Chaves County ownership map showing all existing wells within a radius of 1 mile.

4. Location of Existing and/or Proposed Facilities:

Exhibit "B" shows the location of the proposed well and roads in Section 22. In the event commercial production is found, the tank battery or producing equipment will be located on the drilling pad.

5. Location and Type of Water Supply:

All fresh water required for drilling and road construction will be hauled from the water station at Halfway Bar. All brine water will be hauled from B & E Brine Station at Carlsbad, N.M.

6. Source of Construction Materials:

No construction materials will be needed to make location and road. We plan to scrape off the topsoil and level the ground enough to handle the rigs.

7. Methods of Handling Waste Disposal:

Drill cuttings will be disposed of in the drilling pits.

Drilling fluids will be allowed to evaporate in the drilling pits until pits are dry.

Water produced during test will be disposed of in the drilling pits. Oil produced during test will be stored in test tanks until transferred to tank battery for sale.

Current laws and regulations pertaining to the disposal of human waste will be complied with.

Trash, waste paper, garbage and junk will be buried in a separate trash pit and covered with a minimum of 24 inches of dirt. All waste material will be contained to prevent scattering by the wind. Location of trash pit is shown on Exhibit "D".

All trash and debris will be buried or removed from the wellsite within 30 days after finishing drilling and/or completion operations.

8. Ancillary Facilities: None required.

9. Wellsite Layout:

Exhibit "D" shows the relative location and dimensions of the well pad, slush pits and location of major rig components while drilling with cable tools.

Exhibit "E" shows the relative location and dimensions of the well pad, reserve pit, trash pit and the location of major rig components while drilling with the well servicing unit and rotary tools.

The well site will require minor levelling of sand and caliche rock. No cuts and fills will be necessary.

The reserve pit will be plastic lined.

10. Plans for Restoration of the Surface:

After completion of drilling and/or completion operations, all equipment and other material not needed for operations will be removed. Pits will be filled and location cleaned of all trash and junk to leave wellsite in an aesthetically pleasing condition as possible.

11. Other Information:

Topography: Land surface is rolling caliche nodules.

Soil: Soil consists of silty loams and silty clay loams. Inclusions consist of rare chert gravels and more frequent caliche nodules.

Flora and Fauna: Vegetative cover is sparse and consists of mesquite and very thin native grass. Wildlife consists of coyotes, rabbits, rodents, reptiles, dove, quail and crows.

Residences and Other Structures: There are no residences or any other structures in the area.

Ponds and Streams: None in the area.

Surface Use Plan  
Bliss Petroleum, Inc.  
DB Federal No. 1  
PAGE Three

Archeological, Historical and Cultural Sites: None observed in the area.

Land Use: Grazing and hunting in season.

Surface Ownership: Federal land owned by the Federal Government.

12. Operator's Representatives:

The field representatives responsible for assuring compliance with the approved surface use and operations plan are as follows:

Paul Bliss  
P.O. Box 1817  
Hobbs, New Mexico 88240  
(505) 393-7320

Bill Jamison  
P.O. Box 1817  
Hobbs, New Mexico 88240  
(505) 393-7320

13. Certification:

I hereby certify that I, or persons under my direct supervision, have inspected the proposed drillsite and access route; that I am familiar with the conditions which presently exist; that the statements made in this plan are, to the best of my knowledge true and correct; and the work associated with the operation proposed herein will be performed by myself and my contractors and sub-contractors in conformity with this plan and the terms and conditions under which it is approved.

BLISS PETROLEUM, INC.

June 18, 1981

  
Paul Bliss  
President





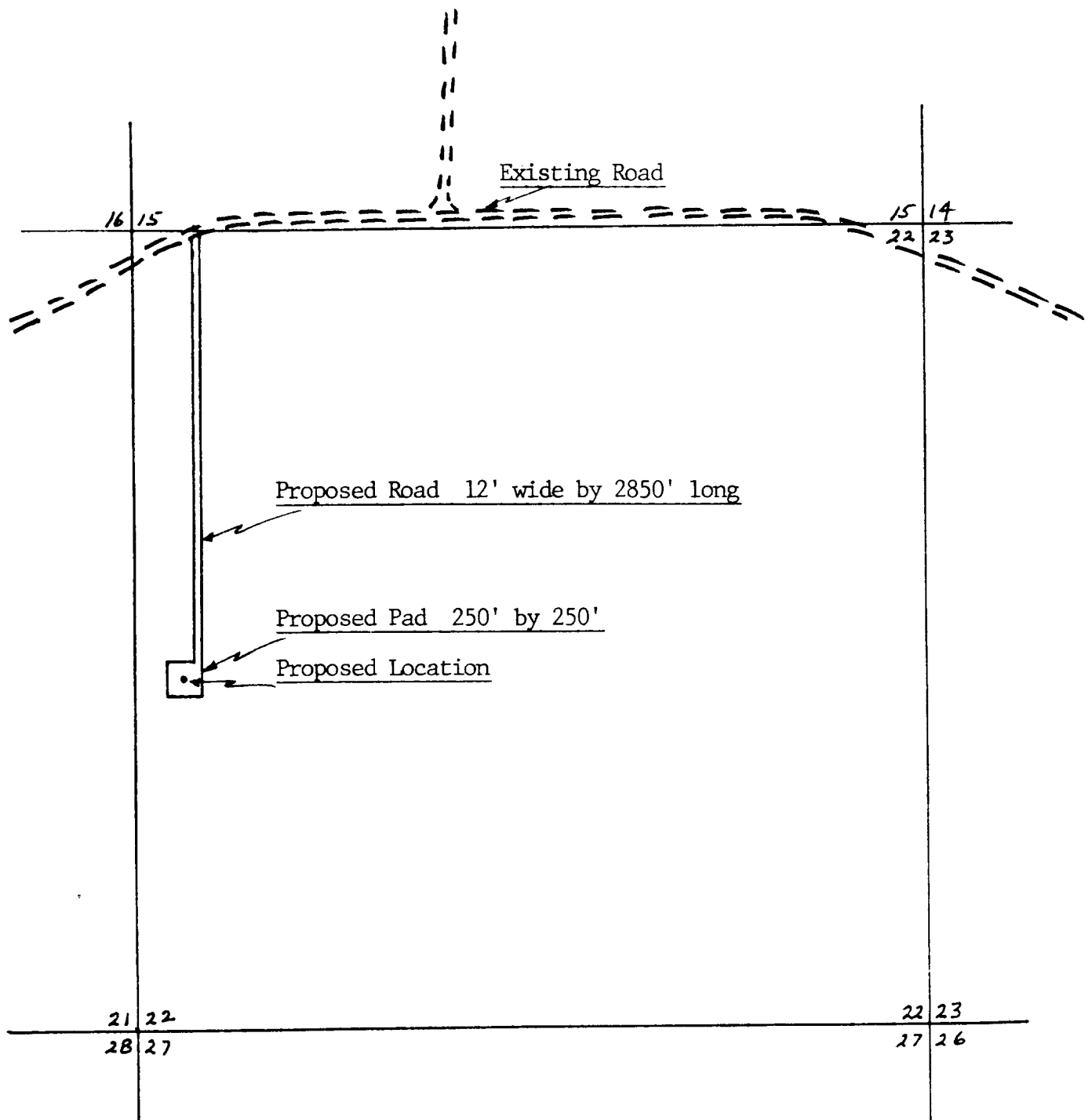

Section 22, T-20-S, R-29-E, Eddy County, New Mexico

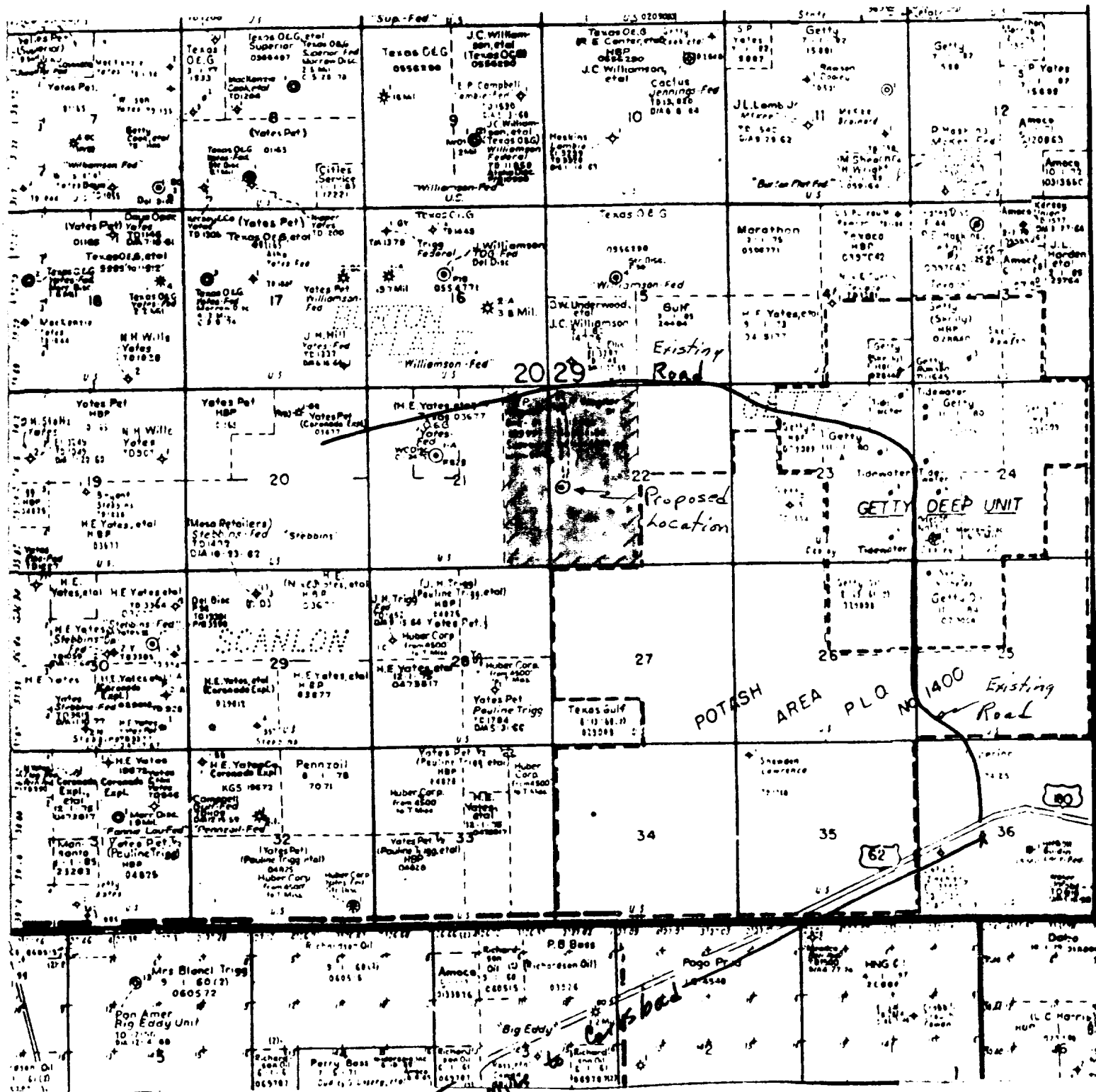



↑  
Road  
12' Wide  
2850' Length  
← 12' →

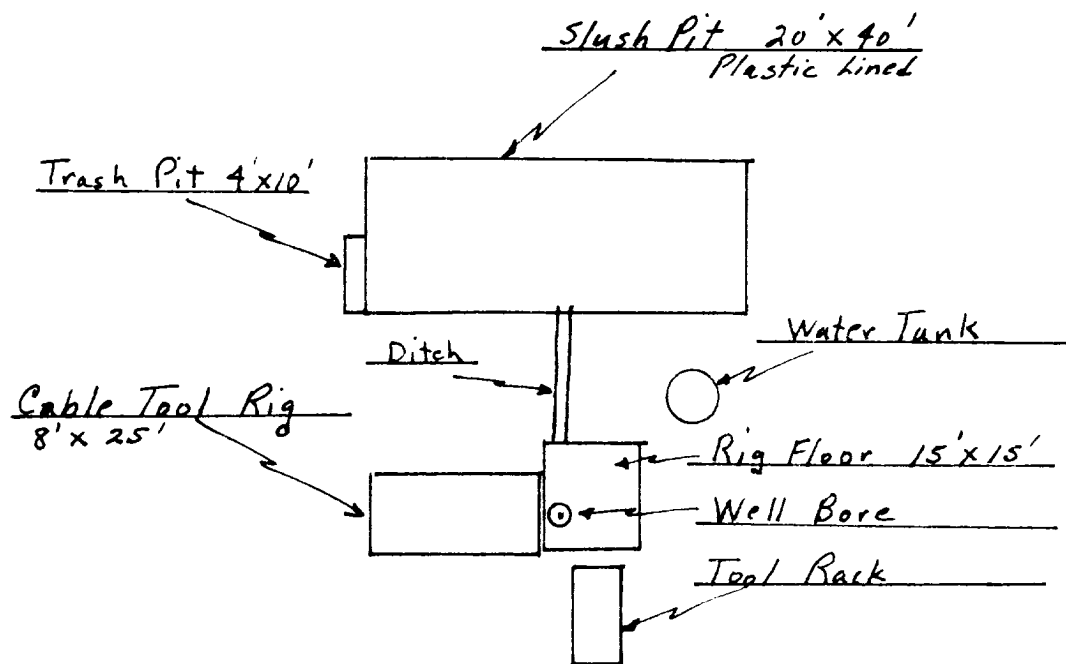



Road 12' wide  
2850' Length

