

NO. OF COPIES RECEIVED	
DISTRIBUTION	
SANTA FE	
FILE	
U.S.G.S.	
LAND OFFICE	
OPERATOR	

NEW MEXICO OIL CONSERVATION COMMISSION

JAN 12 1982

O. C. D.
ARTESIA OFFICE

Form C-101
Revised 1-1-65

30-015-24060

5A. Indicate Type of Lease	
STATE <input checked="" type="checkbox"/>	FEE <input type="checkbox"/>
5. State Oil & Gas Lease No.	
E 5232	

APPLICATION FOR PERMIT TO DRILL, DEEPEN, OR PLUG BACK

1a. Type of Work		7. Unit Agreement Name	
		Big Eddy Unit	
b. Type of Well		8. Farm or Lease Name	
DRILL <input checked="" type="checkbox"/> DEEPEN <input type="checkbox"/> PLUG BACK <input type="checkbox"/> OIL WELL <input type="checkbox"/> GAS WELL <input checked="" type="checkbox"/> OTHER <input type="checkbox"/> SINGLE ZONE <input checked="" type="checkbox"/> MULTIPLE ZONE <input type="checkbox"/>		Big Eddy Unit	
2. Name of Operator		9. Well No.	
Perry R. Bass ✓		93	
3. Address of Operator		10. Field and Pool, or Wildcat	
P.O. Box 2760 Midland, Texas 79702		Indian Flats	
4. Location of Well		12. County	
UNIT LETTER <u>K</u> LOCATED <u>1980</u> FEET FROM THE <u>South</u> LINE AND <u>1980</u> FEET FROM THE <u>West</u> LINE OF SEC. <u>36</u> TWP. <u>21 South</u> RGE. <u>28 East</u> WPM		Eddy	
		19. Proposed Depth	
		12,800	
		19A. Formation	
		Morrow	
		20. Rotary or C.T.	
		Rotary	
21. Elevations (Show whether DF, RT, etc.)		21A. Kind & Status Plug. Bond	
3196.2' GL		Blanket	
		21B. Drilling Contractor	
		Unknown	
		22. Approx. Date Work will start	
		Upon Approval	

PROPOSED CASING AND CEMENT PROGRAM

SIZE OF HOLE	SIZE OF CASING	WEIGHT PER FOOT	SETTING DEPTH	SACKS OF CEMENT	EST. TOP
15"	11-3/4"	42	400'+	350	Circ. to Surface
11"	8-5/8"	32	2780' 3450'	1250	Circ. To Surface
7-7/8"	5-1/2"	17	TD	900	Est. TOC @ 8740'

BOP Diagrams attached BEPCO III & IV

Gas is Dedicated.

Posted ID-1
API + NL Book
1-15-82

APPROVAL VALID FOR 180 DAYS
PERMIT EXPIRES 7-15-82
UNLESS DRILLING UNDERWAY

4. ABOVE SPACE DESCRIBE PROPOSED PROGRAM: IF PROPOSAL IS TO DEEPEN OR PLUG BACK, GIVE DATA ON PRESENT PRODUCTIVE ZONE AND PROPOSED NEW PRODUCTIVE ZONE. GIVE BLOWOUT PREVENTER PROGRAM, IF ANY.

hereby certify that the information above is true and complete to the best of my knowledge and belief.

Signed Stephen D. Smith Title Engineering Assistant Date January 5, 1982
(This space for State Use).

APPROVED BY Mike Williams TITLE OIL AND GAS INSPECTOR DATE JAN 15 1982

CONDITIONS OF APPROVAL, IF ANY:

NEW MEXICO OIL CONSERVATION COMMISSION
WELL LOCATION AND ACREAGE DEDICATION PLAT

Form O-102
Supersedes O-128
Effective 1-1-85

All distances must be from the outer boundaries of the Section

Owner Perry R. Bass		Lease Big Eddy Unit		Well No. 93
Quarter K	Section 36	Township 21 South	Range 28 East	County Eddy
Actual Well Location of Well:				
1980 feet from the South		1980 feet from the West		
Ground Level Elev. 3196.2'	Producing Formation Morrow	Estimated Acreage Indian Flats Morrow		320

- 1 Outline the acreage dedicated to the subject well by colored pencil or hatchure marks on the plat below.
- 2 If more than one lease is dedicated to the well, outline each and identify the ownership thereof (both as to working interest and royalty).
- 3 If more than one lease of different ownership is dedicated to the well, have the interests of all owners been consolidated by communitization, unitization, force-pooling, etc?

☒ Yes ☐ No If answer is "yes," type of consolidation Unit

If answer is "no," list the owners and tract descriptions which have actually been consolidated. (Use reverse side of this form if necessary.)

No allowable will be assigned to the well until all interests have been consolidated (by communitization, unitization, forced-pooling, or otherwise) or until a non-standard unit, eliminating such interests, has been approved by the Commission.

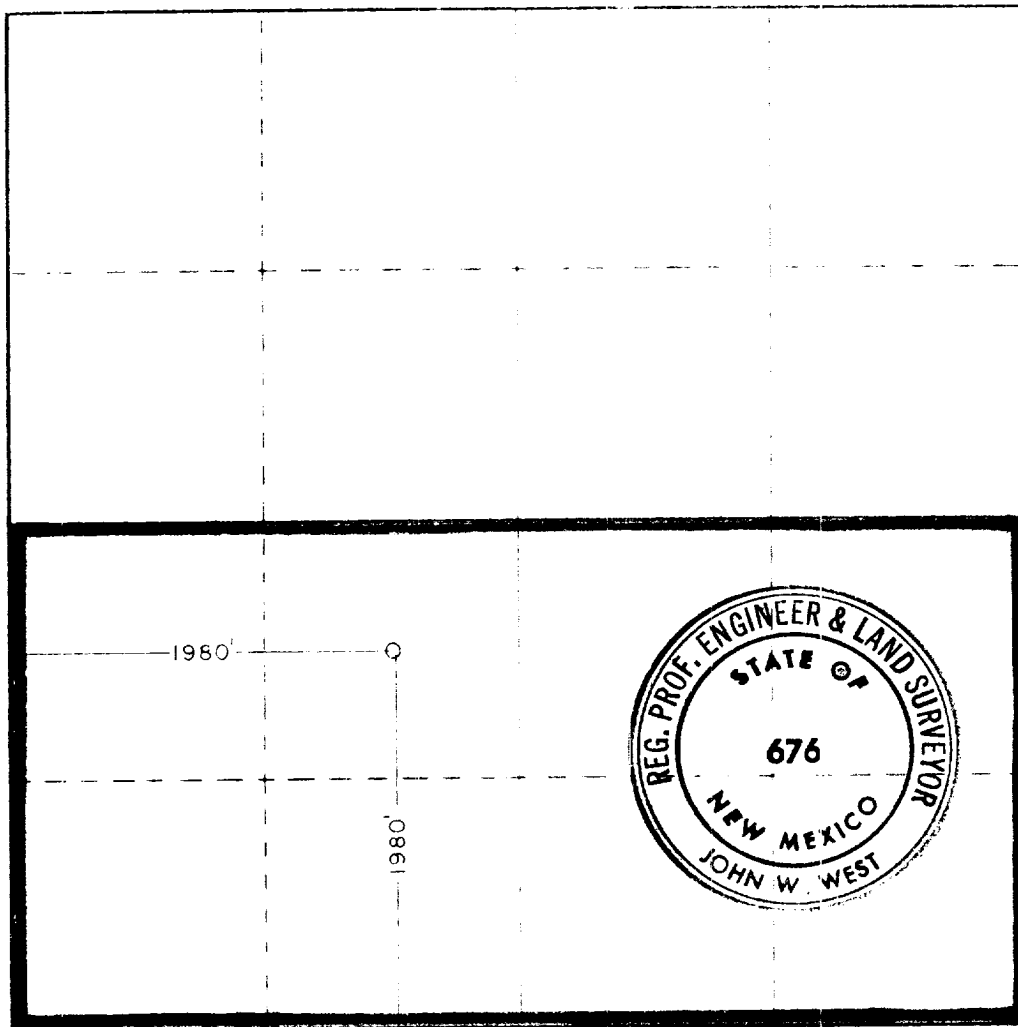

CERTIFICATION

I hereby certify that the information contained herein is true and complete to the best of my knowledge and belief.

Stephen Smith

Signature
Stephen Smith

Position
Engineering Assistant

Signature
Perry R. Bass

Date
January 5, 1982

I hereby certify that the well location shown on this plat was plotted from field notes of actual surveys made by me or under my supervision and that the same is true and correct to the best of my knowledge and belief.

Date Surveyed
Dec. 29, 1981

Registered Professional Engineer
at Large - Surveyor

John W. West

Certificate No. JOHN W. WEST 676
PATRICK A. ROMERO 6663
Ronald J. Eidson 3239

ALTERNATE POSITION FOR CHOKE MANIFOLD
MASTER VALVES TO BE FLANGED OR CLAMPED.

CHOKE AND ONE 4" VALVE TO CONTROL
CONTINUATION OF THE 4" LINE. IF
LOCATED REMOTELY FROM WELL HEAD,
ANOTHER MASTER VALVE SHOULD BE
INSTALLED AT THE REMOTE LOCATION.
ONE CHOKE IS TO BE ADJUSTABLE. THE
OTHER MAY BE EITHER ADJUSTABLE
OR POSITIVE.

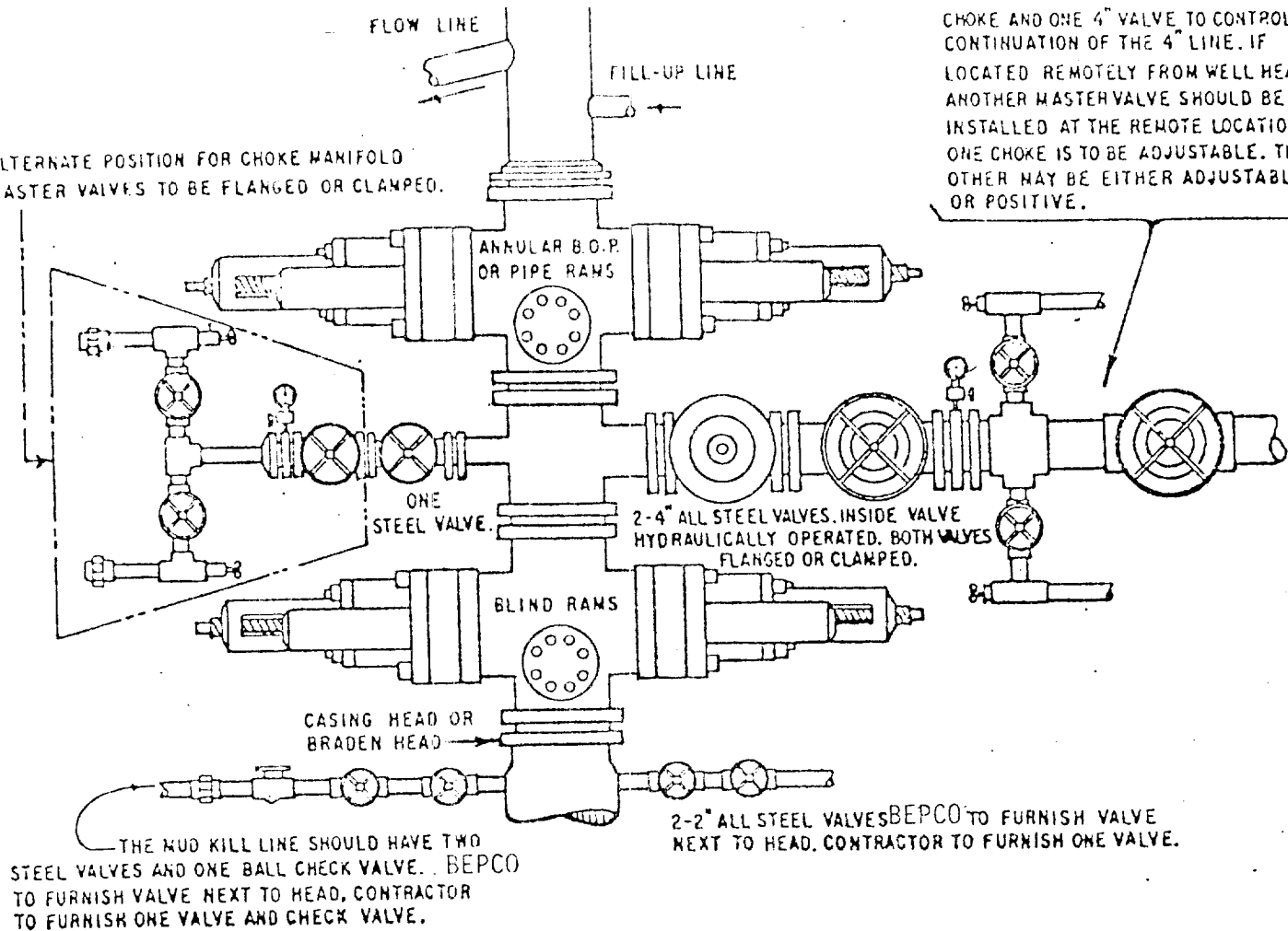

THE FOLLOWING CONSTITUTE MINIMUM BLOWOUT PREVENTER REQUIREMENTS

- A. CONDITIONS MAY BE MET BY EITHER
 - (1) AN ANNULAR BLOWOUT PREVENTER ON TOP AND BLIND RAMS BELOW WITH A CHOKE SPOOL BETWEEN THEM.
 - (2) PIPE RAMS ON TOP AND BLIND RAMS BELOW WITH A CHOKE SPOOL BETWEEN THEM.
 - (3) A DUAL BLOWOUT PREVENTER WITH PIPE RAMS ON TOP AND BLIND RAMS BELOW WITH A SIDE OUTLET BETWEEN THE RAMS AT LEAST FOUR INCHES DIAMETER.
- B. OPENINGS BETWEEN RAMS TO BE FLANGED, STUDDED OR CLAMPED.
- C. ALL CONNECTIONS FROM OPERATING MANIFOLD TO PREVENTERS TO BE ALL STEEL HOSE OR TUBE A MINIMUM OF ONE INCH IN DIAMETER
- D. THE AVAILABLE CLOSING PRESSURE SHALL BE AT LEAST 15% IN EXCESS OF THAT REQUIRED WITH SUFFICIENT VOLUME TO OPERATE THE B.O.P.'s.
- E. ALL CONNECTIONS TO AND FROM PREVENTERS TO HAVE A PRESSURE RATING EQUIVALENT TO THAT OF THE B.O.P.'s.
- F. MANUAL CONTROLS TO BE INSTALLED BEFORE DRILLING CEMENT PLUG.
- G. KELLY COCK TO BE INSTALLED ON KELLY.
- H. INSIDE BLOWOUT PREVENTER TO BE AVAILABLE ON RIG FLOOR.

BEPCO III

TWO CLOSURE HYDRAULIC BLOWOUT PREVENTERS

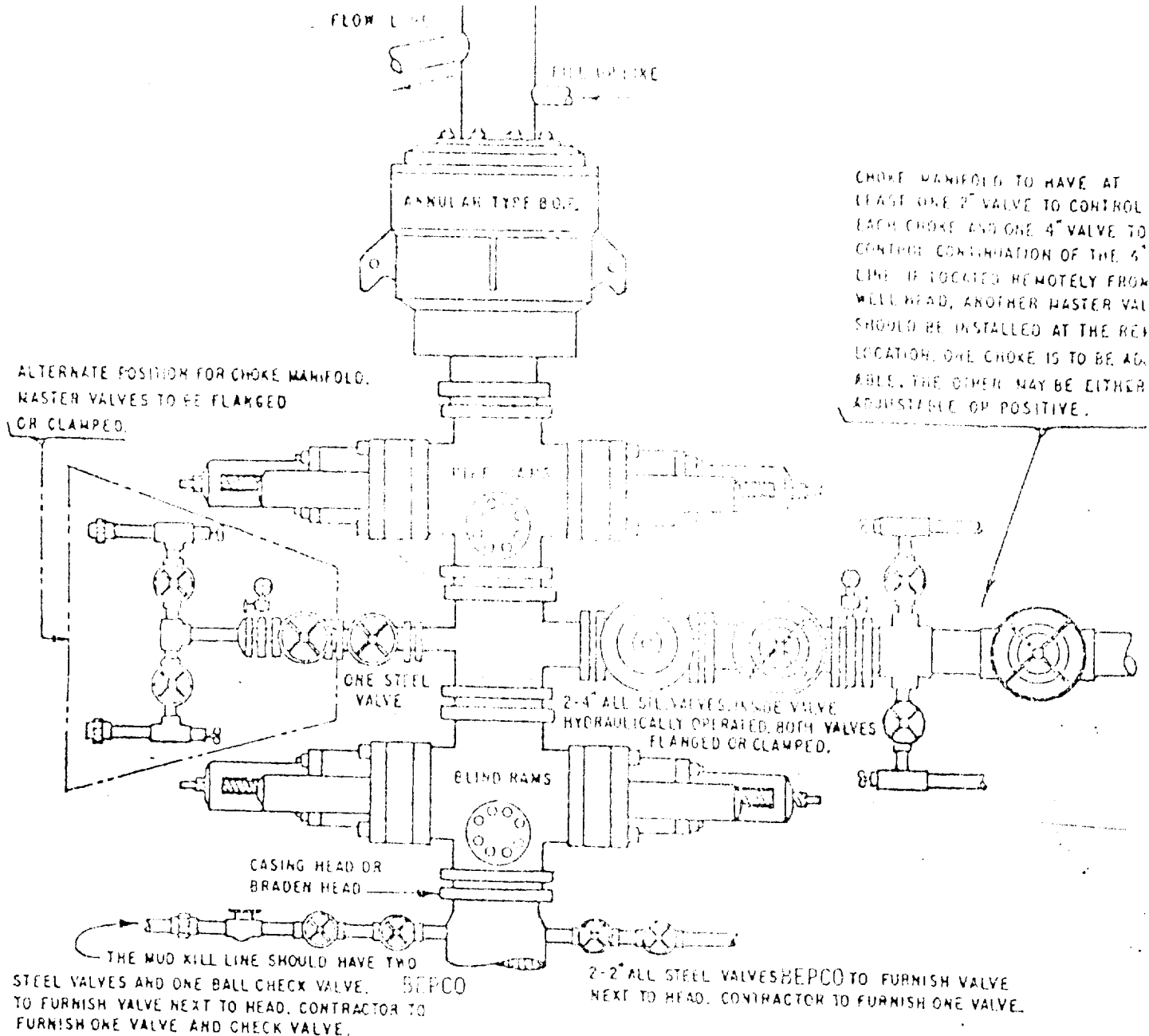

THE FOLLOWING CONSTITUTE MINIMUM BLOWOUT PREVENTER REQUIREMENTS

- A. CONDITIONS MAY BE MET BY AN ANNULAR TYPE BLOWOUT PREVENTER ON TOP AND A CHOKE SPOOL BELOW AND EITHER
 - (1) TWO RAM TYPE BLOWOUT PREVENTERS BELOW THE SPOOL, THE LOWER UNIT CONTAINING BLIND RAMS AND THE UPPER UNIT CONTAINING PIPE RAMS, OR
 - (2) A DUAL BLOWOUT PREVENTER BELOW THE SPOOL WITH BLIND RAMS ON BOTTOM AND PIPE RAMS ON TOP.
- B. OPENING ON CHOKE SPOOL TO BE FLANGED, STUDDED OR CLAMPED.
- C. ALL CONNECTIONS FROM OPERATING MANIFOLDS TO PREVENTERS TO BE ALL STEEL PIPE OR TUBE A MINIMUM OF ONE INCH IN DIAMETER.
- D. THE AVAILABLE CLOSING PRESSURE SHALL BE AT LEAST 15% IN EXCESS OF THAT REQUIRED WITH SUFFICIENT VOLUME TO OPERATE THE BOP.
- E. ALL CONNECTIONS TO AND FROM PREVENTER TO HAVE A PRESSURE RATING EQUIVALENT TO THAT OF THE BOP.
- F. MANUAL CONTROLS TO BE INSTALLED BEFORE DRILLING CEMENT PLUG.
- G. KELLY COCK TO BE INSTALLED ON KELLY.
- H. INSIDE BLOWOUT PREVENTER TO BE AVAILABLE ON RIG FLOOR.
- I. DUAL OPERATING CONTROLS ONE LOCATED BY DRILLERS POSITION AND THE OTHER LOCATED A SAFE DISTANCE FROM THE RIG FLOOR.

BEPCO IV

THREE CLOSURE HYDRAULIC BLOWOUT PREVENTERS