

SUPPLEMENTAL DRILLING DATA

GLENN COPE  
WELL #1 FEDERAL 30 COM  
1090' FNL & 560' FEL SEC. 30-22S-25E  
EDDY COUNTY, NEW MEXICO

1. SURFACE FORMATION: Alluvium soils of Quaternary Age.

2. ESTIMATED GEOLOGIC TOPS:

Yates	20'	Cisco	8000'
Capitan	550'	Atoka	9500'
Cherry Canyon	1700'	Morrow	9900'
Bone Spring	4100'	Barnett	10350'
Wolfcamp	7600'		

3. POSSIBLE WATER AND HYDROCARBON BEARING ZONES:

Water: Down to middle of Capitan  
Oil: Cherry Canyon  
Gas: Atoka, Morrow

4. PROPOSED CASING PROGRAM:

<u>Size</u>	<u>Interval</u>	<u>Weight</u>	<u>Grade</u>	<u>Joint</u>	<u>Condition</u>
13 3/8"	0 - 40'	48 #	H-40	STC	New
9 5/8"	0 - 2500'	36 #	K-55	STC	New
5 1/2"	0 - 1600'	17 #	N-80	LTC	New
	1600 - 8000'	17 #	K-55	STC	New
	8000 - 10500'	17 #	N-80	LTC	New

5. PRESSURE CONTROL EQUIPMENT: Blowout preventer stack will consist of an annular-type preventer and two ram-type preventers with 3000 psi working pressure. A sketch of BOP is attached.

6. PROPOSED MUD PROGRAM:

- 0 - 600' Spud mud w/paper added to control seepage. Add LCM as necessary if loss of circulation becomes a problem.
- 600 - 2500' Drill w/fresh water with additives as needed.
- 2500 - 10500' Drill w/brine increasing weight as hole conditions dictate.

7. AUXILLARY EQUIPMENT:

- A. Kelly cock in kelly.
- B. Full-opening valve on rig floor in open position at all times ready to be stabbed into drillpipe if necessary.
- C. Rotating drilling head.

8. TESTING, LOGGING AND CORING PROGRAMS:

- A. DST's in Atoka and Morrow, if warranted.
- B. No coring is planned.
- C. CNL-FDC w/GR, and DLL/Micro SFL.

9. ABNORMAL PRESSURES, TEMPERATURES OR HYDROGEN SULFIDE GAS: None anticipated. Sufficient material will be kept on location to increase mud weight to handle anticipated pressures.

10. ANTICIPATED STARTING DATE AND DURATION OF THE OPERATIONS:

- A. Road and pad construction: February 6, 1982
- B. Spud well: February 10, 1982
- C. Duration of drilling and completion operations should be about 35 - 70 days.

SDD Exhibit "A"  
BLOWOUT PREVENTER SKETCH

Glenn Cope  
Well #1 Federal 30 Com.  
1090' FNL & 560' FEL Sec. 30-22S-25E

900 SERIES

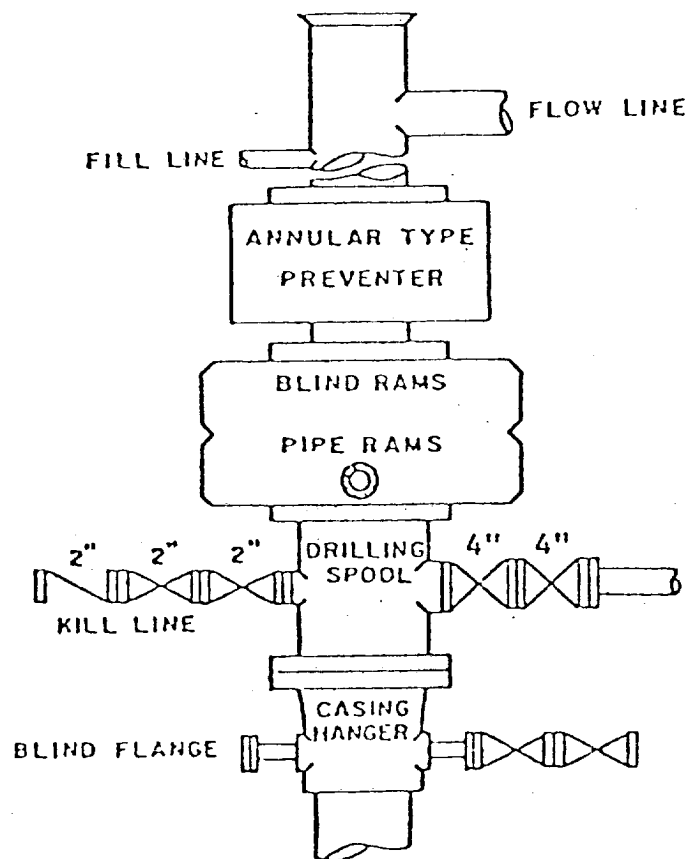

SURFACE USE PLAN

FOR

DRILLING, COMPLETING AND PRODUCING

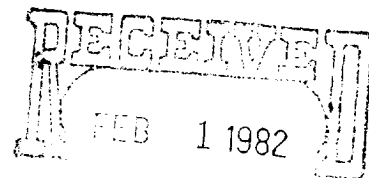

GLENN COPE  
WELL #1 FEDERAL 30 COM  
1090' FNL & 560' FEL SEC. 30-22S-25E  
EDDY COUNTY, NEW MEXICO

LOCATED: 11½ air miles west-southwest of Carlsbad, N. M.

FEDERAL LEASE NUMBER: NM-34650

LEASE ISSUED: 12-1-78 for a primary term of ten years.

RECORD LESSEE: El Paso Natural Gas Co.

OPERATOR'S AUTHORITY: Designation of Operator from lessee

BOND COVERAGE: Lessee's \$150,000 nation-wide bond

ACRES IN LEASE: 878.84

SURFACE OWNERSHIP: U. S. Government with a grazing lease issued to  
Alvin Gene and David H. Kincaid  
Queen Route, Carlsbad, New Mexico 88220

POOL: Undesignated Morrow

WELL SPACING: 320 acres

EXHIBITS:

- A. County Road Map
- B. Topographic Map
- C. Oil & Gas Map
- D. Sketch of Well Pad

## ROAD LOG TO PROPOSED DRILLSITE

STARTING POINT is at Stuckeys in southwestern Carlsbad, New Mexico at the intersection of County Road Eddy-672 with Federal Highways US 62 & 180.

- 0.00 Turn right (west) on E-672 and proceed in a westerly and south-westerly direction for a distance of 3.43 miles. There is a "Rayroux & Kincaid" sign at this intersection.
- 3.43 Turn right (west) on a caliche road and proceed in a westerly direction for a distance of 5.15 miles to a fork in the road (fork is 0.08 mile past Coquina's gas well on right).
- 8.58 Continue straight ahead in a westerly direction for a distance of 4.60 miles to old abandoned ranch house.
- 13.18 Turn right (northwest) on ranch road which follows on right side of fence and proceed in a northwesterly direction for a distance of 0.61 mile.
- 13.79 New road begins at this point: Turn right (northeast) and proceed for a distance of 0.08 mile to the south edge of the proposed drillsite.
- 13.87 PROPOSED DRILLSITE. (Well #1 Federal 30 Com.)

## THIRTEEN POINT PROGRAM

- 1. EXISTING ROADS:
  - A. Existing roads, which lead to the proposed drillsite, are shown on Exhibits "A" & "B".
  - B. It is planned to upgrade the 0.61 mile of two-track ranch road from mileage-13.18 to 13.79 on road log by blading the old road and then capping with caliche.
- 2. PROPOSED NEW ROAD: Proposed new access road will be 0.08 mile in length. Exhibit "B" shows proposed route which will originate at mileage-13.79 on the road log and will terminate at the south side of the proposed drill pad. The center of the proposed new road has been staked and flagged.
  - A. Width: 12 feet with 20-foot R-O-W.
  - B. Surfacing Material: The new road will be surfaced with caliche.

- C. Maximum Grade: Less than one percent.
  - D. Turnouts: None necessary.
  - E. Road Design: New road will be constructed by blading the proposed R-O-W and surfacing the driving area with caliche.
  - F. Culverts: None necessary.
  - G. Gates, Cattleguards: None necessary.
3. LOCATION OF EXISTING WELLS: Existing wells in the vicinity of the proposed drillsite are shown on Exhibit "C".
4. LOCATION OF EXISTING AND/OR PROPOSED FACILITIES:
- A. NM-34650 is a non-producing lease and there are no production facilities on the leasehold.
  - B. If the well is productive, production and storage facilities will be installed on the well pad.
5. LOCATION AND TYPE OF WATER SUPPLY: Water for leasehold operations will be purchased from a commercial source and trucked to the location.
6. SOURCE OF CONSTRUCTION MATERIALS: Material for construction of the proposed new road and well pad will be obtained from the excess material removed from the reserve pit area.
7. METHODS OF HANDLING WASTE DISPOSAL:
- A. Drill cuttings will be disposed of in the drilling pits.
  - B. Drilling fluids will be allowed to evaporate in the drilling pits until the pits are dry.
  - C. Water produced during tests will be disposed of in the drilling pits.
  - D. Oil produced during tests will be produced into temporary test tanks.
  - E. Trash, waste paper, garbage, and junk will be buried in a trash pit and covered with a minimum of 24 inches of dirt. All waste material will be contained to prevent scattering by the wind. Location of the trash pit is shown on Exhibit "D".
  - F. All trash and debris will be buried or removed from the wellsite within 30 days after finishing each drilling and/or completion operation.

8. ANCILLARY FACILITIES: None anticipated.
9. WELLSITE LAYOUT:
- A. The wellsite has been surveyed and a 400' x 400' area has been staked and flagged.
  - B. The dimensions and relative location of the drill pad, mud pit, and trash pit with respect to the well bore are shown on Exhibit "D".
  - C. The location will need a cut of several feet on the south and east sides and a fill on the north and west sides.
  - D. The well pad will be surfaced with caliche.
10. PLANS FOR RESTORATION OF THE SURFACE:
- A. after completion of drilling and/or completion operations, all equipment and other material not needed for operations will be removed. Pits will be filled and the location cleaned of all trash and junk to leave the wellsite in as aesthetically pleasing condition as possible.
  - B. Any unguarded pits containing fluids will be fenced until they are filled.
  - C. After abandonment, all equipment, trash and junk will be removed and the location cleaned. Any special rehabilitation and/or special revegetation requirements of the BLM will be complied with and accomplished as expeditiously as possible.
11. OTHER INFORMATION:
- A. Topography: The terrain of the area surrounding the location is hilly. The location is in a low area between two ridges and slopes to the south toward Little McKittrick Draw. Regional slope is to the east toward the Pecos River.
  - B. Soil: Top soil at the wellsite is rocky sandy loam.
  - C. Land Type & Use: The vicinity surrounding the drillsite is semi-arid rangeland and its primary use is for grazing.
  - D. Flora: Vegetative cover is generally sparse. Flora consists primarily of catclaw, yucca and broomweed interspersed with range grasses and other desert plants.

- E. Fauna: No wildlife was observed, however fauna for this type of habitat normally consists of rabbits, rodents, coyotes, skunks, lizards, snakes, quail, dove, and other small birds.
- F. Ponds & Streams: None.
- G. Water Wells: Nearest water well is 0.65 mile to the southeast.
- H. Residences & Other Structures: There are no occupied dwellings within two miles of the drillsite.
- I. Archaeological, Historical & Cultural Sites: New Mexico Archaeological Services, Inc. of Carlsbad, N. M. has made a survey of the proposed drillsite and new road areas and has recommended that the proposed construction work be approved.

12. OPERATOR'S REPRESENTATIVE: Representative responsible for assuring compliance with the approved Surface Use Plan:

Glenn Cope  
1604 W. Front Avenue  
Midland, Texas 79701  
Office Phone 915-684-7827  
Home Phone 915-683-2047

13. CERTIFICATION:

I hereby certify that I, or persons under my direct supervision, have inspected the proposed drillsite and access route; that I am familiar with the conditions which presently exist; that the statements made in this plan are, to the best of my knowledge true and correct; and, that the work associated with the operations proposed herein will be performed by GLENN COPE and his sub-contractors in conformity with this plan and the terms and conditions under which it is approved.

January 30, 1982  
Date

  
James A. Knauf, Agent



PLANNING AND PROGRAMMING DIVISION

BUREAU OF PUBLIC ROADS

R.24 E.

R.25 E.

R.26 E.

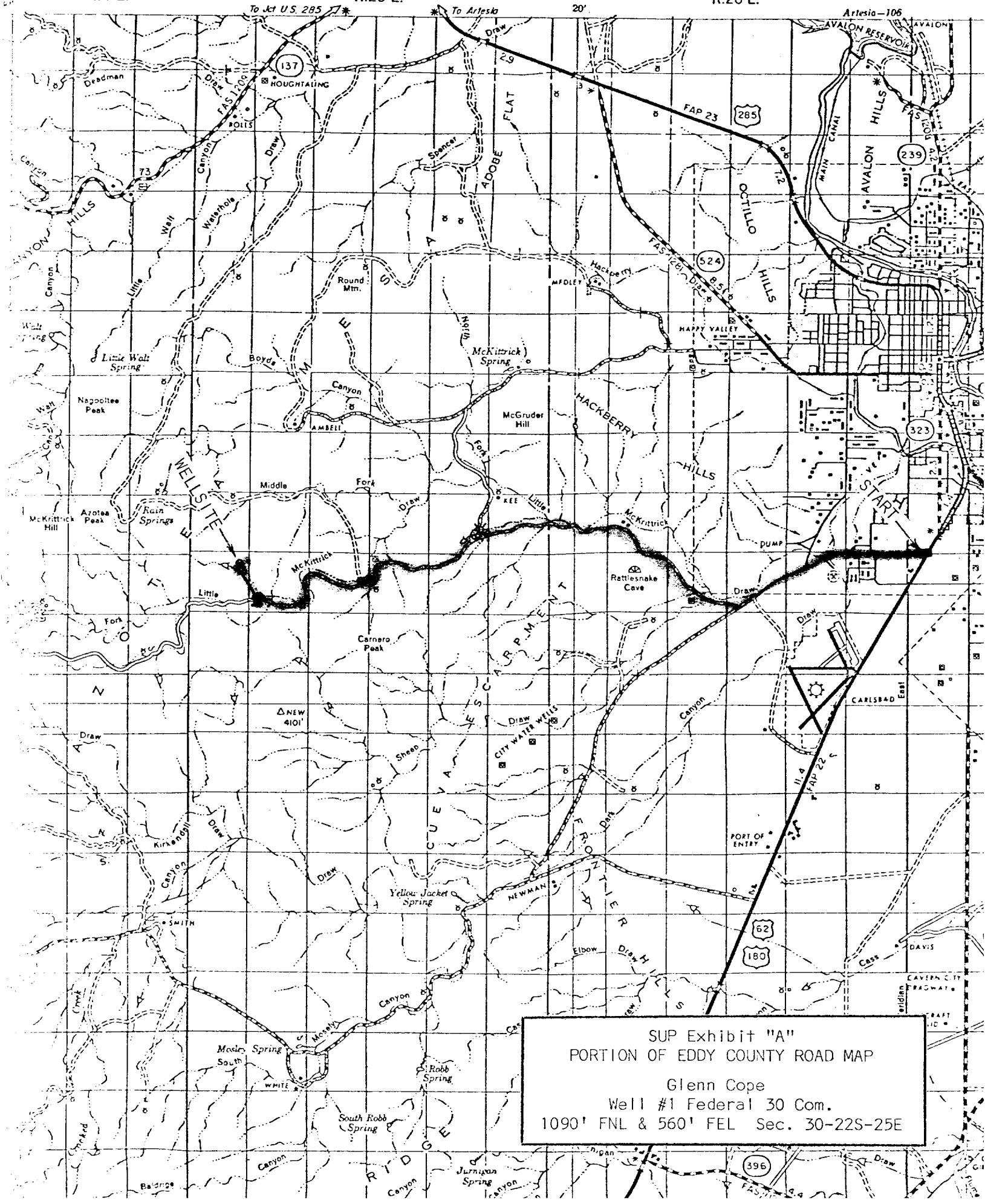

SUP Exhibit "A"  
PORTION OF EDDY COUNTY ROAD MAP

Glenn Cope  
Well #1 Federal 30 Com.  
1090' FNL & 560' FEL Sec. 30-22S-25E

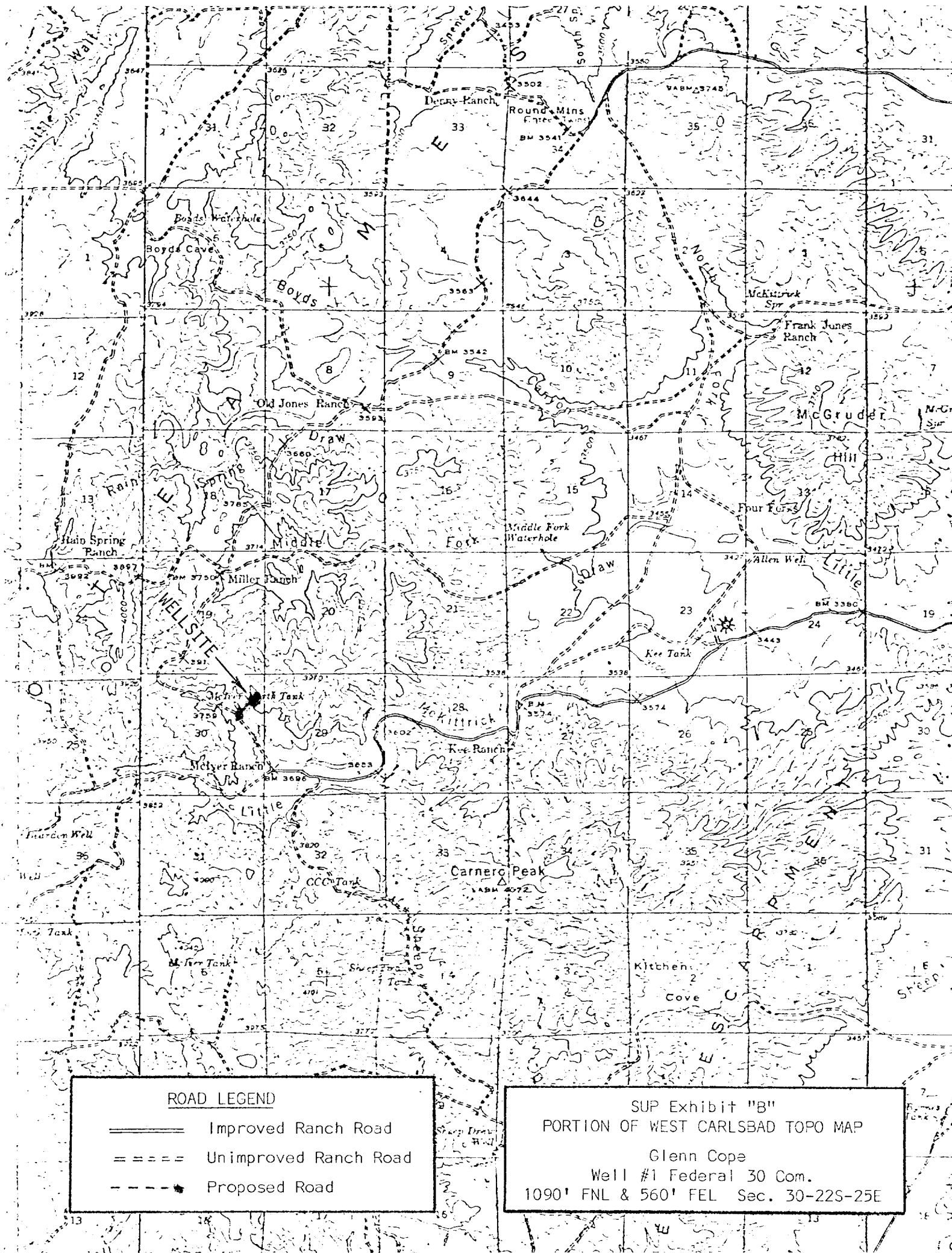

ROAD LEGEND

- ==== Improved Ranch Road
- ===== Unimproved Ranch Road
- Proposed Road

SUP Exhibit "B"  
PORTION OF WEST CARLSBAD TOPO MAP

Glenn Cope  
Well #1 Federal 30 Com.  
1090' FNL & 560' FEL Sec. 30-22S-25E

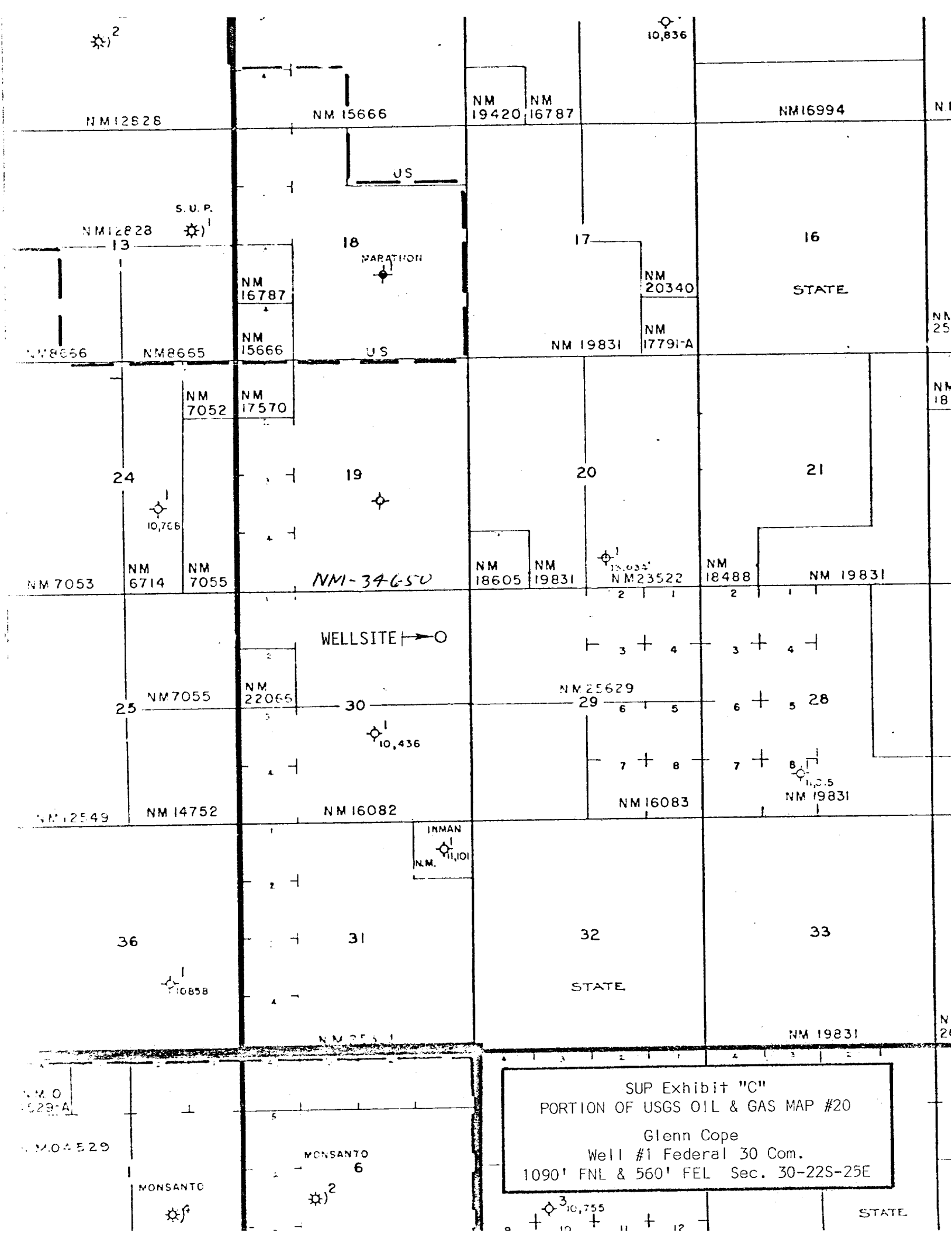

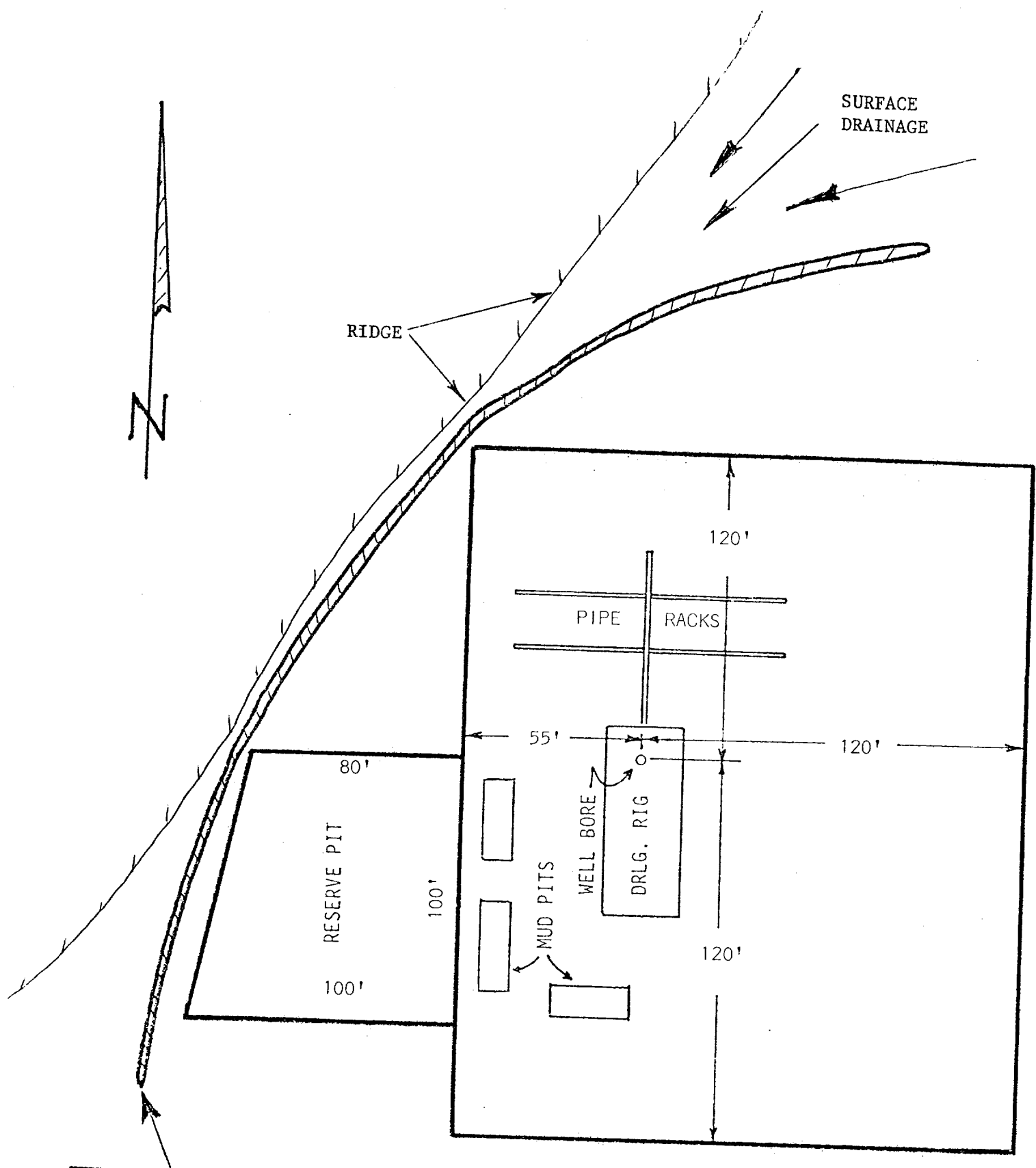

PROPOSED DIKE -- To deflect surface waters around well pad and reserve pit.

SUP Exhibit "D"  
SKETCH OF WELL PAD  
Glenn Cope  
Well #1 Federal 30 Com.  
1090' FNL & 560' FEL Sec. 30-22S-25E

STATE OF NEW MEXICO  
ENERGY AND MINERALS DEPARTMENT  
OIL CONSERVATION DIVISION

RECEIVED

JAN 15 1982

O. C. D.  
ARTESIA, OFFICE

IN THE MATTER OF THE HEARING  
CALLED BY THE OIL CONSERVATION  
DIVISION FOR THE PURPOSE OF  
CONSIDERING:

CASE NO. 7454  
Order No. R-6879

APPLICATION OF URIAH EXPLORATION, INC.  
FOR APPROVAL OF AN UNORTHODOX GAS WELL  
LOCATION, EDDY COUNTY, NEW MEXICO.

ORDER OF THE DIVISION

BY THE DIVISION:

This cause came on for hearing at 9 a.m. on January 6, 1982, at Santa Fe, New Mexico, before Examiner Daniel S. Nutter.

NOW, on this 12th day of January, 1982, the Division Director, having considered the testimony, the record, and the recommendations of the Examiner, and being fully advised in the premises,

FINDS:

- (1) That due public notice having been given as required by law, the Division has jurisdiction of this cause and the subject matter thereof.
- (2) That the applicant, Uriah Exploration, Inc., seeks approval of an unorthodox gas well location 1090 feet from the North line and 560 feet from the East line of Section 30, Township 22 South, Range 25 East, NMPM, to test the Wolfcamp and Pennsylvanian formations, Eddy County, New Mexico.
- (3) That the N/2 of said Section 30 is to be dedicated to the well.
- (4) That a well at said unorthodox location will better enable applicant to produce the gas underlying the proration unit.
- (5) That no offset operator objected to the proposed unorthodox location.
- (6) That approval of the subject application will afford the applicant the opportunity to produce its just and equitable share of the gas in the subject pool, will prevent the economic

loss caused by the drilling of unnecessary wells, avoid the augmentation of risk arising from the drilling of an excessive number of wells, and will otherwise prevent waste and protect correlative rights.

IT IS THEREFORE ORDERED:

(1) That the application of Uriah Exploration Inc. is hereby approved for an unorthodox gas well location for the Wolfcamp and Pennsylvanian formations for a well to be located at a point 1090 feet from the North line and 560 feet from the East line of Section 30, Township 22 South, Range 25 East, NMPM, Eddy County, New Mexico.

(2) That the N/2 of said Section 30 shall be dedicated to the above-described well.

(3) That jurisdiction of this cause is retained for the entry of such further orders as the Division may deem necessary.

DONE at Santa Fe, New Mexico, on the day and year hereinabove designated.

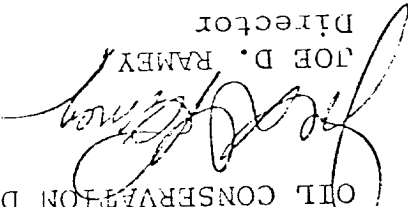
STATE OF NEW MEXICO  
OIL CONSERVATION DIVISION  
  
JOE D. RAMSEY  
Director

S H A L