

UNITED STATES  
DEPARTMENT OF THE INTERIOR  
GEOLOGICAL SURVEY

## APPLICATION FOR PERMIT TO DRILL, DEEPEN, OR PLUG BACK

## 1a. TYPE OF WORK

DRILL ☒DEEPEN ☐ RECEIVED PLUG BACK ☐

## b. TYPE OF WELL

OIL  
WELL ☒GAS  
WELL ☐OTHER ☐SINGLE  
ZONE ☒MULTIPLE  
ZONE ☐

## 2. NAME OF OPERATOR

Exxon Corporation ✓

JAN 14 1983

## 3. ADDRESS OF OPERATOR

P. O. Box 1600, Midland, TX 79702 O. C. D. ARTESIA, OFFICE

## 4. LOCATION OF WELL (Report location clearly and in accordance with any State requirements.)\*

At surface

660' F&amp;L and 1980' F&amp;L of Section

At proposed prod. zone

## 14. DISTANCE IN MILES AND DIRECTION FROM NEAREST TOWN OR POST OFFICE\*

6 miles North from Carlsbad

15. DISTANCE FROM PROPOSED\*  
LOCATION TO NEAREST  
PROPERTY OR LEASE LINE, FT.  
(Also to nearest drlg. unit line, if any)660' lease line  
660' drlg. line

## 16. NO. OF ACRES IN LEASE

2261.75

17. NO. OF ACRES ASSIGNED  
TO THIS WELL

40

18. DISTANCE FROM PROPOSED LOCATION\*  
TO NEAREST WELL, DRILLING, COMPLETED,  
OR APPLIED FOR, ON THIS LEASE, FT.

1320' S to #15

## 19. PROPOSED DEPTH

4700'

## 20. ROTARY OR CABLE TOOLS

Rotary

## 21. ELEVATIONS (Show whether DF, RT, GR, etc.)

3272.8 GR

## 22. APPROX. DATE WORK WILL START\*

February 16, 1983

## 23.

## PROPOSED CASING AND CEMENTING PROGRAM

SIZE OF HOLE	SIZE OF CASING	WEIGHT PER FOOT	SETTING DEPTH	QUANTITY OF CEMENT
17 1/2"	13 3/8"	54.5#	40'	21 sx CIRCULATE
12 1/4"	8 5/8"	24.0#	600'	280 sx CIRCULATE
7 7/8"	5 1/2"	14.0#	4700'	1800 sx CIRCULATE

Gas is not dedicated to a purchaser.

IN ABOVE SPACE DESCRIBE PROPOSED PROGRAM: If proposal is to deepen or plug back, give data on present productive zone and proposed new productive zone. If proposal is to drill or deepen directionally, give pertinent data on subsurface locations and measured and true vertical depths. Give blowout preventer program, if any.

## 24.

SIGNED

*Melba Knippling*

TITLE

Unit Head

DATE

December 22, 1982

(This space for Federal or State office use)

PERMIT NO.

APPROVED

APPROVAL DATE

(ORIG. SGD.) DAVID R. GLASS

APPROVED BY

TITLE

DATE

CONDITIONS OF APPROVAL

JAN 6 1983

*for* JAMES A. GILLHAM  
DISTRICT SUPERVISOR

\*See Instructions On Reverse Side

RECEIVED

DEC 30 1982

MINERAL RESOURCES  
ROSWELL, NM 87068Post ID-1  
1-21-83  
New Loc.  
# API



**EXXON CORPORATION**  
**YATES FEDERAL "C" NO. 13**  
 1980' FSL, 660' FWL  
 Section 31, T20S, R28E  
 Eddy County, New Mexico  
 Federal Lease No. 01119

1. The geologic name of the surface formation: Recent.

2. The estimated tops of important geologic markers:

Salado	150'
Yates	600'
Seven Rivers	800'
Queen	1200'
Grayburg	1350'
San Andres	1500'
Delaware	2500'
Bone Spring	4700'

3. The estimated depths at which anticipated water, oil, gas, or other mineral bearing formations are expected to occur:

Water	60' - 150'
Oil	
Delaware	2500'
Bone Spring	4700'

4. Proposed casing program:

<u>STRING</u>	<u>SIZE</u>	<u>WEIGHT/GRADE</u>	<u>CONDITION</u>	<u>DEPTH INTERVAL</u>
Conductor	13-3/8"	54.5#/K-55	New	0- 40'
Surface	8-5/8"	24#/K-55	New	0- 600'
Production	5-1/2"	14#/K-55	New	0-4700'
Tubing	2-7/8"	6.5#/J-55	New	0-4600'

5. Minimum specifications for pressure control equipment:

- A. Wellhead equipment - Threaded type, 2000 psi WP for 8-5/8" x 5-1/2" casing program with 2-7/8" tubing hanger.
- B. Blowout preventers - Refer to attached drawings and lists of equipment titled "Type II-C" for description of BOP stacks and choke manifold.
- C. BOP control unit - Unit will be hydraulically operated and have at least two control stations.

# MIDLAND DRILLING ORGANIZATION BLOWOUT PREVENTER SPECIFICATION TYPE II - C

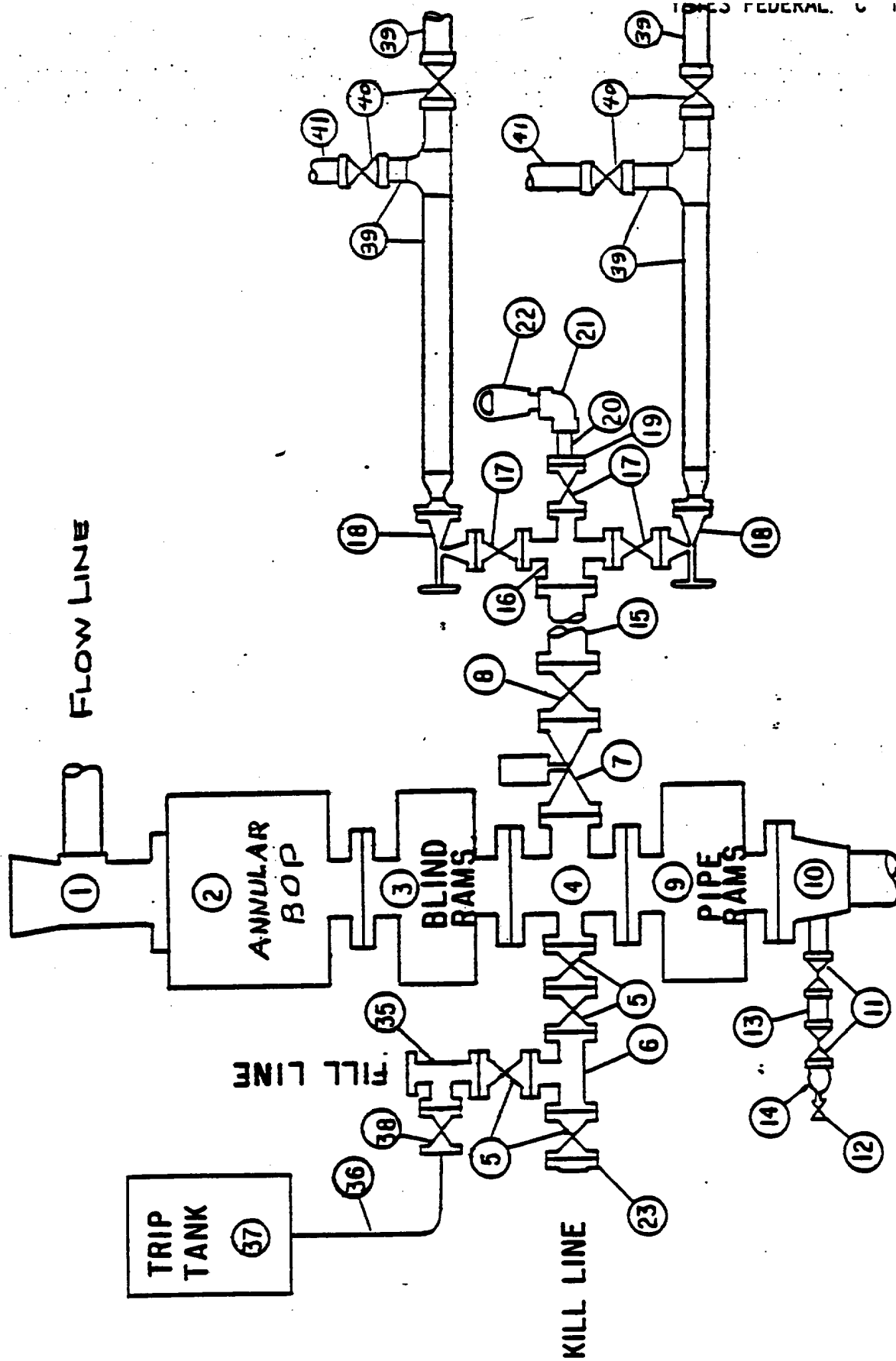

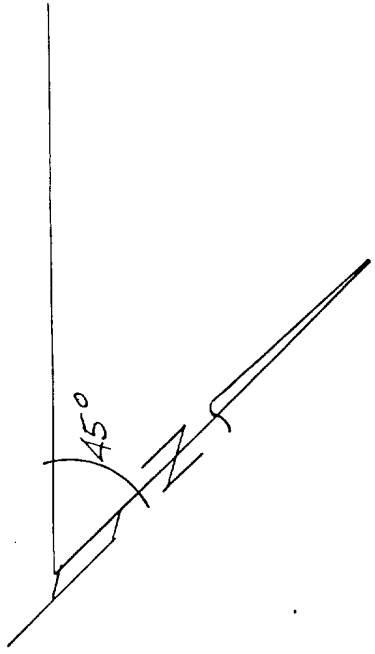

X 200'S  
+0.5'

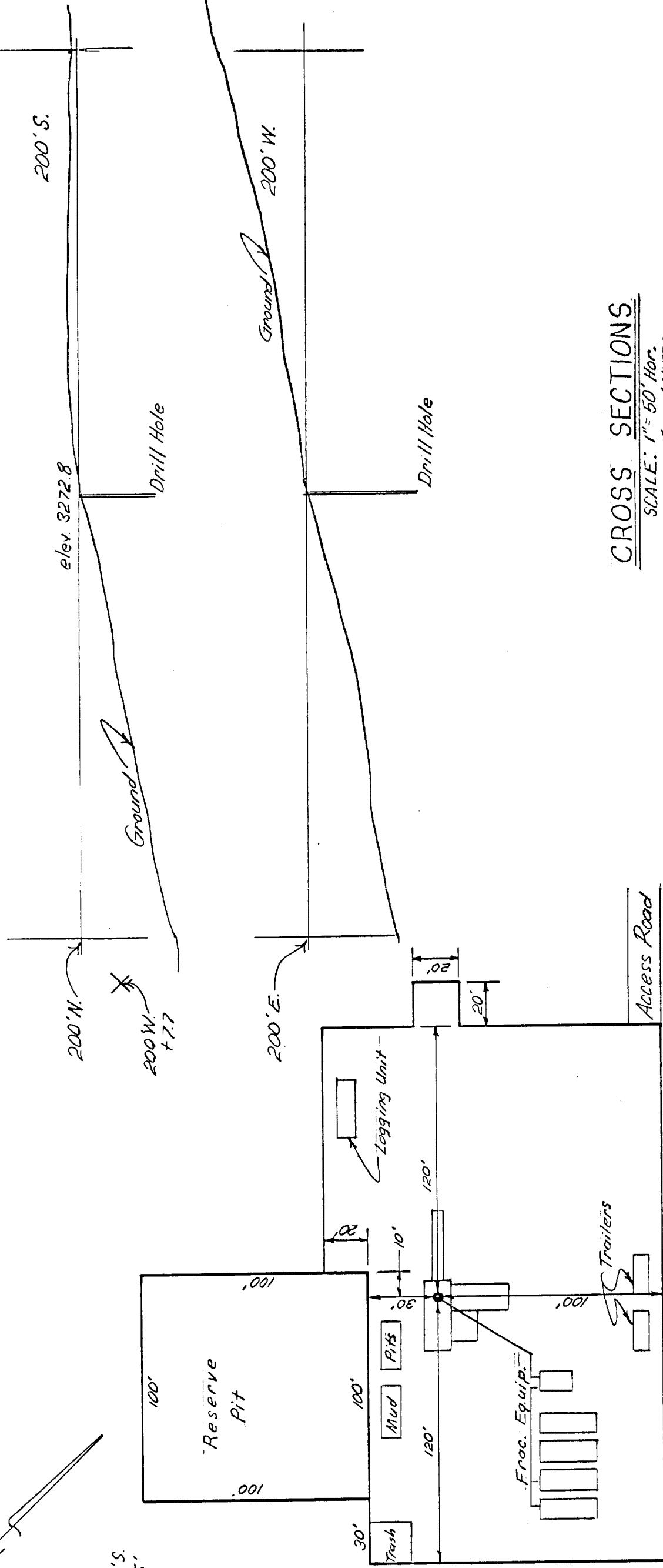

WELL SITE LAYOUT

SCALE: 1" = 50'  
Y-DOOR N45°W

X 200'E  
-7.7'

CROSS SECTIONS

SCALE: 1" = 50' Hor.  
1" = 10' Vert.

EXHIBIT "B"

YATES-FEDERAL-"C" # 13 NW/4 SW/4 SECTION 31; T20S; R28E BURTON FLAT EDDY CO., NEW MEXICO		EXXON COMPANY, U.S.A. (a division of Exxon Corporation) PRODUCTION DEPARTMENT	
DRAWN C. S. Smith	ENGR. SECTION Civil	DATE 12/12/82	FILE NO. WB-7968-C
CHECKED	APPROVED	JOB NO.	SCALE Shown
REVISED			