

MEXICO OIL CONSERVATION COMMISSION
WELL LOCATION AND ACREAGE DEDICATION PLAT

Form C-102
Supersedes C-128
Effective 1-1-65

All distances must be from the outer boundaries of the Section

Operator HNG OIL CO.			Lease McKITTRICK 30 FED.			Well No. 1		
Tract Letter C	Section 30	Township 22 SOUTH	Range 26 EAST	County EDDY				
Actual Portage Location of Well: 660 feet from the NORTH line and 2285 feet from the WEST line								
Ground Level Elev. 3587.5	Producing Formation Morrow		Pool Happy Valley <i>Morrow</i>			Dedicated Acreage: 320 Acres		

1. Outline the acreage dedicated to the subject well by colored pencil or hatchure marks on the plat below.
2. If more than one lease is dedicated to the well, outline each and identify the ownership thereof (both as to working interest and royalty).
3. If more than one lease of different ownership is dedicated to the well, have the interests of all owners been consolidated by communitization, unitization, force-pooling, etc?

☐ Yes ☐ No If answer is "yes," type of consolidation _____

If answer is "no," list the owners and tract descriptions which have actually been consolidated (Use reverse side of this form if necessary.) _____

No allowable will be assigned to the well until all interests have been consolidated (by communitization, unitization, forced-pooling, or otherwise) or until a non-standard unit, eliminating such interests, has been approved by the Commission.

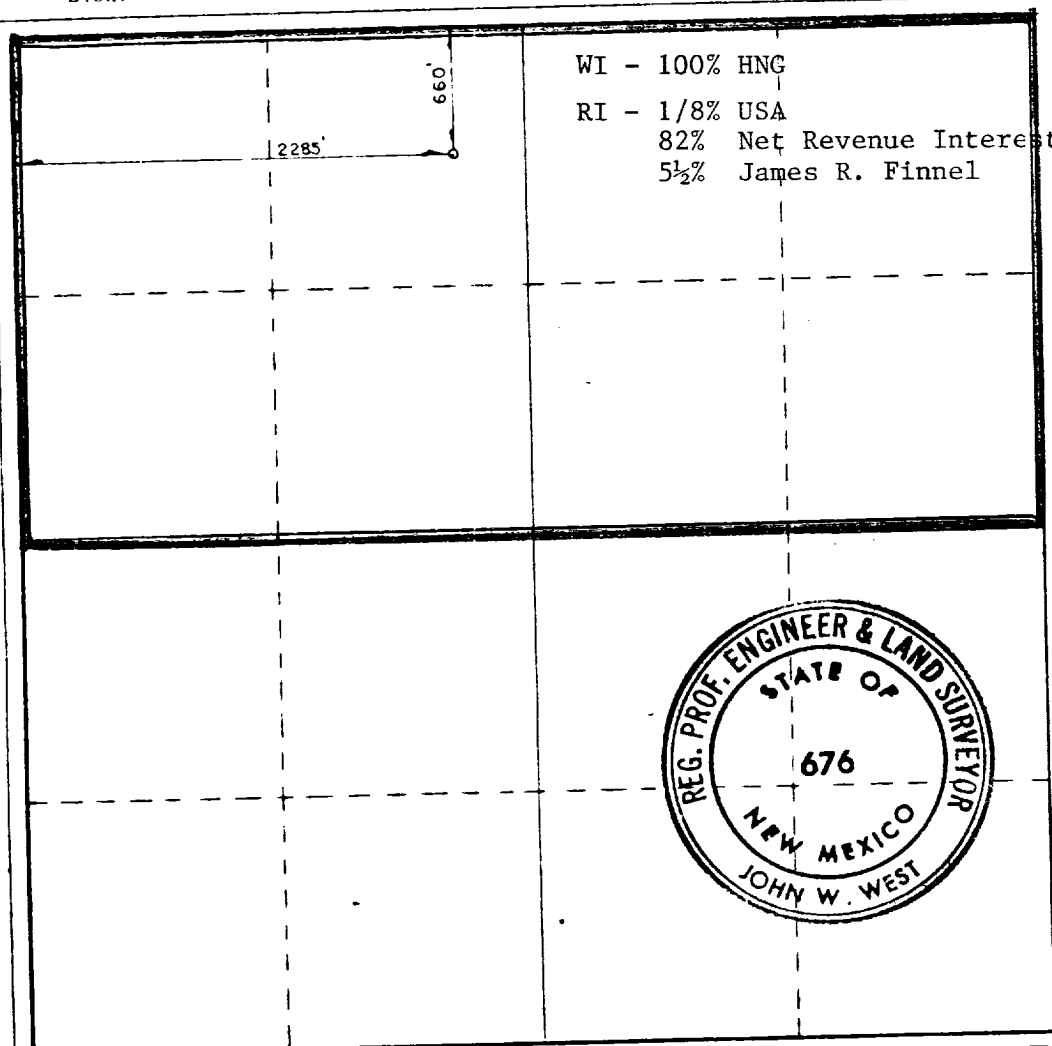

CERTIFICATION

I hereby certify that the information contained herein is true and complete to the best of my knowledge and belief.

Kelly J. Harold
Name
Kelly J. Harold

Position
Receptionist

Company
HNG Oil Company

Date
January 4, 1983

I hereby certify that the well location shown on this plat was plotted from field notes of actual surveys made by me or under my supervision, and that the same is true and correct to the best of my knowledge and belief.

Date Surveyed
DECEMBER 7, 1982

Registered Professional Engineer and/or Land Surveyor

John W. West

Certificate No
JOHN W. WEST N.M. #676

0 330 660 990 1320 1650 1980 2310 2640 2000 1600 1000 500 0