

30-015-24410

NO. OF COPIES RECEIVED	
DISTRIBUTION	
SANTA FE	✓
FILE	✓
U.S.G.S.	2
LAND OFFICE	✓
OPERATOR	✓

NEW MEXICO OIL CONSERVATION COMMISSION

RECEIVED

JAN 25 1983

O. C. D.

ARTESIA OFFICE

Form C-101
Revised 1-1-65

5A. Indicate Type of Lease

STATE ☒FEE ☐

5. State Oil & Gas Lease No.

I-324

APPLICATION FOR PERMIT TO DRILL, DEEPEN, OR PLUG BACK

1a. Type of Work		7. Unit Agreement Name	
b. Type of Well DRILL <input checked="" type="checkbox"/> DEEPEN <input type="checkbox"/> PLUG BACK <input type="checkbox"/> OIL WELL <input checked="" type="checkbox"/> GAS WELL <input type="checkbox"/> OTHER <input type="checkbox"/> SINGLE ZONE <input checked="" type="checkbox"/> MULTIPLE ZONE <input type="checkbox"/>		8. Farm or Lease Name Hondo State	
2. Name of Operator Mesa Petroleum Co. ✓		9. Well No. 7	
3. Address of Operator P.O. Box 2009 / Amarillo, Texas 79189		10. Field and Foot of Wellcat Undes. Burton Flat D.	
4. Location of Well UNIT LETTER E LOCATED 1980 FEET FROM THE North LINE AND 330 FEET FROM THE West LINE OF SEC. 32 TWP. 20S RGE. 28E NMPM		12. County Eddy	
11. Elevations (Show whether DF, RT, etc.) 3231.2		13. Proposed Depth 5000'	
21A. Kind & Status Plug. Bond Blanket		19A. Formation Delaware	
21B. Drilling Contractor TMBR Drilling Inc.		22. Approx. Date Work will start January 27, 1983	

PROPOSED CASING AND CEMENT PROGRAM

SIZE OF HOLE	SIZE OF CASING	WEIGHT PER FOOT	SETTING DEPTH	SACKS OF CEMENT	EST. TOP
12 1/4"	8 5/8"	24#	600'	200/300	surface
7 7/8"	4 1/2"	10.5#	5000'	500	cover all pay

Propose to drill a 12 1/4" hole with fresh water to approximately 600' and set 8 5/8" surface casing. Will circulate cement to surface, nipple up 3000 psi BOP's and drill 7 7/8" hole to TD.

APPROVAL VALID FOR 90 DAYS
PERMIT EXPIRES 8/2/83
UNLESS DRILLING UNDERWAY

XC: NMOCD-A (0+5), CEN RCDS, ACCTG, OPS (FILE), MIDLAND, HOBBS

IN ABOVE SPACE DESCRIBE PROPOSED PROGRAM; IF PROPOSAL IS TO DEEPEN OR PLUG BACK, GIVE DATA ON PRESENT PRODUCTIVE ZONE AND PROPOSED NEW PRODUCTIVE ZONE. GIVE BLOWOUT PREVENTER PROGRAM, IF ANY.

I hereby certify that the information above is true and complete to the best of my knowledge and belief.

Signed [Signature] Title Regulatory Agent Date 1-25-83

(This space for State Use)

Original Signed By
Leslie A. Clements

APPROVED BY _____ TITLE Supervisor District II DATE FEB 02 1983

CONDITIONS OF APPROVAL, IF ANY:

NEW MEXICO OIL CONSERVATION COMMISSION
WELL LOCATION AND ACREAGE DEDICATION PLAT

Form C-102
Supersedes C-128
Effective 1-1-65

All distances must be from the outer boundaries of the Section.

Operator MESA PETROLEUM COMPANY			Lease HONDO STATE		Well No. 7
Unit Letter E	Section 32	Township 20 SOUTH	Range 28 EAST	County EDDY	
Actual Footage Location of Well: 1980 feet from the NORTH line and 330 feet from the WEST line					
Ground Level Elev. 3231.2	Producing Formation DELAWARE		Pool UNDESIGNATED BURTON FLAT (D)		Dedicated Acreage: 40 Acres

1. Outline the acreage dedicated to the subject well by colored pencil or hachure marks on the plat below.
2. If more than one lease is dedicated to the well, outline each and identify the ownership thereof (both as to working interest and royalty).
3. If more than one lease of different ownership is dedicated to the well, have the interests of all owners been consolidated by communitization, unitization, force-pooling, etc?

☐ Yes ☐ No If answer is "yes," type of consolidation _____

If answer is "no," list the owners and tract descriptions which have actually been consolidated. (Use reverse side of this form if necessary.) _____

No allowable will be assigned to the well until all interests have been consolidated (by communitization, unitization, forced-pooling, or otherwise) or until a non-standard unit, eliminating such interests, has been approved by the Commission.

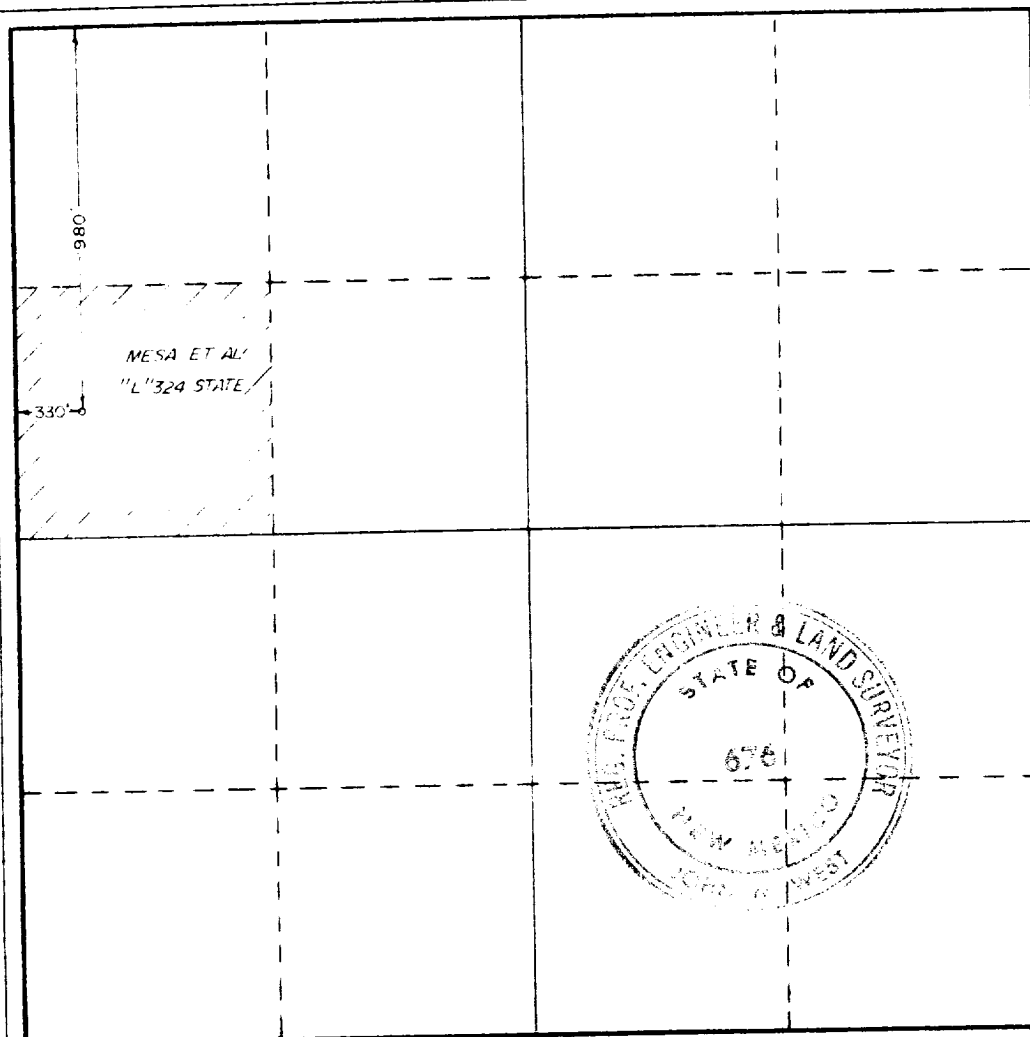

CERTIFICATION

I hereby certify that the information contained herein is true and complete to the best of my knowledge and belief.

Lloyd Reed
Name

LLOYD REED

Position

REGULATORY AGENT

Company

MESA PETROLEUM COMPANY

Date

1-25-1983

I hereby certify that the well location shown on this plat was plotted from field notes of actual surveys made by me or under my supervision, and that the same is true and correct to the best of my knowledge and belief.

Date Surveyed

1-25-83

Registered Professional Engineer and/or Land Surveyor

John W. West
Certificate No.

JOHN W. WEST NO. 676

0 330 660 990 1320 1650 1980 2310 2640 2970 3300 3630 3960 4290 4620 4950 5280 5610 5940 6270 6600