

UNITED STATES
DEPARTMENT OF THE INTERIOR
BUREAU OF LAND MANAGEMENT

N.M. Oil Cons. Division
811 S. 1st Street
Alamosa, NM 88210

DESIGNATION AND SERIAL NO.

APPLICATION FOR PERMIT TO DRILL OR DEEPEN

1a. TYPE OF WORK

DRILL ☐

DEEPEN ☐

b. TYPE OF WELL

OIL WELL ☐

GAS WELL ☐

OTHER ☐

Plug Back

SINGLE ZONE ☒

MULTIPLE ZONE ☐

2. NAME OF OPERATOR

Exxon Corp.

3. ADDRESS OF AND TELEPHONE NO.

P. O. Box 4358

(713) 431 1024

Houston

TX 77210

4. LOCATION OF WELL (Report location clearly and in accordance with any State requirements)

At surface

1968' FNL & 660' FWL

At proposed prod. zone

14. DISTANCE IN MILES AND DIRECTION FROM NEAREST TOWN OR POST OFFICE*

8 miles in a

NORTH direction from

Carlsbad, NM

15. DISTANCE FROM PROPOSED*

LOCATION TO NEAREST
PROPERTY OR LEASE LINE, FT.
(Also to nearest drlg. unit line, if any)

660

16. NO. OF ACRES IN LEASE

1861.75

17. NO. OF ACRES ASSIGNED
TO THIS WELL

320

18. DISTANCE FROM PROPOSED LOCATION*
TO NEAREST WELL, DRILLING COMPLETED, OR
APPLIED FOR, ON THIS LEASE, FT.

None

19. PROPOSED DEPTH

10250

20. ROTARY OR CABLE TOOLS

Rotary

21. ELEVATIONS (Show whether DF, RT, GR, etc.)

3231 GR

22. APPROX. DATE WORK WILL START*

10/22/1999

23. PROPOSED CASING AND CEMENTING PROGRAM

SIZE OF HOLE	GRADE, SIZE OF CASING	WEIGHT PER FOOT	SETTING DEPTH	QUANTITY OF CEMENT
17 1/2	13 3/8	54.5	600	800 sx
12 1/4	9 5/8	36	3000	1200 sx
8 3/4	5 1/2	17, 20	12000	1600 sx

This well is currently in the Morrow and perf'd from about 10,782 to 10,883 in the Burton Flat field.

Proposed Procedure:

Move in rig up well service unit, pull out of hole with tubing and packer. Set Cast iron bridge plug at 10,500' and dump 35' of cement atop the cast iron bridge plug. Run in hole and set packer at 10,007'. Perforate 43 holes from about 10,108' to about 10,248'. Acid stimulate with 15,000 gallons 15% HES's CCA and 600,000 scf of N2. Put well on pump as a Burton Flat-Strawn Gas Pool well.

Verbal by David Glass 10/25/99

IN ABOVE SPACE DESCRIBE PROPOSED PROGRAM : If proposal is to deepen, give data on present productive zone and proposed new productive zone. If proposal is to drill or deepen directionally, give pertinent data on subsurface locations and measured and true vertical depths. Give blowout preventer program, if any.

J. R. Ward

SIGNED

TITLE Sr. Regulatory Specialist

DATE 10/06/1999

(This space for Federal or State office use)

PERMIT NO.

APPROVAL DATE

Application approval does not warrant or certify that the applicant holds legal or equitable title to those rights in the subject lease which would entitle applicant to conduct operations thereon.

CONDITIONS OF APPROVAL, IF ANY:

APPROVED BY

TITLE

DATE

Title 18 U.S.C. Section 1001, makes it a crime for any person knowingly and willfully to make to any department or agency of the United States any false, fictitious or fraudulent statements or representations as to any matter within its jurisdiction.

*See Instructions On Reverse Side

O Box 1980, Hobbs, NM 88241-1980
District II
O Drawer DD, Artesia, NM 88211-0719
District III
000 Rio Brasos Rd. , Aztec, NM 87410
District IV
PO Box 2088, Santa Fe, NM 87504-2088

Minerals & Natural Resources Depart
OIL CONSERVATION DIVISION
PO Box 2088
Santa Fe, NM 87504-2088

Revised February 10, 1994
Submit to Appropriate District Office
State Lease - 4 Copies
Fee Lease - 3 Copies

☐ AMENDED REPORT

WELL LOCATION AND ACREAGE DEDICATION PLAT

API Number 30-015-24500		Pool Code 73360	Pool Name Undesignated Burton Flat-Strawn Gas Pool	
Property Code 004211	Property Name Yates "C" Federal			Well Number 20
OGRID No. 007673	Operator Name Exxon Corp.			Elevation 3231 GL

Surface Location

UL or lot no. D	Section 5	Township 21S	Range 27E	Lot Idn	Feet from the 1968	North/South line NORTH	Feet from the 660	East/West line WEST	County EDDY
--------------------	--------------	-----------------	--------------	---------	-----------------------	---------------------------	----------------------	------------------------	----------------

Bottom Hole Location If Different From Surface

UL or lot no.	Section	Township	Range	Lot Idn	Feet from the	North/South line	Feet from the	East/West line	County
Dedicated Acres 320					Joint or Infill	Consolidation Code	Order No.		

NO ALLOWABLE WILL BE ASSIGNED TO THIS COMPLETION UNTIL ALL INTERESTS HAVE BEEN CONSOLIDATED
OR A NON-STANDARD UNIT HAS BEEN APPROVED BY THE DIVISION

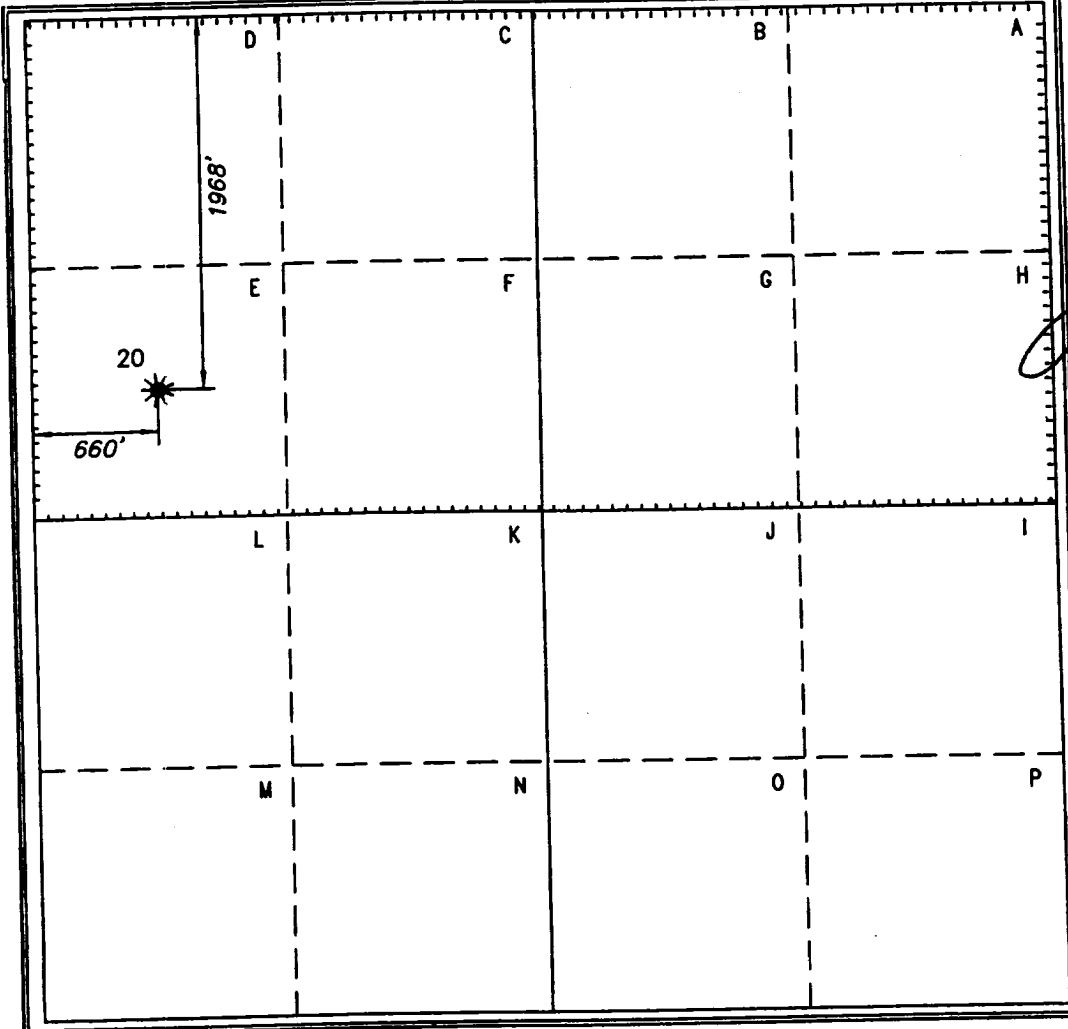

OPERATOR CERTIFICATION

I hereby certify that the information contained herein is true and complete to the best of my knowledge and belief.

C.H. Harper
Signature
C.H. Harper
Printed Name
Permits Supervisor
Title
Date

SURVEYOR CERTIFICATION

I hereby certify that the well location shown on this plat was plotted from field notes of actual surveys made by me or under my supervision, and that the same is true and correct to the best of my belief.

Date of Survey
Signature and Seal of Professional Surveyor.

Certificate Number

Distance to nearest Town 8 Miles N of Carlsbad, New Mexico.	Drawn By DA	Date 9/30/99	Drawing File Name File No.: A-08095-A
--	----------------	-----------------	--