

NM OIL CONS. COMMISSION
Drawer DD
Artesia, NM 88210

Form 9-331
Dec. 1973

UNITED STATES
DEPARTMENT OF THE INTERIOR
GEOLOGICAL SURVEY

Form Approved.
Budget Bureau No. 42-R1424

SUNDRY NOTICES AND REPORTS ON WELLS

(Do not use this form for proposals to drill or to deepen or plug back to a different reservoir. Use Form 9-331-C for such proposals.)

1. oil well ☒ gas well ☐ other ☐

2. NAME OF OPERATOR
Exxon Corporation

3. ADDRESS OF OPERATOR
P.O. Box 1600, Midland, TX 79702

4. LOCATION OF WELL (REPORT LOCATION CLEARLY. See space 17 below.) 2310' FSL and 2310' FEL of Section
AT SURFACE:
AT TOP PROD. INTERVAL:
AT TOTAL DEPTH:

16. CHECK APPROPRIATE BOX TO INDICATE NATURE OF NOTICE, REPORT, OR OTHER DATA

REQUEST FOR APPROVAL TO:

SUBSEQUENT REPORT OF:

TEST WATER SHUT-OFF ☐
FRACTURE TREAT ☐
SHOOT OR ACIDIZE ☐
REPAIR WELL ☐
PULL OR ALTER CASING ☐
MULTIPLE COMPLETE ☐
CHANGE ZONES ☐
ABANDON* ☐

☐
☐
☐
☐
☐
☐
☐
☐

(other) Amend location

5. LEASE
NM-01119

6. IF INDIAN, ALLOTTEE OR TRIBE NAME

7. UNIT AGREEMENT NAME

8. FARM OR LEASE NAME
Yates Federal "C"

9. WELL NO.
18

10. FIELD OR WILDCAT NAME
Avalon

11. SEC., T., R., M., OR BLK. AND SURVEY OR AREA
Sec. 31-20S-28E

12. COUNTY OR PARISH
Eddy

13. STATE
New Mexico

14. API NO.

15. ELEVATIONS (SHOW DF, KDB, AND WD)
3228' GR

(NOTE: Report results of multiple completion or zone change on Form 9-330.)

17. DESCRIBE PROPOSED OR COMPLETED OPERATIONS (Clearly state all pertinent details, and give pertinent dates, including estimated date of starting any proposed work. If well is directionally drilled, give subsurface locations and measured and true vertical depths for all markers and zones pertinent to this work.)*

The above well has been moved from 2180' FSL and 1980' FEL of Section 31-20S-28E to 2310' FSL and 2310' FEL of Section. Attached are corrected plats and Exhibit B.

Subsurface Safety Valve: Manu. and Type _____ Set @ _____ Ft.

18. I hereby certify that the foregoing is true and correct

SIGNED Melba Kripling TITLE UNIT HEAD DATE July 29, 1983

(This space for Federal or State office use)

APPROVED BY A. B. Lopez
CONDITIONS OF APPROVAL, IF ANY:

TITLE

DATE

8/29/83

APPROVAL SUBJECT TO
GENERAL REQUIREMENTS AND
SPECIAL STIPULATIONS

Operator Exxon Corporation			Lease YATES FEDERAL "C"		Well No. 18
Unit Letter J	Section 31	Township 20S	Range 28E	County EDDY	
Actual Footage Location of Well: 2310 feet from the SOUTH line and 2310 feet from the EAST line					
Ground Level Elev. 3228	Producing Formation DELAWARE		Pool AVALON	Dedicated Acreage: 40 Acres	

1. Outline the acreage dedicated to the subject well by colored pencil or hachure marks on the plat below.
2. If more than one lease is dedicated to the well, outline each and identify the ownership thereof (both as to working interest and royalty).
3. If more than one lease of different ownership is dedicated to the well, have the interests of all owners been consolidated by communitization, unitization, force-pooling, etc?

☐ Yes ☐ No If answer is "yes," type of consolidation _____

If answer is "no," list the owners and tract descriptions which have actually been consolidated. (Use reverse side of this form if necessary.) _____

No allowable will be assigned to the well until all interests have been consolidated (by communitization, unitization, forced-pooling, or otherwise) or until a non-standard unit, eliminating such interests, has been approved by the Commission.

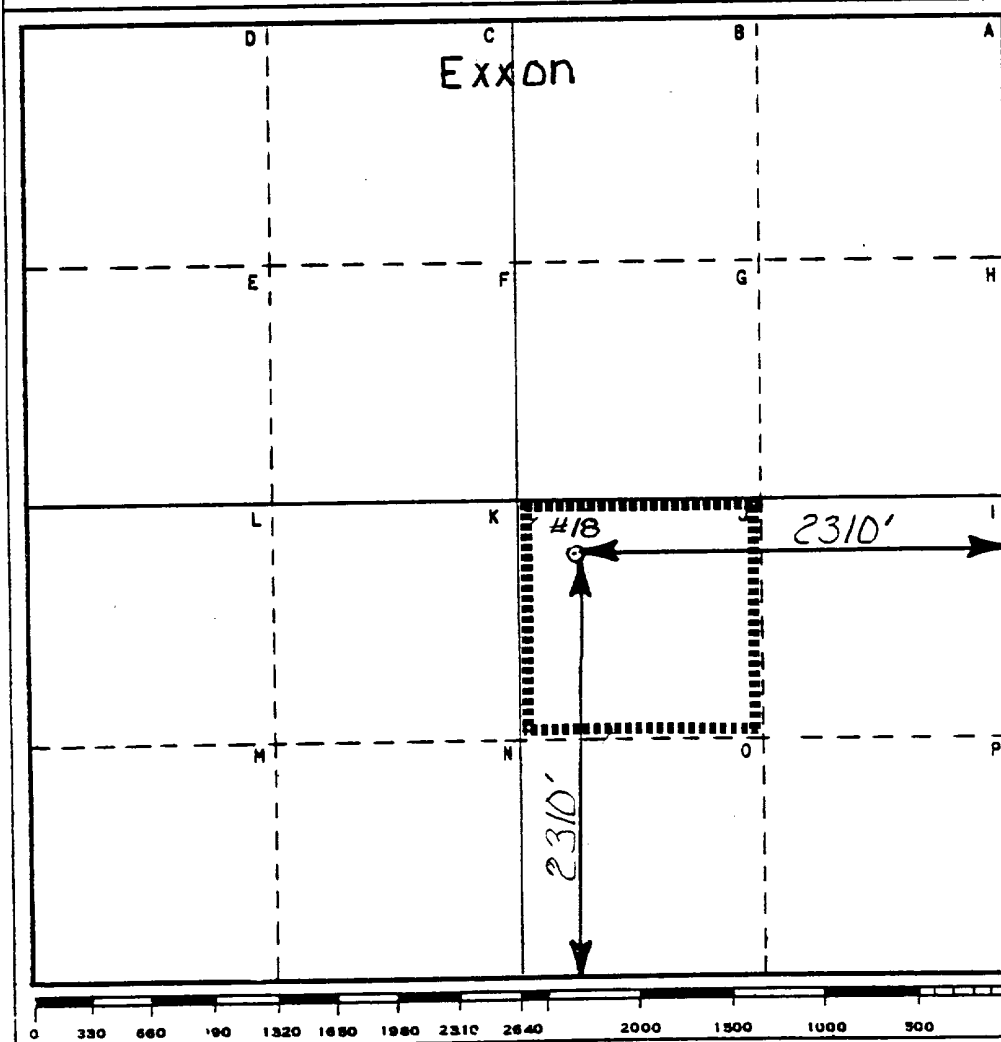

CERTIFICATION

I hereby certify that the information contained herein is true and complete to the best of my knowledge and belief.

Name
Melba Knippling

Position
UNIT HEAD

Company Exxon Corporation
Box 1600 Midland, Texas

Date
7-26-83

I hereby certify that the well location shown on this plat was plotted from field notes of actual surveys made by me or under my supervision, and that the same is true and correct to the best of my knowledge and belief.

Date Surveyed
7-21-83

Registered Professional Engineer
and/or Land Surveyor

W. J. Edmund
Certificate No.
6157

6 Miles NORTH of CARLSBAD, New Mexico

C.E. Sec. File No. WA-7927

2310 FSL) SEC. 31
2310 FEL

EXHIBIT "B"

V-DOOR N15°W

20' WIDE ROAD

GAS PIPELINE

TRAILERS

20' ACCESS ROAD

125'

FRAC. EQUIP.

150

22

EXXON COMPANY, U.S.A. (a division of Exxon Corporation)
PRODUCTION DEPARTMENT

PLAT YATES FEDERAL "C" No.18
NW SE SECTION 31; T20S, R28E
/ALON FIELD EDDY Co., N.I.

AVALON FIELD EDDY Co., N.M.

DRAWN <input type="checkbox"/>	CHECKED <input type="checkbox"/>
--------------------------------	----------------------------------

ENGR. SECTION
APPROVED

REVISÉ.

DATE 7-26-83
SCALE 1"=50'

FILE NO.
W-B-1857