

NO. OF COPIES RECEIVED	
DISTRIBUTION	
SANTA FE	<input checked="" type="checkbox"/>
FILE	<input checked="" type="checkbox"/>
U.S.G.S.	<input checked="" type="checkbox"/>
LAND OFFICE	<input checked="" type="checkbox"/>
OPERATOR	<input checked="" type="checkbox"/>

5A. Indicate Type of Lease

STATE ☒FEE ☐

6. State Oil & Gas Lease No.

RECEIVED BY

K-5115

OCT 27 1983

O.C.D.
PLUG BACK
ARTESIA, OFFICE

APPLICATION FOR PERMIT TO DRILL, DEEPEN, OR PLUG BACK

1a. Type of Work

b. Type of Well

DRILL ☒DEEPEN ☐OIL
WELL ☒GAS
WELL ☐

OTHER

SINGLE
ZONE ☐MULTIPLE
ZONE ☐

7. Unit Agreement Name

8. Form or Lease Name

Stonewall "EP" St.

9. Well No.

6

10. Field and Pool, or Wildcat

Undes. Delaware

2. Name of Operator

Yates Petroleum Corporation

3. Address of Operator

207 S. 4th, Artesia, New Mexico 88210

4. Location of Well

UNIT LETTER C

LOCATED 660

FEET FROM THE

North

LINE

AND 1980

FEET FROM THE

West

LINE OF SEC. 30

TWP. 20S

RGE. 28E

17. County

Eddy

11. Elevations (Show whether DF, KI, etc.)

3278' GL

21A. Kind & Status Plug. Bond

Blanket

15. Proposed Depth

appr. 4900'

19A. Formation

Delaware

20. Rotary or C.T.

Rotary

21B. Drilling Contractor

LaRue Drilling #2

22. Approx. Date Work will start

ASAP

23.

PROPOSED CASING AND CEMENT PROGRAM

SIZE OF HOLE	SIZE OF CASING	WEIGHT PER FOOT	SETTING DEPTH	SACKS OF CEMENT	EST. TOP
17 1/2"	13 3/8"	48#	550'	550 sx	circ
12 1/4"	8 5/8"	24-28#	2500' 2400'	1500 sx	circ
7 7/8"	5 1/2"	17-20#	TD	650 sx	tie to 8 5/8"

Propose to test the Delaware and intermediate formations with surface casing being set at approximately 550' and the intermediate casing at approximately 2400' - 2500' (100' below the Capitan Reef). If commercial pay is encountered, 5 1/2" casing will be run and the well stimulated as needed.

MUD PROGRAM: FW/water loss additives to TD.

BOP PROGRAM: BOP's will be installed on the intermediate casing & tested.

APPROVAL VALID FOR 180 DAYS
PERMIT EXPIRES 4-28-84
UNLESS DRILLING UNDERWAY

4. ABOVE SPACE DESCRIBE PROPOSED PROGRAM; IF PROPOSAL IS TO DEEPEN OR PLUG BACK, GIVE DATA ON PRESENT PRODUCTIVE ZONE AND PROPOSED NEW PRODUCTIVE ZONE. GIVE BLOWOUT PREVENTER PROGRAM, IF ANY.

hereby certify that the information above is true and complete to the best of my knowledge and belief.

Signed Glenn Rodriguez Title Regulatory Agent

Date 10-12-83

(This space for State Use)

APPROVED BY Mike Wilton

TITLE OIL AND GAS INSPECTOR

DATE OCT 28 1983

CONDITIONS OF APPROVAL, IF ANY:

Notify N.M.O.C.C. in sufficient time to witness cementing

the 8 5/8" casing

Posted copy
FD-1571 P. 000
11-4-83

MEXICO OIL CONSERVATION COMMISSION
WELL LOCATION AND ACREAGE DEDICATION PLAT

Form C-102
 Supersedes C-128
 Effective 1-1-65

All distances must be from the outer boundaries of the Section.

Operator YATES PETROLEUM CORPORATION			Lease Stonewall EP State		Well No. 6
Unit Letter C	Section 30	Township 20 South	Range 28 East	County Eddy	
Actual Footage Location of Well: 660 feet from the North line and 2110 feet from the West line					
Ground Level Elev. 3278.	Producing Formation Delaware		Pool <i>Aurora</i> Undes. Delaware	Dedicated Acreage: 40 Acres	

1. Outline the acreage dedicated to the subject well by colored pencil or hachure marks on the plat below.
2. If more than one lease is dedicated to the well, outline each and identify the ownership thereof (both as to working interest and royalty).
3. If more than one lease of different ownership is dedicated to the well, have the interests of all owners been consolidated by communitization, unitization, force-pooling, etc?

☐ Yes ☐ No If answer is "yes," type of consolidation _____

If answer is "no," list the owners and tract descriptions which have actually been consolidated. (Use reverse side of this form if necessary.) _____

No allowable will be assigned to the well until all interests have been consolidated (by communitization, unitization, forced-pooling, or otherwise) or until a non-standard unit, eliminating such interests, has been approved by the Commission.

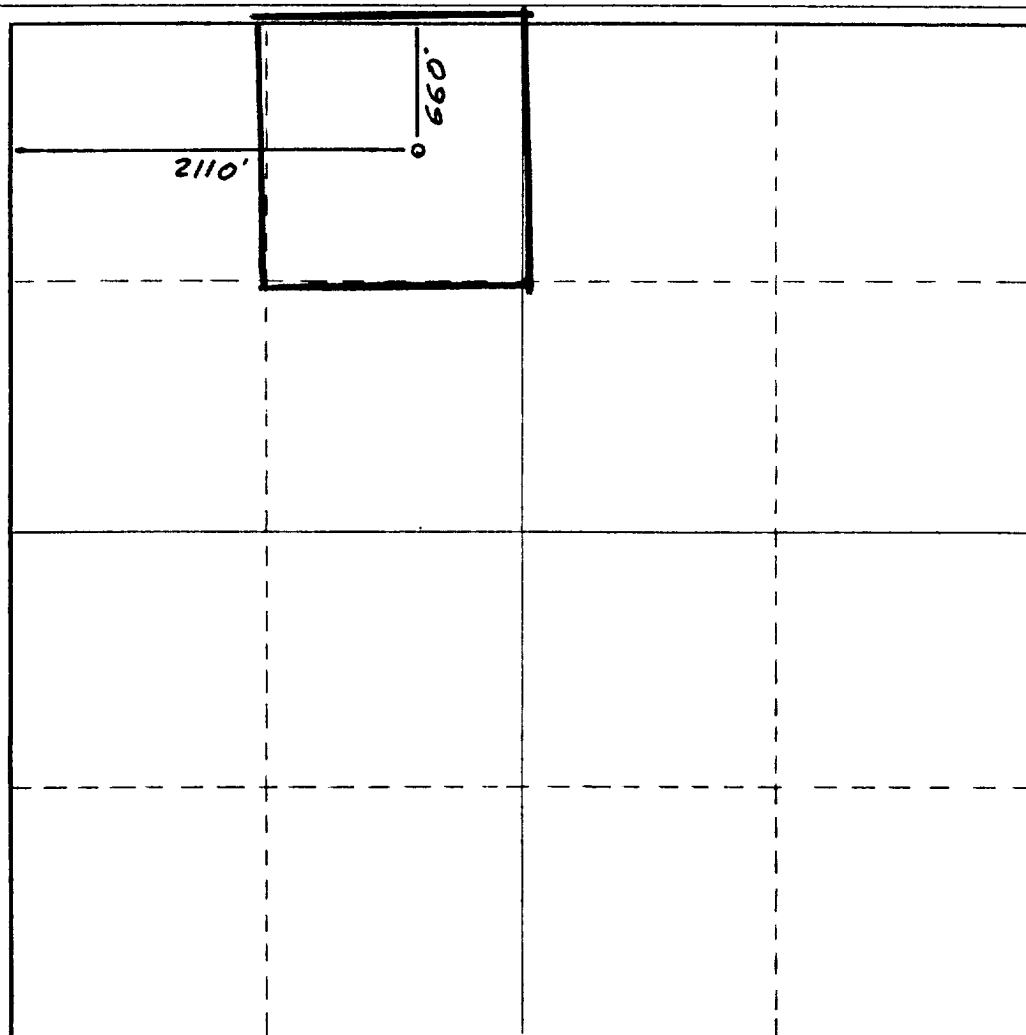

CERTIFICATION

I hereby certify that the information contained herein is true and complete to the best of my knowledge and belief.

Name

Gliserio Rodriguez
GLISERIO RODRIGUEZ

Position

REG. AGT.

Company

YATES PET. CORP.

Date

10-26-83

I hereby certify that the well location shown on this plat was plotted from field notes of actual surveys made by me or under my supervision, and that the same is true and correct to the best of my knowledge and belief.

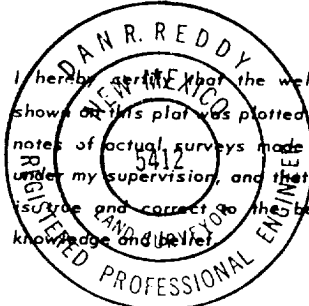

Date Surveyed

October 23, 1983

Registered Professional Engineer
 and/or Land Surveyor

Dan R. Reddy

Certificate No.

NM PE&LS #5412

0 330 660 990 1320 1650 1980 2310 2640 2000 1500 1000 500 0

EXHIBIT B

BDP DIAGRAM

RATED 3000[#]

