

STATE OF NEW MEXICO  
ENERGY AND MINERALS DEPARTMENT

OIL CONSERVATION  
P. O. BOX 2088  
SANTA FE, NEW MEXICO 87501

Form C-101 30-015-24769  
Revised 10-1-78

NO. OF COPIES RECEIVED	
DISTRIBUTION	
SANTA FE	<input checked="" type="checkbox"/>
FILE	<input checked="" type="checkbox"/>
U.S.G.S.	<input checked="" type="checkbox"/>
LAND OFFICE	<input checked="" type="checkbox"/>
OPERATOR	<input checked="" type="checkbox"/>

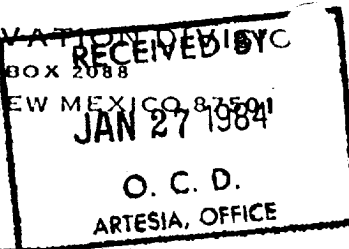

5A. Indicate Type of Lease  
STATE ☐ FEE ☒  
5. State Oil & Gas Lease No.

APPLICATION FOR PERMIT TO DRILL, DEEPEN, OR PLUG BACK

a. Type of Work  
b. Type of Well  
OIL WELL ☐ GAS WELL ☒ OTHER ☐  
c. Name of Operator  
d. Address of Operator  
e. Location of Well  
UNIT LETTER K LOCATED 2100 FEET FROM THE West LINE  
f. Location of Well  
UNIT LETTER K LOCATED 2100 FEET FROM THE West LINE  
g. Location of Well  
UNIT LETTER K LOCATED 2100 FEET FROM THE West LINE

7. Unit Agreement Name  
8. Farm or Lease Name  
9. Well No.  
10. Field and Pool or Indicate Undes. Morrow

Yates Petroleum Corporation  
207 S. 4th, Artesia, New Mexico 88210  
207 S. 4th, Artesia, New Mexico 88210  
UNIT LETTER K LOCATED 2100 FEET FROM THE West LINE  
UNIT LETTER K LOCATED 2100 FEET FROM THE West LINE  
UNIT LETTER K LOCATED 2100 FEET FROM THE West LINE

12. County  
Eddy

1. Elevations (show whether DF, RT, etc.)  
3140' GL  
21A. Kind & Status Plug. Bond  
Blanket  
19. Proposed Depth  
11360'  
19A. Formation  
Morrow  
20. Rotary or C.T.  
Rotary  
21B. Drilling Contractor  
Undes.  
22. Approx. Date Work will start  
ASAP

PROPOSED CASING AND CEMENT PROGRAM

SIZE OF HOLE	SIZE OF CASING	WEIGHT PER FOOT	SETTING DEPTH	SACKS OF CEMENT	EST. TOP
17 1/2"	13 3/8"	48# H-40	610'	400 sx	circ
12 1/4"	9 5/8"	32# J-55	2720' 2300'	1400 sx	circ
7 7/8"	4 1/2"	11.6# N or	TD	600 sx	
	or 5 1/2"	13# N			
		17# or 20# N			

We propose to drill and test the Morrow and intermediate formations. Approximately 610' of surface casing will be set to shut off gravel and caving, and intermediate casing will be set 100' below the Artesian Water Zone. If commercial, will run 4 1/2" or 5 1/2" with 600' cement cover, will perforate and stimulate as needed for production.

MUD PROGRAM: FW gel/LCM to 2720'. If lost circulation occurs, dry drill thru Capitan Reef to approximately 1500'. Native mud & FW to 8400', cut brine to 9500', salt gel/driskpak/brine to TD.

BOP PROGRAM: BOP's & hydril will be installed on 8 5/8" casing & tested daily.

APPROVAL VALID FOR 180 DAYS

PERMIT EXPIRES 8-2-84

UNLESS DRILLING UNDERWAY

ABOVE SPACE DESCRIBE PROPOSED PROGRAM: IF PROPOSAL IS TO DEEPEN OR PLUS BACK, GIVE DATA ON PRESENT PRODUCTIVE ZONE AND PROPOSED NEW PRODUCTIVE ZONE. GIVE BLOWOUT PREVENTER PROGRAM, IF ANY.

I hereby certify that the information above is true and complete to the best of my knowledge and belief.

Signed Cy Cowan Title Regulatory Agent Date 1/25/84  
(This space for State Use)

APPROVED BY Mike Walker TITLE OIL AND GAS INSPECTOR DATE FEB 02 1984

CONDITIONS OF APPROVAL, IF ANY:

Notify N.M.O.C.C. in sufficient time to witness cementing the 9 5/8" casing

Post. App. 2  
JD-1276 Book  
2-10-84

**NEW MEXICO OIL CONSERVATION COMMISSION  
WELL LOCATION AND ACREAGE DEDICATION PLAT**

Form C-102  
Supersedes C-128  
Effective 1-1-65

All distances must be from the outer boundaries of the Section.

Operator <b>YATES PETROLEUM CORPORATION</b>			Lease <b>South Avalon YI Com</b>		Well No. <b>1</b>
Unit Letter <b>K</b>	Section <b>23</b>	Township <b>21 South</b>	Range <b>26 East</b>	County <b>Eddy</b>	
Actual Footage Location of Well: <b>1980</b> feet from the <b>South</b> line and <b>2100</b> feet from the <b>West</b> line					
Ground Level Elev. <b>3140.</b>	Producing Formation <b>Morrow</b>		Pool <b>Under Morrow</b>	Dedicated Acreage: <b>320</b> Acres	

1. Outline the acreage dedicated to the subject well by colored pencil or hatchure marks on the plat below.
2. If more than one lease is dedicated to the well, outline each and identify the ownership thereof (both as to working interest and royalty).
3. If more than one lease of different ownership is dedicated to the well, have the interests of all owners been consolidated by communitization, unitization, force-pooling, etc?

☒ Yes    ☐ No    If answer is "yes," type of consolidation **TO BE COMMUNITIZED**

If answer is "no," list the owners and tract descriptions which have actually been consolidated. (Use reverse side of this form if necessary.)

No allowable will be assigned to the well until all interests have been consolidated (by communitization, unitization, forced-pooling, or otherwise) or until a non-standard unit, eliminating such interests, has been approved by the Commission.

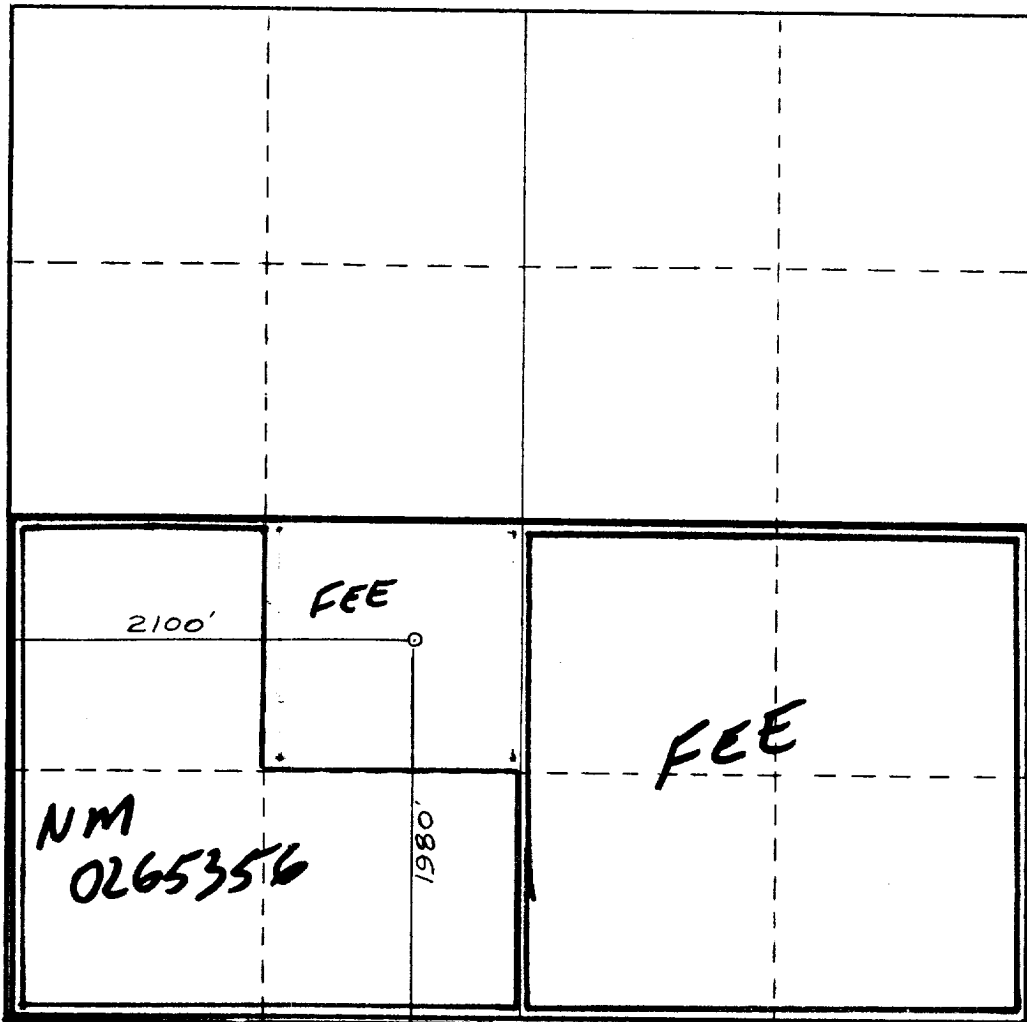

**CERTIFICATION**

I hereby certify that the information contained herein is true and complete to the best of my knowledge and belief.

*Cy Cowan*

Name  
**Cy Cowan**  
Position  
**Regulatory Agent**  
Company  
**Yates Petroleum Corp.**

Date  
**1/25/84**

**DAN R. REDDY**  
I hereby certify that the well location shown on this plat was plotted from field notes of actual surveys made by me or under my supervision, and that the same is true and correct to the best of my knowledge and belief.

Date Surveyed  
**January 6, 1984**

Registered Professional Engineer and/or Land Surveyor

*Dan R. Reddy*

Certificate No.  
**NM PE&LS #5412**

0 330 660 990 1320 1650 1980 2310 2640 2000 1500 1000 500 0

Rotating head if necessary  
2" Fill up Line

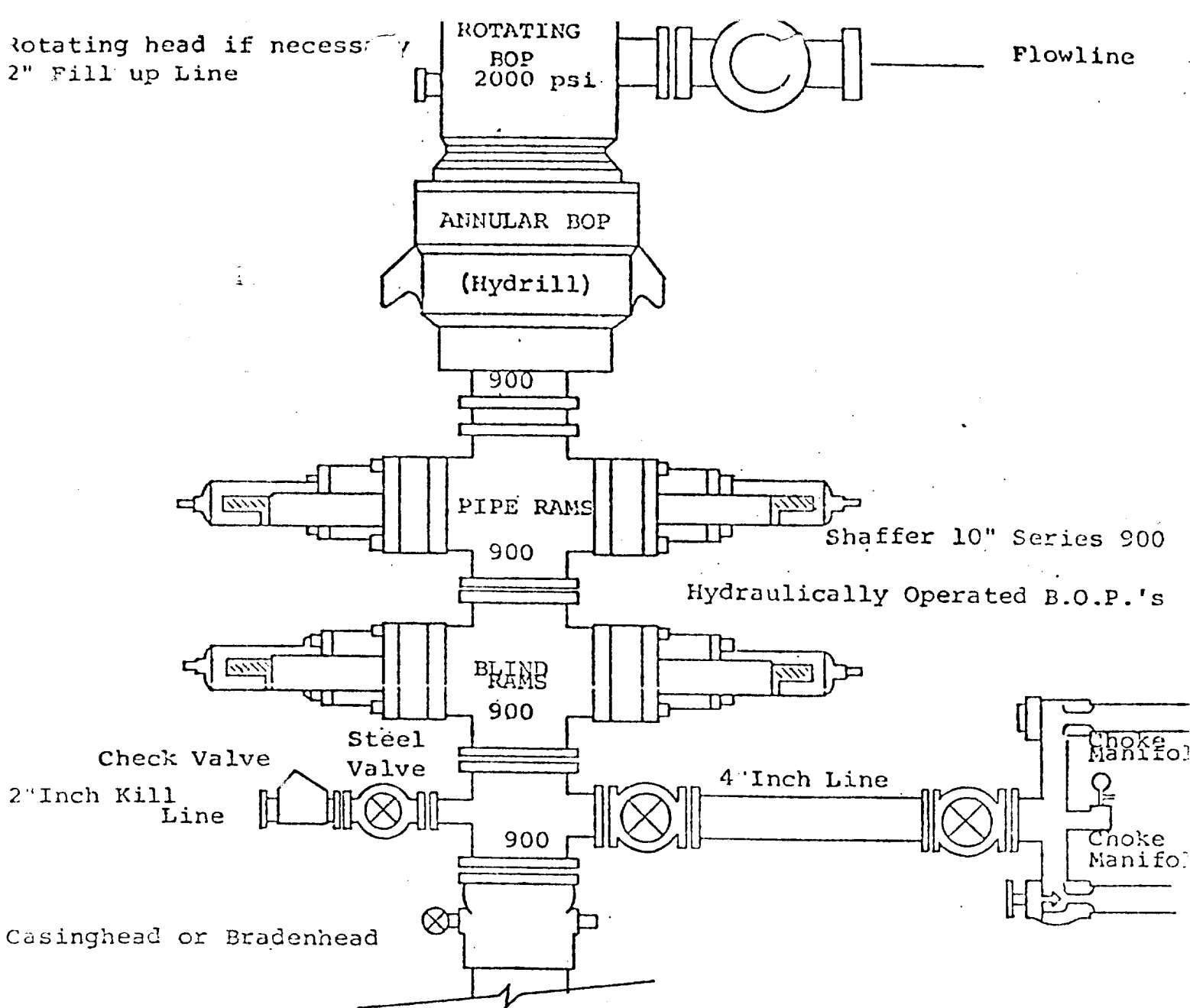

THE FOLLOWING CONSTITUTE MINIMUM BLOWOUT PREVENTER REQUIREMENTS

1. All preventers to be hydraulically operated with secondary manual control installed prior to drilling out from under casing.
2. Choke outlet to be a minimum of 4" diameter.
3. Kill line to be of all steel construction of 2" minimum diameter.
4. All connections from operating manifolds to preventers to be all steel, hole or tube a minimum of one inch in diameter.
5. The available closing pressure shall be at least 15% in excess of that required with sufficient volume to operate the B.O.P.'s.
6. All connections to and from preventer to have a pressure rating equivalent to that of the B.O.P.'s.
7. Inside blowout preventer to be available on rig floor.
8. Operating controls located a safe distance from the rig floor.
9. Hole must be kept filled on trips below intermediate casing.
10. D. P. float must be installed and used below zone of first gas intrusion.