

NO. OF COPIES RECEIVED	
DISTRIBUTION	
SANTA FE	<input checked="" type="checkbox"/>
FILE	<input checked="" type="checkbox"/>
U.S.G.S.	<input checked="" type="checkbox"/>
LAND OFFICE	<input checked="" type="checkbox"/>
OPERATOR	<input checked="" type="checkbox"/>

P. O. BOX 2018
SANTA FE, NEW MEXICO 87501
RECEIVED BY
MAR 09 1984
O. C. D.
ARTESIA, OFFICE

5A. Indicate Type of Lease
STATE ☒ FEDERAL ☐
5. State Oil & Gas Lease No.
K-6261

APPLICATION FOR PERMIT TO DRILL, DEEPEN, OR PLUG BACK

1a. Type of Work

DRILL ☒DEEPEN ☐PLUG BACK ☐

b. Type of Well

OIL WELL ☒GAS WELL ☐OTHER ☐SINGLE ZONE ☐MULTIPLE ZONE ☐

2. Name of Operator

Yates Petroleum Corporation

3. Address of Operator

207 S. 4th, Artesia, New Mexico 88210

4. Location of Well

UNIT LETTER A

LOCATED 330

FEET FROM THE North

LINE

AND

330

FEET FROM THE

East

LINE OF SEC. 36

TWP. 20

RGE. 27E

NMPM

7. Unit Agreement Name

8. Farm or Lease Name

Citdel "ZG"

9. Well No.

1

10. Field and Pool, or Wildcat

Undesignated Delaware

17. County

Eddy

11. Elevations (Show whether D.F., K.I., etc.)

3289' GL

21A. Kind & Status Plug. Bond

Blanket

19. Proposed Depth

appr. 5150'

19A. Formation

Delaware

20. Rotary or C.T.

Rotary

21B. Drilling Contractor

LaRue #2

22. Approx. Date Work will start

ASAP

23.

PROPOSED CASING AND CEMENT PROGRAM

SIZE OF HOLE	SIZE OF CASING	WEIGHT PER FOOT	SETTING DEPTH	SACKS OF CEMENT	EST. TOP
17 1/2"	13 3/8"	28#	550'	550 sx	circ
12 1/4"	8 5/8"	24-28#	2500'	1500 sx	circ
7 7/8"	5 1/2"	17-20#	TD	650 sx	

Propose to test the Delaware and intermediate formations with surface casing being set at approximately 550' and the intermediate casing at approximately 2500' (100' below the Capitan Reef). If commercial pay is encountered, 5 1/2" casing will be run and the well stimulated as needed.

MUD PROGRAM: FW gel/LCM to TD.

BOP PROGRAM: BOP's will be installed on the intermediate casing and tested.

APPROVAL VALID FOR 180 DAYS
PERMIT EXPIRES 9-12-84
UNLESS DRILLING UNDERWAY

IN ABOVE SPACE DESCRIBE PROPOSED PROGRAM; IF PROPOSAL IS TO DEEPEN OR PLUG BACK, GIVE DATA ON PRESENT PRODUCTIVE ZONE AND PROPOSED NEW PRODUCTIVE ZONE. GIVE BLOWOUT PREVENTER PROGRAM, IF ANY.

hereby certify that the information above is true and complete to the best of my knowledge and belief.

igned Cy Conner Title Regulatory Agent Date 3/8/84

(This space for State Use)

APPROVED BY Mike Williams TITLE OIL AND GAS INSPECTOR DATE MAR 12 1984

CONDITIONS OF APPROVAL, IF ANY:

Notify NJOCC in sufficient time to allow for setting the 10 3/4" casing

Post. A & D
10-1 1/2" BOP
3-16-84

**NEW MEXICO OIL CONSERVATION COMMISSION
WELL LOCATION AND ACREAGE DEDICATION PLAT**

Form C-102
Supersedes C-128
Effective 1-1-65

All distances must be from the outer boundaries of the Section.

Operator YATES PETROLEUM CORPORATION			Lease Citdel ZG State		Well No. 1
Unit Letter A	Section 36	Township 20 South	Range 27 East	County Eddy	
Actual Footage Location of Well: 330 feet from the North line and 330 feet from the East line					
Ground Level Elev. 3289.	Producing Formation DELAWARE		Pool UNDES DELAWARE	Dedicated Acreage: .40 Acres	

1. Outline the acreage dedicated to the subject well by colored pencil or hatchure marks on the plat below.
2. If more than one lease is dedicated to the well, outline each and identify the ownership thereof (both as to working interest and royalty).
3. If more than one lease of different ownership is dedicated to the well, have the interests of all owners been consolidated by communitization, unitization, force-pooling, etc?

☐ Yes ☒ No If answer is "yes," type of consolidation _____

If answer is "no," list the owners and tract descriptions which have actually been consolidated. (Use reverse side of this form if necessary.) _____

No allowable will be assigned to the well until all interests have been consolidated (by communitization, unitization, forced-pooling, or otherwise) or until a non-standard unit, eliminating such interests, has been approved by the Commission.

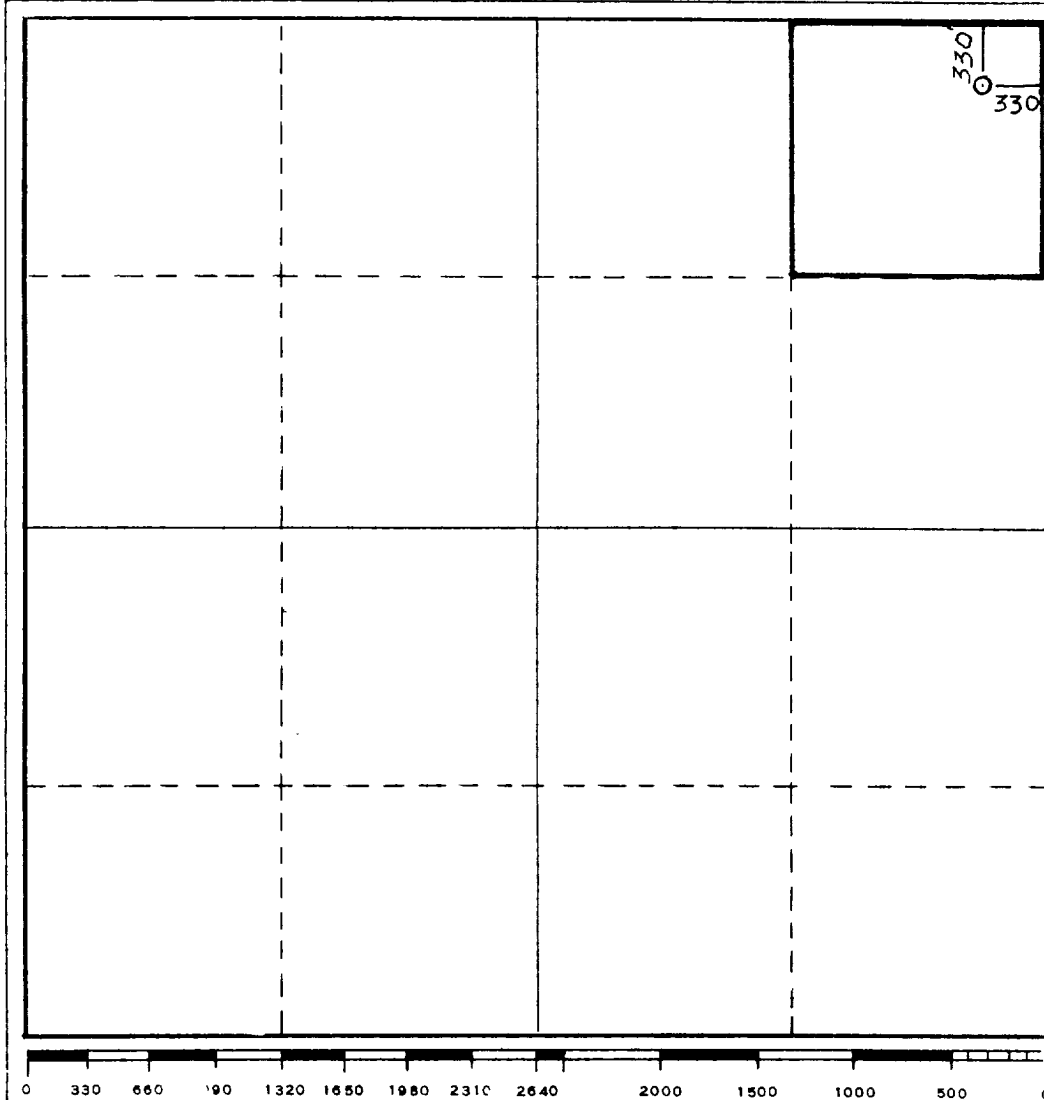

CERTIFICATION

I hereby certify that the information contained herein is true and complete to the best of my knowledge and belief.

Cy Cowan

Name

Cy Cowan

Position

Regulatory Agent

Company

Yates Petroleum Corp.

Date

3/8/84

I hereby certify that the well location shown on this plat was plotted from field notes of actual surveys made by me or under my supervision, and that the same is true and correct to the best of my knowledge and belief.

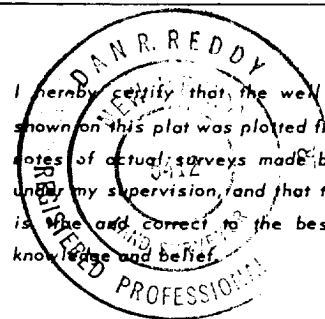

Date Surveyed

March 7, 1984

Registered Professional Engineer
and/or Land Surveyor

Dan R. Reddy

Certificate No.

NM PE&LS #5412

EXHIBIT B

BDP DIAGRAM

RATED 3000[#]

