

NO. OF COPIES RECEIVED	
DISTRIBUTION	
SANTA FE	✓
FILE	✓
U.S.G.S.	h
LAND OFFICE	✓
OPERATOR	✓

NEW MEXICO OIL CONSERVATION COMMISSION

Form C-101
Revised 1-1-85

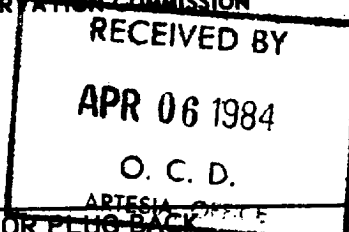

5A. Indicate Type of Lease	STATE <input checked="" type="checkbox"/> FEE <input type="checkbox"/>
5. State Oil & Gas Lease No.	LG 9812

APPLICATION FOR PERMIT TO DRILL, DEEPEN, OR PLUG BACK

1a. Type of Work		7. Unit Agreement Name	
b. Type of Well OIL WELL <input checked="" type="checkbox"/> GAS WELL <input type="checkbox"/> OTHER <input type="checkbox"/>		8. Farm or Lease Name Kirk "20" Com.	
2. Name of Operator Southland Royalty Company ✓		9. Well No. 1	
3. Address of Operator 21 Desta Drive, Midland, Texas 79705		10. Field and Book, or Wildcat Wildcat <i>Calabazas</i> Undesignated (Morrow)	
4. Location of Well UNIT LETTER <u>B</u> LOCATED <u>660</u> FEET FROM THE <u>North</u> LINE AND <u>1980</u> FEET FROM THE <u>East</u> LINE OF SEC. 20 TWP. 21S RGE. 25E NMPM		12. County Eddy	
19. Proposed Depth 10,700'		19A. Formation Morrow	
20. Rotary or C.T. Rotary		21. Elevations (Show whether DF, RT, etc.) 3469.3' GR	
21A. Kind & Status Plug. Bond <i>Blanket</i>		22. Approx. Date Work will start 4-19-84	

PROPOSED CASING AND CEMENT PROGRAM

SIZE OF HOLE	SIZE OF CASING	WEIGHT PER FOOT	SETTING DEPTH	SACKS OF CEMENT	EST. TOP
17 1/2"	13 3/8"	48#	500'	600 sx.	Circulate
12 1/4"	8 5/8"	24#	2450'	* 1000 sx.	
7 7/8"	5 1/2"	17#	10,700'	* Cmt volume determined by BHV integration. Determine cmt top by T.S.	Top @ 6000'

Drill 17 1/2" hole to 500'. Set 13 3/8" csg @ 500'. Cmt w/600 sx. Circ cmt. Drill 12 1/4" hole to 2450'. Set 8 5/8" csg @ 2450'. Cmt w/1000 sx. Drill 7 7/8" hole to TD to test the Morrow and intermediate horizons with shows. If commercial, run 5 1/2" csg to TD. Cmt w/sufficient volume to bring cmt above prospective zones. Estimated top of cmt @ 6000'. Perforate and stimulate.

MUD PROGRAM: 0-500' Spud mud; 500-2450' Fresh gel; 2450-8000' Cut brine; 8000-10,000' Cut brine, gel, Drispac; 10,000-TD Cut Brine, gel, Drispac 3% KCl. MW 9.1-9.3, VIS 34-36. BHP @ TD anticipated to be 4400 psi.

BOP PROGRAM: BOP to be installed and tested after each installation. BOP to be tested by Yellow Jacket, Inc. after setting 8 5/8" and @ 7000'. Install rotating head, gas separator and pit monitors @ 7000'.

APPROVAL VALID FOR 180 DAYS
PERMIT NO. 10-10-84
UNLESS OTHERWISE NOTIFIED

GAS NOT DEDICATED

IN ABOVE SPACE DESCRIBE PROPOSED PROGRAM; IF PROPOSAL IS TO DEEPEN OR PLUG BACK, GIVE DATA ON PROPOSED PRODUCTIVE ZONE AND PROPOSED NEW PRODUCTIVE ZONE. GIVE SLOWOUT PREVENTER PROGRAM, IF ANY.

I hereby certify that the information above is true and complete to the best of my knowledge and belief.

Signed Danell Roberts Title Operations Engineer Date 4/6/84

(This space for State Use)

APPROVED BY Mike Williams TITLE OIL AND GAS INSPECTOR DATE APR 10 1984
CONDITIONS OF APPROVAL, IF ANY: Notify N.M.O.C. in sufficient time to witness cementing the 8 5/8 casing

*Post a PO
RD-1247 BR
4-13-84*

NEW MEXICO OIL CONSERVATION COMMISSION
WELL LOCATION AND ACREAGE DEDICATION PLAT

Form C-102
Supersedes C-128
Effective 1-1-65

All distances must be from the outer boundaries of the Section.

Operator SOUTHLAND ROYALTY CO.			Lease KIRK 20 COM.		Well No. 1
Unit Letter B	Section 20	Township 21 SOUTH	Range 25 EAST	County EDDY	
Actual Footage Location of Well:					
660 feet from the NORTH line and		1980 feet from the EAST line			
Ground Level Elev. 3469.3'	Producing Formation Morrow	Pool WILDCAT MORROW Undesignated	Dedicated Acreage: 320 Acres		

1. Outline the acreage dedicated to the subject well by colored pencil or hatchure marks on the plat below.
2. If more than one lease is dedicated to the well, outline each and identify the ownership thereof (both as to working interest and royalty).
3. If more than one lease of different ownership is dedicated to the well, have the interests of all owners been consolidated by communitization, unitization, force-pooling, etc?

☒ Yes ☐ No If answer is "yes," type of consolidation Communitization

If answer is "no," list the owners and tract descriptions which have actually been consolidated. (Use reverse side of this form if necessary.)

No allowable will be assigned to the well until all interests have been consolidated (by communitization, unitization, forced-pooling, or otherwise) or until a non-standard unit, eliminating such interests, has been approved by the Commission.

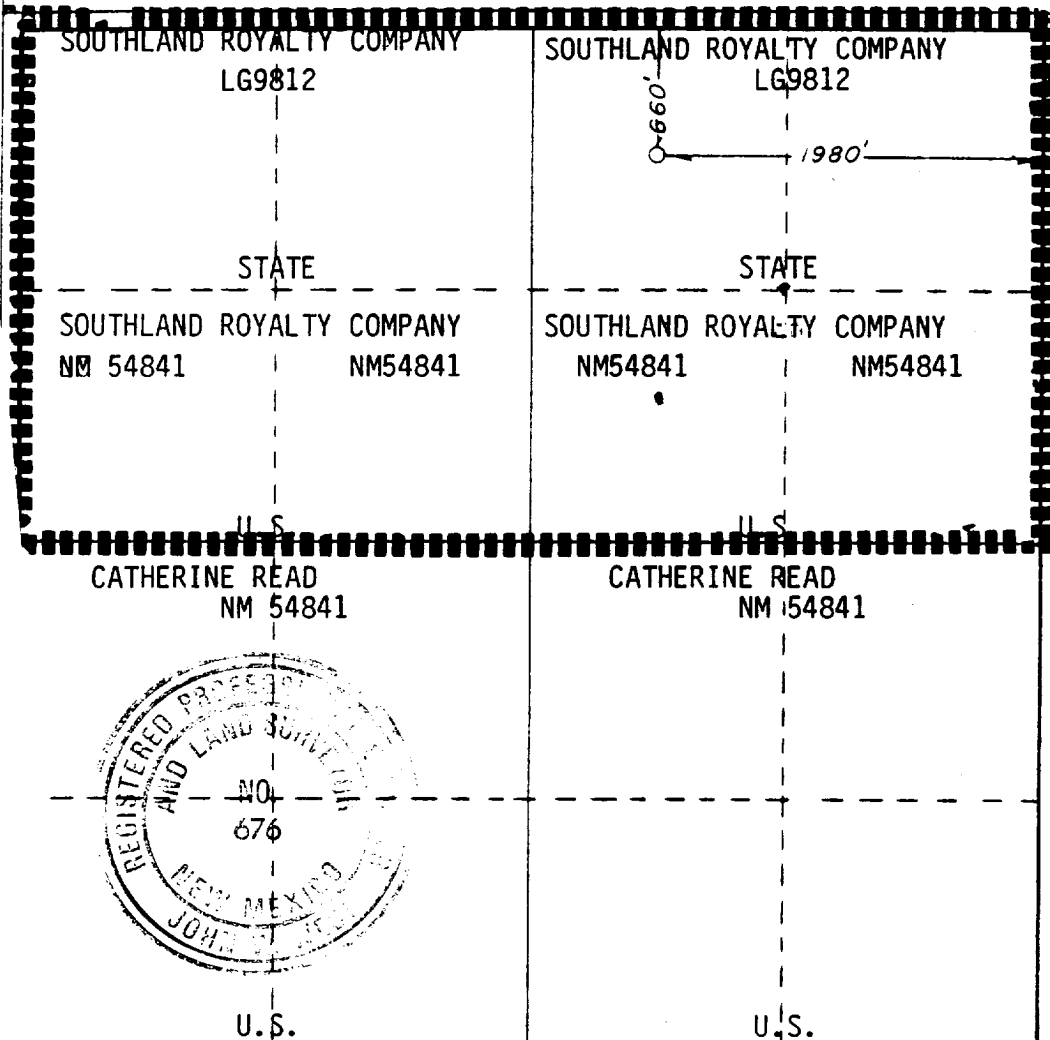

CERTIFICATION

I hereby certify that the information contained herein is true and complete to the best of my knowledge and belief.

Darrell Roberts

Name
Darrell Roberts

Position
Operations Engineer

Company
Southland Royalty Company

Date
4/6/84

I hereby certify that the well location shown on this plat was plotted from field notes of actual surveys made by me or under my supervision, and that the same is true and correct to the best of my knowledge and belief.

Date Surveyed
3/20/84

Registered Professional Engineer and/or Land Surveyor

John W. West

Certificate No. **JOHN W. WEST, 676**
RONALD J. EIDSON, 3239