



SURVEY CERTIFICATION SHEET

STATE OF TEXAS  
COUNTY OF MIDLAND

I, STEVE COVINGTON, in the employ of Eastman Whipstock, Inc., did on the days of SEPT. 16, 19 84 thru SEPT. 17, 19 84 conduct or supervise the taking of a MAGNETIC MULTI-SHOT SURVEY survey by the method of magnetic orientation from a depth of 9248 feet to 11989 feet, with recordings of inclination and direction being obtained at approximate intervals of 93 feet.

This survey was conducted at the request of SANTA FE ENERGY CORP. for their VERNON FEDERAL COM. Y-1, EDDY County, State of NEW MEXICO, in the \_\_\_\_\_ field.

This data for this survey and the calculation were obtained and performed by me according to standards and procedures as set forth by Eastman Whipstock, Inc. and is true and correct to the best of my knowledge.

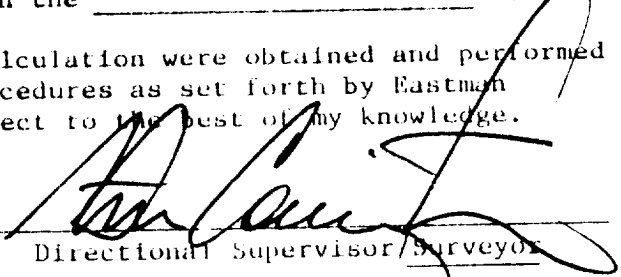
  
Directional Supervisor/Surveyor

The data for this survey has been examined by me and confirms to principles and procedures set forth by Eastman Whipstock, Inc.



Before me, the undersigned authority, on this day personally appeared STEVE COVINGTON, known to me to be the person whose name is subscribed to this instrument, who after being by me duly sworn on oath, states that he has knowledge of all the facts stated above and that this information is a true statement of facts therein recited.

Subscribed and sworn to before me on this 16th day of OCT., 19 84

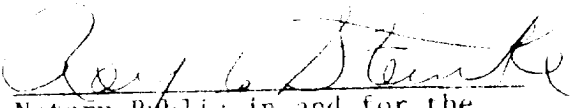
  
Notary Public in and for the  
County of Midland, Texas



ROY L. STEINKE  
Notary Public, State of Texas  
My Commission Expires July 8, 1985

RECEIVED

OCT 24 1964

U.S. G.  
HOBBS OFFICE

NEW MEXICO OIL CONSERVATION COMMISSION  
WELL LOCATION AND ACREAGE DEDICATION PLAT

Form C-102  
Supersedes C-128  
Effective 1-1-65

All distances must be from the outer boundaries of the Section

Operator <b>SANTA FE ENERGY COMPANY</b>			Lease <b>VERNON FEDERAL CON.</b>		Well No. <b>1</b>
Tract Letter <b>J</b>	Section <b>25</b>	Township <b>21 SOUTH</b>	Range <b>27 EAST</b>	County <b>EDDY</b>	
Actual Footage Location of Well: 1980 feet from the <b>SOUTH</b> line and <b>1930</b> feet from the <b>EAST</b> line <del>1980</del>					
Ground Level Elev. <b>3136.0</b>	Producing Formation <b>Morrow</b>	Foot <b>Carlsbad East</b>	Dedicated Acreage: <b>320</b> Acres		

1. Outline the acreage dedicated to the subject well by colored pencil or hatchure marks on the plat below.
2. If more than one lease is dedicated to the well, outline each and identify the ownership thereof (both as to working interest and royalty).
3. If more than one lease of different ownership is dedicated to the well, have the interests of all owners been consolidated by communitization, unitization, force-pooling, etc?

☒ Yes ☐ No If answer is "yes," type of consolidation Communitization Agreement

If answer is "no," list the owners and tract descriptions which have actually been consolidated. (Use reverse side of this form if necessary.)

No allowable will be assigned to the well until all interests have been consolidated (by communitization, unitization, forced-pooling, or otherwise) or until a non-standard unit, eliminating such interests, has been approved by the Commission.

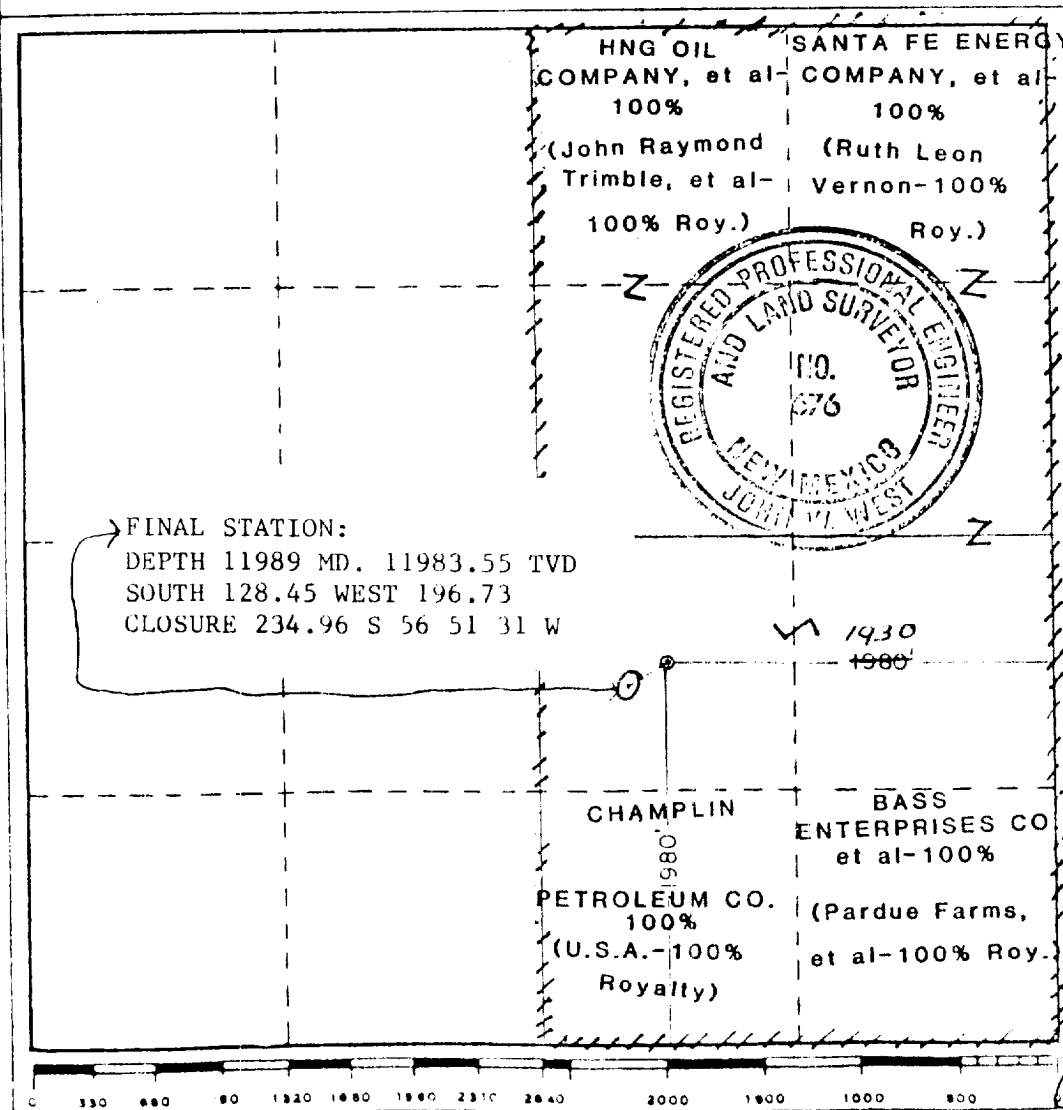

CERTIFICATION

I hereby certify that the information contained herein is true and complete to the best of my knowledge and belief.

*Michael R. Burton*

Name  
Mike Burton

Position  
Sr. Drilling Eng.

Company  
Santa Fe Energy

Date  
5-25-84

I hereby certify that the well location shown on this plat was plotted from field notes of actual surveys made by me or under my supervision, and that the same is true and correct to the best of my knowledge and belief.

Date Surveyed  
MAY 15, 1984

Registered Professional Engineer and/or Land Surveyor

*John W. West*  
Certificate No. **JOHN W. WEST, 676**  
**RONALD J. EIDSON, 3239**

RECEIVED

OCT 24 1984

C. J. J.  
HONORARY OFFICE