

NEW MEXICO OIL CONSERVATION COMMISSION
WELL LOCATION AND ACREAGE DEDICATION PLAT

Form C-102
Supersedes C-128
Effective 1-1-65

All distances must be from the outer boundaries of the Section

Operator CITIES SERVICE OIL & GAS CORP.		Lease GOVERNMENT A D COM		Well No. 3
Unit Letter H	Section 21	Township 21 SOUTH	Range 27 EAST	County EDEY
Actual Footage Location of Well: 1980 feet from the NORTH line and 660 feet from the EAST line				
Ground Level Elev. 3232.5	Producing Formation Morrow	Pool Undes. Burton Flat Morrow	Dedicated Acreage: 320 Acres	

1. Outline the acreage dedicated to the subject well by colored pencil or hachure marks on the plat below.
2. If more than one lease is dedicated to the well, outline each and identify the ownership thereof (both as to working interest and royalty).
3. If more than one lease of different ownership is dedicated to the well, have the interests of all owners been consolidated by communitization, unitization, force-pooling, etc?

☐ Yes ☐ No If answer is "yes," type of consolidation Unitization (see reverse side)

If answer is "no," list the owners and tract descriptions which have actually been consolidated. (Use reverse side of this form if necessary.)

No allowable will be assigned to the well until all interests have been consolidated (by communitization, unitization, forced-pooling, or otherwise) or until a non-standard unit, eliminating such interests, has been approved by the Commission.

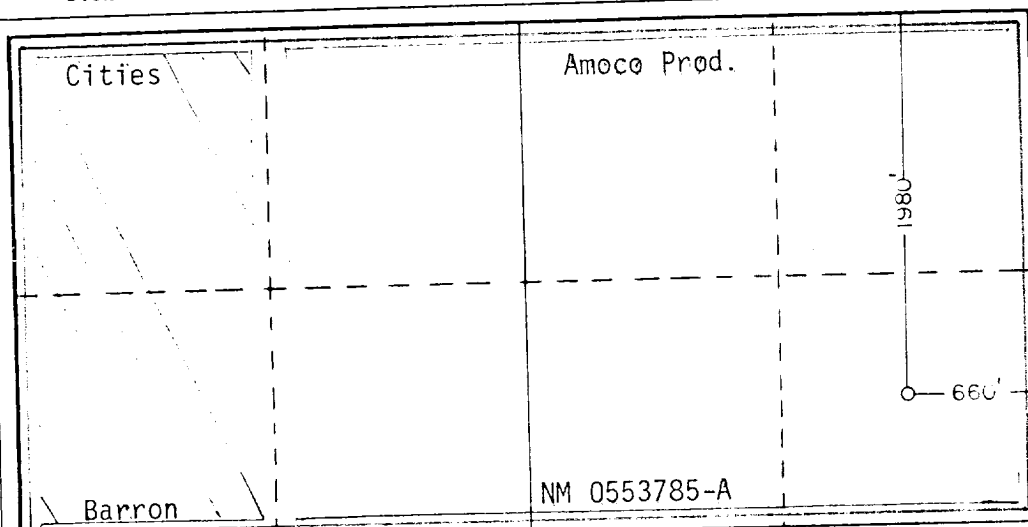

Unit block consists of 4932 acres. Working interests of participating companies in this proposed well are as follows:

Cities Service	61.70003%
Flag Redfern	13.48716%
John & Rosalind Redfern	13.09419%
Patoil Corp.	2.86979%
Union Oil of Calif.	7.44981%
Claremont Corp.	1.39902%
	100.00000%

CERTIFICATION

I hereby certify that the information contained herein is true and complete to the best of my knowledge and belief.

Name Elmer Stutz
Position
Reg. Opr. Mgr. - Prod.
Company
Cities Service O&G Corp.
Date
July 19, 1984

I hereby certify that the well location shown on this plat was plotted from field notes of actual surveys made by me or under my supervision, and that the same is true and correct to the best of my knowledge and belief.

Date Surveyed
MAY 31, 1984

Registered Professional Engineer
and/or Land Surveyor

John W. West

Certificate No. JOHN W. WEST, 676
RONALD J. EIDSON, 3239

0 330 660 990 1320 1650 1980 2310 2640 2000 1500 1000 500 0

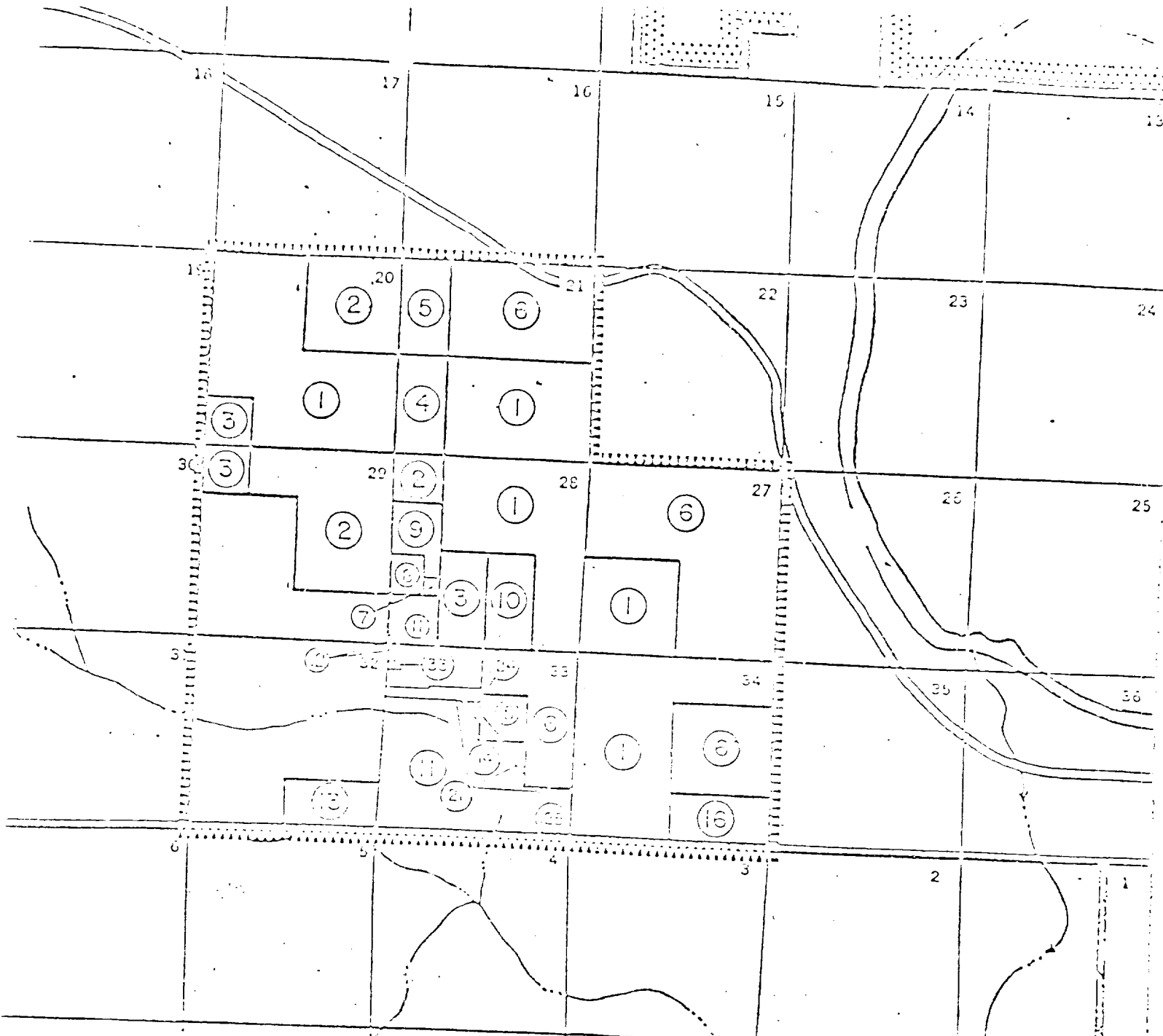

ACT NO. WORKING INTEREST OWNER **R-27-E**
 3,4,5,7, Amarillo Oil Co., Flag-Redfern Oil Co.
 ,14,21 & 33 Cities Service Oil Co.
 Amoco Production Co.
 J.H. Huber, Pierce & Davis
 Union Oil Co. of Calif.
 Patoil Corp.
 Champlin Petro. Co.
 15,124 **EDDY COUNTY, NEW MEXICO**
 35 **SEPT. 22 1972**
 Unleased Acreage **PLAT OF UNIT AREA**
 UNIT AREA
 ② TRACT NUMBERS
 SCALE: 1" = 4000'

EXHIBIT "A" PART IV



LTR



Job separation sheet

NE MEXICO OIL CONSERVATION COMMISSION
WELL LOCATION AND ACREAGE DEDICATION PLAT

Form C-102
Supersedes C-128
Effective 1-1-65

All distances must be from the outer boundaries of the Section

Operator CITIES SERVICE OIL & GAS CORP.		Lease GOVERNMENT AD COM		Well No. 3	
Grid Letter H	Section 21	Township 21 SOUTH	Range 27 EAST	County EDDY	
Actual Footage Location of Well: 1980 feet from the NORTH line and 660 feet from the EAST line					
Ground Level Elev. 3232.5	Producing Formation Morrow		Pool Undes. Burton Flat Morrow	Dedicated Acreage: 320 Acres	

- Outline the acreage dedicated to the subject well by colored pencil or hachure marks on the plat below.
- If more than one lease is dedicated to the well, outline each and identify the ownership thereof (both as to working interest and royalty).
- If more than one lease of different ownership is dedicated to the well, have the interests of all owners been consolidated by communitization, unitization, force-pooling, etc?

☐ Yes ☐ No If answer is "yes," type of consolidation Unitization (see reverse side)

If answer is "no," list the owners and tract descriptions which have actually been consolidated. (Use reverse side of this form if necessary.)

No allowable will be assigned to the well until all interests have been consolidated (by communitization, unitization, forced-pooling, or otherwise) or until a non-standard unit, eliminating such interests, has been approved by the Commission.

Unit block consists of 4932 acres. Working interests of participating companies in this proposed well are as follows:

Cities Service	61.70003%
Flag Redfern	13.48716%
John & Rosalind Redfern	13.09419%
Patoil Corp.	2.86979%
Union Oil of Calif.	7.44981%
Claremont Corp.	1.39902%
	100.00000%

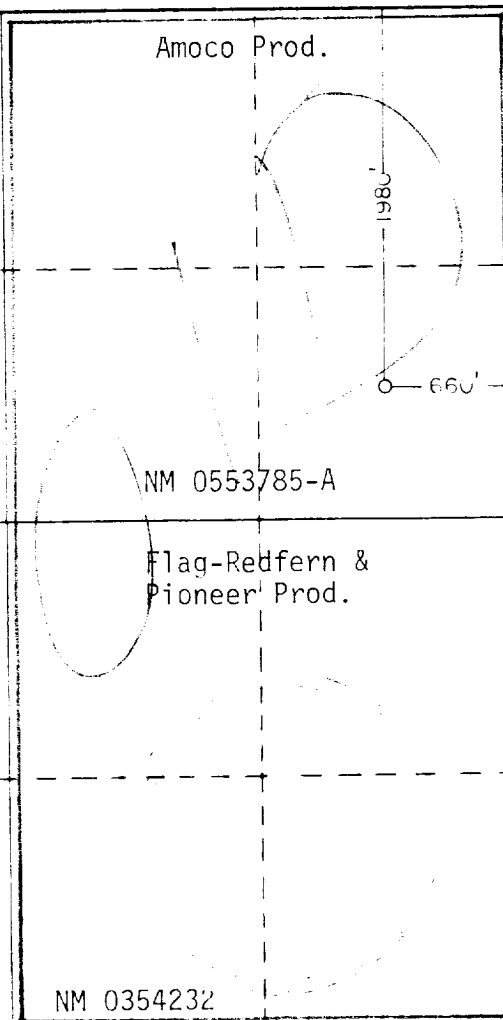

CERTIFICATION

I hereby certify that the information contained herein is true and complete to the best of my knowledge and belief.

Name
Elmer H. Startz
Position
Reg. Opr. Mgr. - Prod.

Company
Cities Service O&G Corp.

Date
July 2, 1984

I hereby certify that the well location shown on this plat was plotted from field notes of actual surveys made by me or under my supervision, and that the same is true and correct to the best of my knowledge and belief.

Date Surveyed
MAY 31, 1984

Registered Professional Engineer
and/or Land Surveyor

John W. West
Certificate No. JOHN W. WEST, 676
RONALD J. EIDSON, 3239

NM 0354232



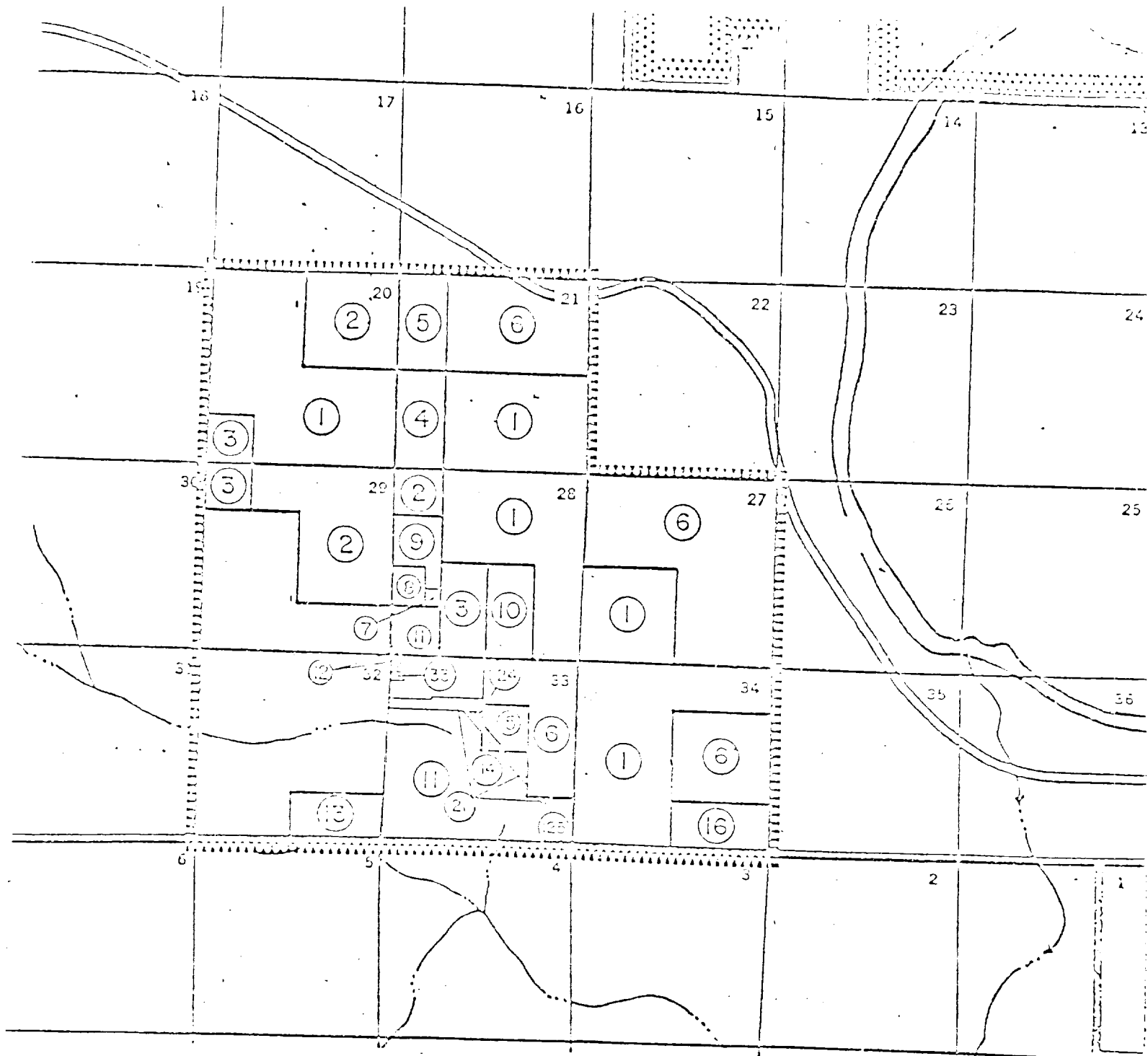

TRACT NO.

WORKING INTEREST OWNER

R-27-E

Amarillo Oil Co., Flag-Redfern Oil Co.

3,4,5,7,

0,14,21 & 33 Cities Service Oil Co.

Amoco Production Co.

J.M. Huber, Pierce & Davis

Union Oil Co. of Calif.

Patoil Corp.

Champlin Petro. Co.

EDDY COUNTY, NEW MEXICO

EXHIBIT "A" PART IV

15,124

125

Unleased Acreage

PLAT OF UNIT AREA

UNIT AREA

② TRACT NUMBERS

SCALE: 1" = 4000'