

All distances must be from the outer boundaries of the Section.

Operator Eagle Oil & Gas		Lease Loafer Draw "A" Federal Comm.		Well No. #1
Unit Letter B	Section 20	Township 21 South	Range 22 East	County Eddy
Actual Footage Location of Well 2310 feet from the East line and 660 feet from the North line				
Ground Level Elev. 4491	Producing Formation Morrow	Pool Wildcat	Dedicated Acreage 320 Acres	

1. Outline the acreage dedicated to the subject well by colored pencil or hatchure marks on the plat below.
2. If more than one lease is dedicated to the well, outline each and identify the ownership thereof (both as to working interest and royalty).
3. If more than one lease of different ownership is dedicated to the well, have the interests of all owners been consolidated by communitization, unitization, force-pooling, etc?

☒ Yes ☐ No If answer is "yes," type of consolidation _____

If answer is "no," list the owners and tract descriptions which have actually been consolidated. (Use reverse side of this form if necessary.) _____

No allowable will be assigned to the well until all interests have been consolidated (by communitization, unitization, forced-pooling, or otherwise) or until a non-standard unit, eliminating such interests, has been approved by the Division

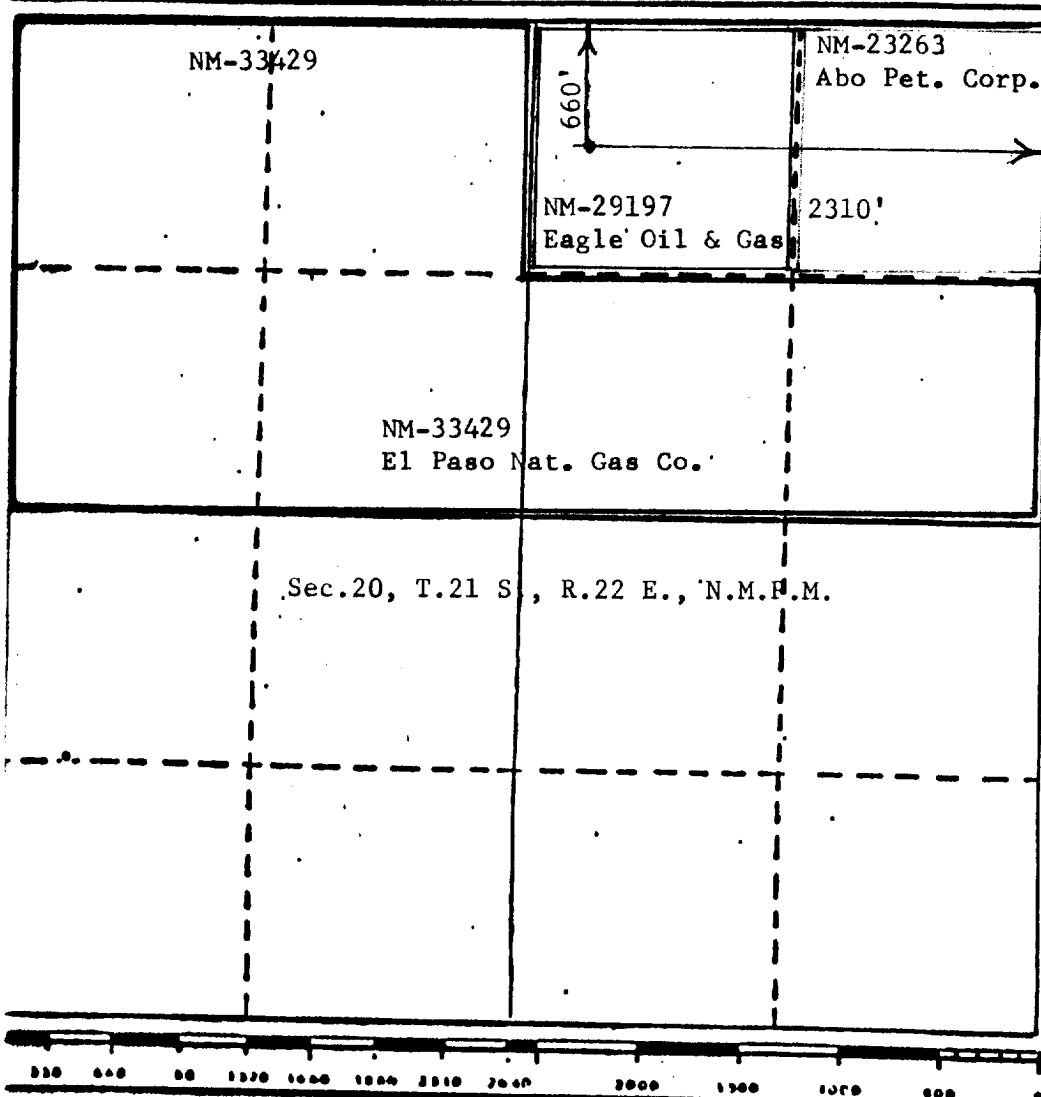

CERTIFICATION

I hereby certify that the information contained herein is true and complete to the best of my knowledge and belief.

George R. Smith

Name
George R. Smith

Position
Agent for:

Company
Eagle Oil & Gas Co.

Date
November 8, 1984

I hereby certify that the well location shown on this plat was plotted from field notes of actual surveys made by me or under my supervision, and that the same is true and correct to the best of my knowledge and belief.

Date Surveyed
November 15, 1984
Professional Engineer
John D. Jacques, P.E. & L.S.
License No. 6290