

Exxon Lse. No. \_\_\_\_\_

MEXICO OIL CONSERVATION COMMISSION

State Lse. No. \_\_\_\_\_

## WELL LOCATION AND ACREAGE DEDICATION PLAT

Form C-102  
Supersedes C-128  
Effective 1-1-65

Federal Lse. No. \_\_\_\_\_

All distances must be from the outer boundaries of the Section.

Operator Exxon Corporation		Lease J.A. TOMAINO FED. COM.		Well No. 1
Unit Letter L	Section 27	Township 22 S	Range 26 E	County EDDY
Actual Footage Location of Well: 1980 feet from the SOUTH line and 660 feet from the WEST line				
Ground Level Elev. 3250'	Producing Formation MORROW	Pool UNDESIG. HAPPY VALLEY-MORROW	Dedicated Acreage: 320 Acres	

1. Outline the acreage dedicated to the subject well by colored pencil or hachure marks on the plat below.
2. If more than one lease is dedicated to the well, outline each and identify the ownership thereof (both as to working interest and royalty).
3. If more than one lease of different ownership is dedicated to the well, have the interests of all owners been consolidated by communitization, unitization, force-pooling, etc?

☐ Yes ☐ No If answer is "yes," type of consolidation COMMUNITIZATION IS PENDING.

If answer is "no," list the owners and tract descriptions which have actually been consolidated. (Use reverse side of this form if necessary.) \_\_\_\_\_

No allowable will be assigned to the well until all interests have been consolidated (by communitization, unitization, forced-pooling, or otherwise) or until a non-standard unit, eliminating such interests, has been approved by the Commission.

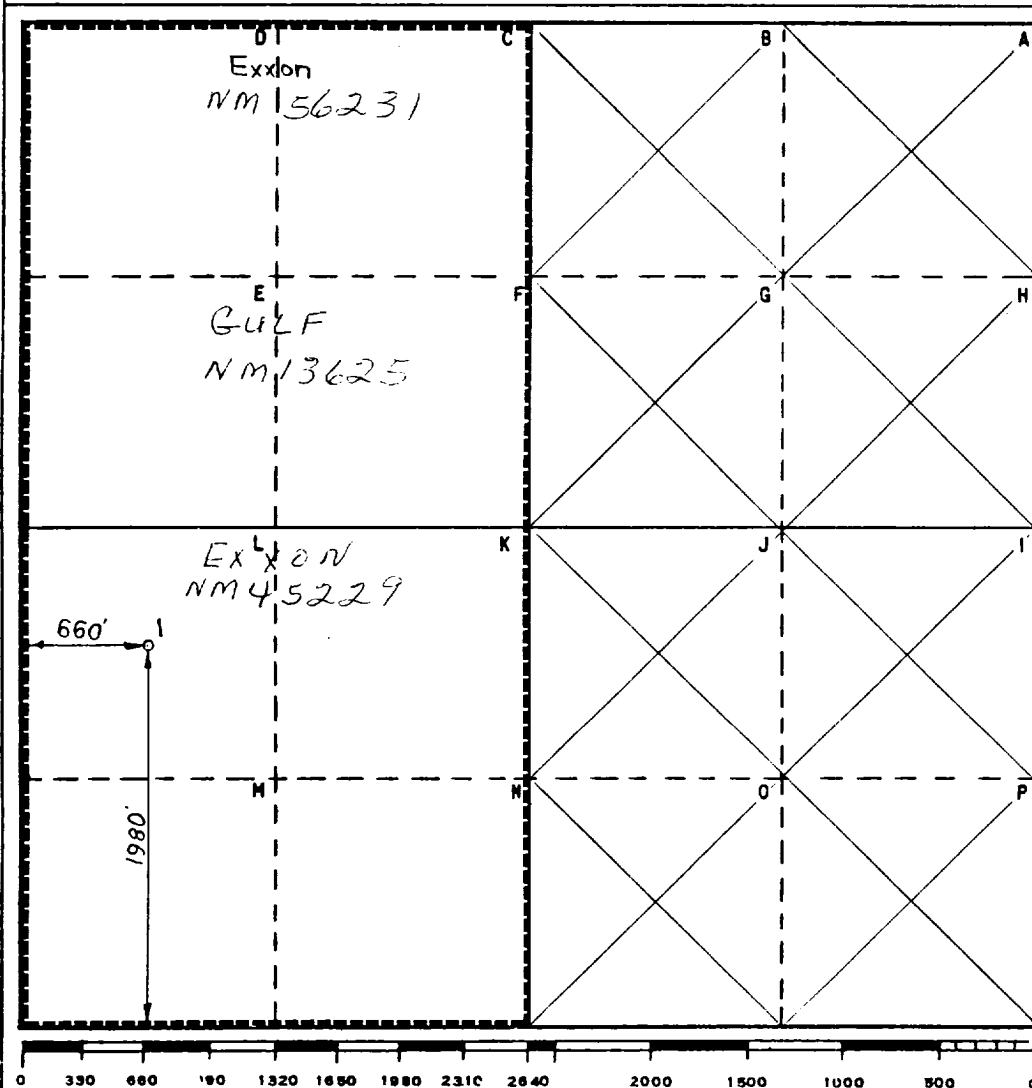

## CERTIFICATION

I hereby certify that the information contained herein is true and complete to the best of my knowledge and belief.

Name  
Melba Kripling  
Position  
UNIT HEAD  
Company  
Exxon Corporation  
Box 1600 Midland, Texas  
Date  
2-6-86

I hereby certify that the well location shown on this plat was plotted from field notes of actual surveys made by me or under my supervision, and that the same is true and correct to the best of my knowledge and belief.

BRUCE R. PENNELL  
NEW MEXICO  
REGISTERED PROFESSIONAL ENGINEER  
9062

Date Surveyed  
1-16-86  
Registered Professional Engineer  
and/or Land Surveyor

Bruce R. Pennell  
Certificate No.

9062

5 Miles SW of CARLSBAD, New Mexico

C.E. Sec. File No. A-9226