

NEW MEXICO OIL CONSERVATION COM SION
WELL LOCATION AND ACREAGE DEDICATION PLAT

Form C-102
Supersedes C-128
Effective 1-1-65

All distances must be from the outer boundaries of the Section.

| | | | | | |
|---|-------------------------------|----------------------|----------------------------|---------------------------------|---------------|
| Operator MARATHON OIL COMPANY | | | Lease INDIAN HILLS UNIT | | Well No. 6 |
| Unit Letter N | Section 20 | Township 21 SOUTH | Range 24 EAST | County EDDY | |
| Actual Footage Location of Well: 560 feet from the SOUTH line and 1550 feet from the WEST line | | | | | |
| Ground Level Elev. 3752.7' | Producing Formation Morrow | Pool Morrow | | Dedicated Acreage: 640 Acres | |

1. Outline the acreage dedicated to the subject well by colored pencil or hachure marks on the plat below.
2. If more than one lease is dedicated to the well, outline each and identify the ownership thereof (both as to working interest and royalty).
3. If more than one lease of different ownership is dedicated to the well, have the interests of all owners been consolidated by communitization, unitization, force-pooling, etc?

☐ Yes ☐ No If answer is "yes," type of consolidation _____

If answer is "no," list the owners and tract descriptions which have actually been consolidated. (Use reverse side of this form if necessary.) _____

No allowable will be assigned to the well until all interests have been consolidated (by communitization, unitization, forced-pooling, or otherwise) or until a non-standard unit, eliminating such interests, has been approved by the Commission.

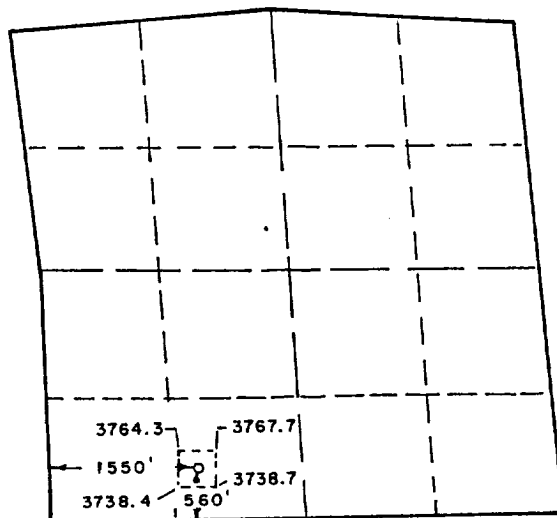

SCALE 1" = 2000'

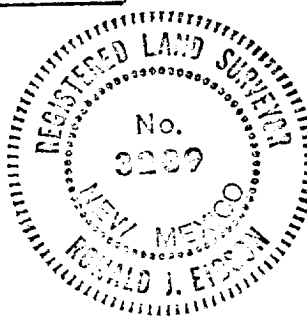

CERTIFICATION

I hereby certify that the information contained herein is true and complete to the best of my knowledge and belief.

Terry L. Rivers

Name

Terry L. Rivers

Position

Dist. Drlg Superintendent

Company

Marathon Oil Company

Date

October 28, 1987

I hereby certify that the well location shown on this plat was plotted from field notes of actual surveys made by me or under my supervision, and that the same is true and correct to the best of my knowledge and belief.

Date Surveyed

OCTOBER 16, 1987

Registered Professional Engineer and/or Land Surveyor

Ronald J. Eidson

Certificate No. JOHN W. WEST 676

Ronald J. Eidson 3239