

NO. OF COPIES RECEIVED	
DISTRIBUTION	✓
SANTA FE	✓
FILE	✓
USING	✓
LAND OFFICE	✓
OPERATOR	✓

NEW MEXICO OIL CONSERVATION COMMISSION
RECEIVED

30-015-25881
Form 7-101
Revised 1-1-85

FEB 26 '88

O. C. D.

APPLICATION FOR PERMIT TO DRILL, DEEPEN, OR PLUG BACK

a. Type of Work DRILL <input checked="" type="checkbox"/> DEEPEN <input type="checkbox"/> PLUG BACK <input type="checkbox"/>		5A. Lease Type of Lease STATE <input type="checkbox"/> FEL <input checked="" type="checkbox"/>
b. Type of Well OIL <input checked="" type="checkbox"/> GAS WELL <input type="checkbox"/> OTHER <input type="checkbox"/> SINGLE ZONE <input type="checkbox"/> MULTIPLE ZONE <input type="checkbox"/>		7. Unit Agreement Name
c. Well Name Ray Westall		8. Form or Lease Name Baseball Park
d. Well Location P.O. Box 4, Loco Hills, New Mexico 88255		9. Well No. 5
e. Well Depth FRT LETTER A LOCATED 660 FNL FEET FROM THE 660 FEL LINE		10. Field and Loc, or Well No. So. Carlsbad Delaware
f. Well Depth FEET FROM THE LINE OF FNL 24 TWP. 22S RGE. 26E		11. County Eddy
g. Well Depth 4650		12. Direction Rotary
h. Well Depth Blanket		13. Approx. Date Work will start ASAP

PROPOSED CASING AND CEMENT PROGRAM

SIZE OF HOLE	SIZE OF CASING	WEIGHT PER FOOT	SETTING DEPTH	SACKS OF CEMENT	EST. TOP
12 1/2"	8 5/8"	24#	3100' 300	circulate	
8"	4 1/2"	17#	4650'	600 sx	

We propose to drill and test the Delaware formation. Approximately 300' of 8 5/8" surface casing will be set to shut off gravel and caving. 4 1/2" production casing will be run, perforated and frac'd for production.

BOP PROGRAM: A 10" Series 900 Shaffer Type F Double BOP will be used in drilling this well.

MUD PROGRAM: Fresh water will be used to drill the surface. Brine water to within 150' of TD and mud up to log and run casing.

POST ID#1
NL & API
3-4-88

180
9/2/88

IN ABOVE SPACE DESCRIBE PROPOSED PROGRAM: IF PROPOSAL IS TO DEEPEN OR PLUG BACK, GIVE DATA ON PRESENT PRODUCTIVE ZONE AND PROPOSED NEW PRODUCE ZONE, AND REGROUT PREVENTER PROGRAM, IF ANY.

I hereby certify that the information above is true and complete to the best of my knowledge and belief.

Signed Ray Westall Title Operator Date 2/24/88

(This space for State Use)

Original Signed By

Mike Williams

Oil & Gas Inspector

APPROVED BY _____ TITLE _____ DATE MAR 2 1988

CONDITIONS OF APPROVAL, IF ANY:

8 5/8

NEW MEXICO OIL CONSERVATION COMMISSION
WELL LOCATION AND ACREAGE DEDICATION PLAT

Form C-102
Supersedes C-128
Effective 1-1-65

All distances must be from the outer boundaries of the Section.

Operator RAY WESTALL		Lease Baseball Park		Well No. 5
Unit Letter A	Section 24	Township 22 South	Range 26 East	County Eddy County, N.M.
Actual Footage Location of Well: 660 feet from the North line and 660 feet from the East line				
Ground Level Elev. 3156.	Producing Formation Delaware	Pool S. Calsbad Delaware	Dedicated Acreage: 40 Acres	

1. Outline the acreage dedicated to the subject well by colored pencil or hachure marks on the plat below.
2. If more than one lease is dedicated to the well, outline each and identify the ownership thereof (both as to working interest and royalty).
3. If more than one lease of different ownership is dedicated to the well, have the interests of all owners been consolidated by communitization, unitization, force-pooling, etc?

☐ Yes ☐ No If answer is "yes," type of consolidation _____

If answer is "no," list the owners and tract descriptions which have actually been consolidated. (Use reverse side of this form if necessary.) _____

No allowable will be assigned to the well until all interests have been consolidated (by communitization, unitization, forced-pooling, or otherwise) or until a non-standard unit, eliminating such interests, has been approved by the Commission.

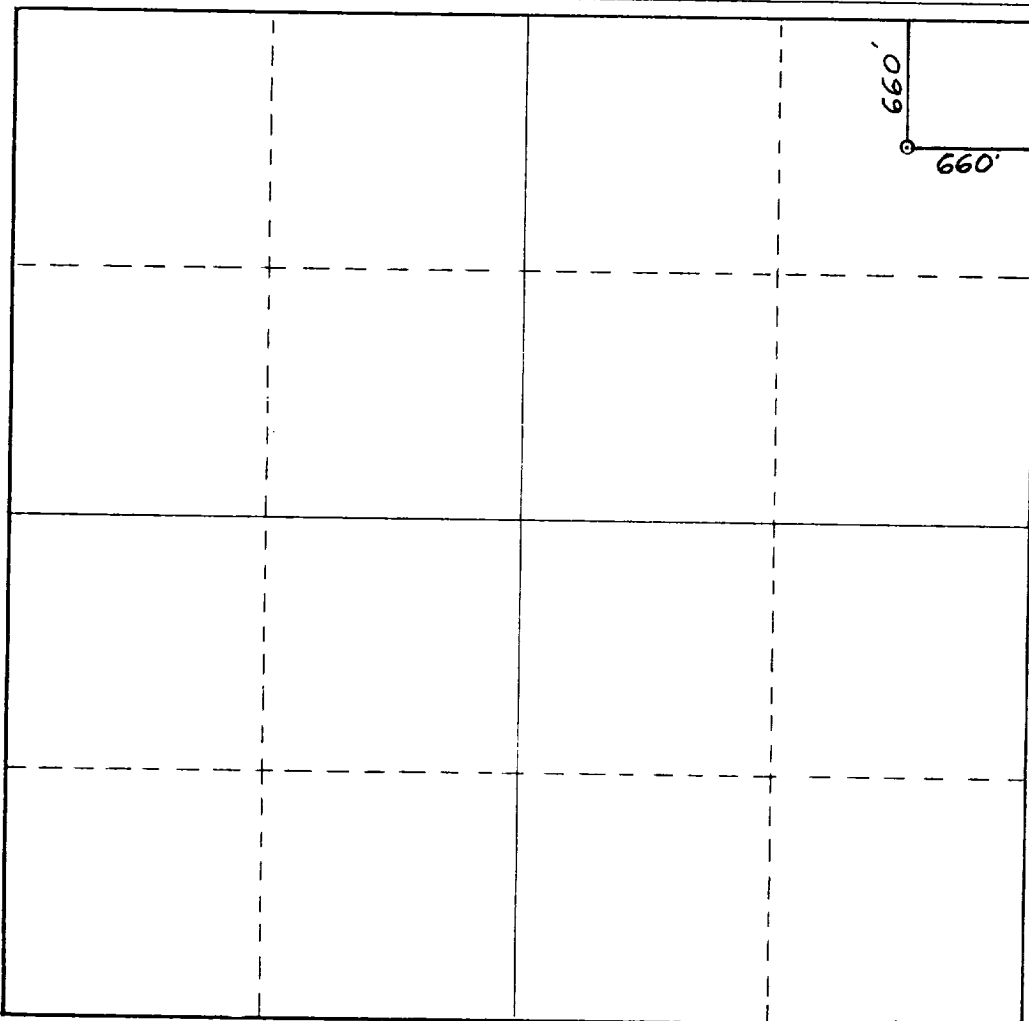

CERTIFICATION

I hereby certify that the information contained herein is true and complete to the best of my knowledge and belief.

Name **Ray Westall**
Position **Operator**
Company **Ray Westall**
Date **2-24-88**

I hereby certify that the well location shown on this plat was plotted from field notes of actual surveys made by me or under my supervision, and that the same is true and correct to the best of my knowledge and belief.

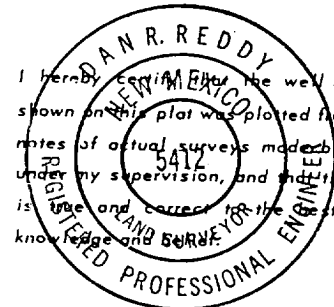

Date Surveyed
February 17, 1988
Registered Professional Engineer
and/or Land Surveyor

Dan R. Reddy
Certificate No.
NM PE&LS NO. 5412

