

mit to Appropriate
dict Office
Lease - 4 copies
Lease - 3 copies

State of New Mexico
Energy, Minerals and Natural Resources Department

Form C-102
Revised 1-1-89

OIL CONSERVATION DIVISION

P.O. Box 2088
Santa Fe, New Mexico 87504-2088

RECEIVED

JUL 3 10 50 AM '90

TRICLI
Box 1980, Hobbs, NM 88240

TRICLI
Drawer DD, Artesia, NM 88210

TRICLI
Rio Brazos Rd., Aztec, NM 87410

WELL LOCATION AND ACREAGE DEDICATION PLAT

All Distances must be from the outer boundaries of the section

CARLE
AREA

Operator Strata Production Company			Lease Aguila Federal			Well No. 1		
Section 4	Township 20 South	Range 28 East	County NMIM Eddy					
Actual Footage Location of Well: 990 feet from the North line and 2080 feet from the West line Producing Formation Delaware Pool Winchester Dedicated Acreage: 40 Acres								

1. Outline the acreage dedicated to the subject well by colored pencil or hatchure marks on the plat below.

2. If more than one lease is dedicated to the well, outline each and identify the ownership thereof (both as to working interest and royalty).

3. If more than one lease of different ownership is dedicated to the well, have the interest of all owners been consolidated by communization, unitization, force-pooling, etc.?

☐ Yes

☐ No

If answer is "yes" type of consolidation

If answer is "no" list the owners and tract descriptions which have actually been consolidated. (Use reverse side of this form if necessary.)

No allowable will be assigned to the well until all interests have been consolidated (by communization, unitization, forced-pooling, or otherwise) or until a non-standard unit, eliminating such interest, has been approved by the Division.

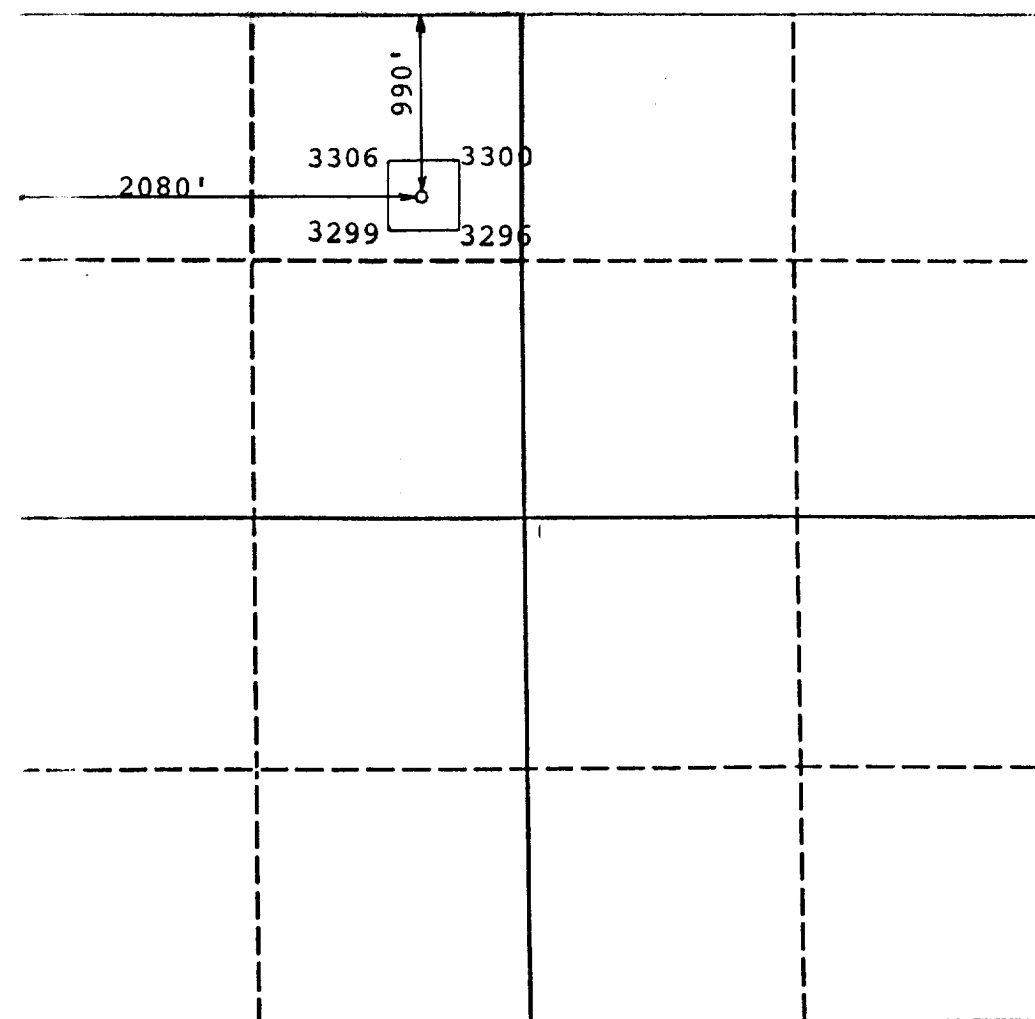

OPERATOR CERTIFICATION

I hereby certify that the information contained herein is true and complete to the best of my knowledge and belief.

Signature

James G. McClelland

Printed Name

James G. McClelland

Position

Vice President

Company

Strata Production Co.

Date

7-2-90

SURVEYOR CERTIFICATION

I hereby certify that the well location shown on this plat was plotted from field notes of actual surveys made by me or under my supervision, and that the same is true and correct to the best of my knowledge and belief.

Date Surveyed

June 28, 1990

Signature & Seal of Professional Surveyor

P.R. Patton

Certificate No.

8112