

Submit to Appropriate
District Office
State Lease - 6 copies
Fee Lease - 5 copies

State of New Mexico
Energy, Minerals and Natural Resources Department

Form C-101
Revised 1-1-89

DISTRICT I
P.O. Box 1980, Hobbs, NM 88240

DISTRICT II
P.O. Drawer DD, Artesia, NM 88210

DISTRICT III
1000 Rio Brazos Rd., Aztec, NM 87410

OIL CONSERVATION DIVISION
P.O. Box 2088
Santa Fe, New Mexico 87504-2088

API NO. (assigned by OCD on New Wells)

30-015-26433

5. Indicate Type of Lease

STATE ☒

FEE ☐

6. State Oil & Gas Lease No.

LG-4525

7. Lease Name or Unit Agreement Name

Flathead State

8. Well No.

1

9. Pool name or Wildcat

Parkway Delaware

APPLICATION FOR PERMIT TO DRILL, DEEPEN, OR PLUG BACK

1a. Type of Work:

DRILL ☒

RE-ENTER ☐

DEEPEN ☐

PLUG BACK ☐

b. Type of Well:

OIL
WELL ☒

GAS
WELL ☐

OTHER ☐

SINGLE
ZONE ☒

MULTIPLE
ZONE ☐

2. Name of Operator

Siete Oil and Gas Corporation

3. Address of Operator

P.O. Box 2523

Roswell, NM 88202-2523

4. Well Location

Unit Letter B : 330' Feet From The North Line and 1650' Feet From The East Line

Section 2 Township 20S Range 29E NMPM Eddy County

10. Proposed Depth

4990'

11. Formation

Delaware

12. Rotary or C.T.

Rotary

13. Elevations (Show whether DF, RT, GR, etc.)

3320' GR

14. Kind & Status Plug. Bond

Surety (Pending)

15. Drilling Contractor

Pending

16. Approx. Date Work will start

ASAP

17.

PROPOSED CASING AND CEMENT PROGRAM

SIZE OF HOLE	SIZE OF CASING	WEIGHT PER FOOT	SETTING DEPTH	SACKS OF CEMENT	EST. TOP
17 1/2"	13 3/8"	54.5#	350'	350 sxs circ	Surface
12 1/4"	8 5/8"	24# & 32#	3200'	1200 sxs circ	Surface
7 7/8"	5 1/2"	15.5#	4990'	700 sxs	N/A

RECEIVED

JUL 19 '90

C. ... D.
ARTESIA, OFFICE

posted ID 1
8-3-90
N.M. API

IN ABOVE SPACE DESCRIBE PROPOSED PROGRAM: IF PROPOSAL IS TO DEEPEN OR PLUG BACK, GIVE DATA ON PRESENT PRODUCTIVE ZONE AND PROPOSED NEW PRODUCTIVE ZONE. GIVE BLOWOUT PREVENTER PROGRAM, IF ANY.

I hereby certify that the information above is true and complete to the best of my knowledge and belief.

SIGNATURE Cathy Batley-Seely TITLE Drilling/Production Tech. DATE 7/16/90

TYPE OR PRINT NAME

TELEPHONE NO.

(This space for State Use)

ORIGINAL SIGNED BY

MIKE WILLIAMS

APPROVED BY SUPERVISOR, DISTRICT II

TITLE

DATE

JUL 30 1990

CONDITIONS OF APPROVAL, IF ANY:

NOTIFY N.M.O.C.D. IN SUFFICIENT
TIME TO WITNESS CEMENTING THE
CASING

NEW MEXICO OIL CONSERVATION COMMISSION
WELL LOCATION AND ACREAGE DEDICATION PLAT

Form C-102
Supersedes C-128
Effective 1-1-65

All distances must be from the outer boundaries of the Section.

Operator SIETE OIL & GAS CORPORATION			Lease Flat Head State		Well No. 1
Unit Letter B	Section 2	Township 20 South	Range 29 East	County Eddy County, N.M.	
Actual Footage Location of Well: 330 feet from the North line and 1650 feet from the East line					
Ground Level Elev. 3320.	Producing Formation Delaware		Pool Parkway	Dedicated Acreage: 40 Acres	

1. Outline the acreage dedicated to the subject well by colored pencil or hatchure marks on the plat below.
2. If more than one lease is dedicated to the well, outline each and identify the ownership thereof (both as to working interest and royalty).
3. If more than one lease of different ownership is dedicated to the well, have the interests of all owners been consolidated by communitization, unitization, force-pooling, etc?

☐ Yes ☐ No If answer is "yes," type of consolidation _____

If answer is "no," list the owners and tract descriptions which have actually been consolidated. (Use reverse side of this form if necessary.) _____

No allowable will be assigned to the well until all interests have been consolidated (by communitization, unitization, forced-pooling, or otherwise) or until a non-standard unit, eliminating such interests, has been approved by the Commission.

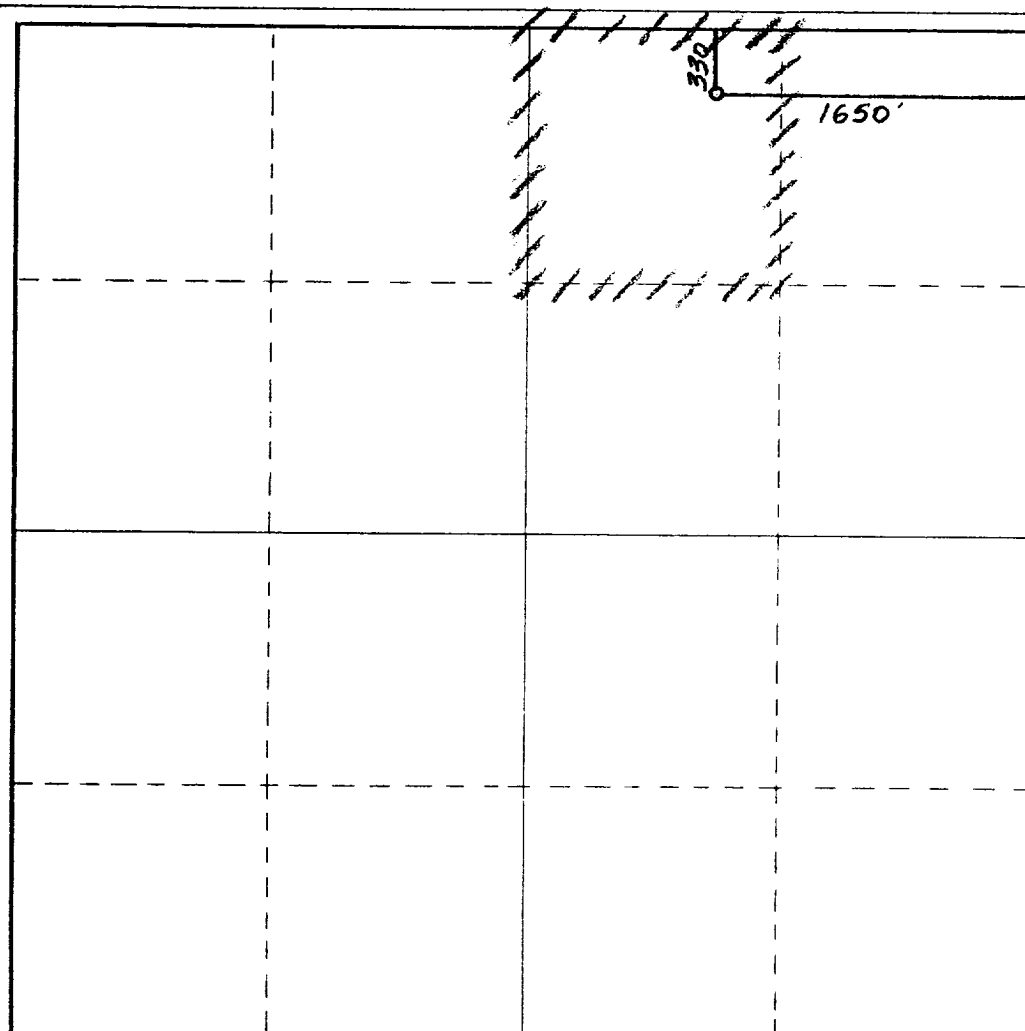

CERTIFICATION

I hereby certify that the information contained herein is true and complete to the best of my knowledge and belief.

Cathy Batley-Seely
Name
Drilling/Production Technician

Position
Siete Oil & Gas Corporation

Company
July 16, 1990

Date

I hereby certify that the well location shown on this plat was plotted from field notes of actual surveys made by me or under my supervision, and that the same are true and correct to the best of my knowledge and belief.

Dan R. Reddy
REGISTERED PROFESSIONAL ENGINEER
NEW MEXICO
JUL 12 1990

Date Surveyed

May 21, 1990

Registered Professional Engineer
and/or Land Surveyor

Dan R. Reddy
Certificate No.
NM PE&LS NO. 5412

