

NEW MEXICO OIL CONSERVATION COMMISSION
WELL LOCATION AND ACREAGE DEDICATION PLAT

Form C-102
Supersedes C-128
Effective 1-1-65

All distances must be from the outer boundaries of the Section.

Operator SIETE OIL & GAS CORPORATION			Lease INDIGO FEDERAL		Well No. 1
Unit Letter L	Section 13	Township 20 South	Range 28 East	County Eddy County, N.M.	
Actual Footage Location of Well: 1650 feet from the South line and 660 feet from the West line					
Ground Level Elev. 3247.	Producing Formation Bone Spring		Pool Wildcat	Dedicated Acreage: 40 Acres	

1. Outline the acreage dedicated to the subject well by colored pencil or hachure marks on the plat below.
2. If more than one lease is dedicated to the well, outline each and identify the ownership thereof (both as to working interest and royalty).
3. If more than one lease of different ownership is dedicated to the well, have the interests of all owners been consolidated by communitization, unitization, force-pooling, etc?

☐ Yes ☐ No If answer is "yes," type of consolidation _____

If answer is "no," list the owners and tract descriptions which have actually been consolidated. (Use reverse side of this form if necessary.) _____

No allowable will be assigned to the well until all interests have been consolidated (by communitization, unitization, forced-pooling, or otherwise) or until a non-standard unit, eliminating such interests, has been approved by the Commission.

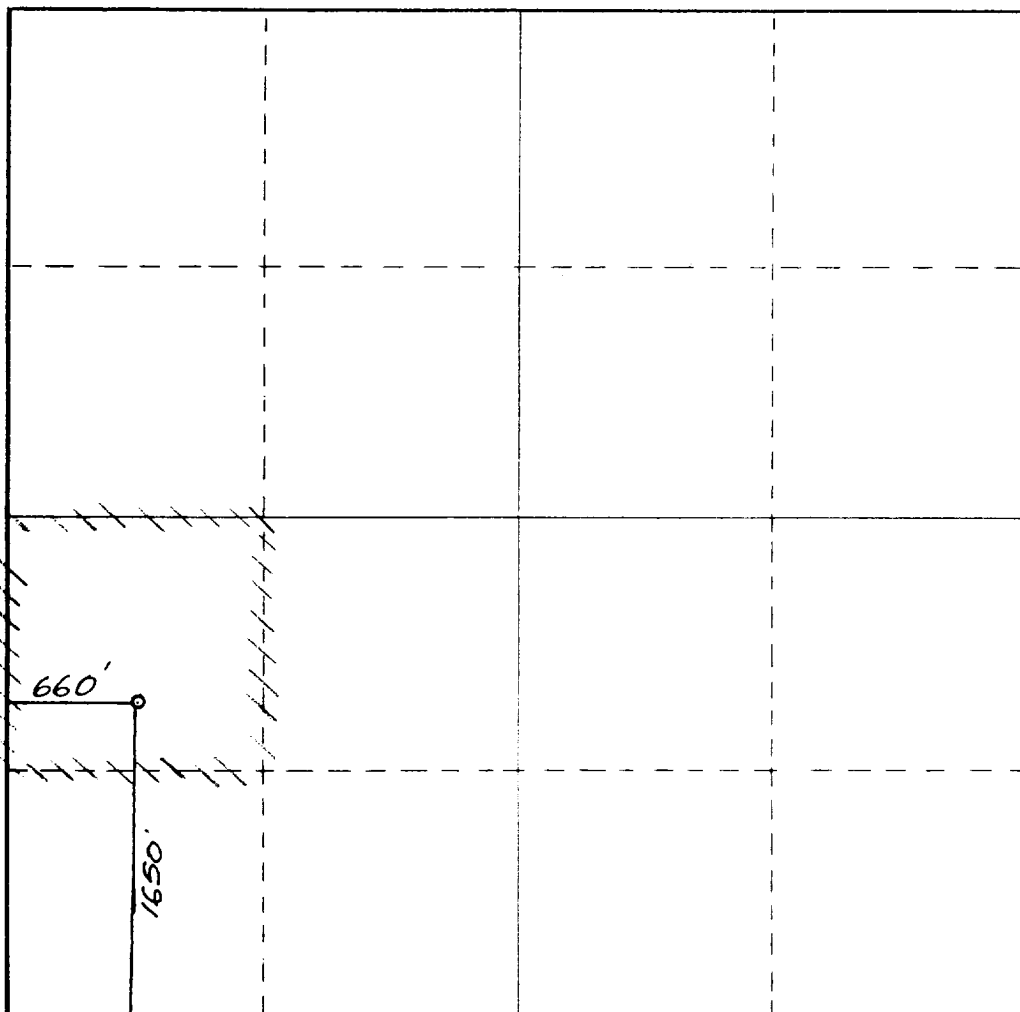

CERTIFICATION

I hereby certify that the information contained herein is true and complete to the best of my knowledge and belief.

Cathy Batley-Seely
Name
Cathy Batley-Seely
Position
Drilling Technician
Company
Siete Oil and Gas Corporation
Date
23 August 1990

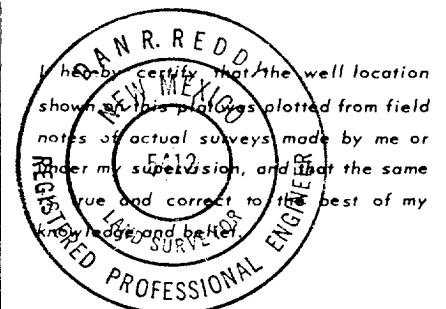

Date Surveyed
June 21, 1990
Registered Professional Engineer
and/or Land Surveyor

Dan R. Reddy
Certificate No.

NM PE&PS NO. 5412

