

# OIL CONSERVATION DIVISION

P.O. Box 2088  
Santa Fe, New Mexico 87504-2088

## DISTRICT I

P.O. Box 1980, Hobbs, NM 88240

## DISTRICT II

P.O. Drawer DD, Artesia, NM 88210

## DISTRICT III

1000 Rio Brazos Rd., Aztec, NM 87410

## WELL LOCATION AND ACREAGE DEDICATION PLAT

All Distances must be from the outer boundaries of the section

Operator SANTA FE ENERGY OPERATING PARTNERS LP			Lease RIGHT HAND CANYON FEDERAL		Well No. 1
Unit Letter E	Section 34	Township 21 SOUTH	Range 24 EAST	NMPM	County EDDY
Actual Footage Location of Well: 1980 feet from the NORTH line and 990 feet from the WEST line					
Ground Level Elev. 3762.1'	Producing Formation Morrow		Pool Indian Hills (Morrow)		Dedicated Acreage: 320 Acres

- Outline the acreage dedicated to the subject well by colored pencil or hatchure marks on the plat below.
- If more than one lease is dedicated to the well, outline each and identify the ownership thereof (both as to working interest and royalty).
- If more than one lease of different ownership is dedicated to the well, have the interest of all owners been consolidated by communitization, unitization, force-pooling, etc.?

☐ Yes ☒ No If answer is "yes" type of consolidation \_\_\_\_\_

If answer is "no" list of owners and tract descriptions which have actually been consolidated. (Use reverse side of this form necessary.)

No allowable will be assigned to the well unit all interests have been consolidated (by communitization, unitization, forced-pooling, otherwise) or until a non-standard unit, eliminating such interest, has been approved by the Division.

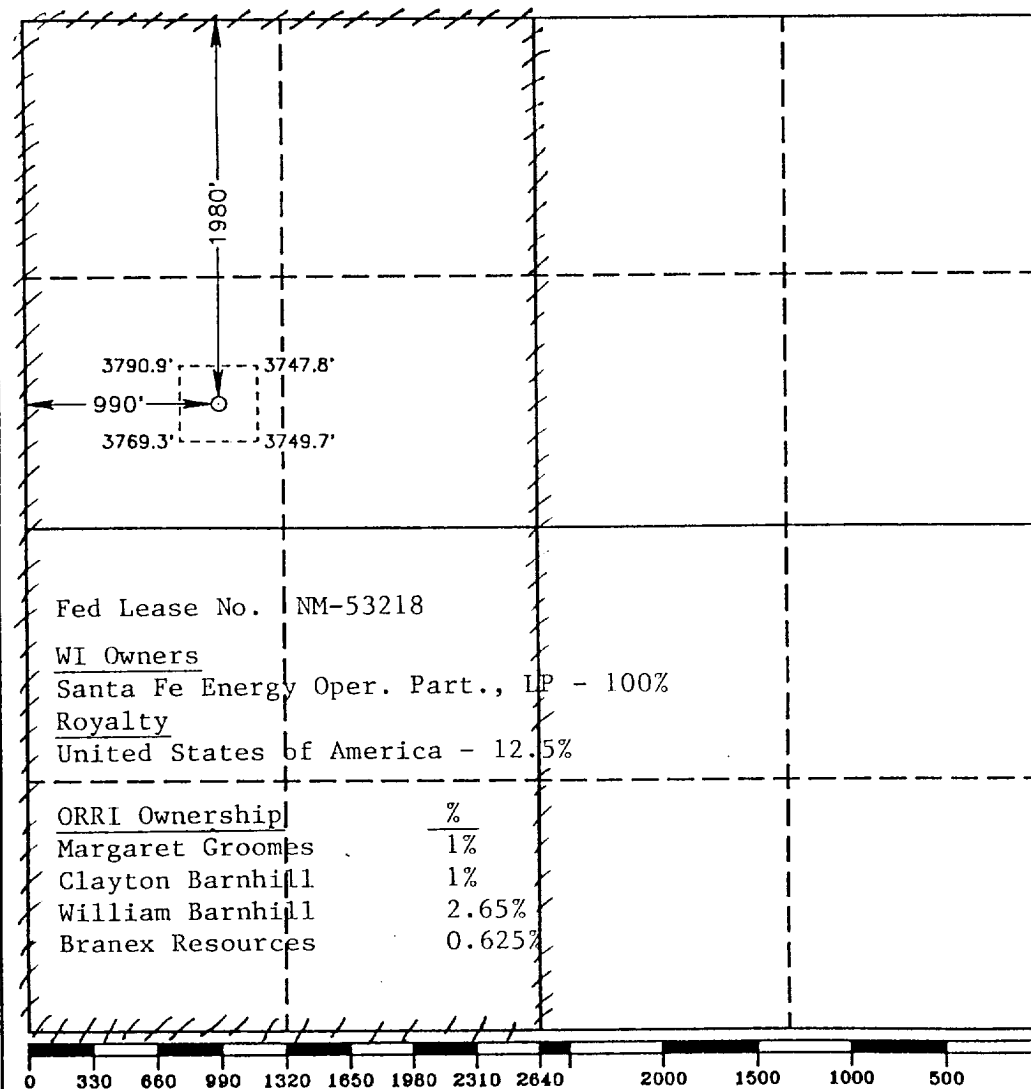

### OPERATOR CERTIFICATION

I hereby certify that the information contained herein is true and complete to the best of my knowledge and belief.

Signature

*Darrell Roberts*

Printed Name

Darrell Roberts

Position

Sr. Drilling Engineer

Company Santa Fe Energy

Operating Partners, L.P.

Date

May 14, 1992

### SURVEYOR CERTIFICATION

I hereby certify that the well location shown on this plat was plotted from field notes of actual surveys made by me or under my supervision, and that the same is true and correct to the best of my knowledge and belief.

Date Surveyed

APRIL 16, 1992

Signature & Seal of  
Professional Surveyor

Certificate No. *Ronald J. Eidson*  
JOHN W. WEST 676  
RONALD J. EIDSON 3239  
GARY L. JONES 7977

92-41-0841