

OIL CONSERVATION DIVISION

P.O. Box 2088

Santa Fe, New Mexico 87504-2088

(Change in unit configuration)
30-015-27046

DISTRICT I

P.O. Box 1980, Hobbs, NM 88240

DISTRICT II

P.O. Drawer DD, Artesia, NM 88210

DISTRICT III

1000 Rio Brazos Rd., Aztec, NM 87410

WELL LOCATION AND ACREAGE DEDICATION PLAT

All Distances must be from the outer boundaries of the section

| | | | | | |
|---|---|----------------------|------------------------------------|---------------------------------|---------------|
| Operator SANTA FE ENERGY OPERATING PARTNERS LP | | | Lease RIGHT HAND CANYON FEDERAL | | Well No. 1 |
| Unit Letter E | Section 34 | Township 21 SOUTH | Range 24 EAST NMPM | County EDDY | |
| Actual Footage Location of Well: 1980 feet from the NORTH line and 990 feet from the WEST line | | | | | |
| Ground Level Elev. 3762.1' | Producing Formation Upper Penn. Assoc. | Pool Indian Basin | | Dedicated Acreage: 320 Acres | |

- Outline the acreage dedicated to the subject well by colored pencil or hachure marks on the plat below.
- If more than one lease is dedicated to the well, outline each and identify the ownership thereof (both as to working interest and royalty).
- If more than one lease of different ownership is dedicated to the well, have the interest of all owners been consolidated by communitization, unitization, force-pooling, etc.?
☐ Yes ☐ No If answer is "yes" type of consolidation _____

If answer is "no" list of owners and tract descriptions which have actually been consolidated. (Use reverse side of this form necessary.)

No allowable will be assigned to the well unit all interests have been consolidated (by communitization, unitization, forced-pooling, otherwise) or until a non-standard unit, eliminating such interest, has been approved by the Division.

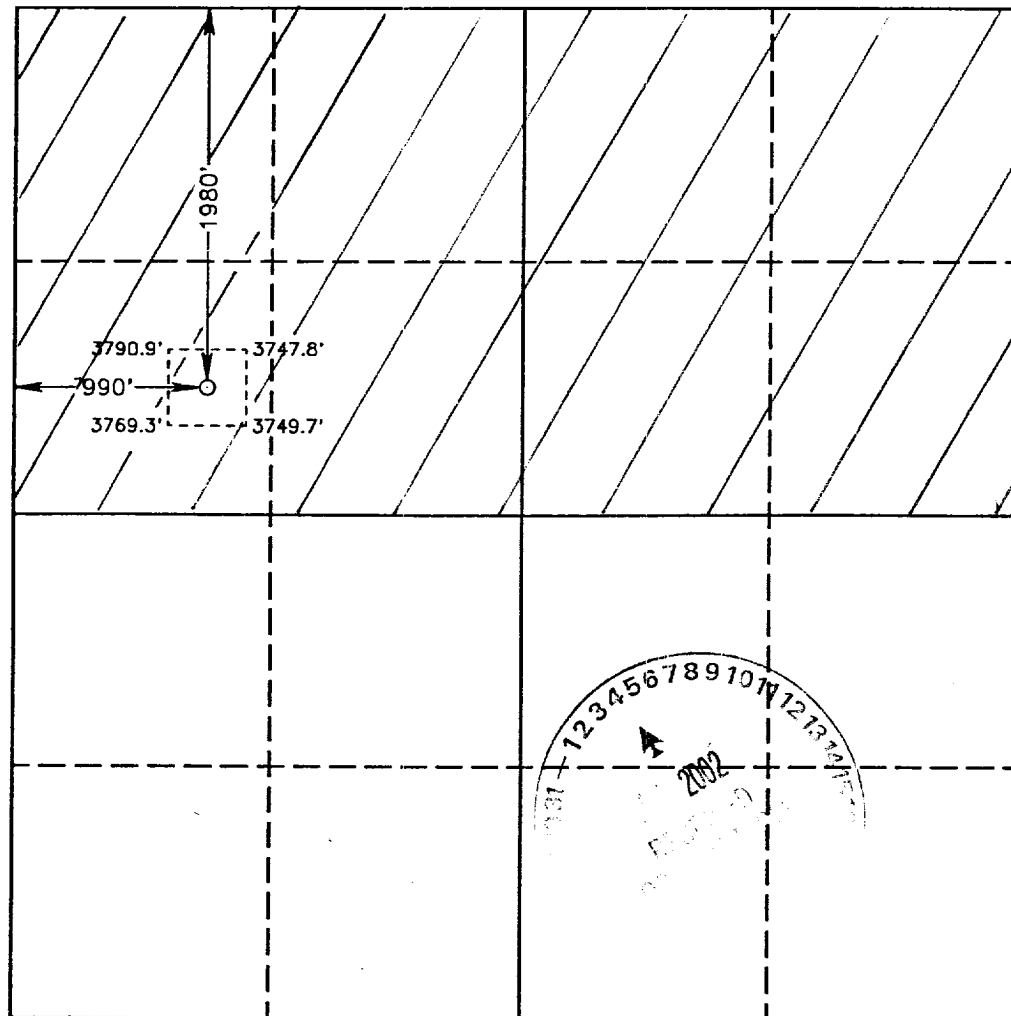

OPERATOR CERTIFICATION

I hereby certify the the information contained herein is true and complete to the best of my knowledge and belief.

Signature

Candace R. Graham

Printed Name

Candace R. Graham

Position

Engr. Tech.

Company

Devon-SES Operating, Inc.

Date

January 3, 2002

SURVEYOR CERTIFICATION

I hereby certify that the well location shown on this plat was plotted from field notes of actual surveys made by me or under my supervision, and that the same is true and correct to the best of my knowledge and belief.

Date Surveyed

APRIL 16, 1992

Signature & Seal of
Professional Surveyor

REGISTERED LAND SURVEYOR
No. 3039
RONALD J. EDSON
RONALD J. EDSON, 3239
EDDY COUNTY, NEW MEXICO
EDDY COUNTY, NEW MEXICO, 87410

92-11-0541