

Submit to Appropriate
District Office
State Lease - 6 copies
Fee Lease - 5 copies

State of New Mexico
Energy, Minerals and Natural Resources Department

Form C-101
Revised 1-1-89

OIL CONSERVATION DIVISION

DISTRICT I
P.O. Box 1980, Hobbs, NM 88240

DISTRICT II
P.O. Drawer DD, Artesia, NM 88210

DISTRICT III
1000 Rio Brazos Rd., Aztec, NM 87410

P.O. Box 2088
Santa Fe, New Mexico 87504-2088

1-10-1992

O.C.D.

API NO. (assigned by OCD on New Wells)

30-015-27236

5. Indicate Type of Lease

STATE ☒

FEE ☐

6. State Oil & Gas Lease No.

L-6706

APPLICATION FOR PERMIT TO DRILL, DEEPEN, OR PLUG BACK

1a. Type of Work:

DRILL ☒

RE-ENTER ☐

DEEPEN ☐

PLUG BACK ☐

b. Type of Well:

OIL
WELL ☒

GAS
WELL ☐

OTHER ☐

SINGLE
ZONE ☒

MULTIPLE
ZONE ☐

7. Lease Name or Unit Agreement Name

Cactus State

2. Name of Operator

Devon Energy Corporation (Nevada) ✓

8. Well No.

1

3. Address of Operator

20 North Broadway Suite 1500 Oklahoma City, OK 73102

9. Pool name or Wildcat

East Catclaw Delaware

4. Well Location

Unit Letter C : 960 Feet From The North Line and 1860 Feet From The West Line

Section 16

Township 21S

Range 26E

NMPM

Eddy

County

10. Proposed Depth

4500'

11. Formation

Delaware

12. Rotary or C.T.

Rotary

13. Elevations (Show whether DF, RT, GR, etc.)

3295.1 GR

14. Kind & Status Plug. Bond

Blanket

15. Drilling Contractor

to be determined

16. Approx. Date Work will start

January 1, 1993

17.

PROPOSED CASING AND CEMENT PROGRAM

SIZE OF HOLE	SIZE OF CASING	WEIGHT PER FOOT	SETTING DEPTH	SACKS OF CEMENT	EST. TOP
17-1/2"	13-3/8"	48	350'	400 sx "C"	Surface
11" 12 1/4"	8-5/8"	24	2200'	700 Lite/250 "C"	Surface
7-7/8"	5-1/2"	15.5	4500'	150 50/50, 325 "C"	1800'

BOP's will be installed while drilling intermediate and production hole.

Post ID-1

12-18-92

New Line & API

APPROVAL VALID FOR 180 DAYS
PERMIT EXPIRES 6-10-93
UNLESS DRILLING UNDERWAY

IN ABOVE SPACE DESCRIBE PROPOSED PROGRAM: IF PROPOSAL IS TO DEEPEN OR PLUG BACK, GIVE DATA ON PRESENT PRODUCTIVE ZONE AND PROPOSED NEW PRODUCTIVE ZONE. GIVE BLOWOUT PREVENTER PROGRAM, IF ANY.

I hereby certify that the information above is true and complete to the best of my knowledge and belief.

SIGNATURE

Charles W. Horsman

TITLE

District Engineer

DATE

12/7/92

TYPE OR PRINT NAME

Charles W. Horsman

TELEPHONE NO. 405-235-3611

(This space for State Use)

APPROVED BY

Mark Redding

TITLE

DATE

DEC 10 1992

CONDITIONS OF APPROVAL, IF ANY:

* AS NOTED ABOVE

NOTIFY N.M.O.C.D. IN SUFFICIENT
TIME TO WITNESS CEMENTING THE
13 3/8, 8 5/8 CASING

OIL CONSERVATION DIVISION

P.O. Box 2088

Santa Fe, New Mexico 87504-2088

DISTRICT I

P.O. Box 1980, Hobbs, NM 88240

DISTRICT II

P.O. Drawer DD, Artesia, NM 88210

DISTRICT III

1000 Rio Brazos Rd., Aztec, NM 87410

WELL LOCATION AND ACREAGE DEDICATION PLAT

All Distances must be from the outer boundaries of the section

Operator DEVON ENERGY			Lease CACTUS STATE		Well No. 1
Unit Letter C	Section 16	Township 21 SOUTH	Range 26 EAST NMPM	County EDDY	
Actual Footage Location of Well: 960 feet from the NORTH line and 1860 feet from the WEST line					
Ground Level Elev. 3295.1'		Producing Formation DELAWARE		Pool EAST CATCLAW DELAWARE	
				Dedicated Acreage: 40 Acres	

1. Outline the acreage dedicated to the subject well by colored pencil or hatchure marks on the plat below.
2. If more than one lease is dedicated to the well, outline each and identify the ownership thereof (both as to working interest and royalty).
3. If more than one lease of different ownership is dedicated to the well, have the interest of all owners been consolidated by communitization, unitization, force-pooling, etc.?
☐ Yes ☐ No If answer is "yes" type of consolidation _____

If answer is "no" list of owners and tract descriptions which have actually been consolidated. (Use reverse side of this form necessary.)

No allowable will be assigned to the well unit all interests have been consolidated (by communitization, unitization, forced-pooling, otherwise) or until a non-standard unit, eliminating such interest, has been approved by the Division.

OPERATOR CERTIFICATION

I hereby certify the the information contained herein is true and complete to the best of my knowledge and belief.

Signature

Printed Name

CHUCK HORSMAN

Position

ENGINEER

Company

DEVON ENERGY CORP (NEVADA)

Date

DECEMBER 7, 1992

SURVEYOR CERTIFICATION

I hereby certify that the well location shown on this plat was plotted from field notes of actual surveys made by me or under my supervision, and that the same is true and correct to the best of my knowledge and belief.

Date Surveyed

DECEMBER 1, 1992

Signature & Seal of Professional Surveyor

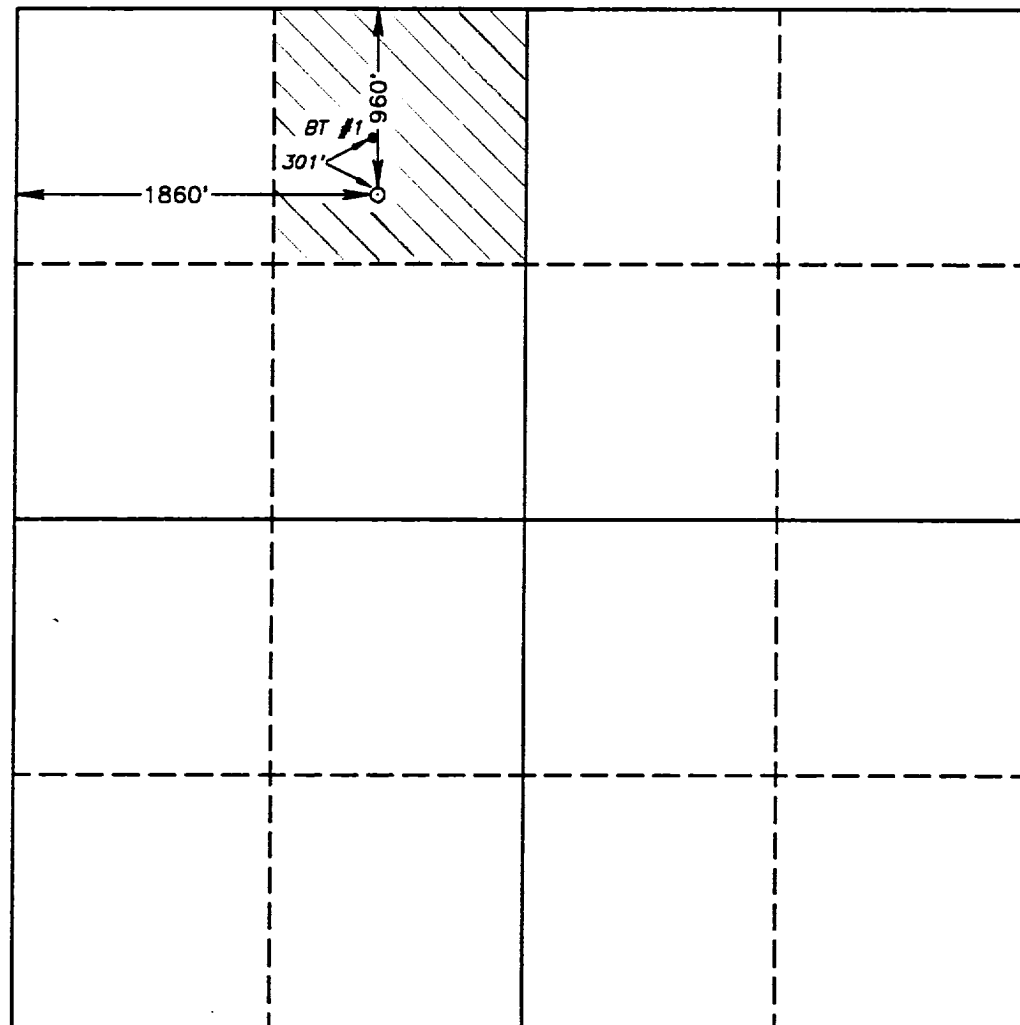
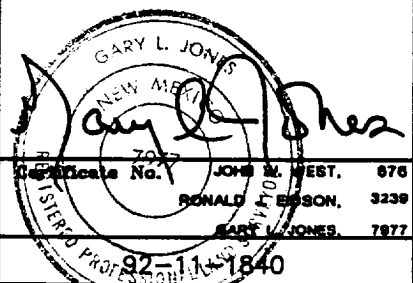

0 330 660 990 1320 1650 1980 2310 2640 2000 1500 1000 500 0