

OIL CONSERVATION DIVISION

DISTRICT I
P.O. Box 1980, Hobbs, NM 88240

P.O. Box 2088
Santa Fe, New Mexico 87504-2088

DISTRICT II
P.O. Drawer DD, Artesia, NM 88210

DISTRICT III
1000 Rio Brazos Rd., Aztec, NM 87410

WELL LOCATION AND ACREAGE DEDICATION PLAT

All Distances must be from the outer boundaries of the section

Operator BARBARA FASKEN			Lease SKELLY FEDERAL		Well No. 2
Unit Letter F	Section 9	Township 21 SOUTH	Range 24 EAST	NMPM	County EDDY
Actual Footage Location of Well: 1604 feet from the NORTH line and 1912 feet from the WEST line					
Ground Level Elev. 4140.0'	Producing Formation Morrow		Pool Cemetery		Dedicated Acreage: 320 Acres

1. Outline the acreage dedicated to the subject well by colored pencil or hatchure marks on the plat below.
2. If more than one lease is dedicated to the well, outline each and identify the ownership thereof (both as to working interest and royalty).
3. If more than one lease of different ownership is dedicated to the well, have the interest of all owners been consolidated by communitization, unitization, force-pooling, etc.?
☒ Yes ☐ No If answer is "yes" type of consolidation Communitization

If answer is "no" list of owners and tract descriptions which have actually been consolidated. (Use reverse side of this form necessary.)

No allowable will be assigned to the well unit all interests have been consolidated (by communitization, unitization, forced-pooling, otherwise) or until a non-standard unit, eliminating such interest, has been approved by the Division.

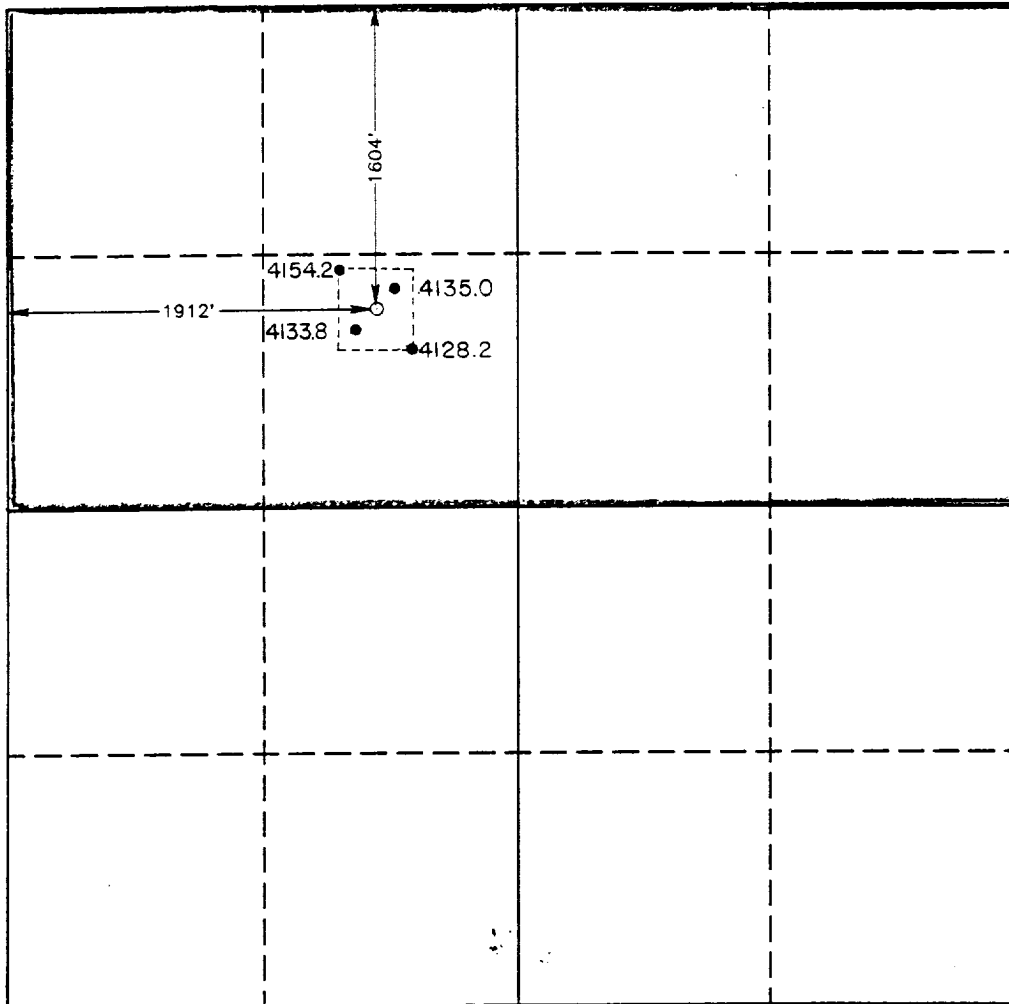

OPERATOR CERTIFICATION

I hereby certify the the information contained herein is true and complete to the best of my knowledge and belief.

Signature

Tommy E. Taylor

Printed Name

Tommy E. Taylor

Position

Drilg. & Prod. Engineer

Company

Barbara Fasken

Date

October 12, 1992

SURVEYOR CERTIFICATION

I hereby certify that the well location shown on this plat was plotted from field notes of actual surveys made by me or under my supervision, and that the same is true and correct to the best of my knowledge and belief.

Date Surveyed

SEPTEMBER 2, 1992

Signature & Seal of
Professional Surveyor

JOHN W. WEST, 878
RONALD J. EIDSON, 3239
GARY L. JONES, 7977

92-11-1299