

Submit to Appropriate
District Office
State Lease - 6 copies
Fee Lease - 5 copies

State of New Mexico
Energy, Minerals and Natural Resources Department

Form C-101
Revised 1-1-89

DISTRICT I
P.O. Box 1980, Hobbs, NM 88240

DISTRICT II
P.O. Drawer DD, Artesia, NM 88210

DISTRICT III
1000 Rio Brazos Rd., Aztec, NM 87410

OIL CONSERVATION DIVISION

P.O. Box 208
Santa Fe, New Mexico 87504-2088

MAY 19 1994

API NO. (assigned by OCD on New Wells)

30-115-27463

5. Indicate Type of Lease

STATE ☒ ☐

FEE ☐

6. State Oil & Gas Lease No.
V-3070

7. Lease Name or Unit Agreement Name

14025 15085

Wagon Unit AOG ST.

8. Well No.
1

9. Pool name or Wildcat
Wildcat Yeso 96032

APPLICATION FOR PERMIT TO DRILL, DEEPEN, OR PLUG BACK

1a. Type of Work:

DRILL ☐

RE-ENTER ☒

DEEPEN ☐

PLUG BACK ☐

b. Type of Well:

OIL
WELL ☒

GAS
WELL ☐

OTHER ☐

SINGLE
ZONE ☐

MULTIPLE
ZONE ☐

2. Name of Operator

YATES PETROLEUM CORPORATION

3. Address of Operator

105 South Fourth Street, Artesia, New Mexico 88210

4. Well Location

Unit Letter

G

: 1980

Feet From The

North

Line and

1980

Feet From The

East

Section

32

Township

22 South

Range

23 East

NMPM

Eddy

County

10. Proposed Depth

2560'

11. Formation

Yeso

12. Rotary or C.T.

Pulling Unit

13. Elevations (Show whether DF, RT, GR, etc.)

4283

14. Kind & Status Plug. Bond
Blanket

15. Drilling Contractor
Undesignated

16. Approx. Date Work will start
ASAP

17.

PROPOSED CASING AND CEMENT PROGRAM

SIZE OF HOLE	SIZE OF CASING	WEIGHT PER FOOT	SETTING DEPTH	SACKS OF CEMENT	EST. TOP
17 1/2"	13 3/8"		360'		In Place
12 1/4"	9 5/8"		2690'		In Place

We plan to re-enter the Wagon Unit #1 that was P & A'd on 10-2-93 by Yates Petroleum Corporation. We plan to drill out the plug set at 0-50', plug at 300' to 428', the plug at 2000' to 2121' and clean out well to 2560'. We will perforate at 2358' to 2366' and stimulate as needed for production.

Part ID-1
5-27-94
Re-entry

IN ABOVE SPACE DESCRIBE PROPOSED PROGRAM: IF PROPOSAL IS TO DEEPEN OR PLUG BACK, GIVE DATA ON PRESENT PRODUCTIVE ZONE AND PROPOSED NEW PRODUCTIVE ZONE. GIVE BLOWOUT PREVENTER PROGRAM, IF ANY.

I hereby certify that the information above is true and complete to the best of my knowledge and belief.

SIGNATURE

Ken Beardemphl

TITLE

Ken Beardemphl

DATE

5/18/94

TYPE OR PRINT NAME

Ken Beardemphl

TELEPHONE NO. 748-4346

(This space for State Use)

APPROVED BY

Mark Kelly

TITLE

GEOLOGIST

APPROVAL VALID FOR 180 DAYS

PERMIT EXPIRES 11-19-94

UNLESS DRILLING UNDERWAY

Submit to Appropriate
District Office
State Lease - 4 copies
Fee Lease - 3 copies

State of New Mexico
Energy, Minerals and Natural Resources Department

Form C-102
Revised 1-1-89
RECEIVED

OIL CONSERVATION DIVISION

P.O. Box 2088
Santa Fe, New Mexico 87504-2088

MAY 26 '94

DISTRICT I
P.O. Box 1980, Hobbs, NM 88240

DISTRICT II
P.O. Drawer DD, Artesia, NM 88210

DISTRICT III
1000 Rio Brazos Rd., Aztec, NM 87410

WELL LOCATION AND ACREAGE DEDICATION PLAT
All Distances must be from the outer boundaries of the section

O. C. D.
ARTESIA, OFFICE

Operator YATES PETROLEUM CORPORATION			Lease Wagon AOG State		Well No. 1
Unit Letter G	Section 32	Township 22 South	Range 23 East	County Eddy County, New Mexico	

Actual Footage Location of Well:

1980 feet from the North line and 1980 feet from the East line			
Ground level Elev. 4283	Producing Formation Yeso	Pool Wildcat Yeso	Dedicated Acreage: 40 Acres

1. Outline the acreage dedicated to the subject well by colored pencil or hatchure marks on the plat below.
2. If more than one lease is dedicated to the well, outline each and identify the ownership thereof (both as to working interest and royalty).
3. If more than one lease of different ownership is dedicated to the well, have the interest of all owners been consolidated by communitization, unitization, force-pooling, etc.?
☐ Yes ☐ No If answer is "yes" type of consolidation _____
If answer is "no" list the owners and tract descriptions which have actually been consolidated. (Use reverse side of this form if necessary.) _____
No allowable will be assigned to the well until all interests have been consolidated (by communitization, unitization, forced-pooling, or otherwise) or until a non-standard unit, eliminating such interest, has been approved by the Division.

OPERATOR CERTIFICATION

I hereby certify that the information contained herein is true and complete to the best of my knowledge and belief.

Signature

Printed Name

Ken Beardemphl

Position

Landman

Company

Yates Petroleum Corporation

Date

May 26, 1994

SURVEYOR CERTIFICATION

I hereby certify that the well location shown on this plat was plotted from field notes of actual surveys made by me or under my supervision, and that the same is true and correct to the best of my knowledge and belief.

Date Surveyed

Signature & Seal of
Professional Surveyor

Refer to original plat.

Certificate No.

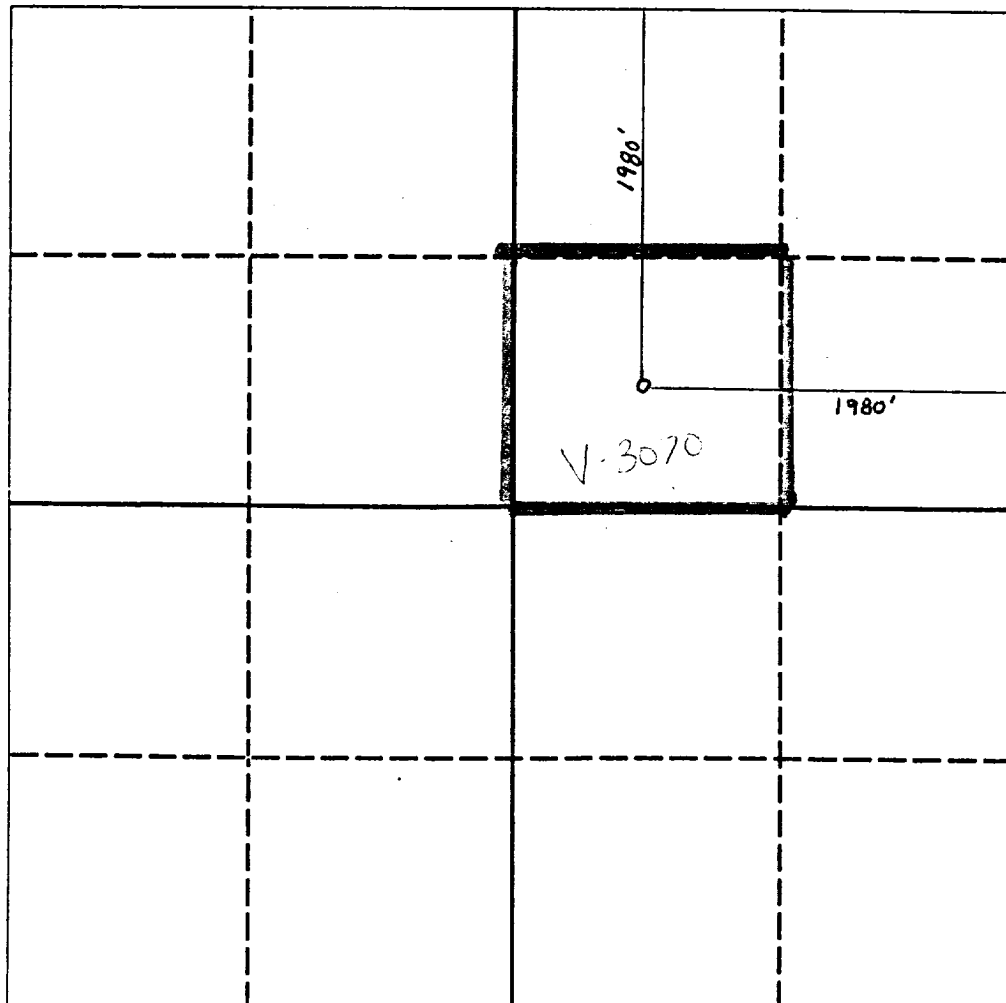

0 330 660 990 1320 1650 1980 2310 2640 2000 1500 1000 500 0