

# OIL CONSERVATION DIVISION

P.O. Box 2088  
Santa Fe, New Mexico 87504-2088

**DISTRICT I**  
P.O. Box 1980, Hobbs, NM 88240

**DISTRICT II**  
P.O. Drawer DD, Artesia, NM 88210

**DISTRICT III**  
1000 Rio Brazos Rd., Aztec, NM 87410

## WELL LOCATION AND ACREAGE DEDICATION PLAT

All Distances must be from the outer boundaries of the section

Operator Nearburg Producing Company			Lease Big Walt 2 State		Well No. 2
Unit Letter J	Section 2	Township 22 - S	Range 24 - E	County Eddy	
Actual Footage Location of Well: 1650 feet from the South line and 1980 feet from the East line					
Ground level Elev. 3930	Producing Formation Cisco/Canyon		Pool Cisco Wildcat	Dedicated Acreage: 344.66 Acres	

1. Outline the acreage dedicated to the subject well by colored pencil or hatchure marks on the plat below.
2. If more than one lease is dedicated to the well, outline each and identify the ownership thereof (both as to working interest and royalty).
3. If more than one lease of different ownership is dedicated to the well, have the interest of all owners been consolidated by communitization, unitization, force-pooling, etc.?  
☐ Yes ☒ No If answer is "yes" type of consolidation \_\_\_\_\_

If answer is "no" list the owners and tract descriptions which have actually been consolidated. (Use reverse side of this form if necessary. We are in the process of consolidating Nearburg Producing Company's NE/4 No allowable will be assigned to the well until all interests have been consolidated (by communitization, unitization, forced-pooling, or otherwise) or until a non-standard unit, eliminating such interest, has been approved by the Division. with Yates Petroleum Corps. SE/4

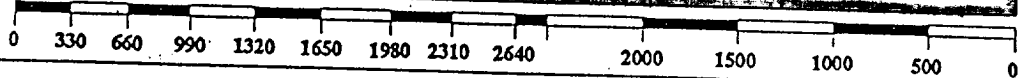
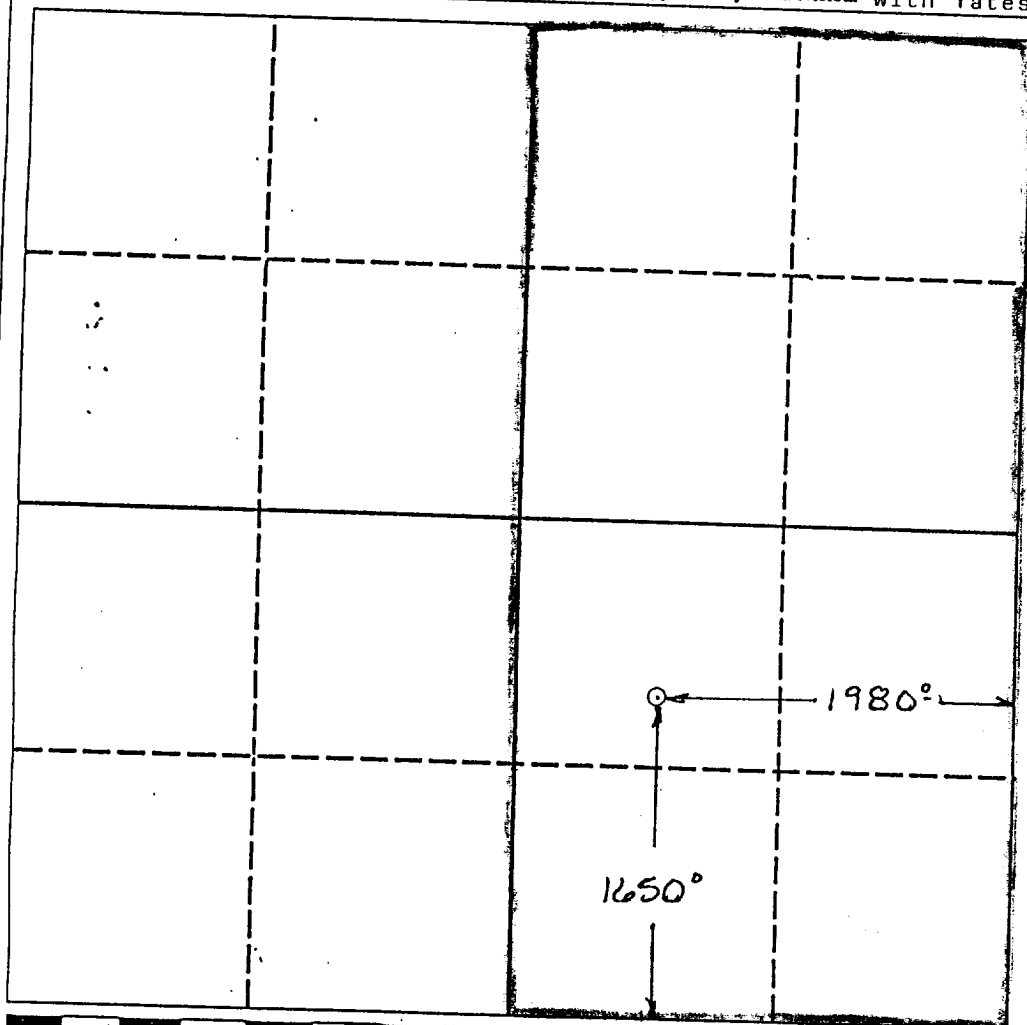

### OPERATOR CERTIFICATION

I hereby certify that the information contained herein is true and complete to the best of my knowledge and belief.

Signature  
*E. Scott Kimbrough*

Printed Name  
E. Scott Kimbrough

Position  
Mgr. of Drilling & Prod  
Company

Nearburg Producing Co.  
Date  
July 1, 1993

### SURVEYOR CERTIFICATION

I hereby certify that the well location shown on this plat was plotted from field notes of actual surveys made by me or under my supervision, and that the same is true and correct to the best of my knowledge and belief.

Date Surveyed  
July 1, 1993

Signature & Seal of Professional Surveyor  
*Truman Gaskin*  
Certificate No. 2126

