

Submit to Appropriate District Office
 State Lease - 4 copies
 Fee Lease - 3 copies

State of New Mexico
 Energy, Minerals and Natural Resources Department

Form C-102
 Revised 1-1-89

OIL CONSERVATION DIVISION

P.O. Box 2088
 Santa Fe, New Mexico 87504-2088

DISTRICT I
 P.O. Box 1980, Hobbs, NM 88240

DISTRICT II
 P.O. Drawer DD, Artesia, NM 88210

DISTRICT III
 1000 Rio Brazos Rd., Aztec, NM 87410

WELL LOCATION AND ACREAGE DEDICATION PLAT

All Distances must be from the outer boundaries of the section

Operator CHI OPERATING, INC.			Lease REMINGTON FEDERAL			Well No. 2		
Unit Letter K	Section 3	Township 20 SOUTH	Range 28 EAST		County EDDY COUNTY, NM			NMPM
Actual Footage Location of Well: 1980 feet from the SOUTH line and 1980 feet from the WEST line								
Ground level Elev. 3282.		Producing Formation Bone Spring		Pool Old Millman Ranch Bone Spring			Dedicated Acreage: 40 Acres	

- Outline the acreage dedicated to the subject well by colored pencil or hachure marks on the plat below.
- If more than one lease is dedicated to the well, outline each and identify the ownership thereof (both as to working interest and royalty).
- If more than one lease of different ownership is dedicated to the well, have the interest of all owners been consolidated by communitization, unitization, force-pooling, etc.?
 Yes No If answer is "yes" type of consolidation _____
 If answer is "no" list the owners and tract descriptions which have actually been consolidated. (Use reverse side of this form if necessary).
 No allowable will be assigned to the well until all interests have been consolidated (by communitization, unitization, forced-pooling, or otherwise) or until a non-standard unit, eliminating such interest, has been approved by the Division.

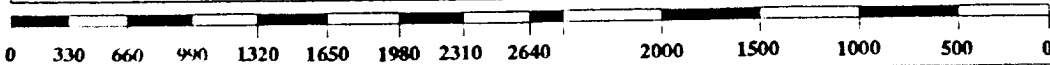
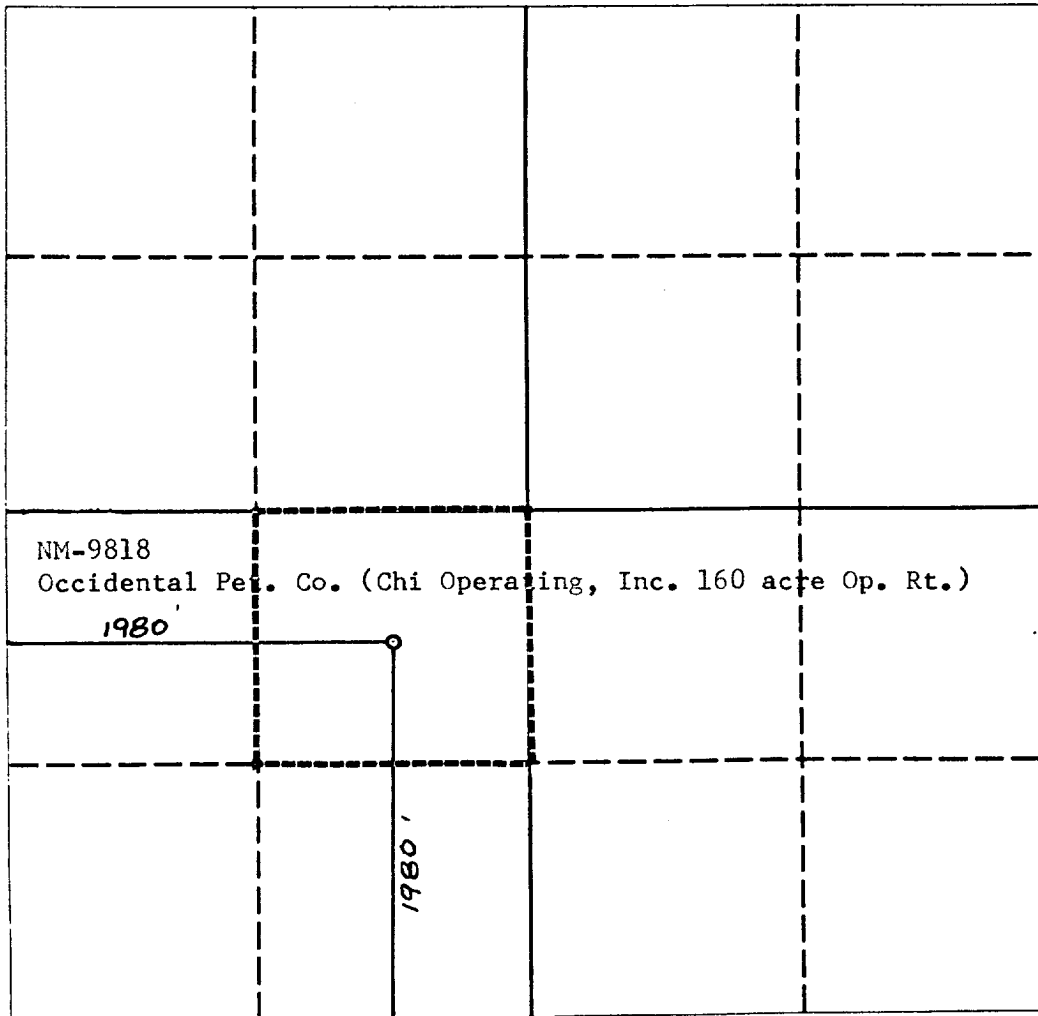

OPERATOR CERTIFICATION

I hereby certify that the information contained herein is true and complete to the best of my knowledge and belief.

Signature
George R. Smith
 Printed Name/
 George R. Smith
 Position
 Agent for:
 Company
 Chi Operating, Inc.
 Date
 August 19, 1993

SURVEYOR CERTIFICATION

I hereby certify that the well location shown on this plat was plotted from field notes of actual surveys made by me or under my supervision, and that the same is true and correct to the best of my knowledge and belief.

Date Surveyed
AUGUST 13, 1993
 Signature & Seal of
 Professional Surveyor

 D. M. EDDY
 NEW MEXICO
 5412
 PROFESSIONAL ENGINEER
 PROFESSIONAL SURVEYOR
 NM ERS & PS 5412