

PROPOSED 3-M BOPE AND CHOKE ARRANGEMENT

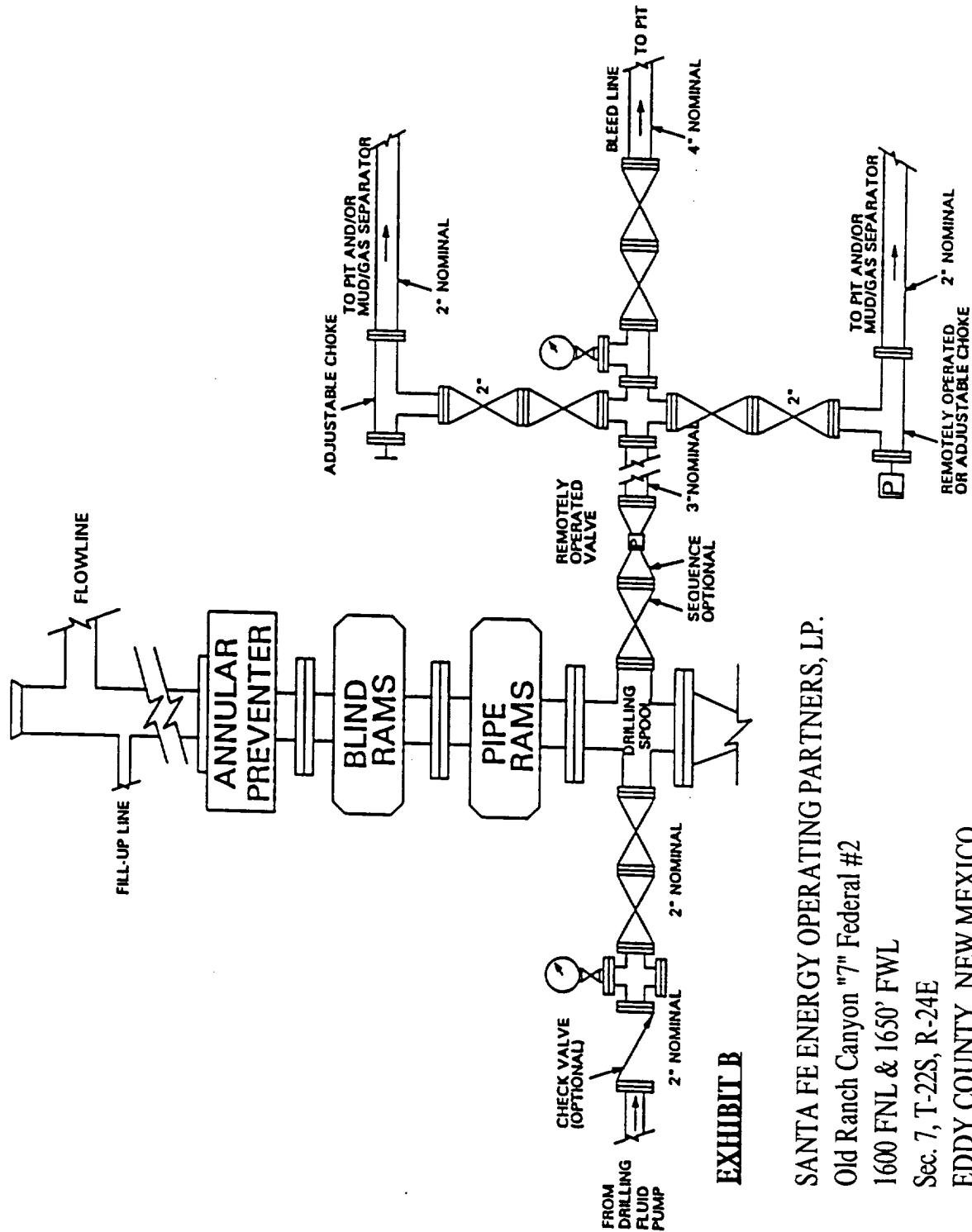

UNITED STATES
DEPARTMENT OF THE INTERIOR
BUREAU OF LAND MANAGEMENT

FORM APPROVED
Budget Bureau No. 1004-0135
Expires: March 31, 1993

SUNDRY NOTICES AND REPORTS ON WELLS

Do not use this form for proposals to drill or to deepen or reentry to a different reservoir.
Use "APPLICATION FOR PERMIT—" for such proposals

SUBMIT IN TRIPLICATE

| | |
|--|---|
| 1. Type of Well <input checked="" type="checkbox"/> Oil Well <input type="checkbox"/> Gas Well <input type="checkbox"/> Other | 5. Lease Designation and Serial No. NM-81219-7-2 |
| 2. Name of Operator Santa Fe Energy Operating Partners, L.P. | 6. If Indian, Allottee or Tribe Name |
| 3. Address and Telephone No. 550 W. Texas, Suite 1330, Midland, Texas 79701 | 7. If Unit or CA, Agreement Designation |
| 4. Location of Well (Footage, Sec., T., R., M., or Survey Description) (F), 1600' FNL and 1400' FWL, Sec. 7, T-22S, R-24E | 8. Well Name and No. Old Ranch Canyon 7 Fed |
| | 9. API Well No. #2 |
| | 10. Field and Pool, or Exploratory Area Not assigned |
| | 11. County or Parish, State Indian Basin (Upper Penn Eddy Co., NM |

CHECK APPROPRIATE BOX(s) TO INDICATE NATURE OF NOTICE, REPORT, OR OTHER DATA

| TYPE OF SUBMISSION | TYPE OF ACTION |
|--|--|
| <input checked="" type="checkbox"/> Notice of Intent | <input type="checkbox"/> Abandonment |
| <input type="checkbox"/> Subsequent Report | <input type="checkbox"/> Recompletion |
| <input type="checkbox"/> Final Abandonment Notice | <input type="checkbox"/> Plugging Back |
| | <input type="checkbox"/> Casing Repair |
| | <input type="checkbox"/> Altering Casing |
| | <input checked="" type="checkbox"/> Other Move well location |
| | <input type="checkbox"/> Change of Plans |
| | <input type="checkbox"/> New Construction |
| | <input type="checkbox"/> Non-Routine Fracturing |
| | <input type="checkbox"/> Water Shut-Off |
| | <input type="checkbox"/> Conversion to Injection |
| | <input type="checkbox"/> Dispose Water |

(Note: Report results of multiple completion on Well Completion or Recompletion Report and Log form.)

13. Describe Proposed or Completed Operations (Clearly state all pertinent details, and give pertinent dates, including estimated date of starting any proposed work. If well is directionally drilled, give subsurface locations and measured and true vertical depths for all markers and zones pertinent to this work.)*

We respectfully request that the proposed location of the subject well be moved per instructions from Barry Hunt. The location is being moved for topographic reasons.

The new location is (F), 1600' FNL & 1400' FWL, Sec. 7, T-22S, R-24E.

A new Form C-102 (amended location plat is attached).

14. I hereby certify that the foregoing is true and correct

| | | |
|--|-----------------------------------|----------------------------|
| Signed <u>Barry Hunt</u> | Title <u>Sr. Production Clerk</u> | Date <u>August 1, 1994</u> |
| (This space for Federal or State office use) | | |
| Approved by _____ | Title <u>AREA MANAGER</u> | Date _____ |
| Conditions of approval, if any: | | |

DISTRICT I
P. O. Box 1980
Hobbs, NM 88241-1980

State of New Mexico
Ex. , Minerals, and Natural Resources . rtment

Form C-102
Revised 02-10-94

Instructions on back

DISTRICT II
P. O. Drawer DD
Artesia, NM 88211-0719

DISTRICT III
1000 Rio Brazos Rd.
Aztec, NM 87410

DISTRICT IV
P. O. Box 2088
Santa Fe, NM 87507-2088

OIL CONSERVATION DIVISION

P. O. Box 2088
Santa Fe, New Mexico 87504-2088

Submit to the Appropriate
District Office
State Lease - 4 copies
Fee Lease - 3 copies

☒ AMENDED REPORT

WELL LOCATION AND ACREAGE DEDICATION PLAT

| | | | | | | | | | |
|---|--------------|---|----------------------------|--|------------------------|---------------------------|------------------------|------------------------|----------------|
| 1 API Number 30-015-28025 | | 2 Pool Code 33685 | | 3 Pool Name Indian Basin (Upper Penn) JSSOC | | | | | |
| 4 Property Code | | 5 Property Name OLD RANCH CANYON '7' FEDERAL | | | | | | 6 Well Number 2 | |
| 7 OGRID No. 020290 | | 8 Operator Name SANTA FE ENERGY OPER. PART, L.P. | | | | | | 9 Elevation 3996' | |
| 10 SURFACE LOCATION | | | | | | | | | |
| UL or lot no. F | Section 7 | Township 22 SOUTH | Range 24 EAST, N.M.P.M. | Lot Ida | Feet from the 1600' | North/South line NORTH | Feet from the 1400' | East/West line WEST | County EDDY |
| 11 BOTTOM HOLE LOCATION IF DIFFERENT FROM SURFACE | | | | | | | | | |
| UL or lot no. | Section | Township | Range | Lot Ida | Feet from the | North/South line | Feet from the | East/West line | County |
| 12 Dedicated Acres 320 | | 13 Joint or Infill | | 14 Consolidation Code | | 15 Order No. | | | |

NO ALLOWABLE WELL BE ASSIGNED TO THIS COMPLETION UNTIL ALL INTERESTS HAVE BEEN
CONSOLIDATED OR A NON-STANDARD UNIT HAS BEEN APPROVED BY THE DIVISION

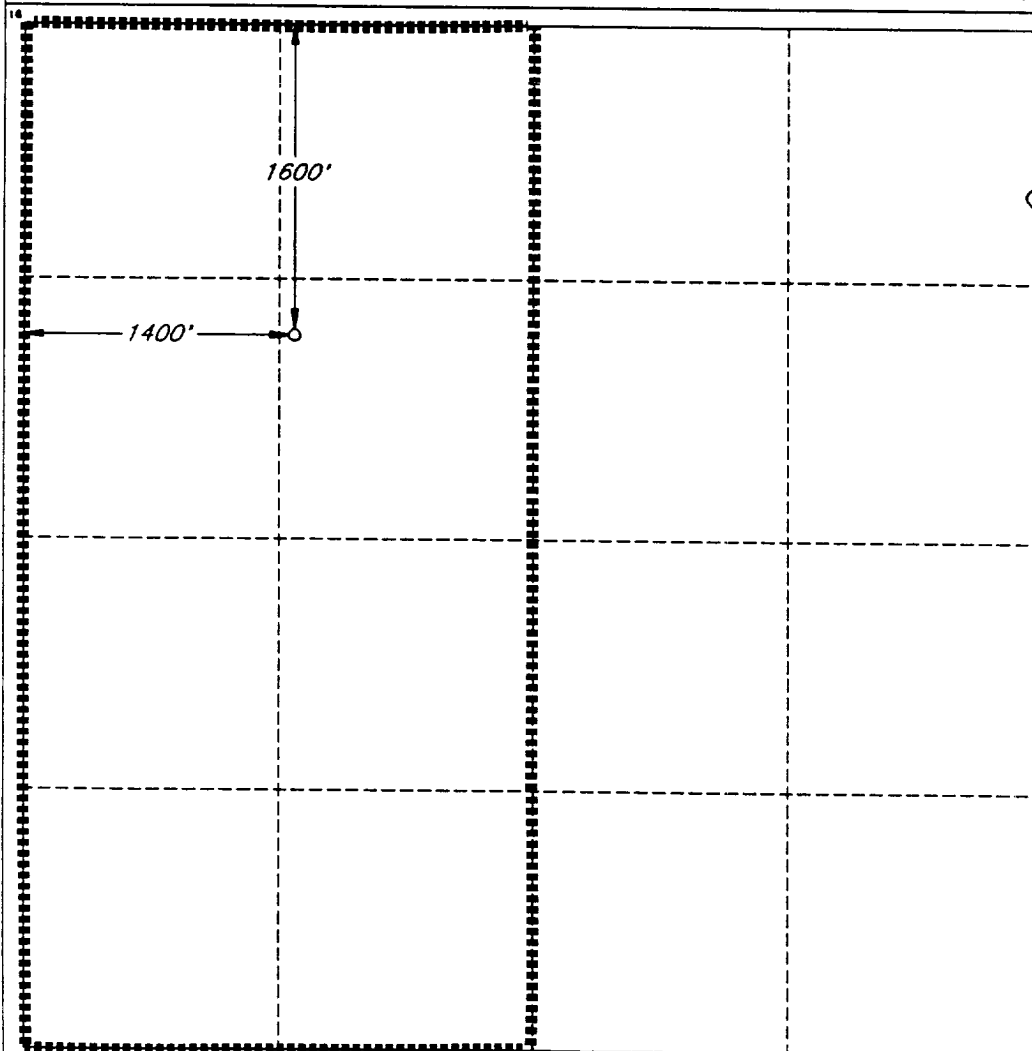

OPERATOR CERTIFICATION

I hereby certify that the information
contained herein is true and complete
to the best of my knowledge and belief.

Signature

Printed Name

Terry McCullough

Title

Sr. Production Clerk

Date

August 1, 1994

SURVEYOR CERTIFICATION

I hereby certify that the well
location shown on this plat was
plotted from field notes of actual
surveys made by me or under
my supervision, and that the
same is true and correct to the
best of my belief.

Date of Survey

JULY 28, 1994

Signature and Seal of
Professional Surveyor

V. LYNN
BEZNER
NO. 7920

Certified by
V. L. BEZNER, R.S. #7920

JOB #34331 / 51 NE / V.H.B.