

REC ED

Form 3160-5
(June 1990)UNITED STATES
DEPARTMENT OF THE INTERIOR
BUREAU OF LAND MANAGEMENT

AUG 03 '94

FORM APPROVED
Budget Bureau No. 1004-0135
Expires: March 31, 1993

SUNDRY NOTICES AND REPORTS ON WELLS

Q. C. D.
ARTESIA, OFFICEDo not use this form for proposals to drill or to deepen or reentry to a different reservoir.
Use "APPLICATION FOR PERMIT—" for such proposals

SUBMIT IN TRIPLICATE

1. Type of Well
☒ Oil Well ☐ Gas Well ☐ Other

2. Name of Operator
 Santa Fe Energy Operating Partners, L.P.

3. Address and Telephone No.
 550 W. Texas, Suite 1330, Midland, Texas 79701

4. Location of Well (Footage, Sec., T., R., M., or Survey Description)
 (F), 1600' FNL and 1400' FWL, Sec. 7, T-22S, R-24E

5. Lease Designation and Serial No.
 NM-81219-7-2

6. If Indian, Allottee or Tribe Name

7. If Unit or CA, Agreement Designation

8. Well Name and No.
 Old Ranch Canyon 7 Fed

9. API Well No. #2
 Not assigned

10. Field and Pool, or Exploratory Area
 Indian Basin (Upper Penn)

11. County or Parish, State
 Eddy Co., NM

CHECK APPROPRIATE BOX(S) TO INDICATE NATURE OF NOTICE, REPORT, OR OTHER DATA

TYPE OF SUBMISSION

- ☒ Notice of Intent
- ☐ Subsequent Report
- ☐ Final Abandonment Notice

TYPE OF ACTION

- ☐ Abandonment
- ☐ Recompletion
- ☐ Plugging Back
- ☐ Casing Repair
- ☐ Altering Casing
- ☒ Other Move well location

- ☐ Change of Plans
- ☐ New Construction
- ☐ Non-Routine Fracturing
- ☐ Water Shut-Off
- ☐ Conversion to Injection
- ☐ Dispose Water

(Note: Report results of multiple completion on Well Completion or Recompletion Report and Log form.)

13. Describe Proposed or Completed Operations (Clearly state all pertinent details, and give pertinent dates, including estimated date of starting any proposed work. If well is directionally drilled give subsurface locations and measured and true vertical depths for all markers and zones pertinent to this work.)*

We respectfully request that the proposed location of the subject well be moved per instructions from Barry Hunt. The location is being moved for topographic reasons.

The new location is (F), 1600' FNL & 1400' FWL, Sec. 7, T-22S, R-24E.

A new Form C-102 (amended location plat is attached).

14. I hereby certify that the foregoing is true and correct

Signed

Bessie McTulough

Title

Sr. Production Clerk

Date

August 1, 1994

(This space for Federal or State office use)

Approved by

Title

Date

Conditions of approval, if any:

Title 18 U.S.C. Section 1001, makes it a crime for any person knowingly and willfully to make to any department or agency of the United States any false, fictitious or fraudulent statement or representations as to any matter within its jurisdiction.

*See instruction on Reverse Side

DISTRICT I
P. O. Box 1980
Hobbs, NM 88241-1980

State of New Mexico
Department of Energy, Minerals, and Natural Resources

Form C-102
Revised 02-10-94
Instructions on back

DISTRICT II
P. O. Drawer DD
Artesia, NM 88211-0719

DISTRICT III
1000 Rio Brazos Rd.
Aztec, NM 87410

OIL CONSERVATION DIVISION
P. O. Box 2088
Santa Fe, New Mexico 87504-2088

Submit to the Appropriate
District Office
State Lease - 4 copies
Fee Lease - 3 copies

☒ AMENDED REPORT

DISTRICT IV
P. O. Box 2088
Santa Fe, NM 87507-2088

WELL LOCATION AND ACREAGE DEDICATION PLAT

1 API Number		2 Pool Code		3 Pool Name Indian Basin (Upper Penn)			
4 Property Code		5 Property Name OLD RANCH CANYON '7' FEDERAL				6 Well Number 2	
7 OGRID No. 020290		8 Operator Name SANTA FE ENERGY OPER. PART, L.P.				9 Elevation 3996'	

10 SURFACE LOCATION

UL or lot no. F	Section 7	Township 22 SOUTH	Range 24 EAST, N.M.P.M.	Lot Ida	Feet from the 1600'	North/South line NORTH	Feet from the 1400'	East/West line WEST	County EDDY
--------------------	--------------	----------------------	----------------------------	---------	------------------------	---------------------------	------------------------	------------------------	----------------

"BOTTOM HOLE LOCATION IF DIFFERENT FROM SURFACE

UL or lot no.	Section	Township	Range	Lot Ida	Feet from the	North/South line	Feet from the	East/West line	County
---------------	---------	----------	-------	---------	---------------	------------------	---------------	----------------	--------

12 Dedicated Acres 320	13 Joint or Infill	14 Consolidation Code	15 Order No.
---------------------------	--------------------	-----------------------	--------------

NO ALLOWABLE WELL BE ASSIGNED TO THIS COMPLETION UNTIL ALL INTERESTS HAVE BEEN CONSOLIDATED OR A NON-STANDARD UNIT HAS BEEN APPROVED BY THE DIVISION

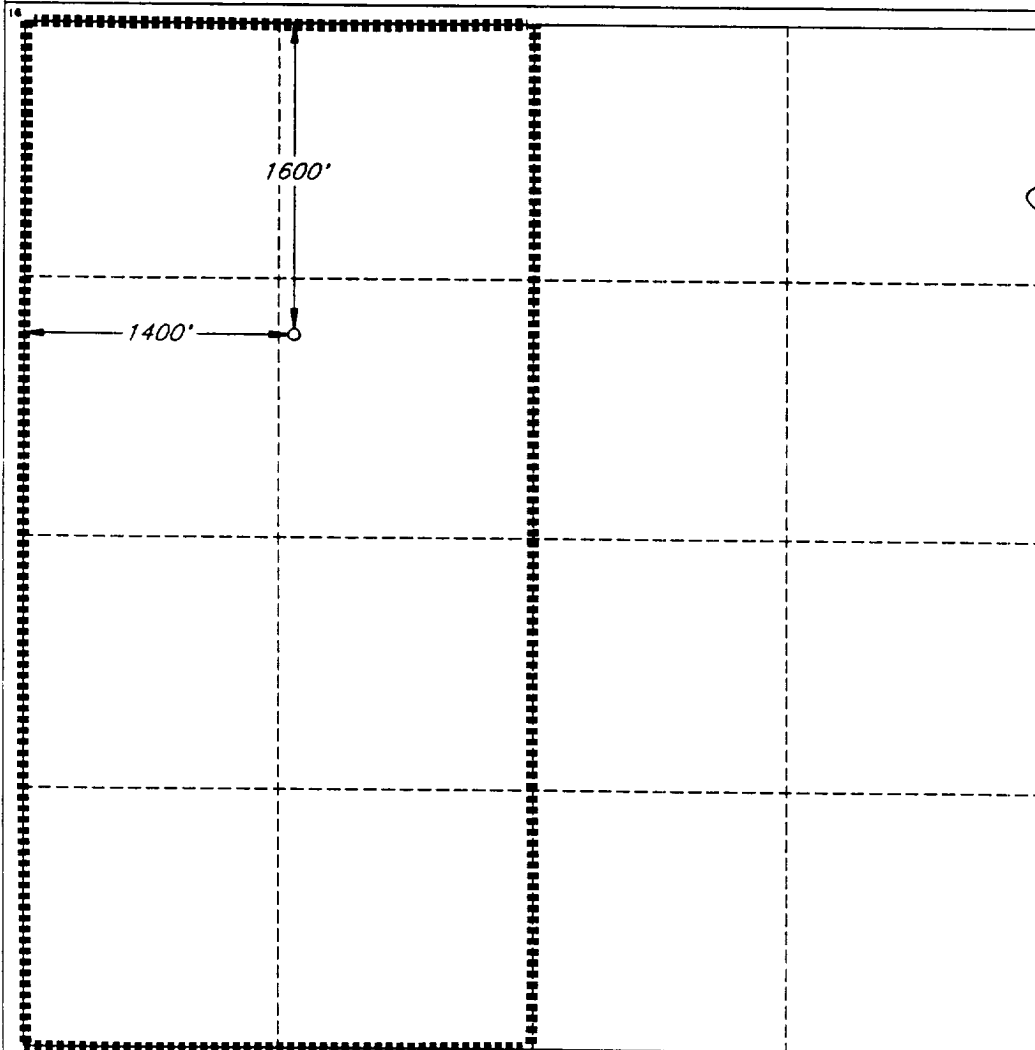

OPERATOR CERTIFICATION

I hereby certify that the information contained herein is true and complete to the best of my knowledge and belief.

Signature

Printed Name

Terry McCullough

Title

Sr. Production Clerk

Date

August 1, 1994

SURVEYOR CERTIFICATION

I hereby certify that the well location shown on this plat was plotted from field notes of actual surveys made by me or under my supervision, and that the same is true and correct to the best of my belief.

Date of Survey

JULY 16, 1994

Signature and Seal of Professional Surveyor

STATE OF NEW MEXICO
V. LYNN BEZNER
NO. 7920
Certified by
V. L. BEZNER R.E.S. #7920
JOB #34331 / S1 NE / V.H.B.