

DISTRICT I  
P O. Box 1980, Hobbs, NM 88240

DISTRICT II  
P O. Drawer DD, Artesia, NM 88210

DISTRICT III  
1000 Rio Brazos Rd., Aztec, NM 87410

## OIL CONSERVATION DIVISION

2040 Pacheco St.  
Santa Fe, NM 87505

|  |
|--|
| WELL API NO.<br>30-015-28186   |
| Indicate Type of Lease<br>STATE <input checked="" type="checkbox"/> FEE  |
| State Oil & Gas Lease No.  |
| Lease Name or Unit Agreement Name<br>Big Walt 2 State  |
| Well No.<br>3  |
| Pool name or Wildcat<br>McKittrick Hills; Morrow   |
| Well Location<br>Unit Letter K : 1980 Feet From The South Line and 1980 Feet From The West Line<br>Section 2 Township 22S Range 24E NMPM Eddy County<br>Elevation (Show whether DF, RKB, RT, GR, etc.)<br>3902' GR |

**SUNDRY NOTICES AND REPORTS ON WELLS**  
(DO NOT USE THIS FORM FOR PROPOSALS TO DRILL OR TO DEEPEN OR PLUG BACK TO A DIFFERENT RESERVOIR. USE "APPLICATION FOR PERMIT" (FORM C-101) FOR SUCH PROPOSALS.)

Type of Well:  
OIL WELL GAS WELL ☒ OTHER

Name of Operator  
Nearburg Producing Company

Address of Operator  
3300 N A St., Bldg 2, Suite 120, Midland, TX 79705

Well Location  
Unit Letter K : 1980 Feet From The South Line and 1980 Feet From The West Line  
Section 2 Township 22S Range 24E NMPM Eddy County  
Elevation (Show whether DF, RKB, RT, GR, etc.)  
3902' GR

11

Check Appropriate Box to Indicate Nature of Notice, Report, or Other Data

### NOTICE OF INTENTION TO:

PERFORM REMEDIAL WORK ☐ PLUG AND ABANDON ☐  
TEMPORARILY ABANDON ☐ CHANGE PLANS ☐  
PULL OR ALTER CASING ☐  
OTHER: Off Lease Gas Measurement and Surface Gas Commingling ☒

### SUBSEQUENT REPORT OF:

REMEDIAL WORK ☐ ALTERING CASING ☐  
COMMENCE DRILLING OPNS. ☐ PLUG AND ANBANDONMENT ☐  
CASING TEST AND CEMENT JOB ☐  
OTHER: ☐

Describe Proposed or Completed Operations (Clearly state all pertinent details, and give pertinent dates, including estimated date of starting any proposed work) SEE RULE 1103.

Nearburg Producing Company is requesting approval for Off Lease Gas Measurement and Surface Gas Commingling for the above referenced well.

The Big Walt 2 State #3 will be commingled with gas from the following wells:

McKittrick Federal Com 11 1-Y  
2319 FSL and 960 FWL  
Section 11, T22S, R24E  
Eddy County, New Mexico

Shelby Federal #3  
1900 FSL and 2150 FWL  
Section 12, T22S, R24E  
Eddy County, New Mexico

The gas from each well is individually metered on each location.

The Off Lease Measurement meter is located 1980' FSL and 100' FWL in Section 13, T21S, R25E, Eddy County, New Mexico.  
(Attachment II attached)



I hereby certify that the information above is true and complete to the best of my knowledge and belief.

SIGNATURE Kim Stewart TITLE Regulatory Analyst DATE 07-18-01

TYPE OR PRINT NAME Kim Stewart

TELEPHONE NO. 915/686-8235

(This space for State Use)

APPROVED BY

TITLE

DATE

CONDITIONS OF APPROVAL IF ANY:

Administrative Approval Required

JUL 23 2001

# SECTION 13, T-21-S, R-25-E, EDDY COUNTY, NM

## ATTACHMENT II

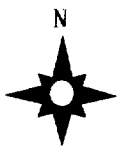
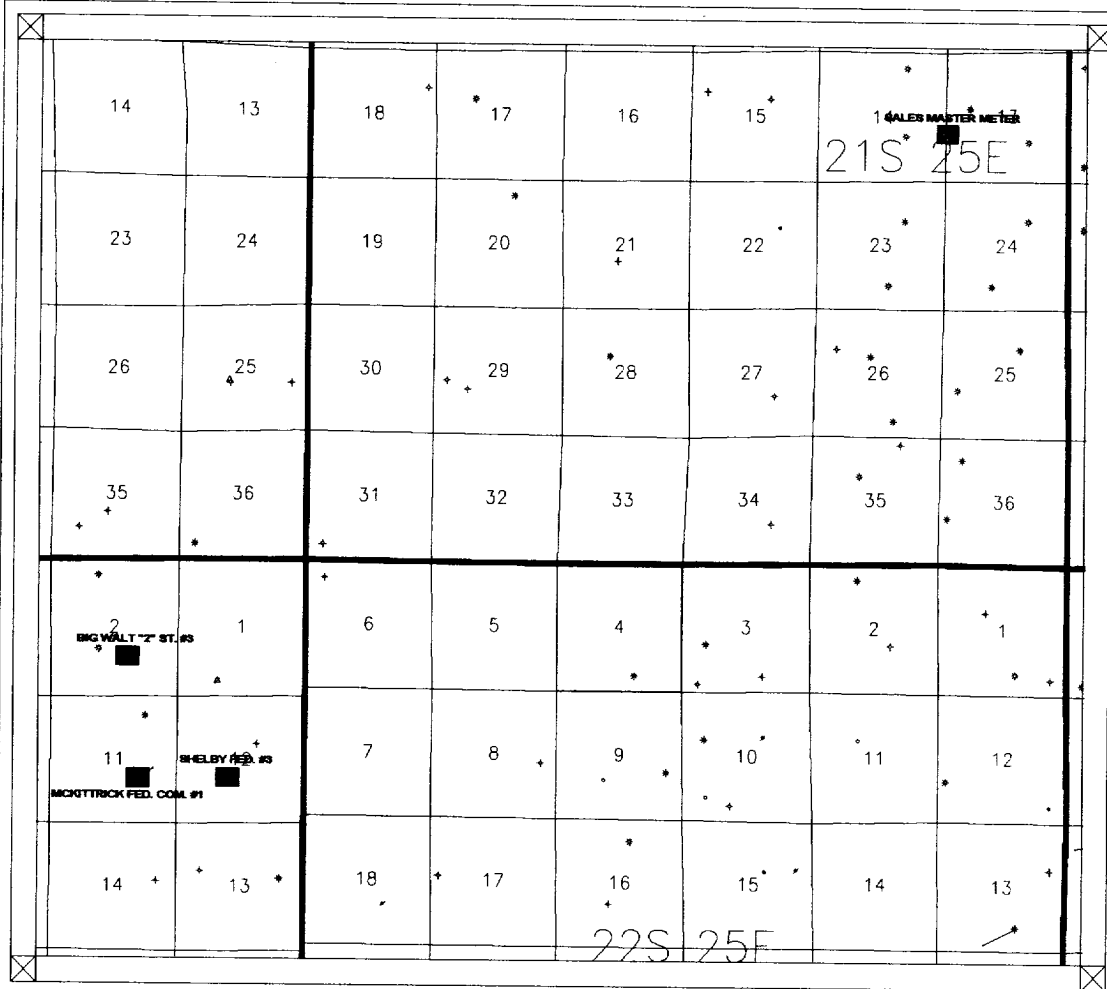

Scale: 1:96000

2000 0 2000 4000 6000 8000 10000 feet



ENG-MASMET