

DISTRICT I
P. C. Box 1980
Hobbs, NM 88241-1980

State of New Mexico
Energy, Minerals, and Natural Resources Department

Form C-102
Revised 02-10-94
Instructions on back

DISTRICT II
P. O. Drawer DD
Artesia, NM 88211-0719

OIL CONSERVATION DIVISION
P. O. Box 2088
Santa Fe, New Mexico 87504-2088

Submit to the Appropriate
District Office
State Lease - 4 copies
Fee Lease - 3 copies

☐ AMENDED REPORT

DISTRICT III
1000 Rio Brazos Rd.
Aztec, NM 87410

DISTRICT IV
P. O. Box 2088
Santa Fe, NM 87507-2088

WELL LOCATION AND ACREAGE DEDICATION PLAT

1 API Number		2 Pool Code		3 Pool Name Wildcat			
4 Property Code D		5 Property Name FAREWELL '18' FEDERAL COM.				6 Well Number 1	
7 OGRID No.		8 Operator Name SANTA FE ENERGY OPERATING PARTNERS, L.P.				9 Elevation 3769'	

10 SURFACE LOCATION

UL or lot no. D	Section 18	Township 22 SOUTH	Range 26 EAST, N.M.P.M.	Lot Ida	Feet from the 1026'	North/South line NORTH	Feet from the 409'	East/West line WEST	County EDDY
--------------------	---------------	----------------------	----------------------------	---------	------------------------	---------------------------	-----------------------	------------------------	----------------

11 BOTTOM HOLE LOCATION IF DIFFERENT FROM SURFACE

UL or lot no.	Section	Township	Range	Lot Ida	Feet from the	North/South line	Feet from the	East/West line	County
---------------	---------	----------	-------	---------	---------------	------------------	---------------	----------------	--------

12 Dedicated Acres 320	13 Joint or Infill	14 Consolidation Code	15 Order No.
---------------------------	--------------------	-----------------------	--------------

NO ALLOWABLE WELL BE ASSIGNED TO THIS COMPLETION UNTIL ALL INTERESTS HAVE BEEN
CONSOLIDATED OR A NON-STANDARD UNIT HAS BEEN APPROVED BY THE DIVISION

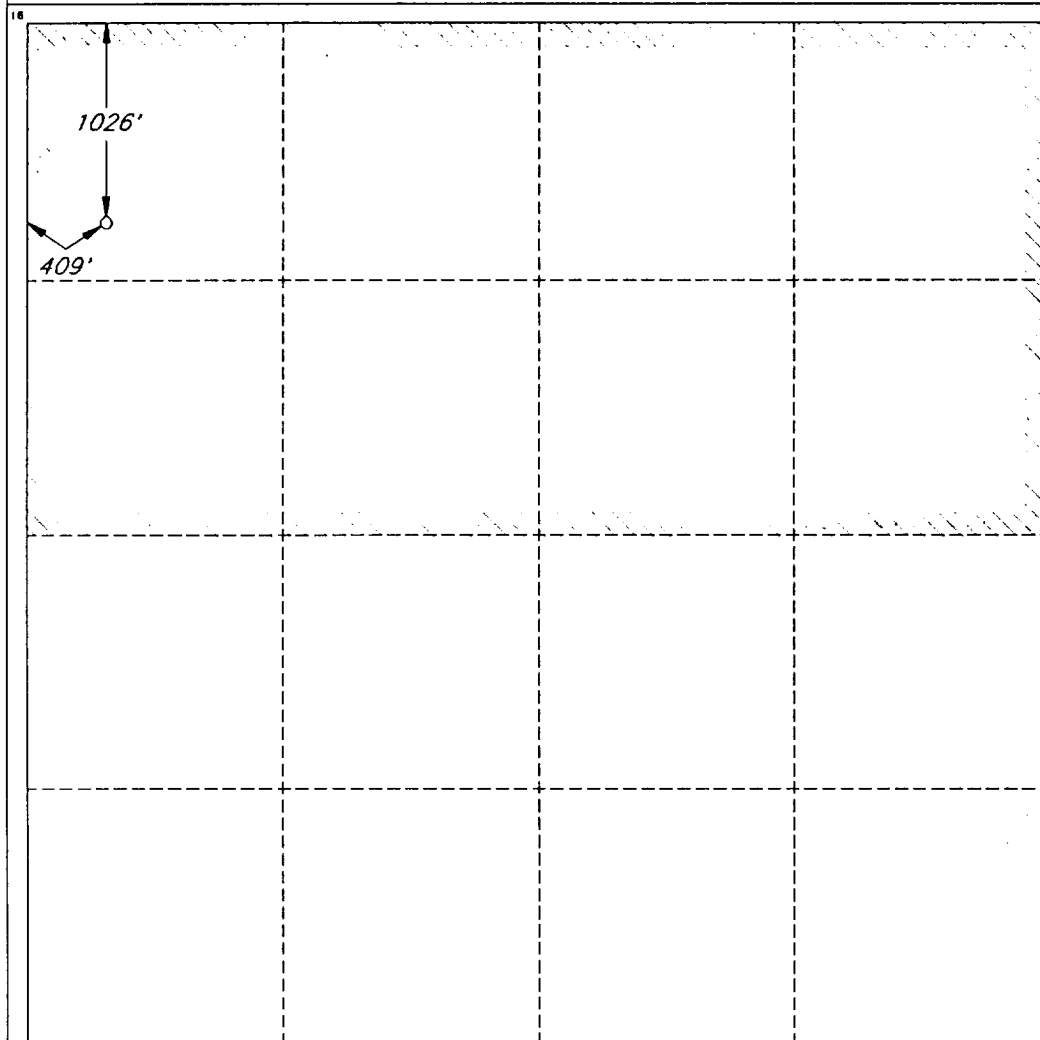

OPERATOR CERTIFICATION

I hereby certify that the information
contained herein is true and complete
to the best of my knowledge and belief.

Signature
James P. "Phil" Stinson

Printed Name
James P. "Phil" Stinson

Title
Agent for Santa Fe Energy

Date
11-23-94

SURVEYOR CERTIFICATION

I hereby certify that the well
location shown on this plat was
plotted from field notes of actual
surveys made by me or under
my supervision, and that the
same is true and correct to the
best of my belief.

Date of Survey
NOVEMBER 17, 1994

Signature and Seal of
Professional Surveyor

V. Lynn Bezner
V. LYNN
BEZNER
NO. 7920

Certification No.
V. L. BEZNER
LAND SURV. #7920

JOB #38586 / 50 NE / V.H.B.