

UNITED STATES OF AMERICA, NM 88210  
DEPARTMENT OF THE INTERIOR  
BUREAU OF LAND MANAGEMENT

APPLICATION FOR PERMIT TO DRILL OR DEEPEN

1a. TYPE OF WORK <b>DRILL</b> <input checked="" type="checkbox"/> <b>DEEPEN</b> <input type="checkbox"/>		5. LEASE DESIGNATION AND SERIAL NO. <b>NM07260</b>
b. TYPE OF WELL OIL WELL <input checked="" type="checkbox"/> GAS WELL <input checked="" type="checkbox"/> OTHER <input type="checkbox"/> SINGLE ZONE <input checked="" type="checkbox"/> MULTIPLE ZONE <input type="checkbox"/>		6. IF INDIAN, ALLOTTEE OR TRIBE NAME <b>INDIAN HILLS</b>
2. NAME OF OPERATOR <b>Marathon Oil Company</b>		7. UNIT AGREEMENT NAME <b>INDIAN HILLS Unit 6409</b>
3. ADDRESS AND TELEPHONE NO. <b>P.O. Box 552, Midland, TX 79702</b> <b>915/682-1626</b>		8. FARM OR LEASE NAME, WELL NO. <b>INDIAN HILLS #8</b>
4. LOCATION OF WELL (Report location clearly and in accordance with any State requirements. *) At surface <b>1182' FSL &amp; 1545' FWL</b> <b>UNORTHODOX</b> <b>Subject to</b> At proposed prod. zone <b>1182' FSL &amp; 1545' FWL</b> <b>LOCATION: Unit N</b> <b>Like Approval</b> <b>By State</b> <b>Lot 14</b>		9. API WELL NO. <b>30-015-28590</b>
14. DISTANCE IN MILES AND DIRECTION FROM NEAREST TOWN OR POST OFFICE* <b>18 MILES N.W. OF CARLSBAD, N.M.</b>		10. FIELD AND POOL, OR WILDCAT <b>INDIAN BASIN/U PENN (GAS)</b>
15. DISTANCE FROM PROPOSED* LOCATION TO NEAREST PROPERTY OR LEASE LINE, FT. (Also to nearest drlg. unit line, if any) <b>1182'</b>		11. SEC., T., R., M., OR BLK AND SURVEY OR AREA <b>79050</b> <b>SEC. 33, T-21-S, R-24-E</b>
16. NO. OF ACRES IN LEASE		12. COUNTY OR PARISH <b>EDDY</b>
17. NO. OF ACRES ASSIGNED TO THIS WELL <b>320 - 5/2</b>		13. STATE <b>NM</b>
18. DISTANCE FROM PROPOSED LOCATION* TO NEAREST WELL, DRILLING, COMPLETED, OR APPLIED FOR, ON THIS LEASE, FT. <b>*</b>		19. PROPOSED DEPTH <b>8000'</b>
20. ROTARY OR CABLE TOOLS <b>ROTARY</b>		21. APPROX. DATE WORK WILL START* <b>7-20-95</b>
21. ELEVATIONS (Show whether DF, RT, GR, etc.) <b>4090' GR</b> <b>Carlsbad Controlled Water Basin</b>		

23. PROPOSED CASING AND CEMENTING PROGRAM				
SIZE OF HOLE	GRADE, SIZE OF CASING	WEIGHT PER FOOT	SETTING DEPTH	QUANTITY OF CEMENT
17 1/2"	13 3/8"	48#	40'	CONDUCTOR-REDI MIX TO SURFACE
12 1/4"	9 5/8"	36#	1200'	800 - CIRCULATE
8 3/4"	7"	23#, 26#	8000'	1075-TOC @ +/- 1000'

SEE ATTACHED MULTIPOINT AND DRILLING PROGRAM FOR SPECIFIC DETAILS.

RECEIVED  
JUL 20 1995  
OIL CON. DIV.  
DIST. 2  
Post ID-1  
7-28-95  
New Loc +  
API

- \* DISTANCE TO HU #5 @ 1230' FSL & 1470' FWL - 125'
- \* DISTANCE TO HU #4 @ 1650' FSL & 1650' FWL, SEC. 28 - 5,749'

Special Requirements and  
Special Stipulations  
Attached

IN ABOVE SPACE DESCRIBE PROPOSED PROGRAM: If proposal is to deepen, give data on present productive zone and proposed new productive zone. If proposal is to drill or deepen directionally, give pertinent data on subsurface locations and measured and true vertical depths. Give blowout preventer program, if any.

24. SIGNED W.J. Queen for D.D. Weber TITLE DRILLING SUPERINTENDENT DATE 6-19-95  
(This space for Federal or State office use)

PERMIT NO. \_\_\_\_\_ APPROVAL DATE \_\_\_\_\_

Application approval does not warrant or certify that the applicant holds legal or equitable title to those rights in the subject lease which would entitle the applicant to conduct operations thereon.

CONDITIONS OF APPROVAL, IF ANY:

APPROVED BY (ORIG. SGD.) RICHARD L. MANIUS TITLE AREA MANAGER DATE 7/19/95

\*See Instructions On Reverse Side

Title 18 U.S.C. Section 1001, makes it a crime for any person knowingly and willfully to make to any department or agency of the United States any false, fictitious or fraudulent statements or representations as to any matter within its jurisdiction.

DISTRICT I  
P.O. Box 1980, Hobbs, NM 88241-1980

DISTRICT II  
P.O. Drawer DD, Artesia, NM 88211-0719

DISTRICT III  
1000 Rio Brazos Rd., Aztec, NM 87410

DISTRICT IV  
P.O. BOX 2088, SANTA FE, NM 87504-2088

State of New Mexico  
Energy, Minerals and Natural Resources Department

Form C-102  
Revised February 10, 1994  
Submit to Appropriate District Office  
State Lease - 4 Copies  
Fee Lease - 3 Copies

OIL CONSERVATION DIVISION

P.O. Box 2088  
Santa Fe, New Mexico 87504-2088

☐ AMENDED REPORT

WELL LOCATION AND ACREAGE DEDICATION PLAT

API Number <b>30-015-28590</b>	Pool Code <b>19050</b> <del>15475</del>	Indian Basin, Upper Penn. (GAS) <del>S. Dagger Draw (Upper Penn. Assoc)</del>
Property Code	Property Name <b>INDIAN HILLS Unit</b>	Well Number <b>8</b>
OGRID No.	Operator Name <b>MARATHON OIL COMPANY</b>	Elevation <b>4090</b>

Surface Location

UL or lot No.	Section	Township	Range	Lot Idn	Feet from the	North/South line	Feet from the	East/West line	County
	33	2 S	24 E		1182	SOUTH	1545	WEST	EDDY

Bottom Hole Location If Different From Surface

UL or lot No.	Section	Township	Range	Lot Idn	Feet from the	North/South line	Feet from the	East/West line	County

Dedicated Acres <b>320-S/2</b>	Joint or Infill	Consolidation Code	Order No.
-----------------------------------	-----------------	--------------------	-----------

NO ALLOWABLE WILL BE ASSIGNED TO THIS COMPLETION UNTIL ALL INTERESTS HAVE BEEN CONSOLIDATED  
OR A NON-STANDARD UNIT HAS BEEN APPROVED BY THE DIVISION

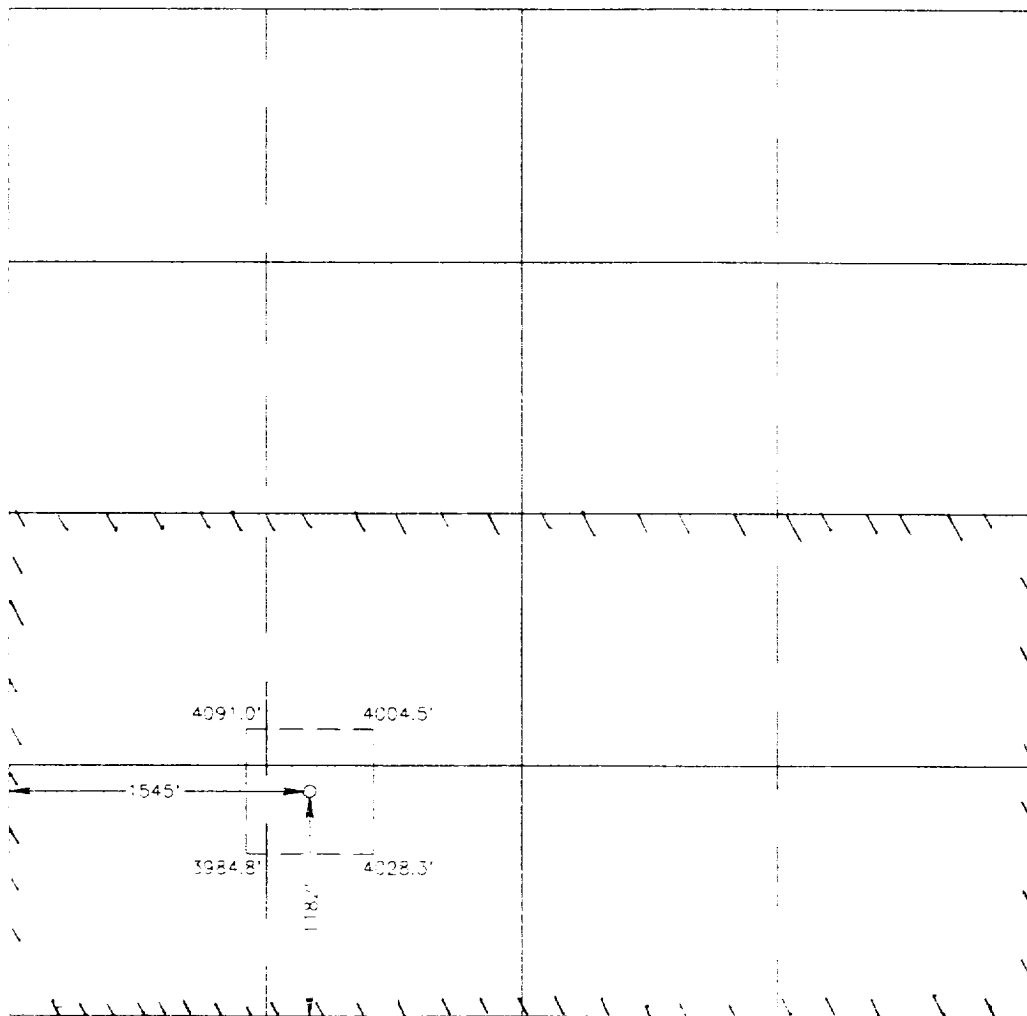

OPERATOR CERTIFICATION

I hereby certify the the information  
contained herein is true and complete to the  
best of my knowledge and belief.

*W. J. Nordt FOR DPN*  
Signature

D. P. Nordt

Printed Name

Drilling Superintendent

Title

6-19-95

Date

SURVEYOR CERTIFICATION

I hereby certify that the well location shown  
on this plat was plotted from field notes of  
actual surveys made by me or under my  
supervision and that the same is true and  
correct to the best of my belief.

JUNE 13, 1995

Date Surveyed

SJA

Signature & Seal of  
Professional Surveyor

*Ronald J. Edson*  
A.C. No. 95-11-0904

Certificate No. JOHN W. WEST 676  
RONALD J. EDSON 3239  
CARY EDSON 1264

