

UNITED STATES
DEPARTMENT OF THE INTERIOR
BUREAU OF LAND MANAGEMENT

FORM APPROVED
Budget Bureau No. 1004-0135
Expires: March 31, 1993

SUNDRY NOTICES AND REPORTS ON WELLS

Do not use this form for proposals to drill or deepen or reentry to a different reservoir.

Use "APPLICATION FOR PERMIT-" for such proposals

SUBMIT IN TRIPLICATE

1. Type of well <input type="checkbox"/> Oil <input checked="" type="checkbox"/> Gas <input type="checkbox"/> Other	7. If Unit or CA, Agreement Designation Unit No. SW-298
2. Name of Operator CHEVRON U.S.A. PRODUCTION CO., INC.	8. Well Name and No. Bogle Flats Unit/A Com Well No. 12
3. Address and Telephone No. P. O. BOX 1150, MIDLAND, TX 79702 Attn: Reggie Holzer (915) 687-7182	9. API Well No. API No. 3001528624
4. Location of Well (Footage, Sec., T., R., M., or Survey Description) Section 8, T22S - R23E 1,880' FSL - 1,750' FEL Unit J	10. Field and Pool, or Exploratory Area Indian Basin
	11. County or Parish, State Eddy County, NM

CHECK APPROPRIATE BOX(S) TO INDICATE NATURE OF NOTICE, REPORT, OR OTHER DATA

12 TYPE OF SUBMISSION	TYPE OF ACTION
<input checked="" type="checkbox"/> Notice of Intent	<input type="checkbox"/> Abandonment
<input type="checkbox"/> Subsequent Report	<input type="checkbox"/> Recompletion
<input type="checkbox"/> Final Abandonment Notice	<input type="checkbox"/> Plugging Back
	<input type="checkbox"/> Casing Repair
	<input type="checkbox"/> Altering Casing
	<input checked="" type="checkbox"/> Other Measurement/comingle
	<input type="checkbox"/> Change of Plans
	<input type="checkbox"/> New Construction
	<input type="checkbox"/> Non-Routine Fracturing
	<input type="checkbox"/> Water Shut-Off
	<input type="checkbox"/> Conversion to Injection
	<input type="checkbox"/> Dispose Water

(Note: Report results of multiple completion on Well Completion or Recompletion Report and Log form.)

13. Describe Proposed or Completed Operations (Clearly state all pertinent details, and give pertinent dates, including estimate date of starting any proposed work. If well is directionally drilled, give subsurface locations and measured and true vertical depths for all markers and zones pertinent to this work.)

As required by 43 CFR 3162.7-2 and Onshore Oil and Gas Order No. 4, we are requesting approval of off-lease measurement, alternate measurement method, and commingling of condensate. Attached is a copy of the BLM approval for alternate measurement of condensate in the Indian Basin field. Also as required by 43 CFR 3162.7-3 and Onshore Oil and Gas Order No. 4, we are requesting approval of off-lease measurement and commingling of gas. Both condensate and gas is transported to the Marathon Gas Plant located, at SW/NE, Section 23, T-21-S, R-23-E in Eddy County, by separate steel pipelines. The routing of these pipelines is shown in Figure 1. An application is attached showing the affected leases in the Indian Basin field.

RECEIVED
MAR 18 1996
OIL CON. DIST.

RECEIVED
FEB 5 9 15 AM '96
CARLETON AREA

14. I hereby certify that the foregoing is true and correct Signed <u>Reggie Holzer</u>	Title <u>Sr. Facilities Engineer</u>	Date <u>February 2, 1996</u>
(This space for Federal or State office use) Approved by <u>Paul J. [Signature]</u>	Title <u>Petroleum Engineer</u>	Date <u>3/13/96</u>
Conditions of approval, if any:		

Title 18 U.S.C. Section 1001, makes it a crime for any person knowingly and willfully to make to any department or agency of the United States any false, fictitious or fraudulent statements or representations as to any matter within its jurisdiction.

**APPLICATION FOR SURFACE COMMINGLING
OFF-LEASE STORAGE AND MEASUREMENT APPROVAL**

TO: Bureau of Land Management
P. O. Box 1778
Carlsbad, New Mexico 88221-1778

Chevron U. S. A. Production Company is requesting approval for surface commingling and off lease storage and measurement of hydrocarbon production from the following formations(s) and well(s) on **Federal Lease No. SW-298; Lease name: Bogle Flats Unit/A Com.,**

<u>Well No.</u>	<u>Location</u>	<u>Section</u>	<u>Township</u>	<u>Range</u>	<u>Formation</u>
12	1,880' FSL - 1,750' FEL	8	22S	23E	Upper Penn

with hydrocarbon production from other Federal Leases connected to the Marathon gas gathering and oil and water gathering systems.

Production from the new well involved is as follows:

<u>Well Name and Number</u>	<u>BOPD</u>	<u>Oil Gravity</u>	<u>MCFPD</u>
Bogle Flats Unit/A Com Well No. 12	6	60° API	2,670

The proposed operation is described in detail on the attached diagrams.

A map is enclosed showing the lease numbers and location of all leases and wells that will contribute production to the proposed commingling/common storage facility. All unitized/communitized areas, producing zones and pools are also clearly illustrated.

A schematic diagram is also attached which clearly identifies all equipment that will be utilized.

The storage and measuring facility is located at SW/NE, Section 23, T21S-R23E, Eddy County, New Mexico. BLM will be notified if there is any future change in the facility location.

Details of the proposed method for allocating production to contributing sources is as follows:

The gas and oil are measured at each site utilizing allocation meters. The gas and oil with water is transported to the Marathon Gas Plant in two separate pipelines. After processing the gas it is metered at the tail-gate of the plant and sold. The oil is also processed and sold through a LACT Unit at the plant. The produced water is injected into salt water disposal wells adjacent to the plant.

The proposed commingling of production is in the best interest of conservation and will not result in reduced royalty or improper measurement of production.

The proposed commingling is necessary for continued operation of the above referenced Federal Leases.

We understand that the requested approval will not constitute the granting of any right-of-way or construction rights not granted by the lease instrument. And, we will submit within 30 days an application for right-of-way approval to the BLM's Realty Section in your office if we have not already done so.

Additional wells require additional commingling approvals.

Signature: RA Holzer
Name: R. A. HOLZER
Title: SR. FACILITIES ENGR
Date: 2-2-96

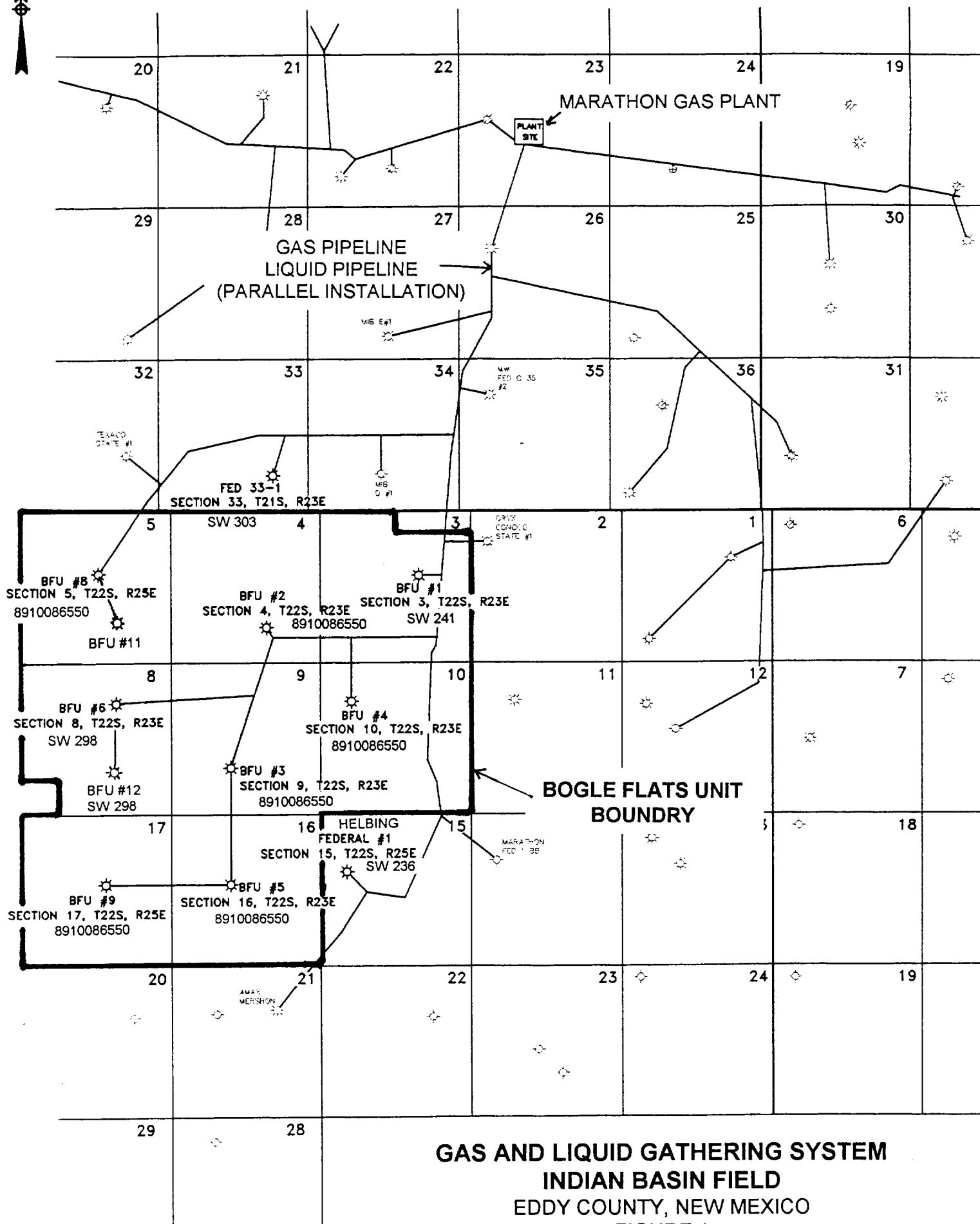

ATTACHMENT

Chevron USA Production Company

<u>Lease No.</u>	<u>Lease Name</u>	<u>Location</u>			
NM 06953A	Bogle Flats Unit Com Well No. 1	Sec. 3	T22S	R23E	Unit G
NM 045273	Bogle Flats Unit Well No. 2	Sec. 4	T22S	R23E	Unit J
NM 033647	Bogle Flats Unit Well No. 3	Sec. 9	T22S	R23E	Unit K
NM 045273	Bogle Flats Unit Well No. 4	Sec.10	T22S	R23E	Unit F
State	Bogle Flats Unit Well No. 5	Sec. 16	T22S	R23E	Unit F
NM 045272	Bogle Flats Unit/A Com Well No. 6	Sec. 8	T22S	R23E	Unit G
NM LC068721	Bogle Flats Unit Well No. 8	Sec. 5	T22S	R23E	Unit G
NM 033647B	Bogle Flats Unit Well No. 9	Sec. 17	T22S	R23E	Unit G
NM LC068721	Bogle Flats Unit Well No. 11	Sec. 5	T22S	R23E	Unit J
NM 045272	Bogle Flats Unit /A Com Well No. 12	Sec. 8	T22S	R23E	Unit J
NM 0556590	Federal 33 Com Well No. 1	Sec. 33	T21S	R23E	Unit J
NM 068032	Helbing Com Well No. 1	Sec. 15	T22S	R23E	Unit F

V-1
16" X 7'-6"
HORZ. SEPARATOR
1440 PSI WP

V-2
3' X 10'
HORZ. SEPARATOR
500 PSI MAWP

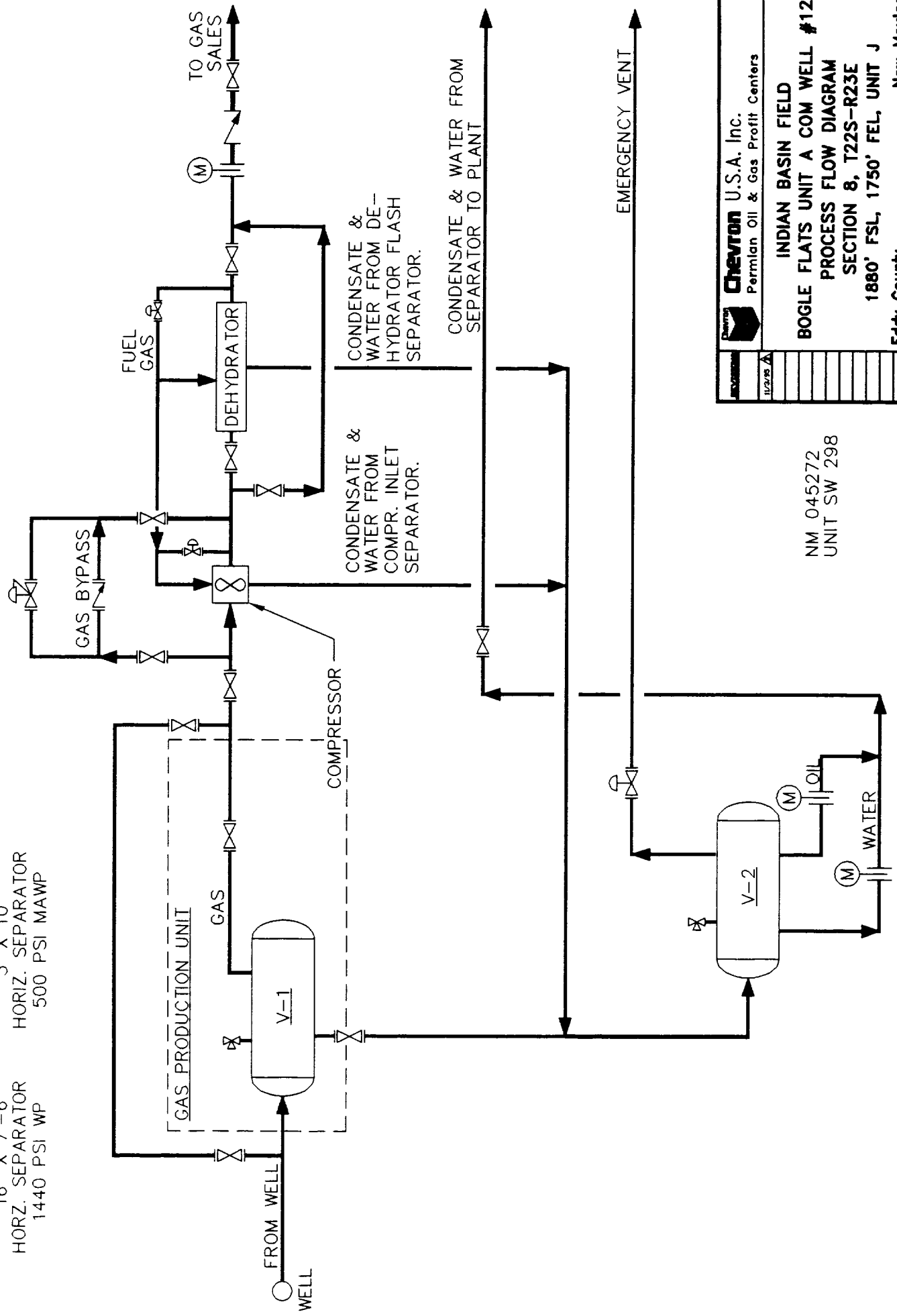

Chevron U.S.A. Inc.
Permian Oil & Gas Profit Centers

INDIAN BASIN FIELD
BOGLE FLATS UNIT A COM WELL #12
PROCESS FLOW DIAGRAM
SECTION 8, T22S-R23E
1880' FSL, 1750' FEL, UNIT J

Eddy County, New Mexico

DATE: 10/13/95
TIME: 10:00 AM
BY: J. L. H. / TP
CHECKED: 1
APPROVED: 2
D-IND-00-01

ADDRESS: INDIAN-8\IND0001

NM 045272
UNIT SW 298

NOTE: SEE PAGE 2 FOR DEHYDRATOR PFD

V-3
VERTICAL INLET
SEPARATOR
20" X 5'
1200 PSI WP

V-4
GLYCOL CONTACTOR
SEPARATOR
24" X 14'
1200 PSI WP

V-5
HORIZONTAL
FLASH SEPARATOR
24" X 5'
125 PSI WP

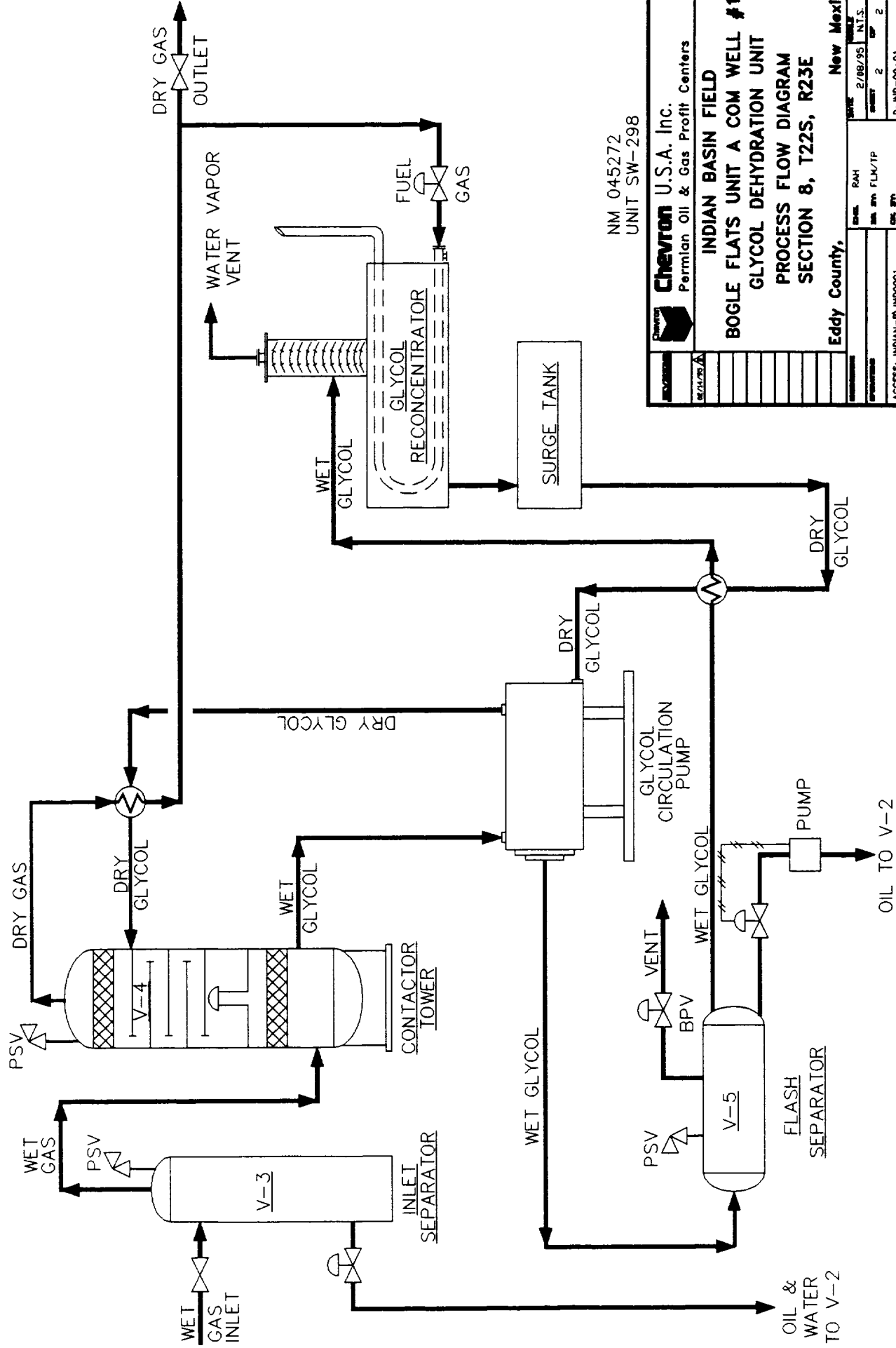

NM 045272
UNIT SW-298

Chevron U.S.A. Inc. Permian Oil & Gas Profit Centers		DATE: 2/08/95 REV: 2 D-IND-00-01	
INDIAN BASIN FIELD BOGLE FLATS UNIT A COM WELL #12 GLYCOL DEHYDRATION UNIT PROCESS FLOW DIAGRAM SECTION 8, T22S, R23E		New Mexico Eddy County	
ACCESS: INDIAN-BV-IND0001		RAH FLN/TP IND. BY IND. BY	